

STATE GAME LANDS #: 152
SALE: 152-2025-01
NAME: Neidermeyer

PENNSYLVANIA GAME COMMISSION
2001 ELMERTON AVENUE
HARRISBURG, PA 17110-9797
ATTN: FORESTRY DIVISION, BUREAU OF WILDLIFE HABITAT MANAGEMENT

Gentlemen:

In answer to a recent advertisement for lump sum bids on an estimated 230,578 board feet of sawlogs and 971 tons of pulpwood located on 90 acres of State Game Lands No. 152, Cussewago Township, Crawford County, I offer the following:

\$ _____
(BID QUOTATION MUST BE TYPEWRITTEN OR IN INK)

Full payment will be made when agreements are signed or payment in full for each individual cutting block before cutting operations are started on that block.

It is further understood that an acceptable bond of **\$20,000.00** will be provided to guarantee faithful performance of the agreement.

Removal of timber to be subject to the terms, conditions and stipulations included in the Timber Sale Agreement. It is understood that the contract will run until **June 30, 2027**.

ATTACHED IS **CERTIFIED, CASHIER'S OR TREASURER'S CHECK OR MONEY ORDER, (PERSONAL, COMPANY, CORPORATE CHECK OR CASH ARE NOT ACCEPTED)**, IN THE AMOUNT OF **\$1,000.00** as evidence of good faith in bidding. I understand that it will be forfeited as fully liquidated damages upon my failure within 45 days after presentation to accept and execute the contract and provide a bond as required.

IN CASE OF PARTNERSHIP, EACH PARTNER SIGNS: IF A CORPORATION, THE AUTHORIZED OFFICER MUST SIGN, GIVING HIS/HER TITLE AND NAME OF CORPORATION.

Sincerely yours,

(Tax No. or Social Security No.)

Signature of Bidder - Sign In Ink

(Telephone Number)

Print Name

Firm Name

Street Address (Name, Number, Etc.)

City State Zip

BIDS MUST BE SUBMITTED IN AN ENVELOPE THAT CLEARLY STATES ON THE OUTSIDE: **BID PROPOSAL FOR TIMBER SGL #152**. Bids will be opened in the Bureau of Wildlife Habitat Management, 2001 Elmerton Avenue, Harrisburg, PA 17110-9797, at **2:00 P.M., Monday, September 8, 2025**. The Commission reserves the right to reject any and all bids and to award the contract as deemed to its best interests.

STATE GAME LANDS #: 152
SALE #: 152-2025-01
NAME: Neidermeyer

- INSTRUCTIONS TO BIDDERS -

The following information covers details concerning the proposed lump sum sale of an estimated 230,578 board feet of sawlogs and 971 tons of pulpwood to be cut from 90 acres of State Game Lands No. 152, Cussewago Township, Crawford County.

See attached sheets for additional volume information. The volume and percentages are not guaranteed and each prospective bidder is urged to examine the sale area and bid on the basis of his own estimate.

- SHOW DATE -

Timber will be shown to prospective bidders on **August 20, 2025**. Viewers will be met at State Game Lands parking area along SR98 (41.847251, -80.226495), 1.6 miles northeast of Crossingville at 10:00 a.m., and conducted to the sale area.

The timber to be sold will be clearly designated by Scott Wolbert, 1509 Pittsburgh Road, Franklin, PA 16323, telephone: 1-814-432-3187 extension 11181, the Regional Forester.

- BIDS -

BIDS SHOULD BE MAILED AT LEAST FOUR (4) WORKING DAYS PRIOR TO BID OPENING TO PERMIT U.S. POSTAL SERVICE DELIVERY. USE SPECIAL MAIL SERVICE IF MAILED LATER THAN FOUR DAYS PRIOR TO BID OPENING. SPECIAL DELIVERY BIDS SHOULD BE ADDRESSED TO: PENNSYLVANIA GAME COMMISSION, FORESTRY DIVISION, 2001 ELMERTON AVENUE, HARRISBURG, PA 17110-9797.

Bids must be submitted in an envelope that clearly states on the outside: **BID PROPOSAL FOR TIMBER. SGL #152**. Bids received in envelopes not containing this information will be rejected.

In order to be considered, the bid shall be accompanied by a **CERTIFIED, CASHIER'S OR TREASURER'S CHECK, OR A BANK, POSTAL OR EXPRESS MONEY ORDER**, payable to the Pennsylvania Game Commission in the amount of **\$1,000.00**, as evidence of good faith in bidding, to be forfeited as fully liquidated damages upon the bidders failure to accept the award, execute the contract and give bond as required. Bid deposits will be returned to the unsuccessful bidder when the contract has been executed and a satisfactory performance deposit has been furnished.

In lieu of bid deposit, bidders may submit an open bid bond to cover the deposit requirement. Any bid bond must be filed for an annual period and both the amount of bond and the surety shall receive prior approval of the Pennsylvania Game Commission.

The Commission reserves the right to reject any and all bids and to award the contract as deemed to its best interests.

Bids will be opened in the Bureau of Wildlife Habitat Management, 2001 Elmerton Avenue, Harrisburg, Pennsylvania 17110-9797, at 2:00 P.M., **Monday, September 8, 2025**, telephone: 717/787-2039. **BIDS RECEIVED LATER THAN 2:00 P.M., THIS DATE, WILL BE REJECTED.**

- PERFORMANCE DEPOSIT -

A performance bond in the amount of **\$20,000.00** will be required in the form of a Certified Check or a Postal Money Order drawn to the order of the Pennsylvania Game Commission. Negotiable securities, including assignment of a bank savings account may be furnished in lieu of above. A bond with corporate surety approved by the Attorney General, or a bank Irrevocable Letter of Credit, may be posted provided the bond has an expiration date a minimum of 1 year beyond the expiration date of the timber contract.

- EXPIRATION OF CONTRACT -

Contract will expire **June 30, 2027**.

- PAYMENTS

The sale is divided into 4 cutting blocks. Payment may be made by:

1. Total payment when agreement is signed.
- or
2. Payment by individual block or blocks.

1 – 17% - 11 acres
2 – 55% - 32 acres
3 – 4% - 12 acres
4 – 24% - 35 acres

Payment for Block 1 is due at contract execution.

Final payment is due No Later Than 120 days before the expiration of the Agreement.

- ANTI DISCRIMINATION -

The contractor awarded the Timber Sale Agreement agrees he will not discriminate against any employee or other persons on account of race, sex, creed, age, ancestry or national origin.

- SAFETY and ENVIRONMENTAL PROTECTION –

The Buyer, his employees and sub-contractors are expected to perform all logging operations in a safe manner as required by applicable laws and regulations. The Commission expects the Buyer to ensure that logging crewmembers dress in protective attire, and perform their duties with equipment in accordance with standards established by the logging industry and the Occupational Safety and Health Administration (OSHA).

The PGC recommends that logging crews working on State Game Lands be trained in safe logging techniques and sound environmental logging practices through a formal training program such as the one provided by the Pennsylvania Sustainable Forestry Initiative (PA SFI) or another similar program.

Contractor must comply with the erosion and sediment control plan for disturbed areas that is included as a part of the timber contract.

- SPECIAL PROVISIONS -

See 7 Attached Sheet(s).

SPECIAL PROVISIONS FOR THE NEIDERMEYER SALE
S.G.L. # 152 T.S. # 152-2025-01

1) ADMINISTRATIVE ITEMS

- a) This timber sale consists of 4 blocks and has an estimated 230,578 board feet of sawtimber and 971 tons of pulpwood on 90 total treated acres in Cussewago Township, Crawford County.
- b) Logging will be restricted to low ground pressure equipment for this sale, which is defined as equipment applying an average ground pressure of 10 or less pounds per square inch design load. This includes equipment with wide tires (34-72 inches wide), duals, tire tracks, bogeys, or tracked machinery.
- c) All blocks contain advanced regeneration, and caution should be taken to minimize damage. **No fully mechanized equipment will be allowed in any of the 4 blocks.** Prohibited equipment includes grapple skidders, feller bunchers, processors, etc. The Regional Forester or his designee have the right to inspect and reject any equipment they deem inappropriate.
- d) All contractors, subcontractors and consultants of the Buyer must be pre-approved by the Commission. The Commission reserves the right to reject any subcontractor at its sole discretion. If Contractor enters into any subcontract(s) not previously approved by the Commission, the Commission shall have the right to require the Contractor to terminate such contracts.
- e) Logging in Block 4 will be limited to dry or frozen conditions.
- f) **Payment for Block 1 is due at contract signature and execution. Final payment is due no later than 120 days before the expiration of the agreement.**
- g) The Regional Forester or his designee will closely monitor harvest and skidder damage to residual trees. If damage becomes excessive additional restrictions will be placed on the harvest. Total disregard to the residual trees and failure to take corrective actions will result in payment of damages and/or termination of the timber contract.
- h) No whole tree harvesting or on-site chipping is permitted.

2) BOUNDARIES, BLOCKS, AND CUTTING INSTRUCTIONS

- a) Timber sale boundaries are marked by two blue stripes. Gameland boundaries are designated with white blazes.
- b) **All trees marked with yellow paint are to be cut in all blocks. All unmarked trees are reserved and are not to be cut or damaged.**
- c) Snags are to be left standing unless they present a safety hazard. Any reserved trees that are felled for safety reasons must be left at the stump.
- d) Game Land boundary, roads, herbaceous openings and spring runs are to be kept free of tops.
- e) Within a block, cutting of polewood and sawtimber shall proceed in a complete and orderly manner. All cutting in one block must be completed to the satisfaction of the Regional Forester or his designee before commencing operations in a subsequent block.

- f) All stumps must be cut lower than 12" ground height.
- g) Cull portions of the tree are to be left at the stump. All logs and pulpwood are to be marked to length in the woods to eliminate short ends at the landings.
- h) Extra caution should be taken to avoid felling damage or skidding damage to reserved trees.
- i) All top wood 3" in diameter and smaller from all sawtimber trees is reserved and cannot be removed from the site. The tops need to be scattered across the harvest site.
- j) Except for the contractor, no persons shall be permitted to cut or remove firewood.

3) US / STATE / LOCAL ROADS

- a) The contractor will need to use state road SR 98. For information about weight limits and permits, contact the PennDOT District 1 Office at 814-678-7085.
- b) Game Road (T-893) is located in Cussewago Township, Crawford County.
For information contact:

Cussewago Township
23748 N. Mosiertown Road
Saegertown, PA 16433
Phone: 814-763-3322
Email: cussewagotwp@hotmail.com

4) GAME LAND ROADS TO MAINTAIN

Total distance of existing game land roads to maintain is approximately 940 feet.

a) General Road Specs

- 1. The contractor will be required to maintain the gameland roads throughout operations on the sale. This may require application of aggregate to be purchased off site if the contractor damages roads during trucking operations. The Regional Forester or his designee will have final determination if and where material may be needed on the roadways.
- 2. Upon conclusion of use and as directed by the Regional Forester or his designee, all haul roads will be required to be graded. Total distance to grade and maintain is 940 feet. Roads should be smooth and rut-free, with 12-foot running surface or the roadway original width, whichever is wider, and with positive drainage including ditches, broad based dips, and turnouts. Roads must be crowned or sloped, as directed by the Regional Forester or designee, to drain all water into ditches and culverts. Any and all piles of surface sidecast should be graded level by feathering it back into the road berms and/ or road surface during final grading. Road berms should be graded to mow-able contour.
- 3. All treetops and logging debris must be removed from the ditches and road banks along all roads throughout the timber sale area to allow for proper road drainage and future road maintenance.
- 4. Gates are to be kept closed and locked at all times except when the contractor is present on the site.

5. There are existing culverts along the hauling route. These culverts are to be maintained in good working condition throughout hauling operations. The contractor is responsible for damage to culverts resulting from timber operation. The contractor will immediately repair and/ or replace damaged culverts with new black corrugated double- walled smoothbore plastic culvert pipes of equivalent diameter and length as the damaged culvert and will remove damaged culverts from the Game Lands as directed by the Regional Forester or his designee.

b) Road to Block 3 & 4 Landing

1. The operator will be required to improve the existing road for a distance of 210 feet to establish a truck pad prior to logging operations.
2. The contractor will supply and install one (1) 15" diameter x 40-foot smooth bore, double-walled plastic culvert at the entrance to the road. This installation must be coordinated with Cussewago Township Supervisors. A backhoe or excavator will be required to install the culvert. Culvert needed is as follows:

One (1) – 15" diameter by 40' length

The new culvert must be set in a minimum of 4" of compacted 2A gravel. The road surface directly over the culvert must be a minimum of 12 inches deep of compacted 2A aggregate. The remaining 2A aggregate will be tapered into the existing road elevation on either side of the pipe. This will require 22 tons of 2A aggregate. This gravel is not available on the gameland. It must be purchased off-site and delivered to the gameland.

3. The contractor must then supply and install 12' wide geotextile road fabric for a distance of 210 feet beginning at the intersection with Game Road (T-893) and continuing south.
4. The contractor will then be required to apply a total of 220 tons of bank run gravel to the same 210 feet of roadway. A bulldozer will be required to grade and compact the gravel during application to establish the truck pad.

5) LANDINGS

- a) All landings are to be approved by the Regional Forester or his designee. Main landing locations are designated on the sale map. An existing parking area will be utilized as the landing for Block 1.
- b) Logging debris is to be kept to a minimum. All logs and pulpwood are to be marked to length in the woods to eliminate short ends at the landings.
- c) At the conclusion of the sale, all landings are to be leveled and cleared of all debris. The landings for Blocks 2, 3, & 4 are to be seeded according to specifications in Section 7.
- d) The contractor must apply 66 tons of 2A aggregate to the landing for Block 1 to reestablish the parking area at the conclusion of operations in that Block. A bulldozer will required to grade and compact the aggregate.

6) SKIDDING

- a) Skid trails will be designated by the Regional Forester or his designee. Existing trails are to be used for skidding and must be left open and level.

- b) Logging will be restricted to low ground pressure equipment for this sale, which is defined as equipment applying an average ground pressure of 10 or less pounds per square inch design load. This includes equipment with wide tires (34-72 inches wide), duals, tire tracks, bogeys, or tracked machinery.
- c) Logging in Block 4 will be limited to dry or frozen conditions.
- d) Skidders are to be kept off haul roads as much as possible.
- e) If skid trails are to sit idle for one month or more, they are to have water bars added.
- f) Main skid trails are to be leveled, open and have water bars added at the conclusion of the sale.

7) **SEEDING OF ROADWAYS AND LANDINGS**

- a) At the conclusion of the sale, landings for Blocks 2, 3, & 4, the main skid trail to Block 4, and disturbed areas along gameland roads are to be leveled, cleared of rocks and debris and seeded according to the following:

6 lbs. per acre of White Dutch Clover - Inoculated Seed
 10 lbs. per acre of Crimson Clover - Inoculated Seed
 25 lbs. per acre of Wheat or Oats

Lime 4 tons per acre.

Fertilizer - 300 lbs. per acre of 10-20-20

Approximately 1.5 acres are to be seeded at the conclusion of the sale.

- b) Straw mulch will be required at a rate of 2.5 tons per acre or 100 bales per acre.
- c) Regional Forester is to be notified prior to the application of lime, seed, fertilizer, and mulch.
- d) All other bulldozed skid trails are to be seeded with wheat or oats.
- e) Guaranteed catch of cover must be obtained to the satisfaction of the Regional Forester before the bond will be released.

8) **OPERATIONS AND NON-WORK DAYS**

- a) No woods operation will be permitted on the following days:
 1. All Saturdays in the months of September, October, November, December, and January.
 2. All Sundays open to hunting in the months of September, October, November, December, and January.
 3. The opening day and all Saturdays during spring turkey season, including the youth spring gobbler hunt.
 4. The added Sunday of the statewide archery season in November
 5. All the days of the general statewide bear season
 6. The entire 2 weeks of the general firearms deer season
 7. The opening day of the flintlock muzzleloader season

- b) The contractor, employees, and sub-contractors may not hunt to, from, or at the job site when the work location is beyond a gated road that is closed to public traffic. The contractor may travel to and from the work location on no-work days to check on the condition of equipment.
- c) ***Except on Sundays, it is unlawful to be present on State Game Lands from November 15 through December 15 inclusive when not engaged in lawful hunting or trapping and fail to wear a minimum of 250 square inches of daylight fluorescent-orange material on the head, chest, and back combined, or in lieu thereof, a hat of the same colored material. The material shall be worn so it is visible in a 360-degree arc.***

9) **MISCELLANEOUS**

- a) Operator must comply with the erosion and sedimentation control plan for the area.
- b) Extra caution should be taken to avoid felling damage or skidding damage to reserved trees.
- c) All existing trails and at least one main skid trail must be kept open for hunter access in each block.
- d) *Violation of contract provisions by the operator may subject the operator or its employees or contractors to fine based on Title 58 regulations.*
- e) **Payment for Block 1 is due at contract execution.**

10) **FORESTER CONTACT INFORMATION**

Forester Ryan Thompson: (814) 516-2134
 Assistant Regional Forester Mark Kirkwood: (814) 657-1811
 Regional Forester Scott Wolbert: (814) 432-3187 ext. 11181

11) **PA RIGHT TO KNOW PROVISIONS**

CONTRACT PROVISIONS – RIGHT TO KNOW LAW

- a. The Pennsylvania Right-to-Know Law, 65 P.S. §§ 67.101-3104, applies to this contract.
- b. Unless the Contractor provides the Commonwealth, in writing, with the name and contact information of another person, the agency shall notify the Contractor using the Contractor information provided by the Contractor in SRM [or “the legal contact information provided in this contract”] if the agency needs the Contractor’s assistance in any matter arising out of the Right to Know Law (“RTKL”). The Contractor shall notify the agency in writing of any change in the name or the contact information within a reasonable time prior to the change.
- c. Upon notification from the Commonwealth that the Commonwealth requires the Contractor’s assistance in responding to a RTKL request for records in the Contractor’s possession, the Contractor shall provide the Commonwealth, within fourteen (14) calendar days after receipt of such notification, access to, and copies of, any document or information in the Contractor’s possession which arises out of the contract that the Commonwealth requests (“Requested Information”) and provided such other assistance as the Commonwealth may request in order to comply with the RTKL. If the Contractor fails to provide the Requested Information within fourteen (14) calendar days after receipt of such request, the Contractor shall indemnify and hold the Commonwealth harmless for any damages, penalties, detriment or harm that the Commonwealth may incur as a result of the Contractor’s failure, including any statutory damages assessed against the Commonwealth.
- d. The Commonwealth’s determination as to whether the Requested Information is a public record is dispositive of the question as between the parties. Contractor agrees not to challenge the

Commonwealth's decision to deem the Requested Information a Public Record. If the Contractor considers the Requested Information to include a request for a Trade Secret or Confidential Proprietary Information, as those terms are defined by the RTKL, the Contractor will immediately notify the Commonwealth, and will provide a written statement signed by a representative of the Contractor explaining why the requested material is exempt from public disclosure under the RTKL within seven (7) calendar days of receiving the request. If, upon review of the Contractor's written statement, the Commonwealth still decides to provide the Requested Information, Contractor will not challenge or in any way hold the Commonwealth liable for such a decision.

e. The Commonwealth will reimburse the Contractor for any costs associated with complying with this provision only to the extent allowed under the fee schedule established by the Office of Open Records or as otherwise provided by the RTKL if the fee schedule is inapplicable.

f. Contractor agrees to abide by any decision to release a record to the public made by the Office of Open Records, or by the Pennsylvania Courts. The Contractor agrees to waive all rights or remedies that may be available to it as a result of the Commonwealth's disclosure of Requested Information pursuant to the RTKL. Contractor's duties relating to the RTKL are continuing duties that survive the expiration of this contract and shall continue as long as the Contractor has Requested Information in its possession.

LOGGING COSTS FOR THE NEIDERMEYER SALE
S.G.L. # 152

A. ROAD TO BLOCKS 3 & 4		
	Costs for culvert & installation	\$ 1,800
	22 tons of 2A aggregate for culvert installation	\$ 660
	210 feet of 12' wide woven geotextile fabric	\$ 600
	Apply 220 tons of bank run gravel	<u>\$ 5,500</u>
	Sub-Total	\$ 8,560
B. CLEAN-UP		
1,500	Final road grading on SGL roads (940')	\$
	Level and grade skid trails & landings	\$ 3,000
	Apply 66 tons of 2A aggregate to parking area	<u>\$ 2,500</u>
	Sub-Total	\$ 7,000
C. SEEDING (1.5 acres)	Sub-Total	<u>\$ 3,600</u>
	TOTAL	\$ 19,160

The above logging costs are not guaranteed, but they are our best estimate and may vary according to different contractors. The bidder should devise their costs using this sheet for assistance only in formulating their own costs.

Report For Neidermeyer

Sale Name:	Neidermeyer	SGL Number:	152
Forester:	Thompson	Report Date:	06/04/2025
Blocks Numbers in Sale:	1,2,3,4	Acres:	90
County:	Crawford	Township:	Cussewago

The Pennsylvania Game Commission
SGL #152 - Neidermeyer Timbersale
Scribner Rule (BDFT) - All Volumes are Estimates

Sale Summary by Harvest Block														
Block Number	Area		Harvest Type	Sawtimber				Pulpwood				Culls		
	Acres	% of Sale		Method	BDFT	Per Acre	% of Sale	Method	Tons	Per Acre	% of Sale	2 - 4"	6 - 10"	12 +"
1	11	12%	Shelterwood	100% Tally	38,268	3,627	17%	100% Tally	54	5	6%	61	0	3
2	32	36%	Group Selection	100% Tally	127,191	3,920	55%	100% Tally	219	7	23%	322	0	2
3	12	13%	Group Selection	100% Tally	10,043	843	4%	100% Tally	124	10	13%	84	12	2
4	35	39%	Group Selection	100% Tally	55,077	1,586	24%	100% Tally	575	17	59%	392	79	19
Total	90	100%			230,578		100%		971	10.8	100%	859	91	26

The Pennsylvania Game Commission

SGL #152 - Neidermeyer Timbersale

Scribner Rule (BDFT) - All Volumes are Estimates

Block All - 90 acres																									
	10"-12" DBH		14" DBH		16" DBH		18" DBH		20" DBH		22" DBH		24" DBH		26" DBH		28" DBH		30"+ DBH		Sawtimber Totals			Pulpwood	
Species	#TR	VOL	#TR	VOL	#TR	VOL	#TR	VOL	#TR	VOL	#TR	VOL	#TR	VOL	#TR	VOL	#TR	VOL	#TR	VOL	Total Trees	Total Volume	Avg Vol Per Tree	Trees	Tons
Yellow-poplar	2	97	16	1,322	22	3,607	44	9,883	64	20,126	56	23,026	59	29,138	42	23,963	13	9,200	14	10,903	332	131,265	395	67	19
Red Maple	42	2,012	186	13,121	186	20,806	124	19,090	53	10,865	26	7,520	11	3,854	3	1,219	0	0	1	614	632	79,101	125	1,950	801
Black Cherry	2	108	21	1,573	26	3,369	9	1,381	4	782	1	384	0	0	1	324	0	0	0	0	64	7,921	124	73	44
N. Red Oak	1	34	2	185	7	1,088	8	1,590	6	1,665	4	1,537	2	749	0	0	0	0	0	0	30	6,848	228	2	1
Sugar Maple	6	251	8	599	11	1,483	5	722	3	755	1	128	0	0	1	534	0	0	0	0	35	4,473	128	280	74
Yellow Birch	0	0	0	0	0	0	0	0	0	0	0	0	0	0	1	653	0	0	0	0	1	653	653	4	1
American Basswood	0	0	1	71	1	131	0	0	0	0	0	0	0	0	0	0	0	0	0	0	2	202	101	1	1
American Beech	0	0	0	0	1	115	0	0	0	0	0	0	0	0	0	0	0	0	0	0	1	115	115	68	22
Aspen	0	0	0	0	0	0	0	0	0	0	0	0	0	0	0	0	0	0	0	0	0	0	0	14	7
White Ash	0	0	0	0	0	0	0	0	0	0	0	0	0	0	0	0	0	0	0	0	0	0	0	4	2
Total	53	2,502	234	16,871	254	30,599	190	32,666	130	34,192	88	32,596	72	33,742	48	26,692	13	9,200	15	11,517	1,097	230,578	210	2,463	971

The Pennsylvania Game Commission

SGL #152 - Neidermeyer Timbersale

Scribner Rule (BDFT) - All Volumes are Estimates

Block 1 - 11 acres																									
	10"-12" DBH		14" DBH		16" DBH		18" DBH		20" DBH		22" DBH		24" DBH		26" DBH		28" DBH		30"+ DBH		Sawtimber Totals			Pulpwood	
Species	#TR	VOL	#TR	VOL	#TR	VOL	#TR	VOL	#TR	VOL	#TR	VOL	#TR	VOL	#TR	VOL	#TR	VOL	#TR	VOL	Total Trees	Total Volume	Avg Vol Per Tree	Trees	Tons
Yellow-poplar	1	48	9	710	11	1,652	14	2,983	14	4,120	17	6,483	15	7,211	8	4,780	2	1,193	1	831	92	30,012	326	25	7
Red Maple	4	157	5	339	12	1,522	9	1,390	7	1,721	1	135	0	0	0	0	0	0	0	0	38	5,263	139	87	25
N. Red Oak	1	34	1	79	4	615	2	337	3	802	0	0	0	0	0	0	0	0	0	0	11	1,868	170	2	1
Yellow Birch	0	0	0	0	0	0	0	0	0	0	0	0	0	0	1	653	0	0	0	0	1	653	653	2	0
Black Cherry	1	54	2	130	1	146	1	143	0	0	0	0	0	0	0	0	0	0	0	0	5	473	95	2	0
Sugar Maple	0	0	0	0	0	0	0	0	0	0	0	0	0	0	0	0	0	0	0	0	0	0	0	83	20
American Beech	0	0	0	0	0	0	0	0	0	0	0	0	0	0	0	0	0	0	0	0	0	0	0	3	1
Aspen	0	0	0	0	0	0	0	0	0	0	0	0	0	0	0	0	0	0	0	0	0	0	0	2	0
Total	7	294	17	1,257	28	3,935	26	4,853	24	6,643	18	6,618	15	7,211	9	5,433	2	1,193	1	831	147	38,268	260	206	54

The Pennsylvania Game Commission

SGL #152 - Neidermeyer Timbersale

Scribner Rule (BDFT) - All Volumes are Estimates

Block 2 - 32 acres																									
	10"-12" DBH		14" DBH		16" DBH		18" DBH		20" DBH		22" DBH		24" DBH		26" DBH		28" DBH		30"+ DBH		Sawtimber Totals			Pulpwood	
Species	#TR	VOL	#TR	VOL	#TR	VOL	#TR	VOL	#TR	VOL	#TR	VOL	#TR	VOL	#TR	VOL	#TR	VOL	#TR	VOL	Total Trees	Total Volume	Avg Vol Per Tree	Trees	Tons
Yellow-poplar	1	48	5	470	11	1,955	28	6,433	50	16,006	37	15,792	43	21,507	31	17,803	11	8,008	11	8,467	228	96,489	423	32	6
Red Maple	8	373	45	3,306	46	5,487	36	5,854	9	1,898	12	3,820	4	1,153	0	0	0	0	0	0	160	21,891	137	471	170
N. Red Oak	0	0	1	106	3	472	6	1,253	3	863	4	1,537	2	749	0	0	0	0	0	0	19	4,980	262	0	0
Black Cherry	1	54	8	548	9	1,340	4	518	2	489	0	0	0	0	1	324	0	0	0	0	25	3,272	131	25	16
Sugar Maple	0	0	0	0	2	242	0	0	0	0	0	0	0	0	0	0	0	0	0	0	2	242	121	37	7
American Basswood	0	0	1	71	1	131	0	0	0	0	0	0	0	0	0	0	0	0	0	0	2	202	101	1	1
American Beech	0	0	0	0	1	115	0	0	0	0	0	0	0	0	0	0	0	0	0	0	1	115	115	51	18
Aspen	0	0	0	0	0	0	0	0	0	0	0	0	0	0	0	0	0	0	0	0	0	0	0	1	1
Yellow Birch	0	0	0	0	0	0	0	0	0	0	0	0	0	0	0	0	0	0	0	0	0	0	0	2	0
Total	10	475	60	4,500	73	9,742	74	14,059	64	19,256	53	21,148	49	23,409	32	18,127	11	8,008	11	8,467	437	127,191	291	620	219

The Pennsylvania Game Commission

SGL #152 - Neidermeyer Timbersale

Scribner Rule (BDFT) - All Volumes are Estimates

Block 3 - 12 acres																									
	10"-12" DBH		14" DBH		16" DBH		18" DBH		20" DBH		22" DBH		24" DBH		26" DBH		28" DBH		30"+ DBH		Sawtimber Totals			Pulpwood	
Species	#TR	VOL	#TR	VOL	#TR	VOL	#TR	VOL	#TR	VOL	#TR	VOL	#TR	VOL	#TR	VOL	#TR	VOL	#TR	VOL	Total Trees	Total Volume	Avg Vol Per Tree	Trees	Tons
Red Maple	3	162	16	1,066	14	1,435	3	371	3	611	1	225	1	374	1	448	0	0	0	0	42	4,691	112	279	116
Yellow-poplar	0	0	1	71	0	0	2	466	0	0	2	751	1	421	1	290	0	0	2	1,605	9	3,604	400	1	1
Black Cherry	0	0	6	473	7	838	1	143	2	293	0	0	0	0	0	0	0	0	0	0	16	1,747	109	10	7
Sugar Maple	0	0	0	0	0	0	0	0	0	0	0	0	0	0	0	0	0	0	0	0	0	0	0	2	0
Total	3	162	23	1,610	21	2,273	6	980	5	903	3	976	2	795	2	738			2	1,605	67	10,043	150	292	124

The Pennsylvania Game Commission

SGL #152 - Neidermeyer Timbersale

Scribner Rule (BDFT) - All Volumes are Estimates

Block 4 - 35 acres																									
	10"-12" DBH		14" DBH		16" DBH		18" DBH		20" DBH		22" DBH		24" DBH		26" DBH		28" DBH		30"+ DBH		Sawtimber Totals			Pulpwood	
Species	#TR	VOL	#TR	VOL	#TR	VOL	#TR	VOL	#TR	VOL	#TR	VOL	#TR	VOL	#TR	VOL	#TR	VOL	#TR	VOL	Total Trees	Total Volume	Avg Vol Per Tree	Trees	Tons
Red Maple	27	1,320	120	8,411	114	12,362	76	11,476	34	6,635	12	3,341	6	2,327	2	771	0	0	1	614	392	47,256	121	1,113	491
Sugar Maple	6	251	8	599	9	1,241	5	722	3	755	1	128	0	0	1	534	0	0	0	0	33	4,231	128	158	47
Black Cherry	0	0	5	423	9	1,046	3	576	0	0	1	384	0	0	0	0	0	0	0	18	2,429	135	36	20	
Yellow-poplar	0	0	1	71	0	0	0	0	0	0	0	0	0	0	2	1,090	0	0	0	0	3	1,161	387	9	5
Aspen	0	0	0	0	0	0	0	0	0	0	0	0	0	0	0	0	0	0	0	0	0	0	0	11	6
American Beech	0	0	0	0	0	0	0	0	0	0	0	0	0	0	0	0	0	0	0	0	0	0	0	14	3
White Ash	0	0	0	0	0	0	0	0	0	0	0	0	0	0	0	0	0	0	0	0	0	0	0	4	2
Total	33	1,571	134	9,503	132	14,648	84	12,775	37	7,391	14	3,853	6	2,327	5	2,395			1	614	446	55,077	123	1,345	575

The Pennsylvania Game Commission

SGL #152 - Neidermeyer Timbersale

Scribner Rule (BDFT) - All Volumes are Estimates

Block All - 90 acres - Pulp Tree Stand and Stock Table																						
	2" DBH		4" DBH		6" DBH		8" DBH		10" DBH		12" DBH		14" DBH		16" DBH		18" DBH		20"+ DBH		Pulpwood	
Species	#TR	VOL	#TR	VOL	#TR	VOL	#TR	VOL	#TR	VOL	#TR	VOL	#TR	VOL	#TR	VOL	#TR	VOL	#TR	VOL	Total Trees	Total Tons
Red Maple	0	0	0	0	508	68	475	117	468	198	339	228	115	114	26	36	10	18	8	19	1,950	801
Sugar Maple	0	0	0	0	139	17	66	17	54	25	18	13	3	3	0	0	0	0	0	0	280	74
Black Cherry	0	0	0	0	15	2	12	3	14	7	21	17	8	10	3	5	0	0	0	0	73	44
American Beech	0	0	0	0	43	6	10	3	8	3	0	0	4	4	2	3	0	0	1	3	68	22
Yellow-poplar	0	0	0	0	31	2	16	4	14	7	4	3	1	1	1	2	0	0	0	0	67	19
Aspen	0	0	0	0	0	0	3	0	4	1	3	2	3	3	1	1	0	0	0	0	14	7
White Ash	0	0	0	0	0	0	2	0	0	0	1	1	1	1	0	0	0	0	0	0	4	2
N. Red Oak	0	0	0	0	0	0	1	0	0	0	1	1	0	0	0	0	0	0	0	0	2	1
American Basswood	0	0	0	0	0	0	0	0	0	0	1	1	0	0	0	0	0	0	0	0	1	1
Yellow Birch	0	0	0	0	3	0	1	0	0	0	0	0	0	0	0	0	0	0	0	0	4	1
Black Gum	0	0	0	0	0	0	0	0	0	0	0	0	0	0	0	0	0	0	0	0	0	0
Total					739	95	586	145	562	241	388	265	135	136	33	47	10	18	9	21	2,463	971

GIRARD FORM CLASS
SAW TIMBER
BY SPECIES

<u>SPECIES</u>	<u>FORM CLASS</u>	<u>SPECIES</u>	<u>FORM CLASS</u>
Red Oak	83	Tulip & Cucumber	81
Black Oak	81	White Ash	82
White Oak	81	Birch	82
Scarlet Oak	84	Beech	84
Chestnut Oak	80	Hemlock	78
Red Maple	83	White Pine	79
Sugar Maple	81	All Other Hardwoods	79
Black Cherry	83	All Other Softwood	79

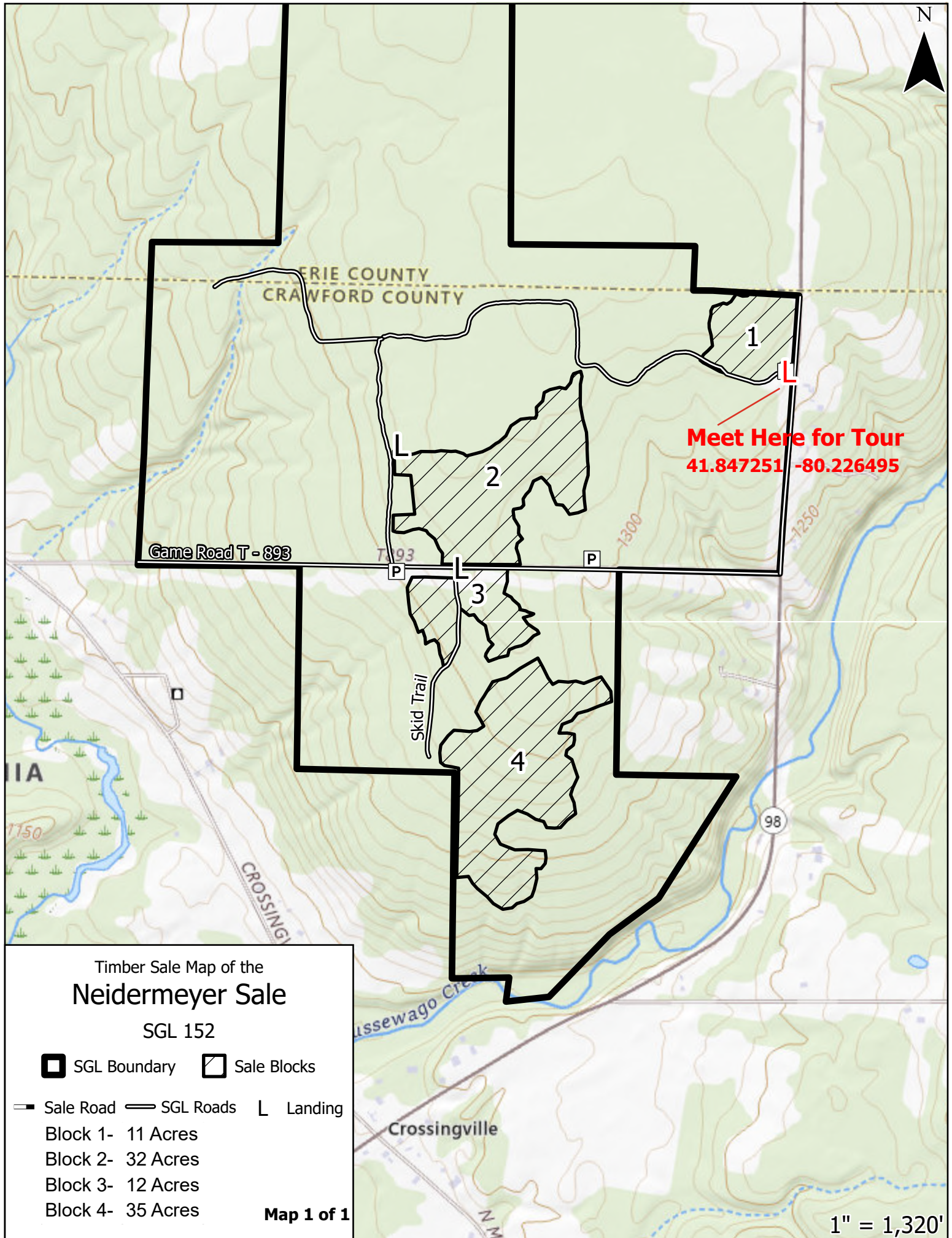

Timber Sale Map of the
Neidermeyer Sale
SGL 152

SGL Boundary Sale Blocks

Sale Road SGL Roads Landing

Block 1- 11 Acres

Block 2- 32 Acres

Block 3- 12 Acres

Block 4- 35 Acres

Map 1 of 1

1" = 1,320'

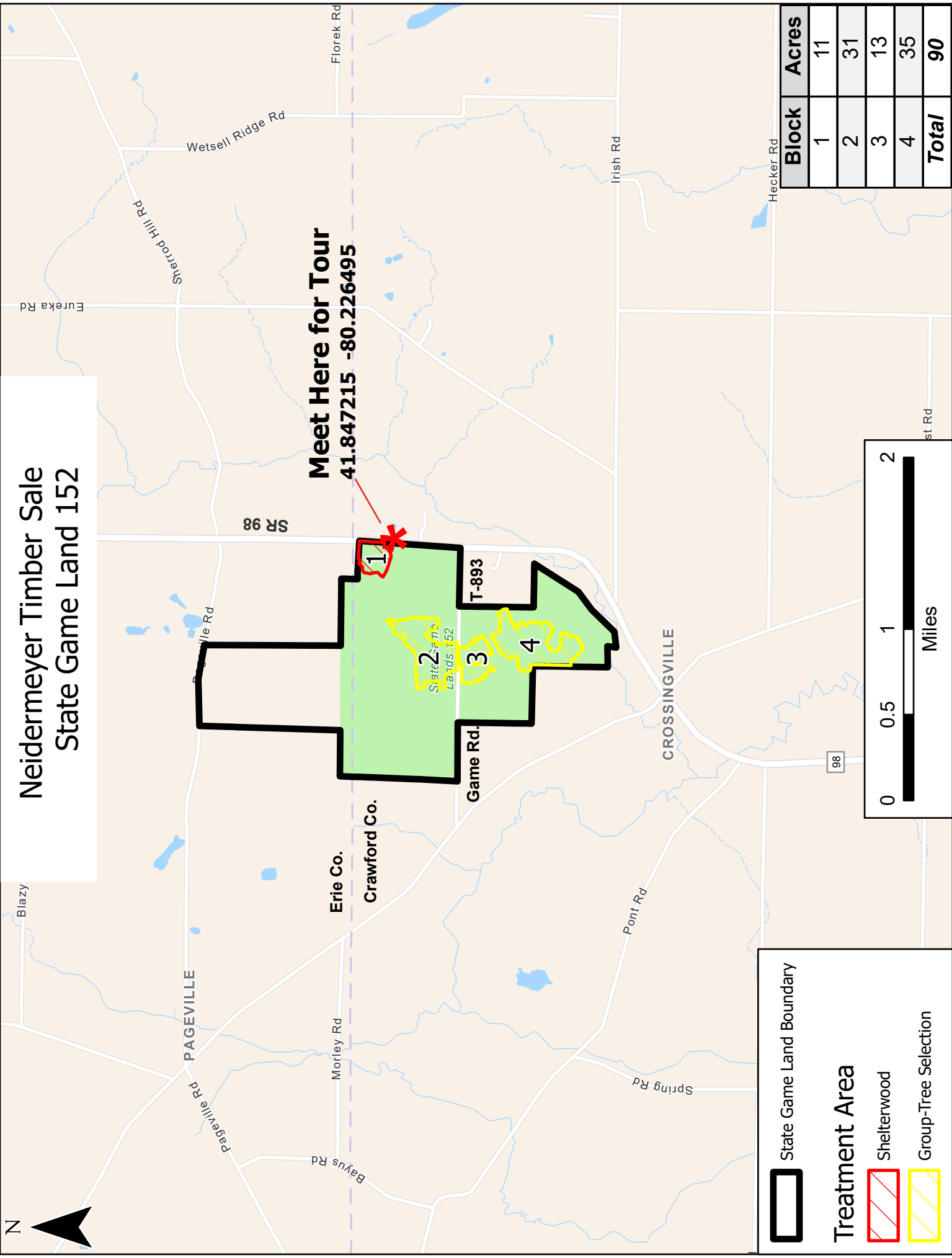

Neidermeyer Timber Sale State Game Land 152

Meet Here for Tour
41.847215 -80.226495

Block	Acres
1	11
2	31
3	13
4	35
Total	90

State Game Land Boundary

Treatment Area

Shelterwood

Group-Tree Selection