

**PRELIMINARY DETOUR ROUTE
SR 1022 (LIBERTY PARK ROAD), SECTION 552
OVER TRIBUTARY TO DUBOIS CREEK
BRIDGE REPLACEMENT PROJECT
LIBERTY TOWNSHIP, SUSQUEHANNA COUNTY
2027 ANTICIPATED CONSTRUCTION**

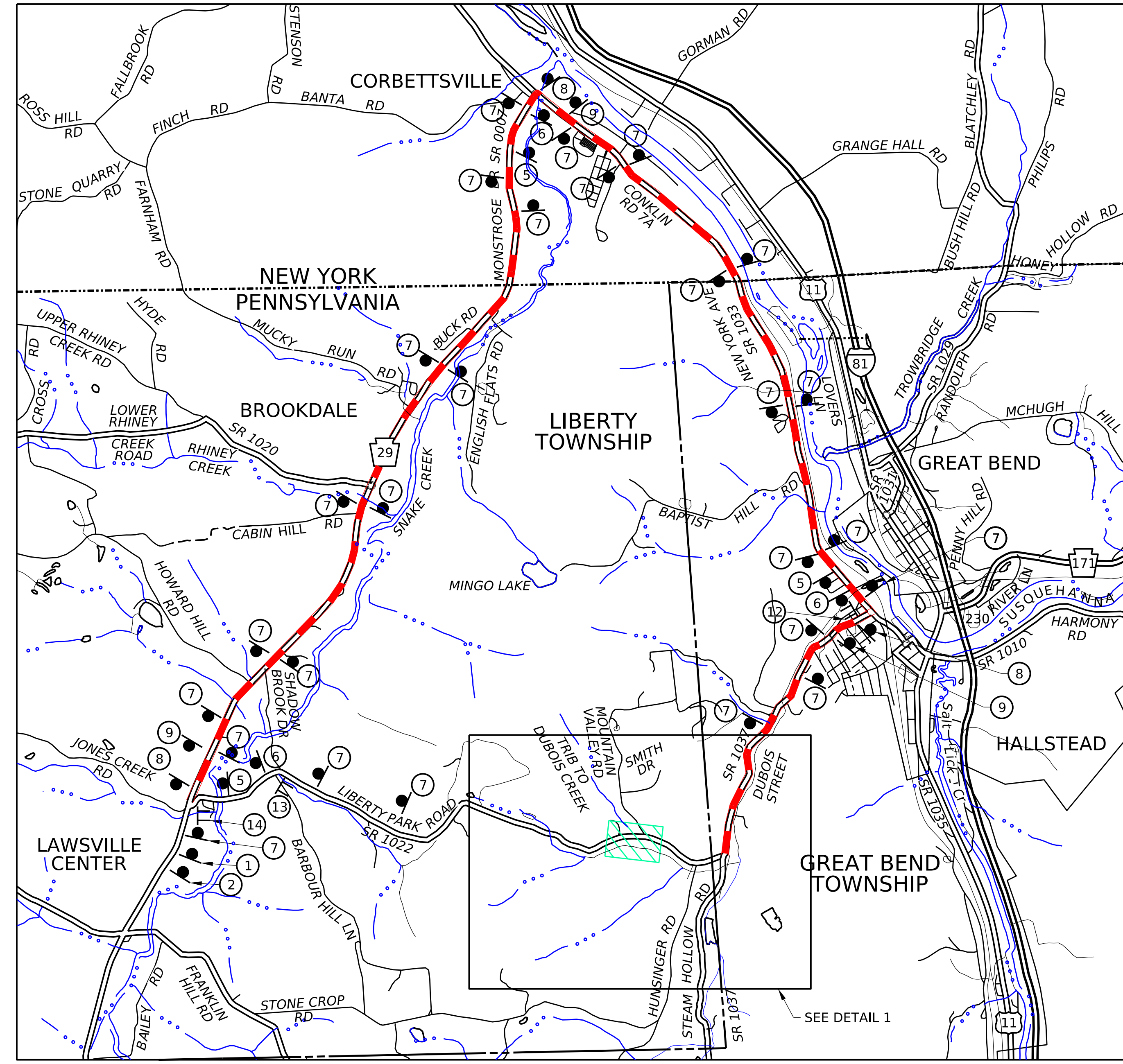

DETOUR MAP

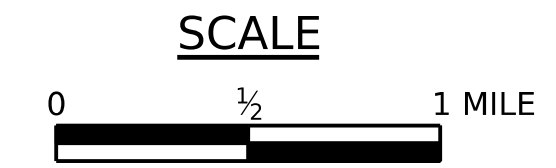

LEGEND

- DETOUR ROUTE (± 11.3 MILES)
- STATE ROUTE
- TOWNSHIP ROAD
- MUNICIPAL BOUNDARY
- STREAM
- STATE BOUNDARY
- CONSTRUCTION WORK ZONE
- TYPE III BARRICADE
- TYPE "B" BREAKAWAY POST
- SIGN IDENTIFIER
- TYPE "B" FLASHING LIGHT

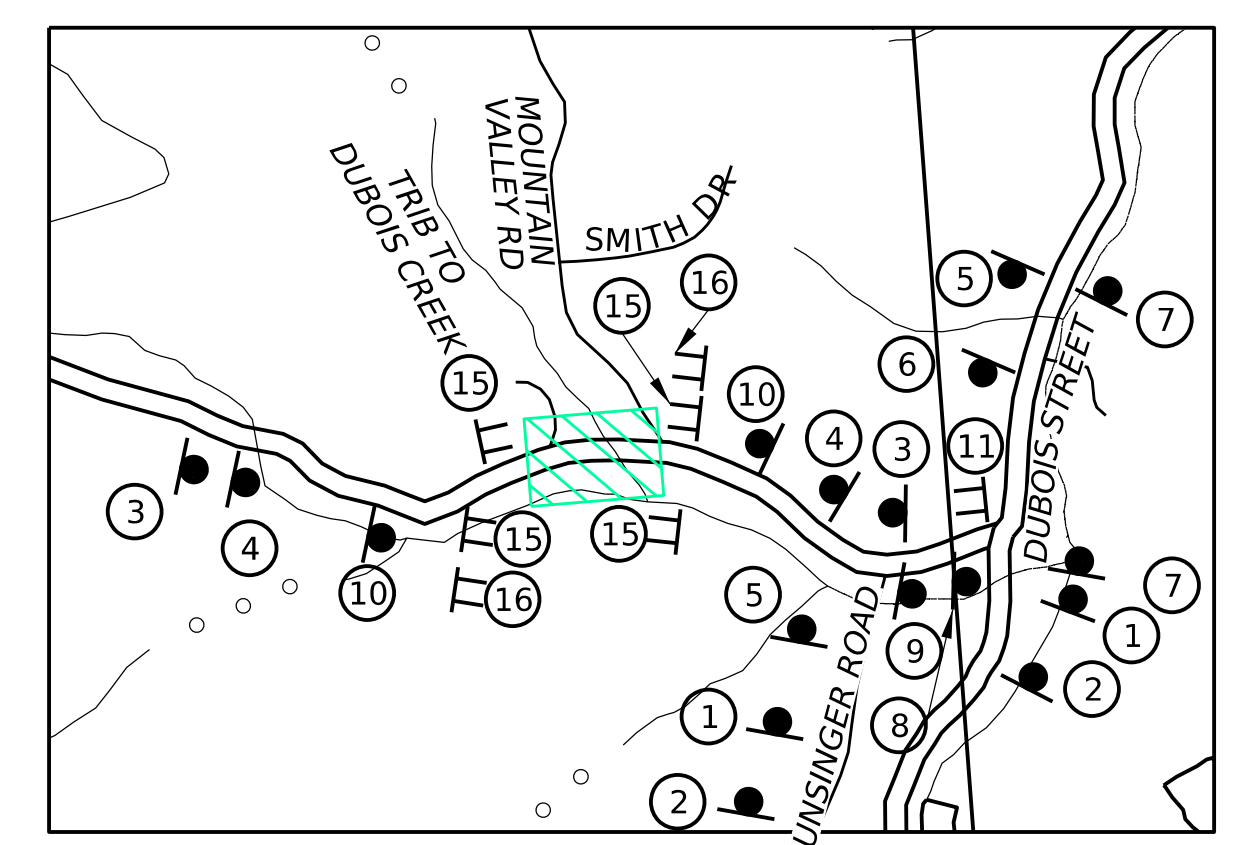
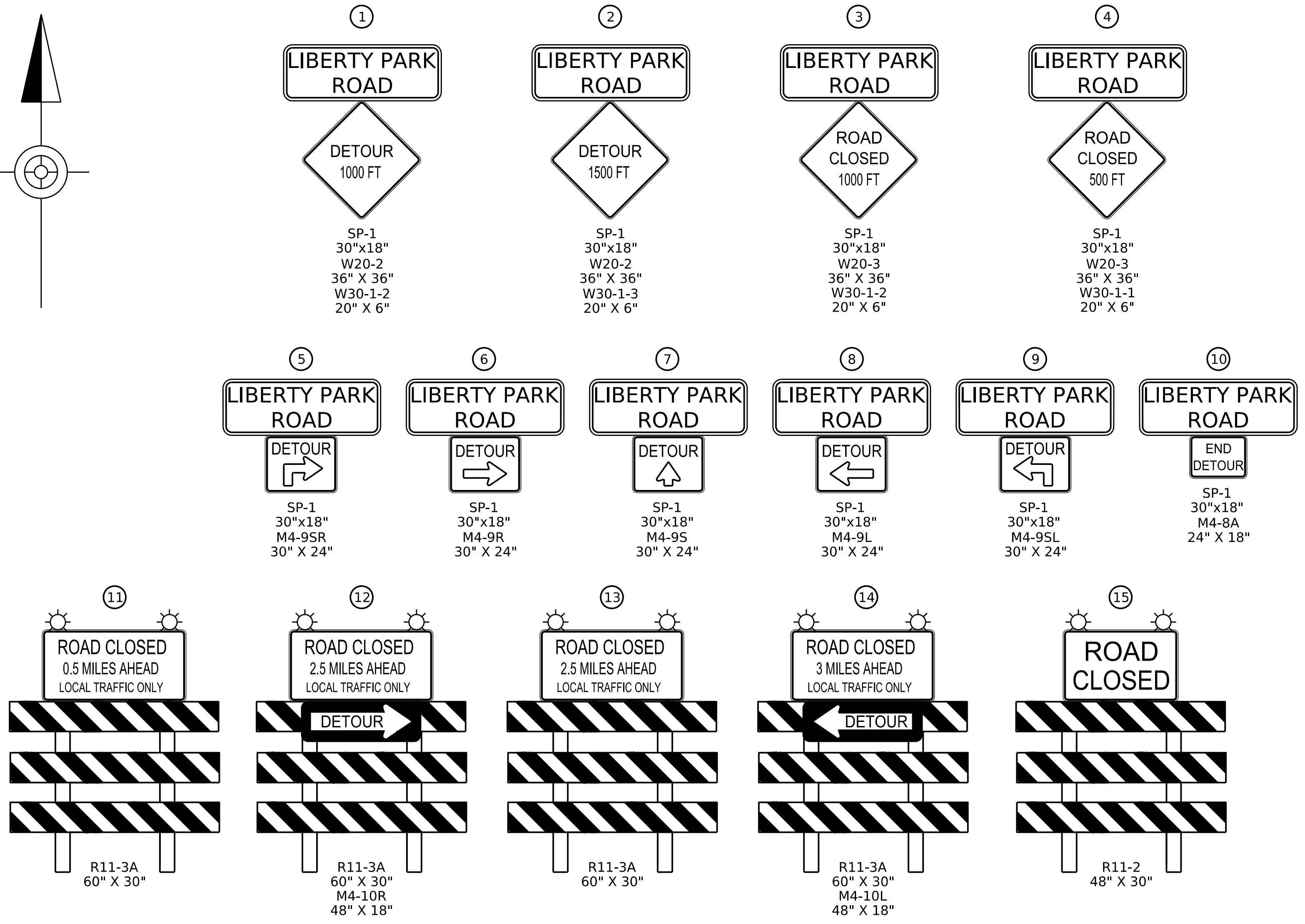
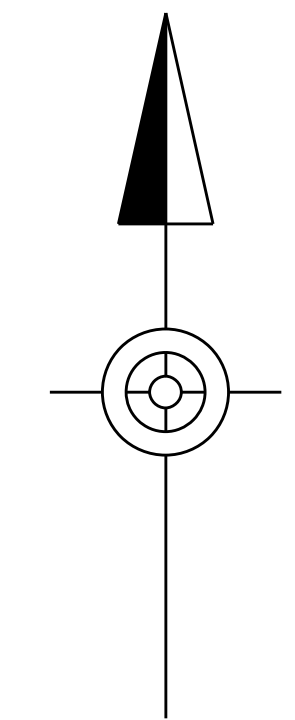

DETAIL 1
SCALE
0 1500 3000 FEET

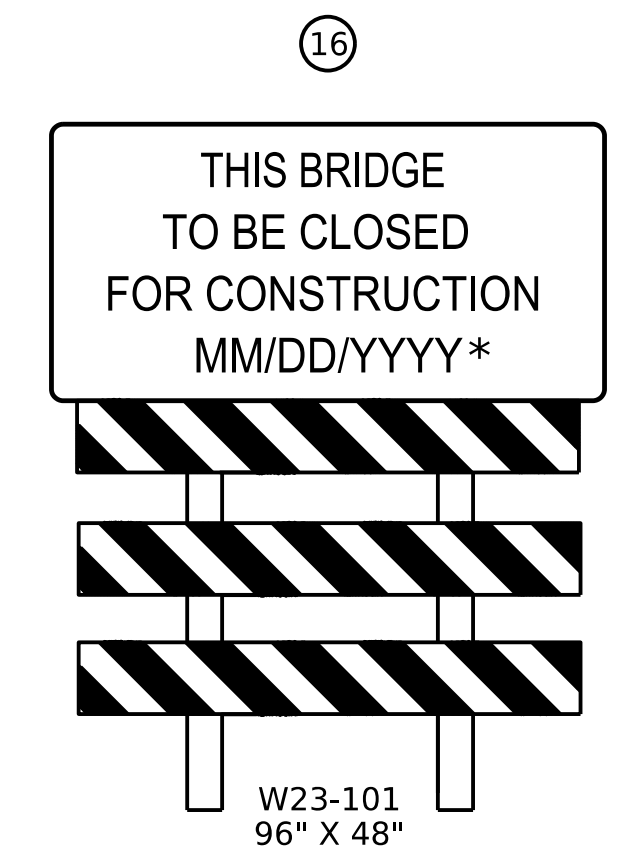

* APPROPRIATE DATE
PLACE W23-101 SIGN IN EACH DIRECTION OF TRAVEL TWO WEEKS (14 DAYS) PRIOR TO CLOSURE.
REMOVE THE W23-101 SIGNS ONCE THE DETOUR/CLOSURE IS IN PLACE. REFER TO PENNDOT PUBLICATION 236.