

SR 4035 (REGISTER ROAD) OVER PINE CREEK HUNTINGTON TOWNSHIP, LUZERNE COUNTY

TRAFFIC WILL BE MAINTAINED VIA A DETOUR ROUTE DURING BRIDGE CONSTRUCTION

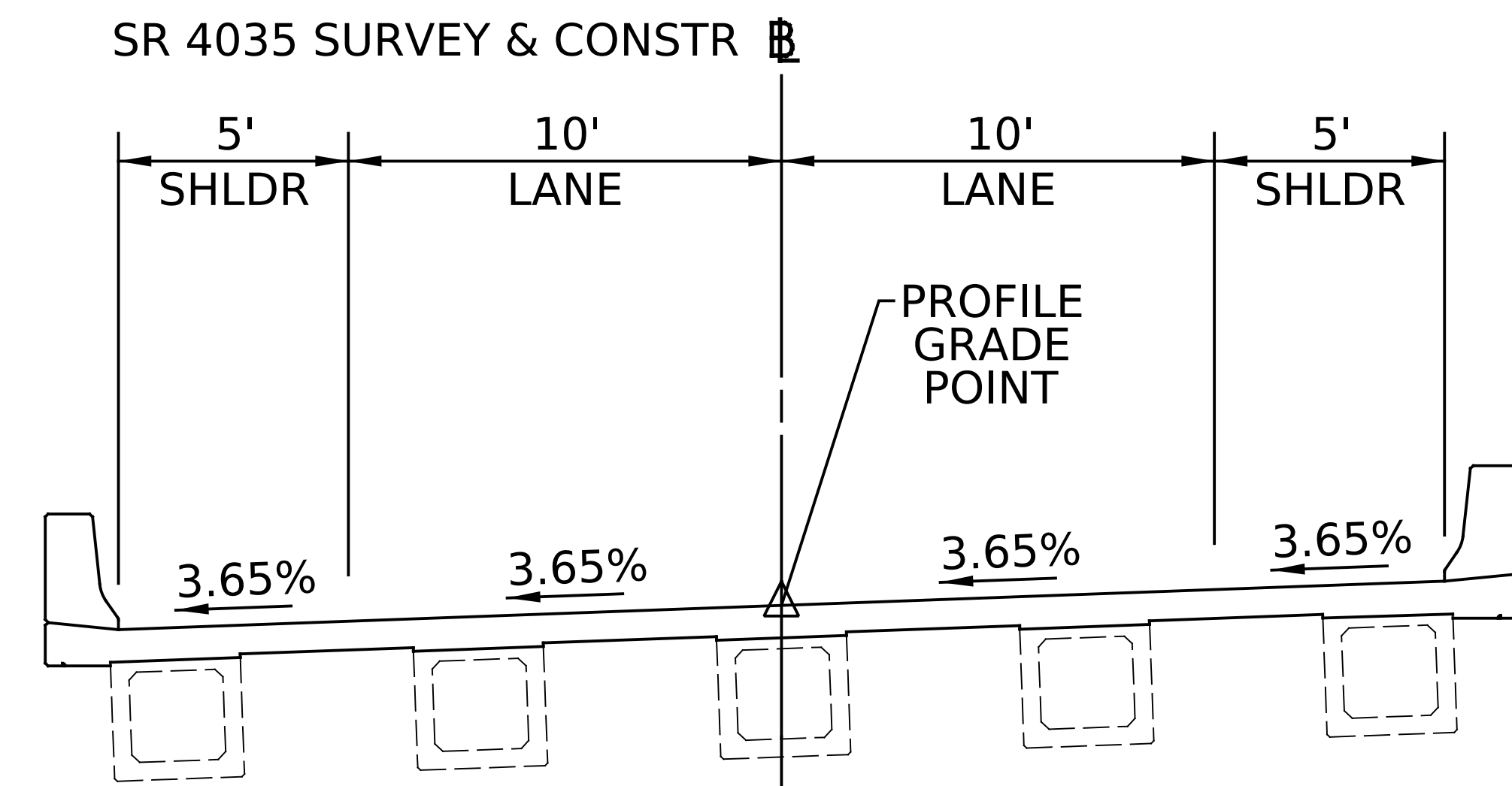
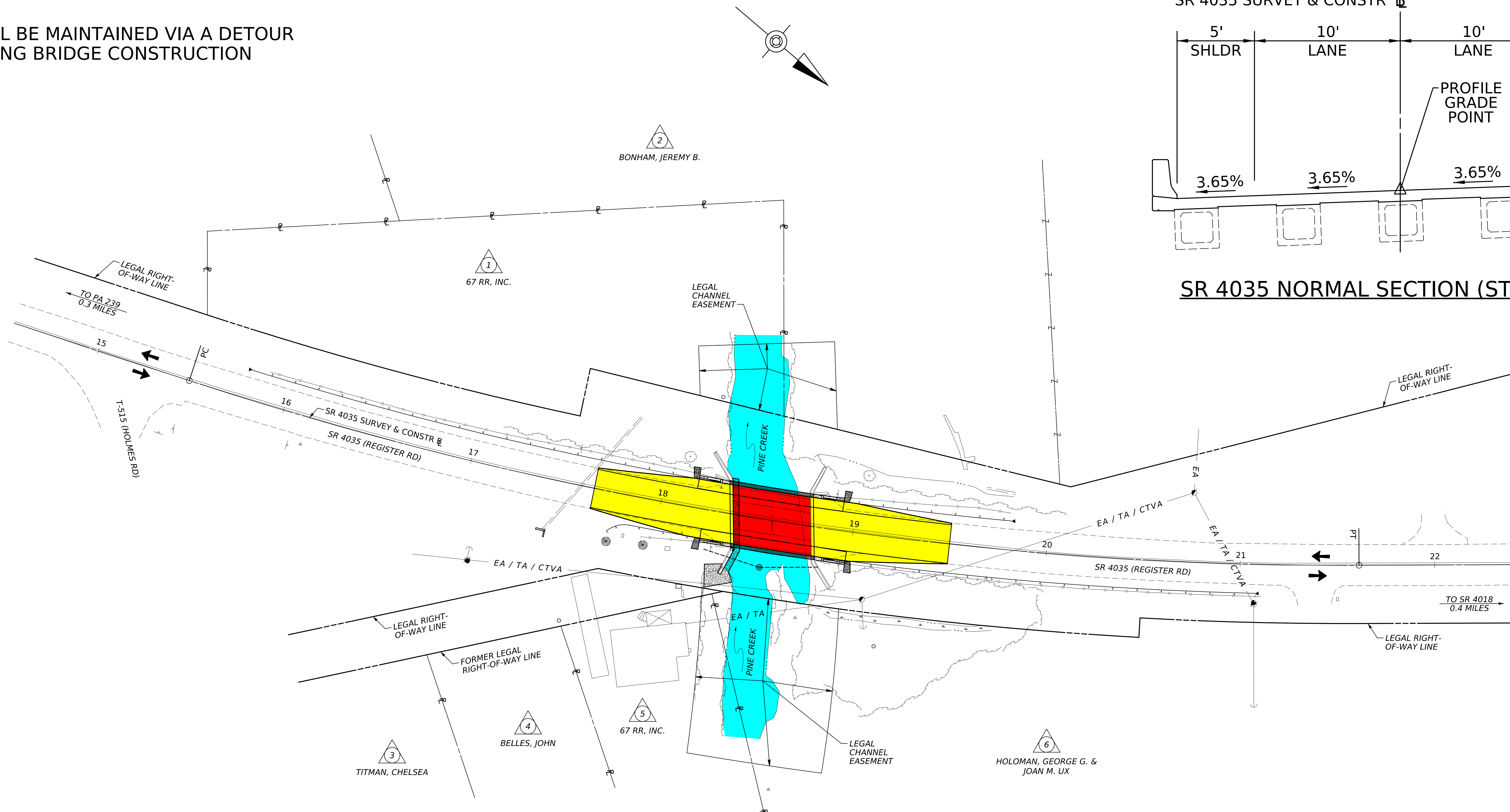

SR 4035 NORMAL SECTION (STRUCTURE)

ANTICIPATED SCHEDULE

FINAL DESIGN	2024
OPEN BIDS	FALL 2025
DETOUR	2026

LEGEND

- PROPOSED BRIDGE
- PROPOSED ROADWAY
- PINE CREEK

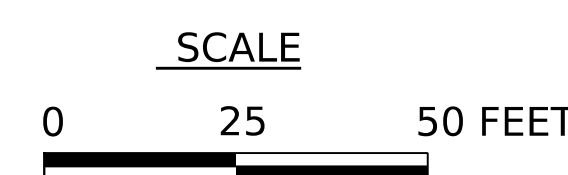

PRELIMINARY