

PROJECT INFORMATION

Brownsville Avenue Bridge
over
Dunlap Creek

Bridge Deck Replacement

Brownsville Borough,
Fayette County



Brownsville Ave Looking North Across Bridge

PROJECT INTRODUCTION



District 12-0

- Stacy Lloyd, P.E. – Project Manager
 - Phone: 724.439.7243
 - Email: stlloyd@pa.gov
- Laina Aquiline – Press Officer
 - Phone: 724.415.3748
 - Email: laquiline@pa.gov

Project Introduction:

- The purpose of the presentation is to introduce the project to the public, gather feedback, and present impacts that will occur due to construction.
- The purpose of the project is to provide a safe and reliable crossing over Dunlap Creek for vehicular and pedestrian traffic.
- The existing bridge structure is in poor condition and has a weight limit of 16 tons.
- The proposed rehabilitation will strengthen the bridge so that the posted weight limit can be removed.



Upstream Elevation View of Bridge



PROJECT LOCATION

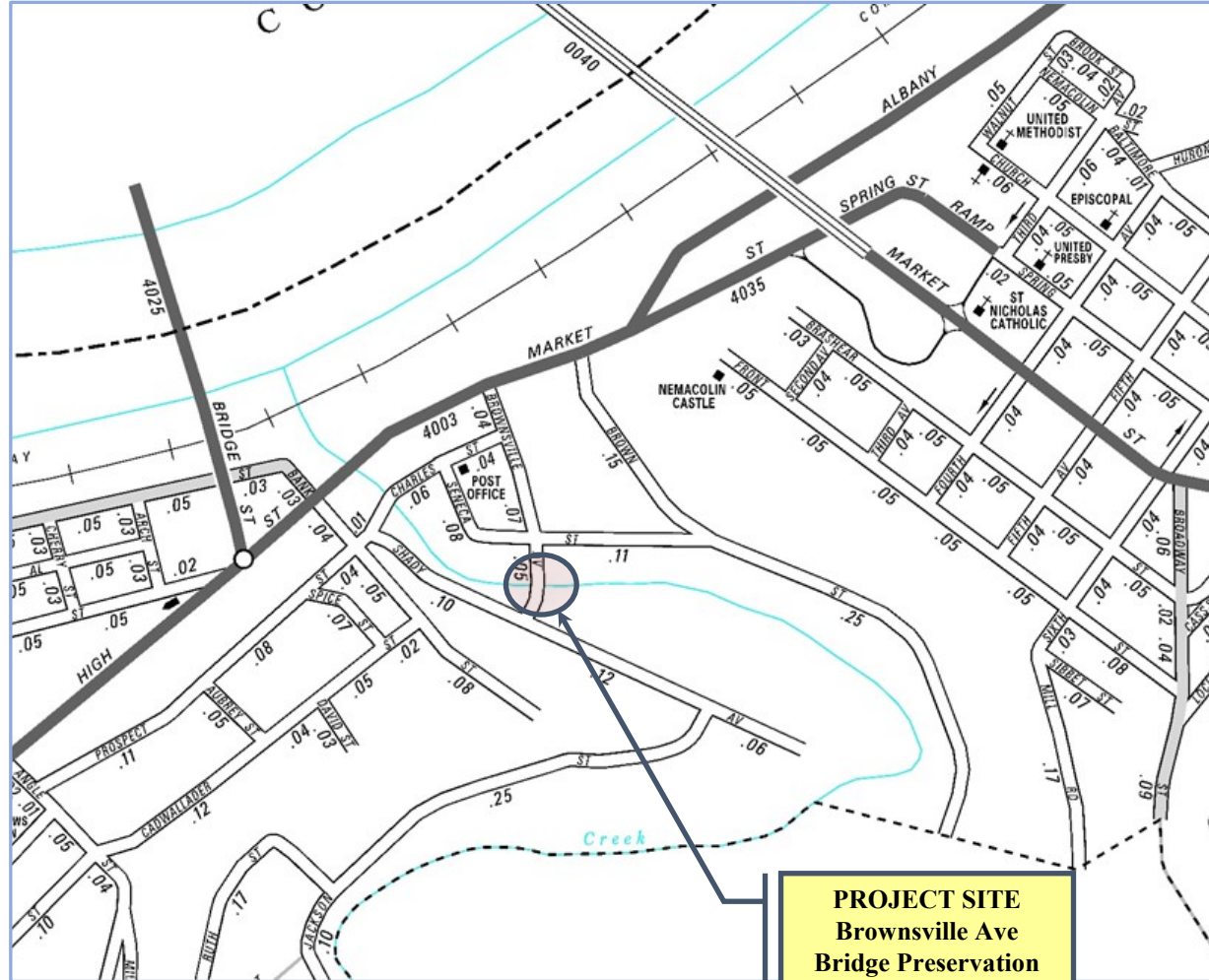

PROJECT SITE
Brownsville Ave
Bridge Preservation
Project over
Dunlap Creek



PROPOSED PROJECT IMPROVEMENTS

- Remove the existing asphalt riding surface, concrete sidewalk and concrete barriers.
- Perform beam repairs.
- Construct a new concrete deck, sidewalk and barriers. The new deck will be made composite with the existing beams to strengthen the bridge.
- Pave the approach roadways from the intersection with Shady Ave to the intersection with Seneca Street.
- Install guide rail on structure approaches.
- The existing roadway width will be maintained. See Typical Section to the right.

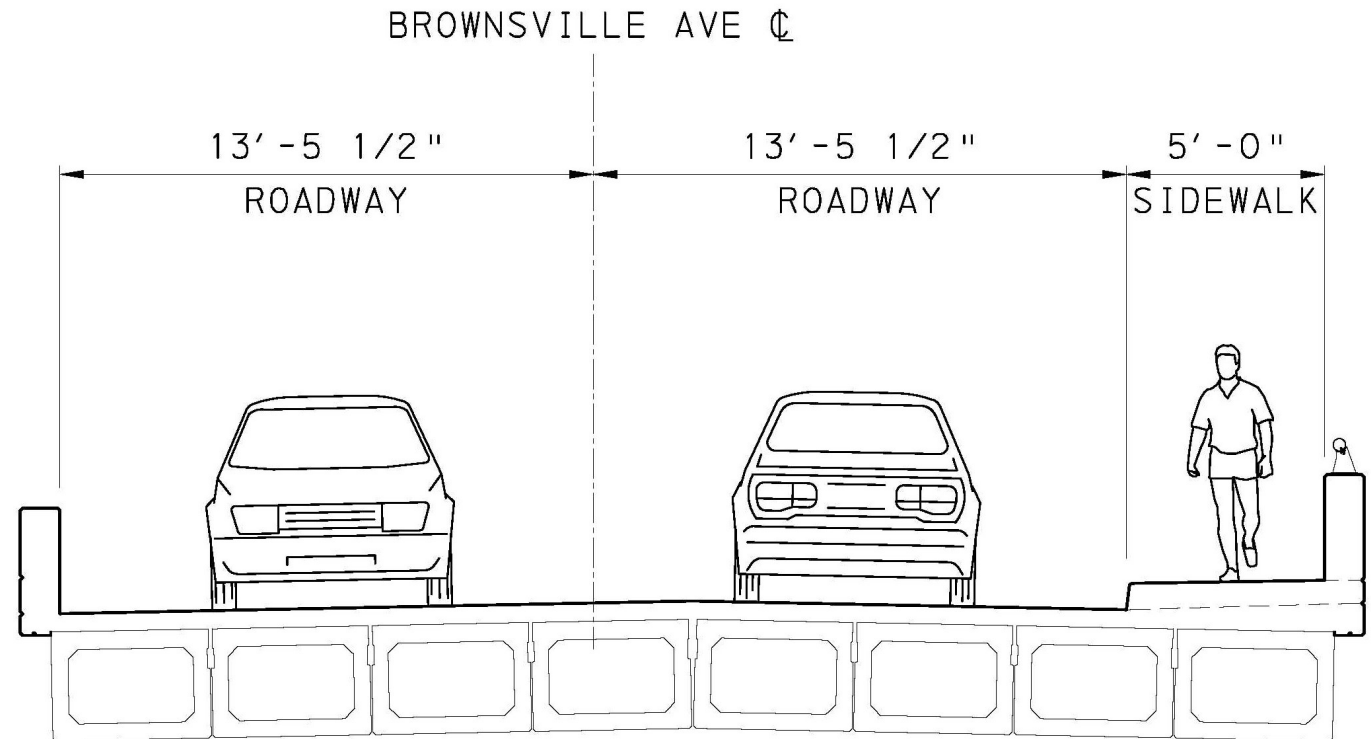

TYPICAL SECTION



PROJECT PLAN VIEW

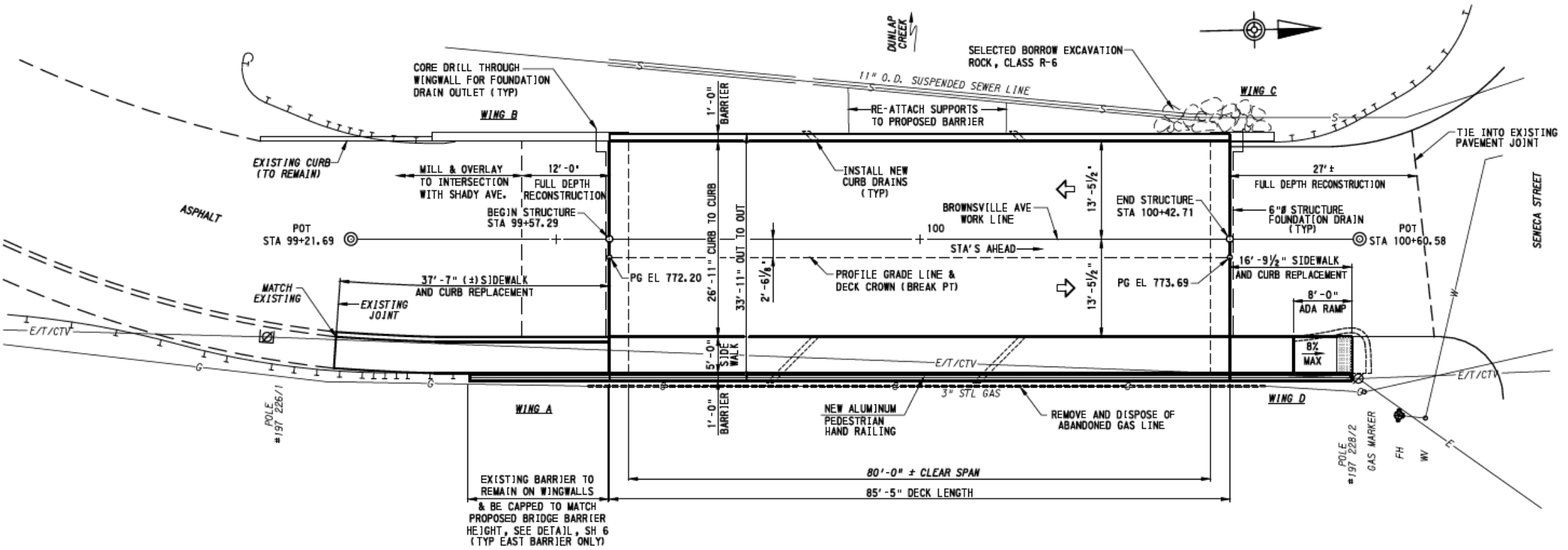

PLAN



PROPOSED TRAFFIC CONTROL

- Traffic will be detoured during construction.
- The detour will utilize Ray Charles Way (AKA - Shady Avenue), Bank Street, and SR 4003 (Market Street).
- The length of the detour is 0.3 miles.
- The SR 4003 (Market Street) bridge, also known as the Cast Iron Bridge, over Dunlap Creek will not be closed until the Brownsville Avenue bridge over Dunlap Creek is open to traffic.
- Charles Street will remain open.

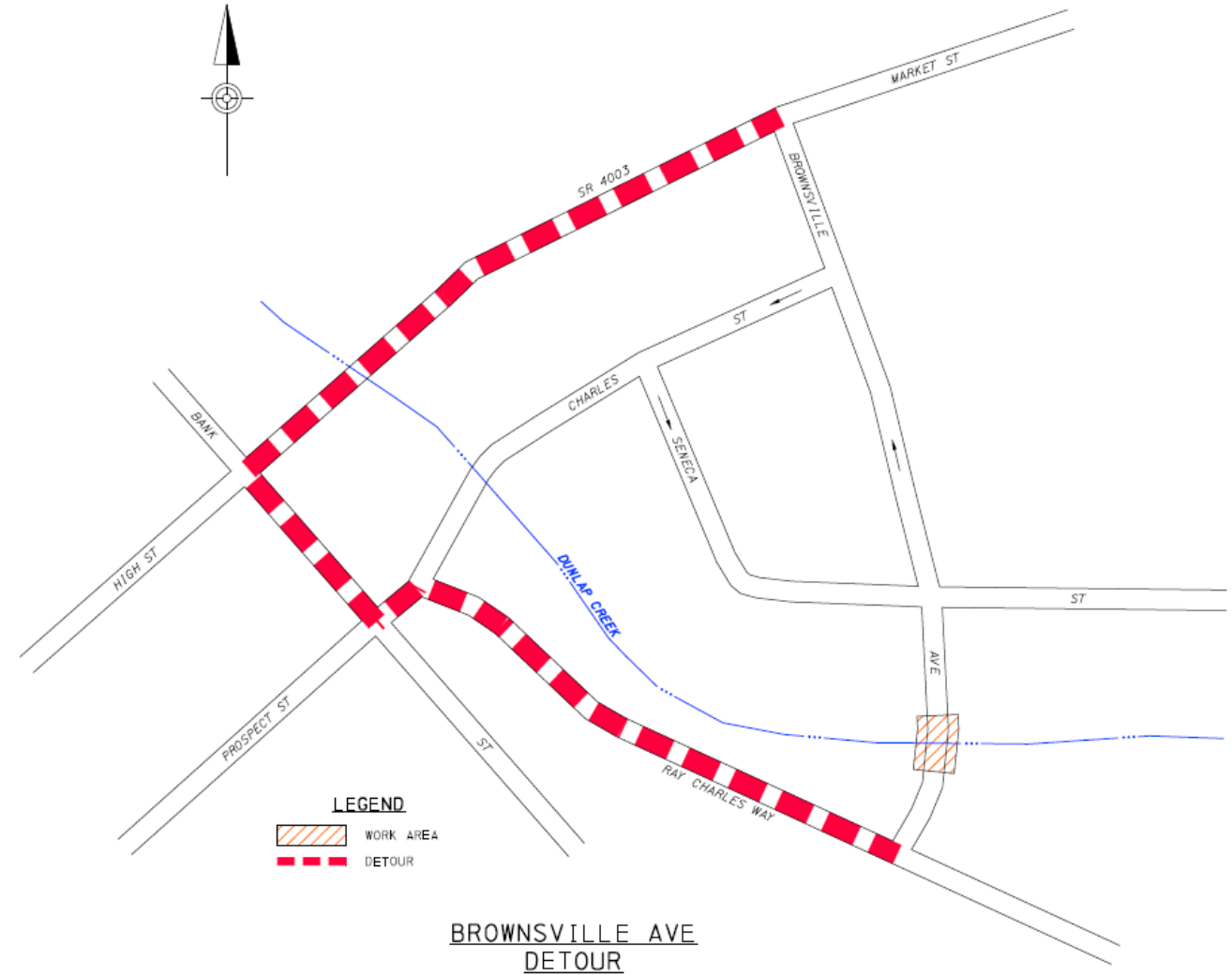

PROPOSED PROJECT SCHEDULE

Design Complete: December 2023

Project Advertisement and Letting: January 2023

Closure of Brownsville Ave: Spring 2024 (Estimated)

Opening of Brownsville Ave: Summer 2024 (Estimated)

Duration of Closure: Approximately 2 to 3 Months



(Dates are Subject to Change)



NATIONAL ENVIRONMENTAL POLICY ACT (NEPA)

Public outreach begins with **PennDOT Connects** and extends into the **NEPA** (National Environmental Policy Act) process:

- NEPA requires agencies to integrate environmental values into their decision-making processes by considering the environmental impacts of their proposed actions and reasonable alternatives to those actions.
- NEPA also includes public involvement activities and gathering feedback from the public.



PROJECT COMMENT FORM

- Please submit comments by following the following directions:
 - Go to the PennDOT website (www.penndot.gov)
 - Click on “Regional Offices” at the top of the screen
 - Click on District 12 on the map of Pennsylvania
 - Click on “Public Meetings/Studies” under the District Links on the right side of the page
 - Click on the “Fayette County” tile
 - Click on the “Dunlap Creek Bridge” tile
 - Click on the “Submit A Comment” link on the right side of the page (see illustration below)

