

Temporary Construction Easement Project Total = 4.24 Acres: An easement to use the land as necessary during construction of the project. The easement is required only until the construction or work indicated by the plan is completed, unless sooner relinquished in writing by The Department.

Slope Easement Project Total = 0.14 Acres: An easement for the support and protection of the highway, including the right to construct, inspect, maintain, repair, reconstruct, and alter drainage facilities and the contour of the land. The easement shall not prevent the property owner from making any legal use of the area which is not detrimental to the necessary support and protection of the highway Right-Of-Way and the safety of the traveling public.

Drainage Easement Project Total = 0.03 Acres: An easement for the construction, inspection, maintenance, repair, reconstruction, and alteration of highway drainage facilities. The easement shall not prevent the property owner from making any legal use of the area which is not detrimental to the necessary flow of water. However, no structure of any kind may be erected in the area, nor may any pipe or ditch be connected to the Department's pipe or ditch without advanced written approval by The Department of Transportation.

Note: Proposed Pavement includes Approximately 200 feet of paving at the southern limits and 400 feet of widening under the new bridge to the northern project limits.

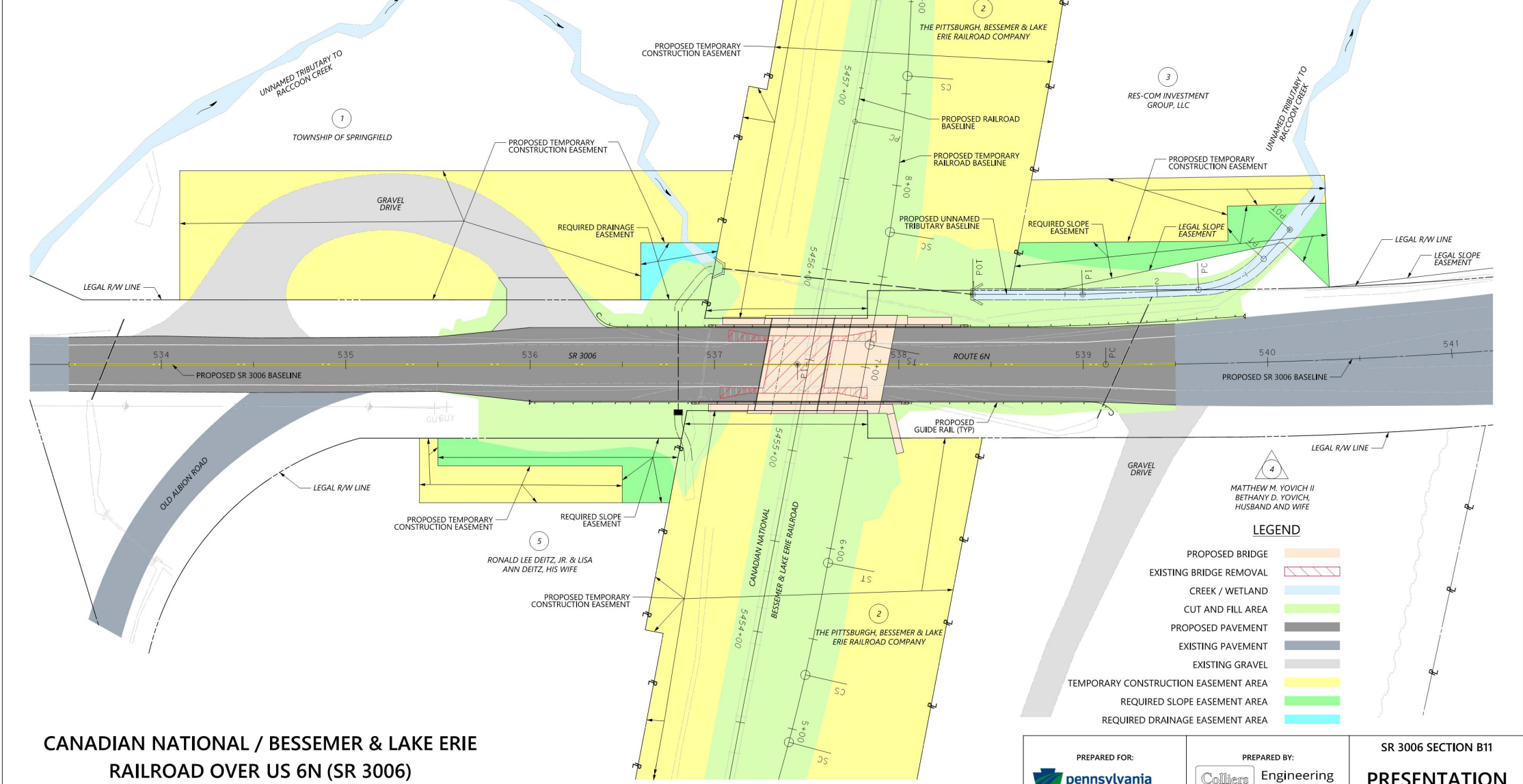

**CANADIAN NATIONAL / BESSEMER & LAKE ERIE  
RAILROAD OVER US 6N (SR 3006)  
BRIDGE REPLACEMENT PROJECT**

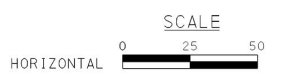

**LEGEND**

- PROPOSED BRIDGE
- EXISTING BRIDGE REMOVAL
- CREEK / WETLAND
- CUT AND FILL AREA
- PROPOSED PAVEMENT
- EXISTING PAVEMENT
- EXISTING GRAVEL
- TEMPORARY CONSTRUCTION EASEMENT AREA
- REQUIRED SLOPE EASEMENT AREA
- REQUIRED DRAINAGE EASEMENT AREA

<p>PREPARED FOR:  <b>pennsylvania</b> DEPARTMENT OF TRANSPORTATION</p> <p>ENGINEERING DISTRICT 1-0 255 ELM STREET, P.O. BOX 398 OIL CITY, PA 16301</p>	<p>PREPARED BY:  <b>Colliers</b> Engineering &amp; Design</p> <p>800 CRANBERRY WOODS DRIVE, SUITE 280 CRANBERRY TOWNSHIP, PA 16066</p>	<p>SR 3006 SECTION B11</p> <p><b>PRESENTATION BOARD 1</b></p> <p>PRELIMINARY PLAN VIEW</p> <p>JULY 2024 SHEET 1 OF 3</p>
--	--	--