

PLOTTED: 12-SEP-2023 10:59

OPERATOR: chnewell
FILE NAME: pw://PDEDPRAPPW01.penn.dot.ctb:Connect_Projects/OpenRoads_Projects/D01/25-Erie/25-4034 S01 (118747)/DESIGN/Roadway/CADD Files/254034S01_PLAN.dgn

DISTRICT	COUNTY	ROUTE	SECTION	SHEET
1-0	ERIE	4034	S01	OF
CITY OF ERIE				
REV NO	REVISIONS	DATE	BY	APPD

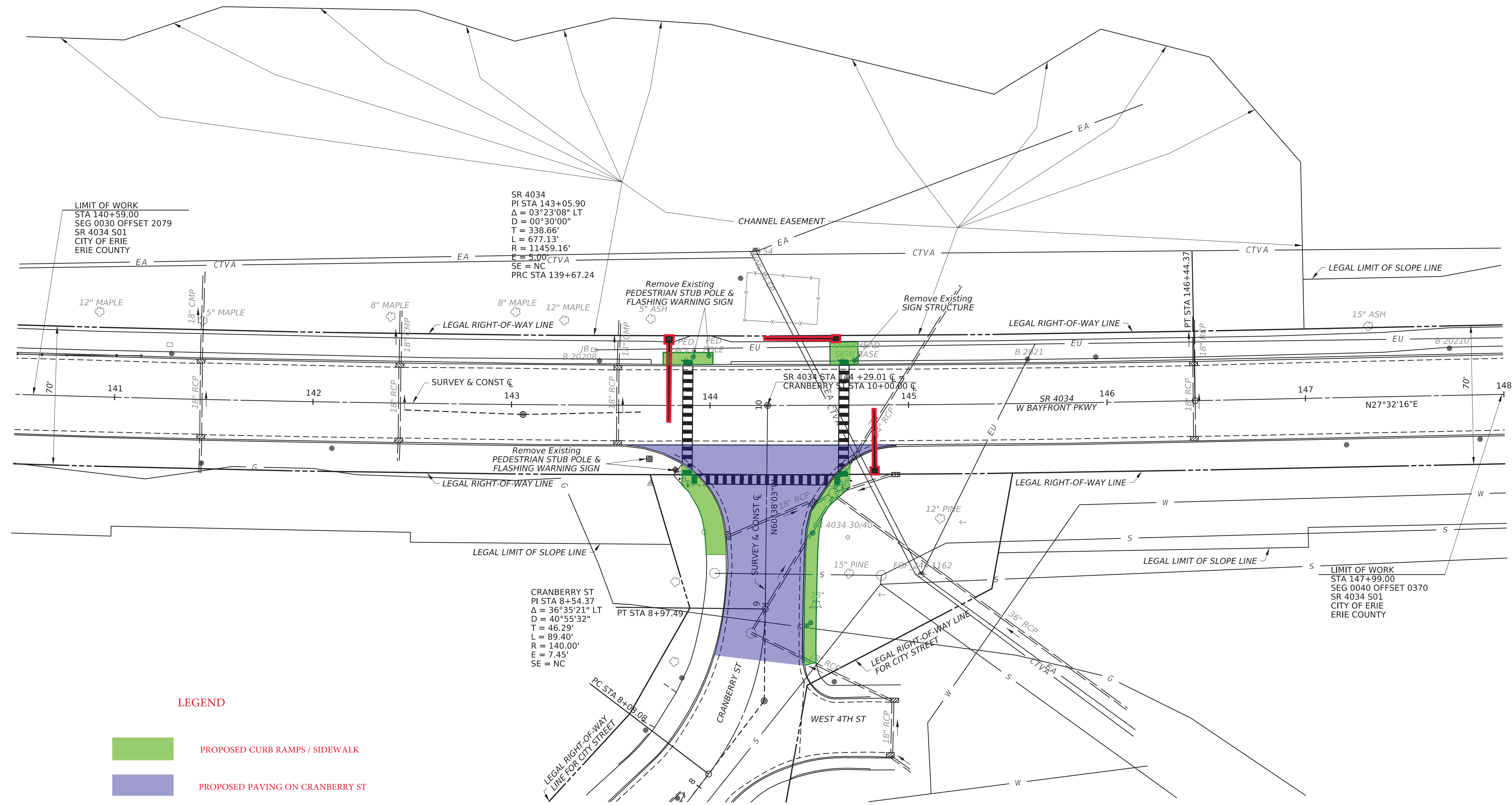
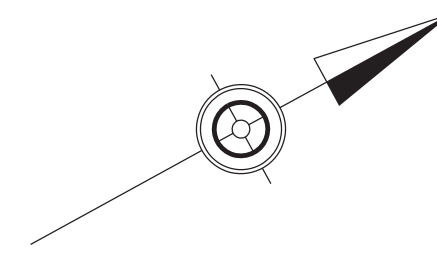

LIMIT OF WORK
STA 140+59.00
SEG 0030 OFFSET 2079
SR 4034 S01
CITY OF ERIE
ERIE COUNTY

SR 4034
PI STA 143+05.90
 $\Delta = 03^{\circ}23'08''$ LT
D = $00^{\circ}30'00''$
T = 338.66'
L = 677.13'
R = 11459.16'
E = 5.00' CTVA
SE = NC
PRC STA 139+67.24

CRANBERRY ST
PI STA 8+54.37
 $\Delta = 36^{\circ}35'21''$ LT
D = $40^{\circ}55'32''$
T = 46.29'
L = 89.40'
R = 140.00'
E = 7.45'
SE = NC

LIMIT OF WORK
STA 147+99.00
SEG 0040 OFFSET 0370
SR 4034 S01
CITY OF ERIE
ERIE COUNTY

LEGEND

- PROPOSED CURB RAMPS / SIDEWALK
- PROPOSED PAVING ON CRANBERRY ST
- PROPOSED TRAFFIC SIGNAL MAST ARM

