

MCKEESPORT-DUQUESNE BRIDGE PRESERVATION

CITY OF MCKEESPORT AND CITY OF DUQUESNE, ALLEGHENY COUNTY

VIRTUAL PUBLIC OFFICIALS AND STAKEHOLDER MEETING



JUNE 10, 2025



AGENDA

☐ Introduction

- Project Team
- Project Location

☐ Project Details

- Project Schedule
- Proposed Project Improvements
- Traffic Phasing
- Right-of-Way Impacts

☐ Question and Answer Session



PROJECT TEAM



PennDOT District 11-0

- Doug Seeley, PE – Assistant District Executive, Design
- Mark Krajcovic, PE – Project Manager
- John Myler – Senior Assistant Construction Manager
- Shane Szalankiewicz, PE – District Bridge Engineer
- Stephanie Zolnak, PE – District Traffic Engineer
- Cheryl Solosky, PE – Senior Project Manager
- Mark Young – District Environmental Planning Manager
- Nicholas Krobot, PE – District Assistant Environmental Manager
- Leigh Anne Crouse, PE – District Business Manager
- Steve Cowan – District Press Officer



AECOM

- Darren Kredel, PE – Project Director
- William Confair, PE – Project Manager
- William Alko, PE – Bridge Structure Project Lead
- Katie Colella, PE – Assistant Bridge Structure Project Lead
- Mark Unger, PE – Traffic Project Lead
- Mike Earl – Assistant Roadway Project Lead

PROJECT LOCATION

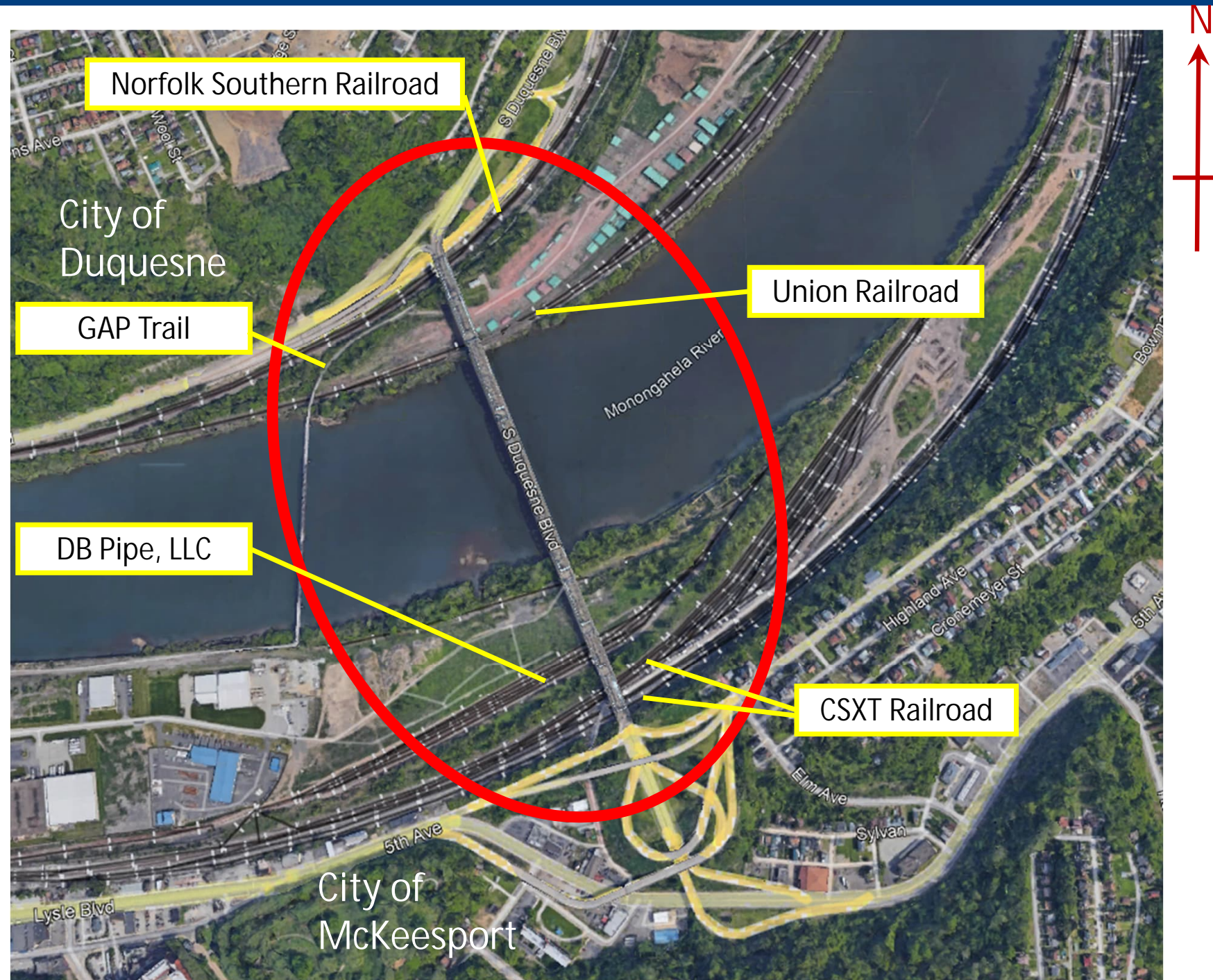

PROPOSED PROJECT IMPROVEMENTS

- ❑ Full Bridge Containment, Cleaning, and Painting
- ❑ Repairs
 - Retrofitting/repairing various steel members
 - Concrete barrier repairs
 - Pier and abutment repairs
- ❑ Deck Overlay
 - Scarification and hydrodemolition
 - Protective concrete overlay
- ❑ Expansion Joints
 - Replace tooth expansion joints with strip seals
 - Replace compression seals with strip seals



Note: No impacts to the GAP Trail are Anticipated

PROPOSED PROJECT IMPROVEMENTS

- ☐ Bridge Jacking and Bearing Replacements
 - Replace existing rocker bearings
 - Replace existing roller nest bearings
 - New disc bearings
- ☐ Downspouts and Scuppers
 - Replace downspouts
 - Clean and flush existing drainage system
- ☐ Fencing Upgrades
- ☐ Lighting Upgrades
- ☐ New Approach Slabs
- ☐ Sign Structures
 - Eliminate Existing Sign Structure in Span 1
 - New Signs/Structures in Span 4 and Span 6



Note: No impacts to the GAP Trail are Anticipated

PROPOSED PROJECT IMPROVEMENTS

- ☐ Duquesne Side Approach Widening
 - Widening to west (outside of curve)
 - Improve turning movements on approach
- ☐ Ramp J Widening (McKeesport Side)
 - Widening to south (outside of curve)
 - Improve turning movements on approach
- ☐ Median Barrier Replacement
 - New Impact Attenuators
- ☐ ADA Curb Ramps
 - New curb ramps at Duquesne side west sidewalk
- ☐ Signs and Pavement Markings
 - New signs, delineators, and pavement markings to improve safety

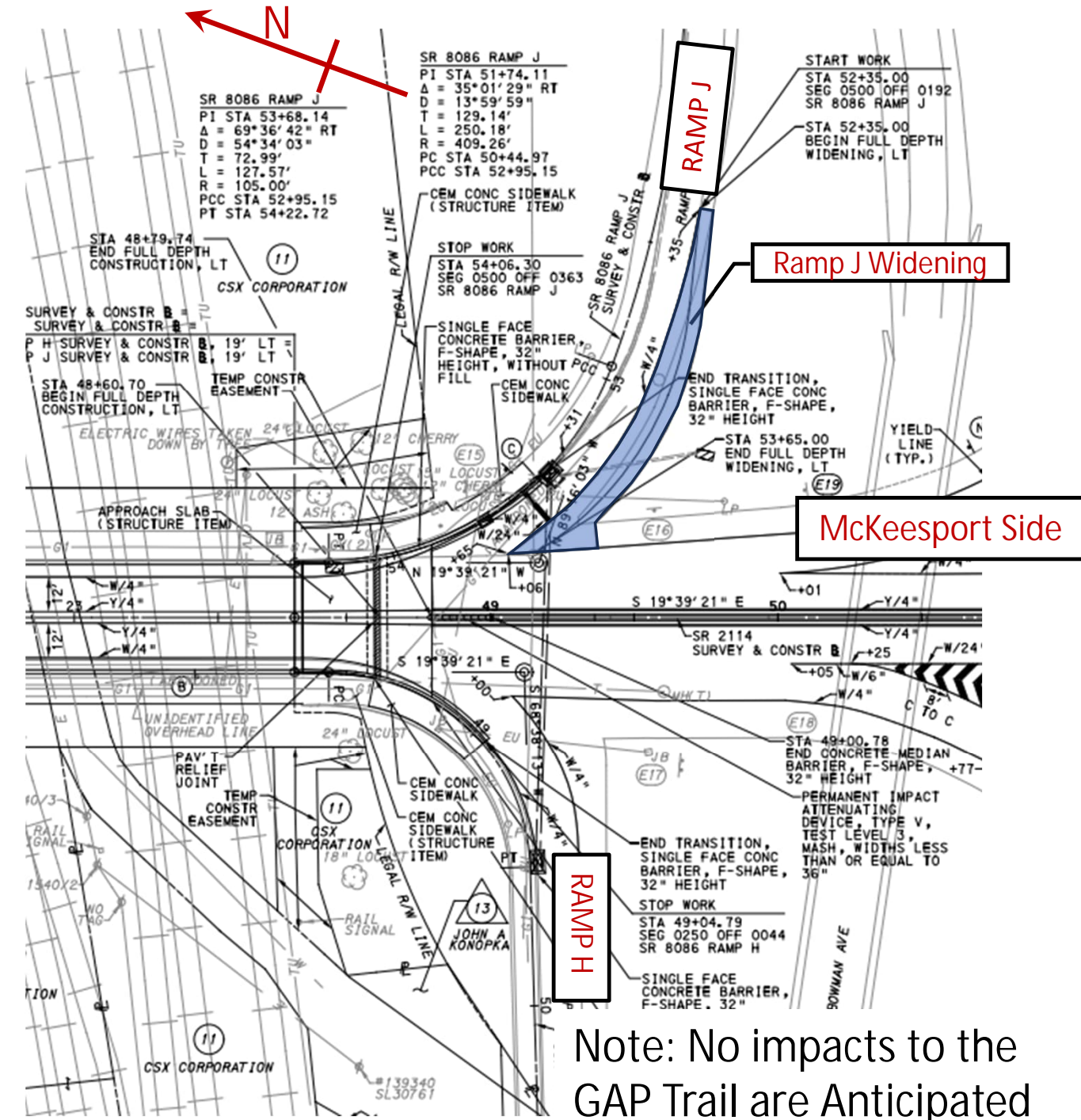

PROPOSED PROJECT IMPROVEMENTS

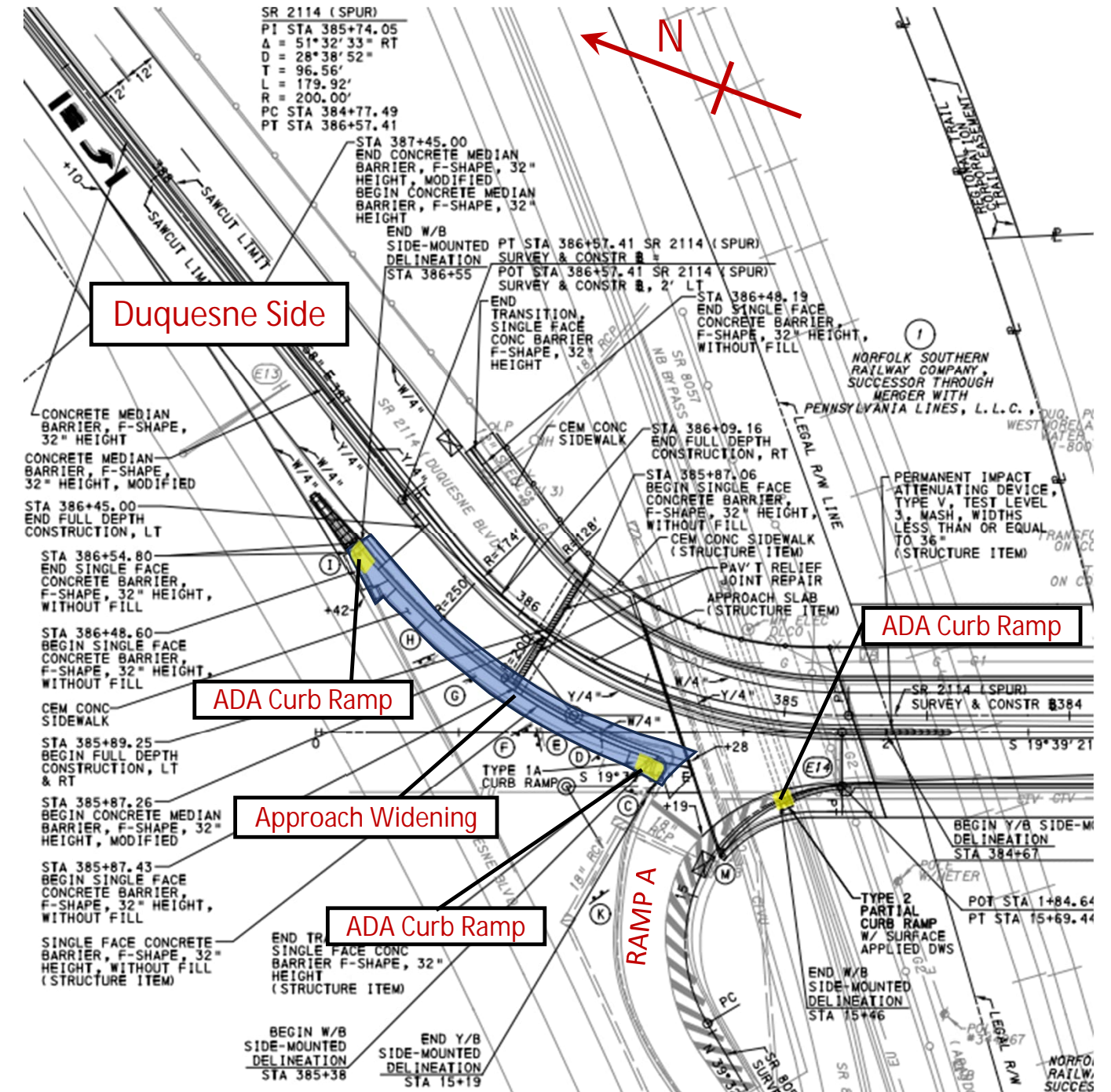

Note: No impacts to the
GAP Trail are Anticipated

PROJECT SCHEDULE

Anticipated Project Schedule																																					
Traffic Control	2026												2027												2028												
	Jan	Feb	Mar	Apr	May	Jun	Jul	Aug	Sep	Oct	Nov	Dec	Jan	Feb	Mar	Apr	May	Jun	Jul	Aug	Sep	Oct	Nov	Dec	Jan	Feb	Mar	Apr	May	Jun	Jul	Aug	Sep	Oct	Nov	Dec	
Phase 1A																																					
Phase 1B																																					
Phase 2 Closure and Detour																																					
Phase 2 Project Closeout																																					

☐ Phase 1A

- Painting, Steel Repairs, Concrete Repairs, Bearing Replacements

☐ Phase 1B

- Painting, Steel Repairs, Concrete Repairs, Bearing Replacements, Fencing

☐ Phase 2 Closure and Detour

- Protective Concrete Overlay, Deck Joint Replacements, Approach Roadway and Ramp J Widening

☐ Phase 2 Project Closeout

- Line Painting, Signing, Punchlist items, Project Cleanup

- The anticipated project construction cost is \$63M
- Note: The project schedule and construction cost are tentative and depends on the contractor means and methods.

TRAFFIC PHASING

☐ Phase 1A

- Two 12' lanes shifted east (downstream)
- West Truss Painting/Steel Repairs/Bearings

☐ Phase 1B

- Two 12' lanes shifted west (upstream)
- East Truss Painting/Steel Repairs/Bearings
- Duquesne-Light Utility Upgrades

☐ Short Term Detours

- Remove median barrier
- Temporary deck joints at Piers 2, 7, & 8
- Full width deck joints at Piers 2, 7, & 8

☐ Ramp A Closed and Detoured

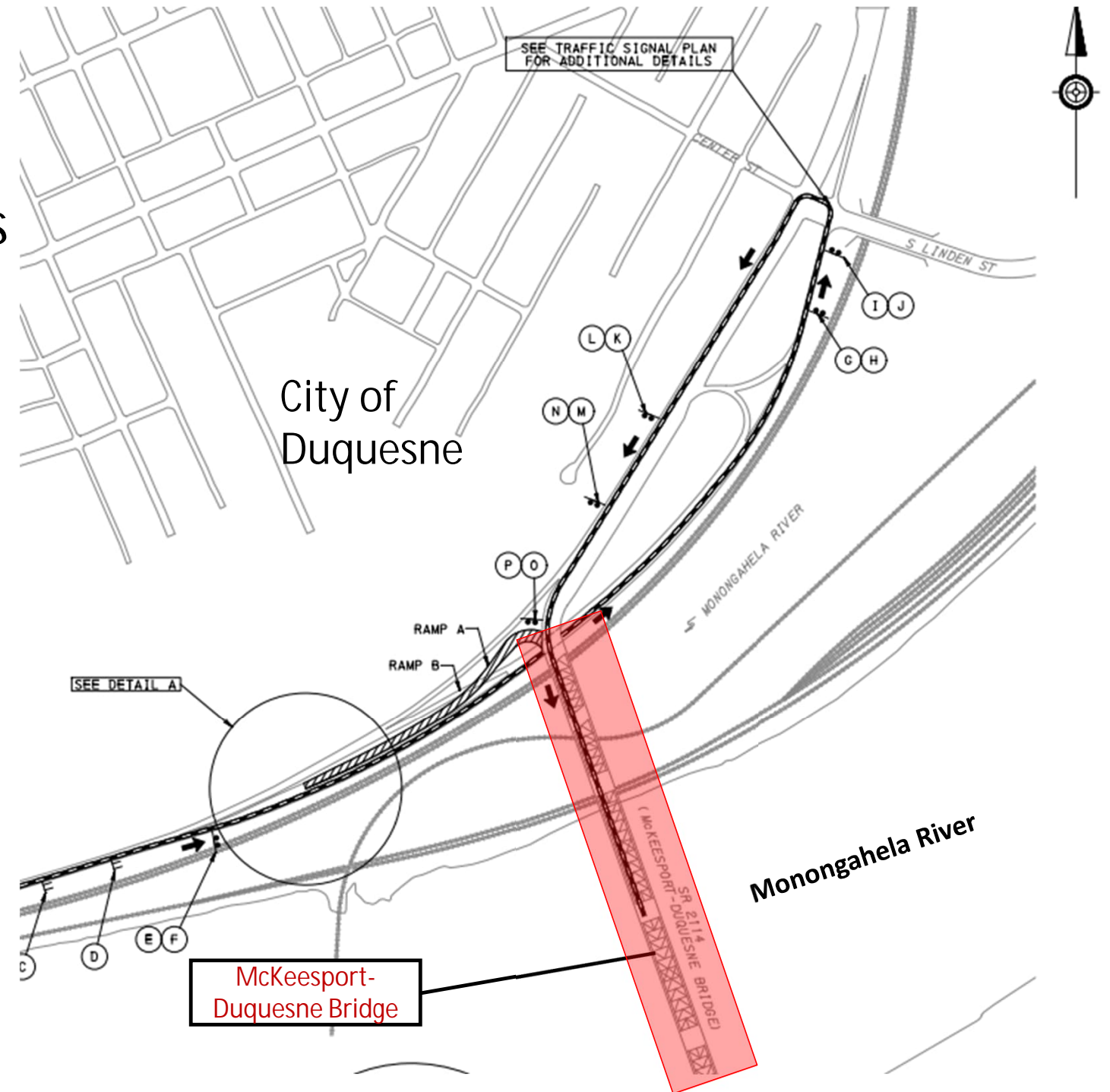

TRAFFIC PHASING

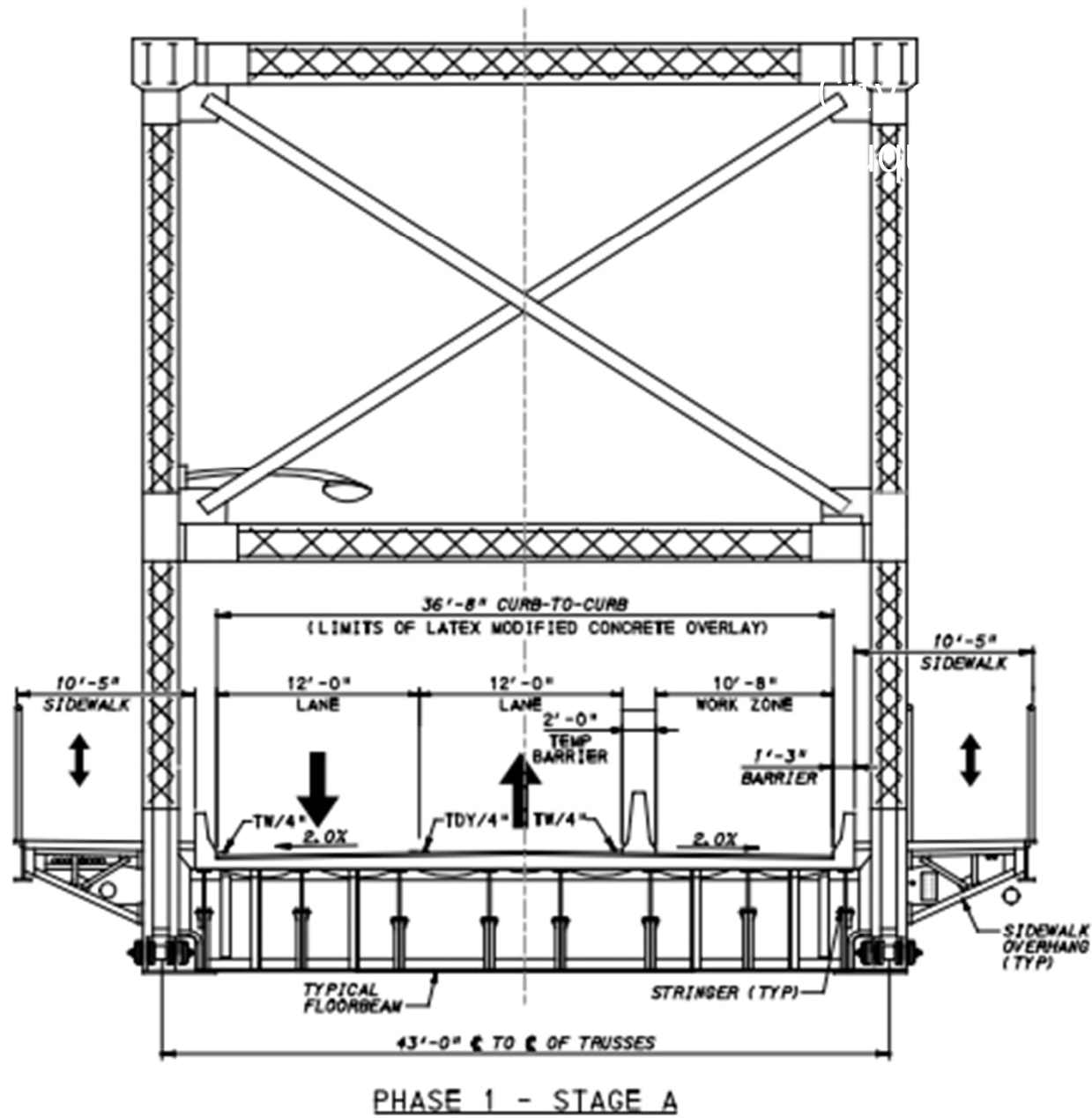

East
Truss

West
Truss

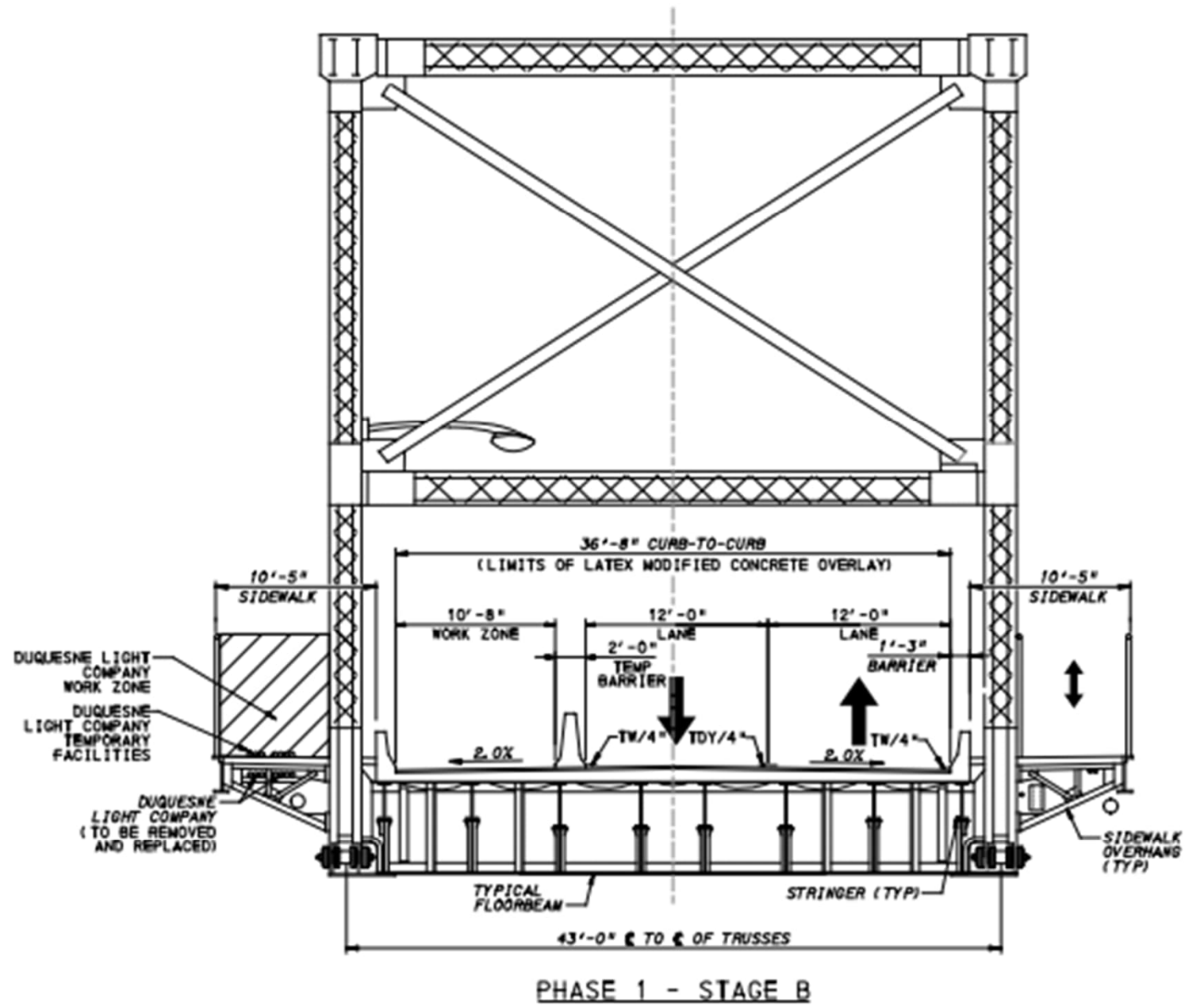

East
Truss

West
Truss



TRAFFIC PHASING

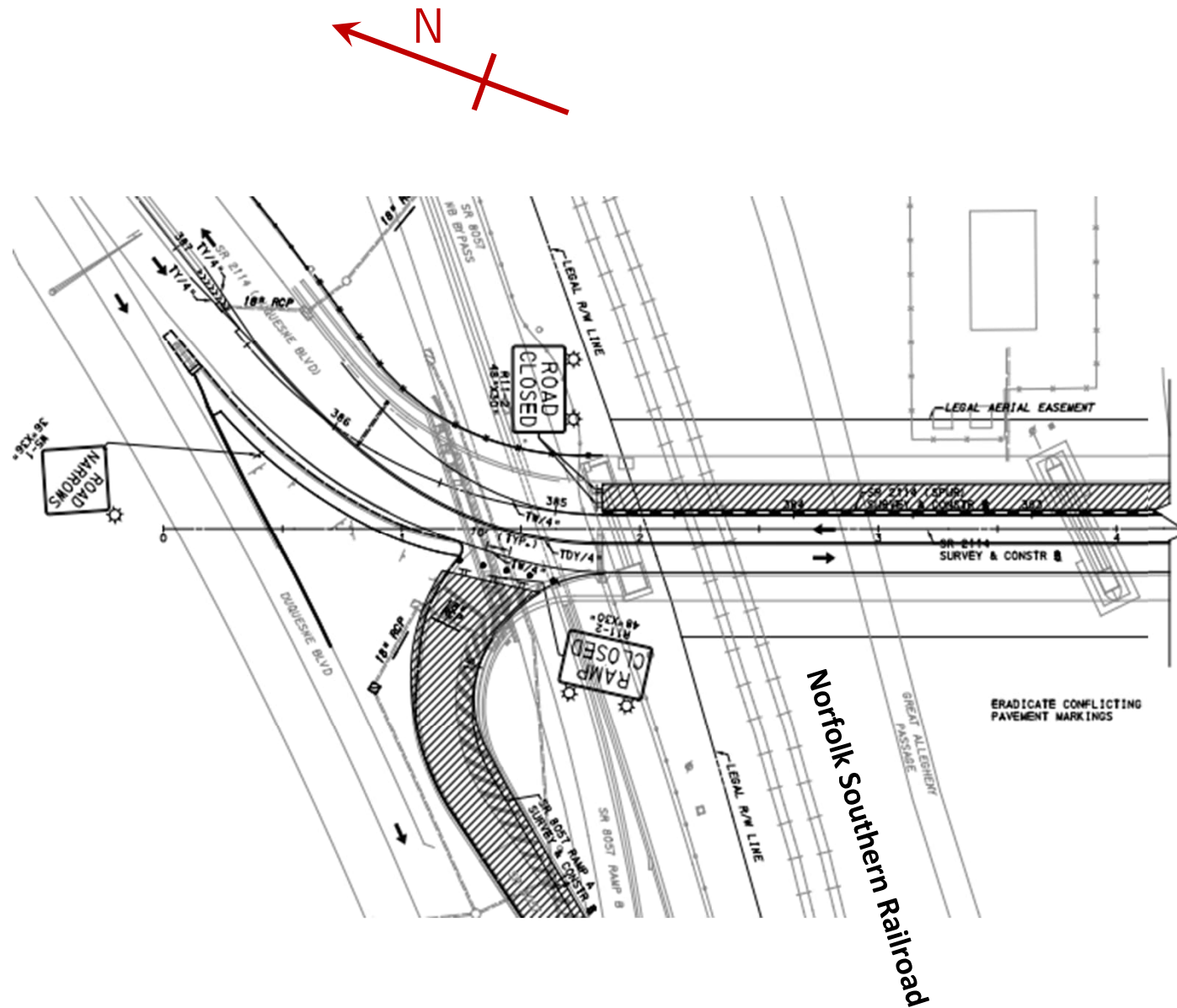

City of
Duquesne

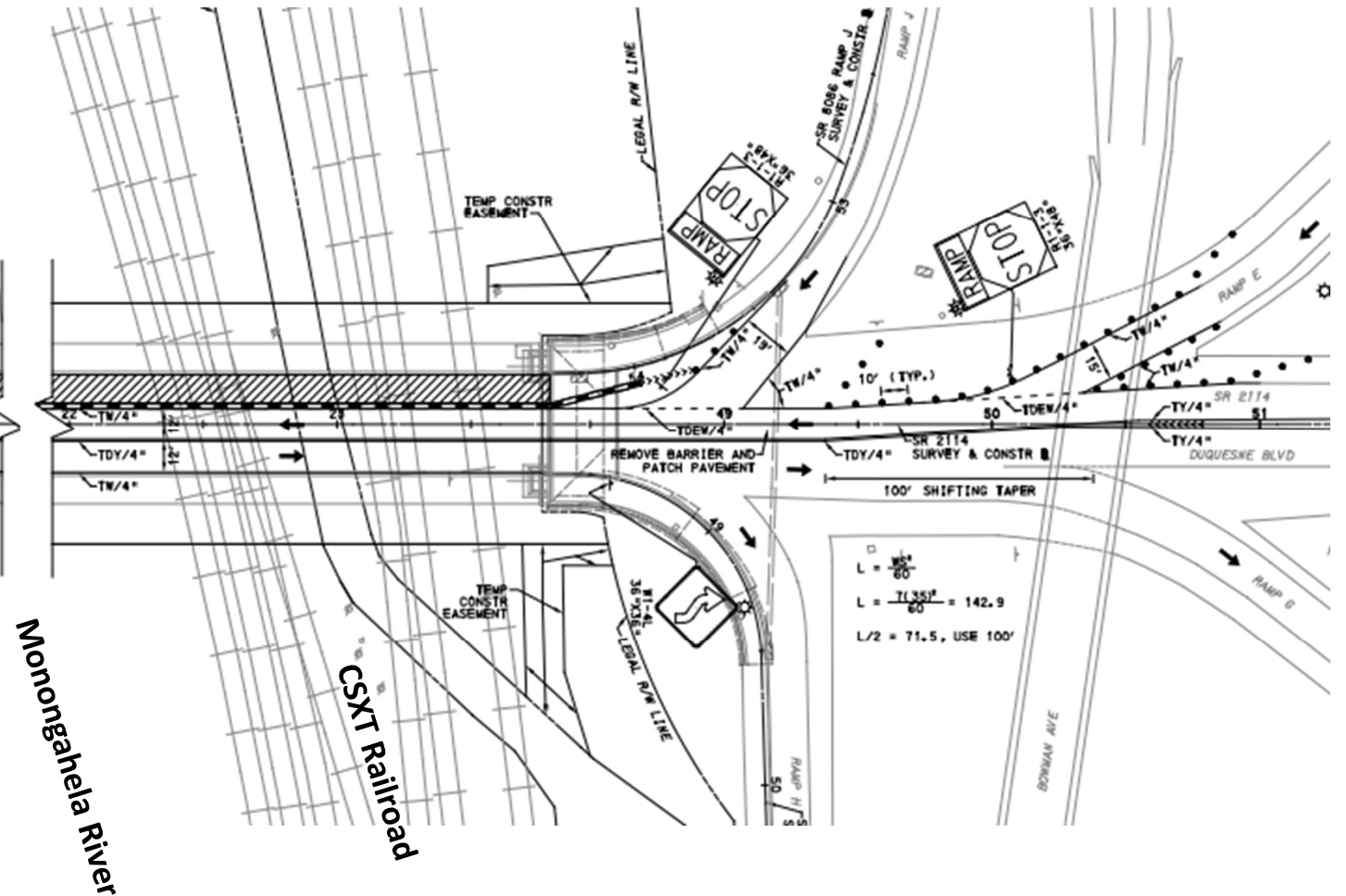

City of
McKeesport

TRAFFIC PHASING

Phase 2

- Full Bridge Closure and Detour
 - Anticipated to be Less than 90 Days
 - Remaining deck joints
 - Protective Concrete Overlay
 - Approach Slabs and Approach Roadway
 - Overhead Sign Structures
 - Sidewalk ADA Ramps
-
- Note: Phase 1A and Phase 1B Short Term Detours follow Phase 2 Detour Route

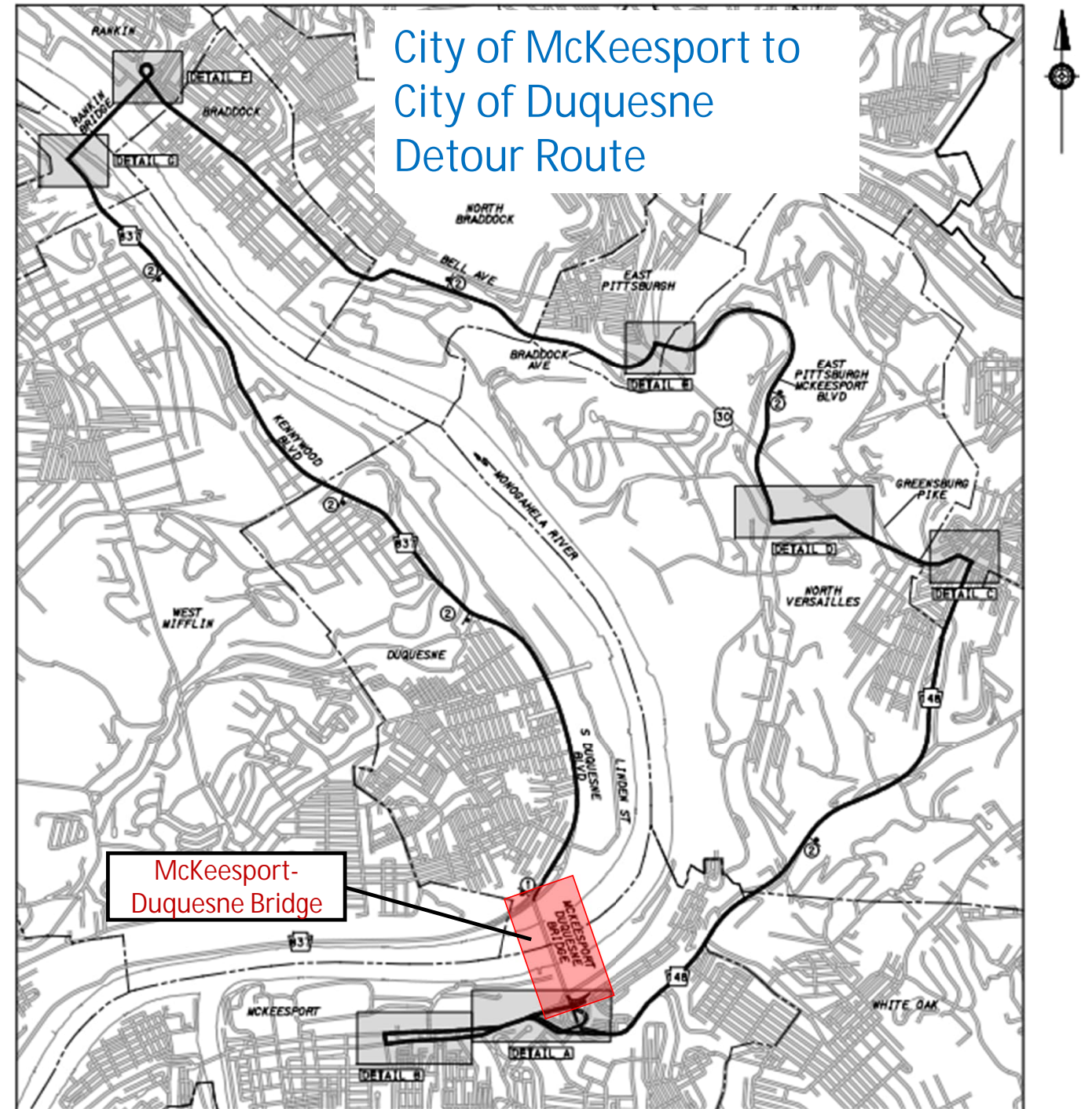

TRAFFIC PHASING

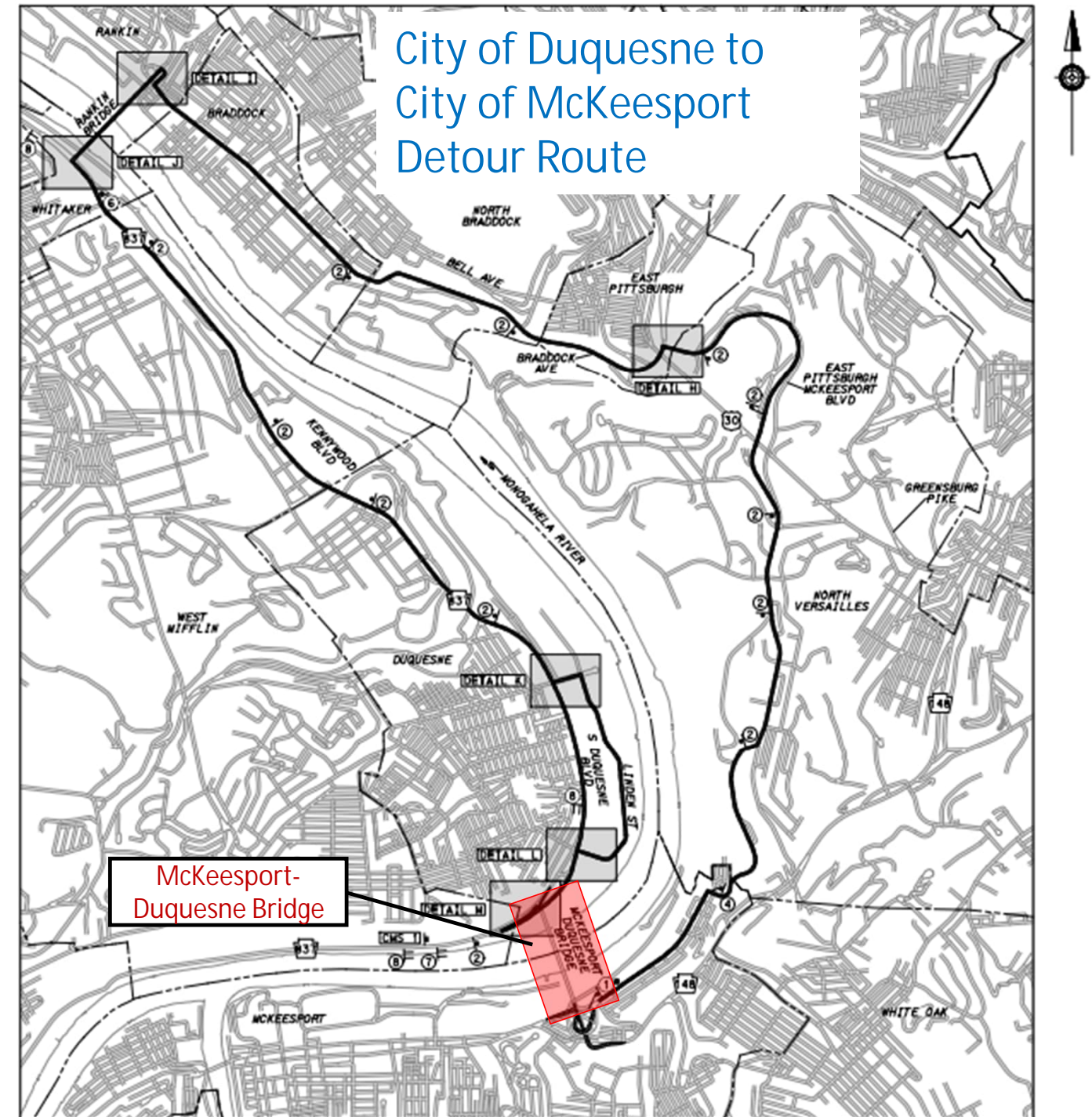
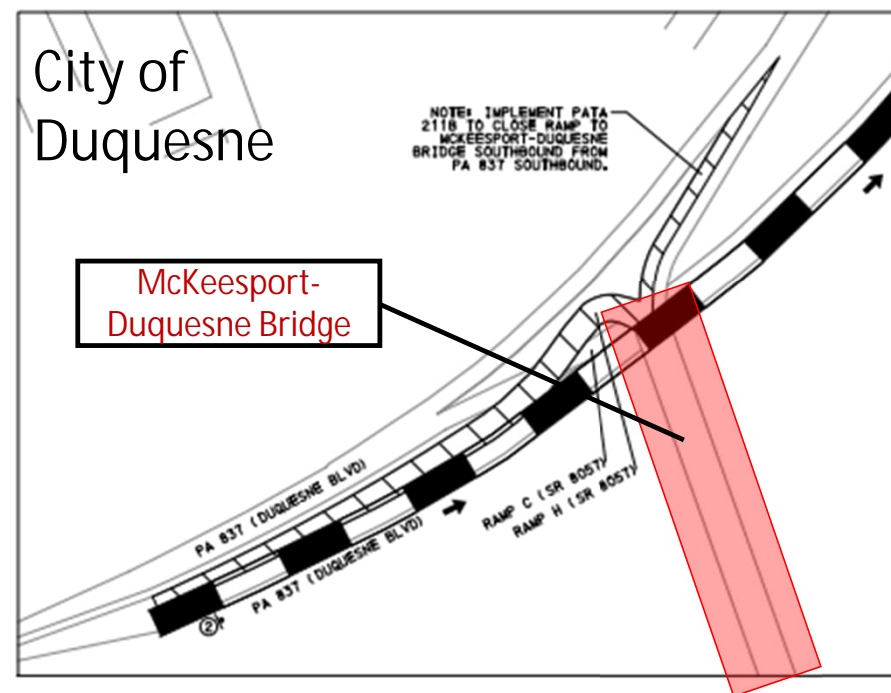
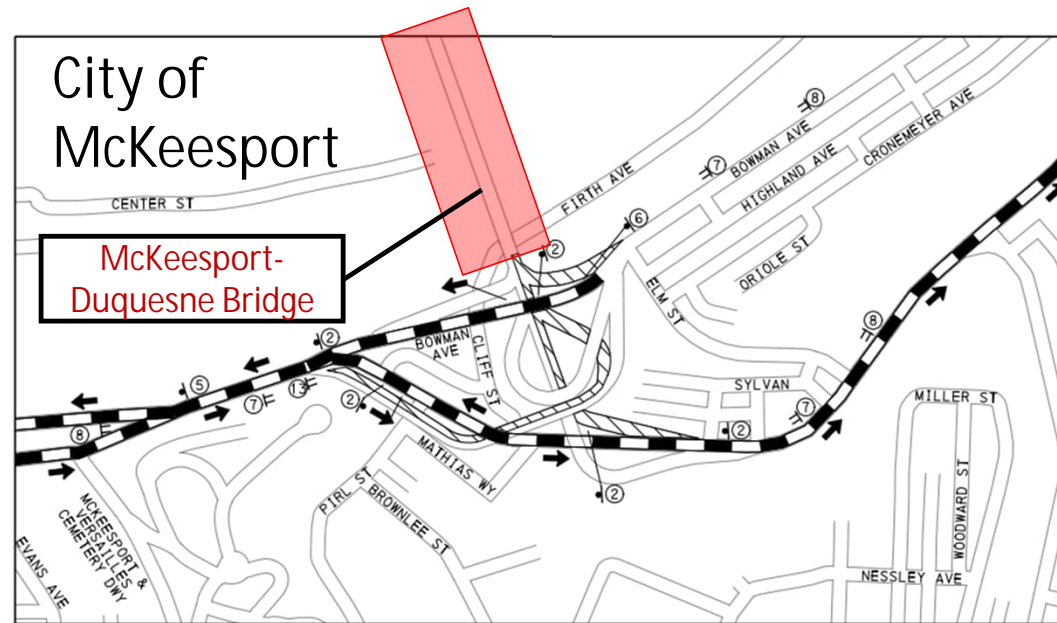

RIGHT-OF-WAY IMPACTS

- ☐ 8 Total Non-Residential Impacted Claimants
- ☐ Required Right-of-Way
 - None
- ☐ Temporary Construction Easement
 - 5 non-residential properties impacted for construction staging activities and/or contractor access to the Bridge
- ☐ Required Aerial Easement
 - 6 non-residential properties impacted for repair access and then future bridge inspection and maintenance
- ☐ Required Underground Bridge Structure Support Easement
 - 1 non-residential property impacted for pier foundation stability protection

PROJECT COMMENT FORM

- The on-line project comment form can be found on the project website. To access, scan the QR Code:



- 1) Click the “Submit a Comment” button under the contact information on the right side of the screen.
- 2) Select “Project Name” from the list of projects in the dropdown box.

QUESTION AND ANSWER SESSION

Thank you for your attendance and attention!

Questions/Comments/Feedback?

For additional information, please contact:

Mark Krajcovic, PE
Project Manager
(412) 429-2812
mkrajcovic@pa.gov