

OPERATOR: FORDAT
FILE NAME: pw://cdmsmith-az02-pw.bentley.com/pw_ext/Documents/118912/28172710 Transportation/02 Engineering Services/01 Roadway/14 - SR 3009 (Corner Rd)/10 BIM_CADD/01 Working/14 - SR 3009 (Corner Rd)/10 BIM_CADD/01 Presentations/SR3009_PublicRoadwayPlan.dgn

SR 3009 PROPOSED STRUCTURE DATA	
TYPE	COMPOSITE PRESTRESSED SPREAD BOX BEAM
CLEAR SPAN	72'-0"
UNDERCLEARANCE	6'-4½"
ROADWAY WIDTH	28'-0" CURB-TO-CURB, 31'-0" OUT-TO-OUT

SR 3009 EXISTING STRUCTURE DATA	
TYPE	NON-COMPOSITE PRESTRESSED ADJACENT BOX BEAM
CLEAR SPAN	72'-0"
UNDERCLEARANCE	6'-4½"
ROADWAY WIDTH	28'-0" CURB-TO-CURB, 33'-6" OUT-TO-OUT



DISTRICT	COUNTY	ROUTE	SECTION	SHEET
8-0	FRANKLIN	3009	022	OF
MONTGOMERY TOWNSHIP				
REV NO	REVISIONS	DATE	BY	APPD

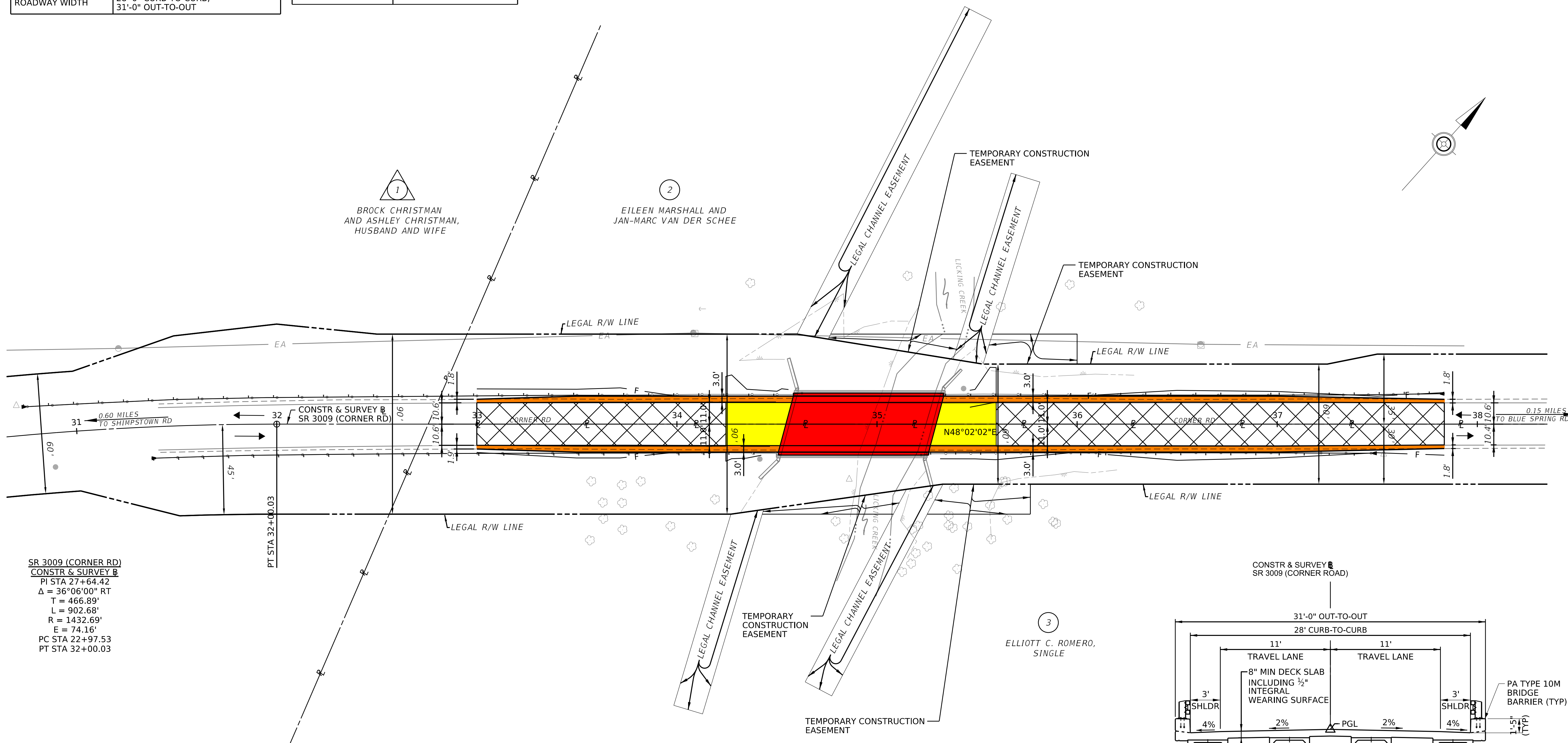

SR 3009 (CORNER RD)
CONSTR & SURVEY B
PI STA 27+64.42
Δ = 36°06'00" RT
T = 466.89'
L = 902.68'
R = 1432.69'
E = 74.16'
PC STA 22+97.53
PT STA 32+00.03

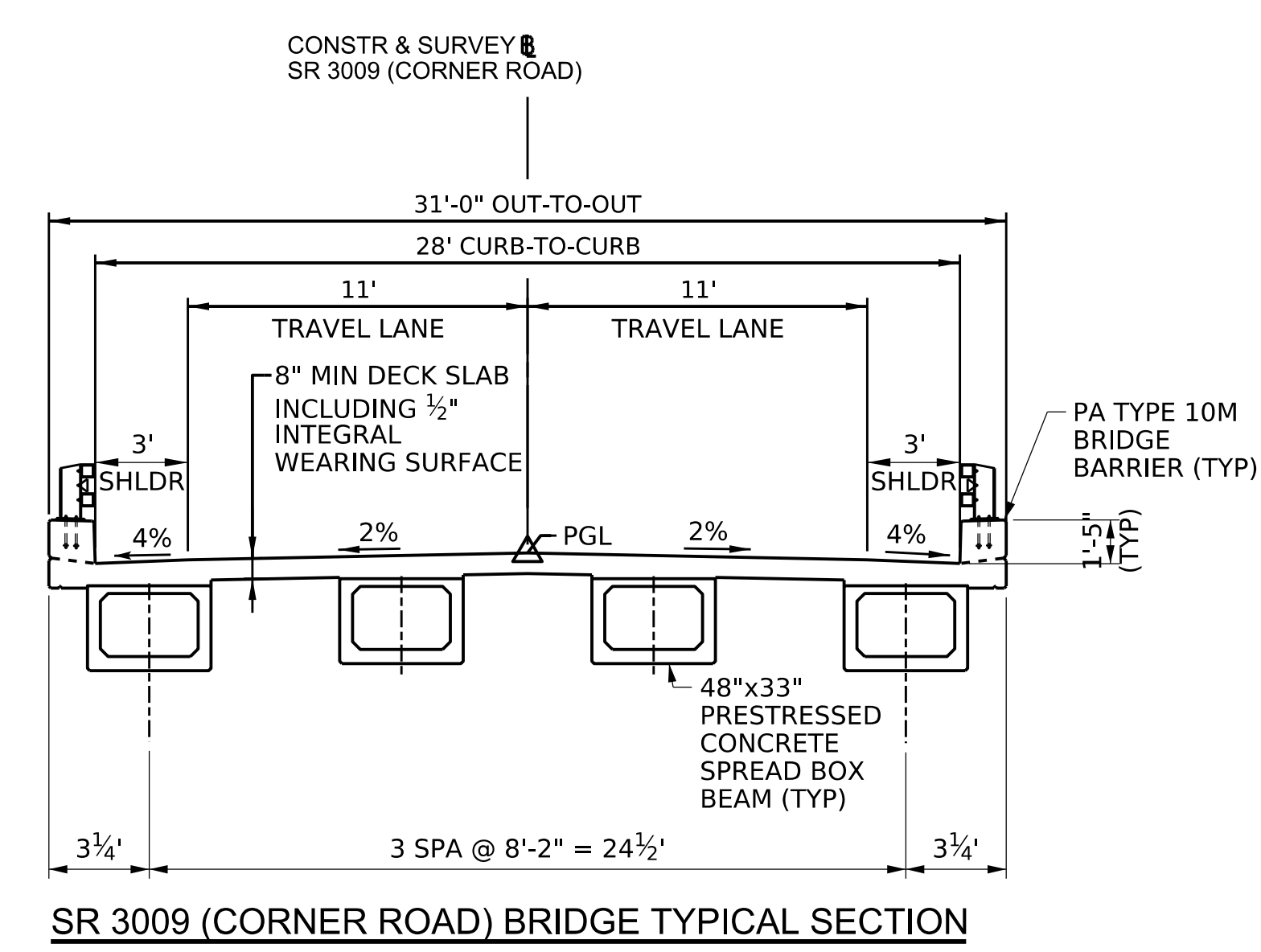

- LEGEND**
- PROPOSED BRIDGE
 - PROPOSED ROADWAY
 - PROPOSED SHOULDER
 - MILL AND OVERLAY
 - TRAFFIC FLOW

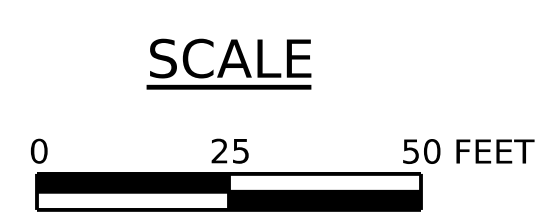

SR 3009 (CORNER RD)
PRELIMINARY ROADWAY PLAN VIEW