





ROUTE 22/322 CLARK'S FERRY IMPROVEMENT PROJECT

Dauphin and Perry Counties

US 22/322 & SR 147 INTERCHANGE & TRAIL CROSSING IMPROVEMENTS

LEGEND

-  PROPOSED PAVEMENT (LANE / SHOULDER)
-  EXISTING PAVEMENT (LANE / SHOULDER)
-  APPALACHIAN TRAIL CONCRETE BARRIER
-  TRAFFIC PATTERN FOR U-TURN TO ROUTE 22 / 322 WB
- WB** WEST BOUND
- EB** EAST BOUND
- NB** NORTH BOUND
- SB** SOUTH BOUND

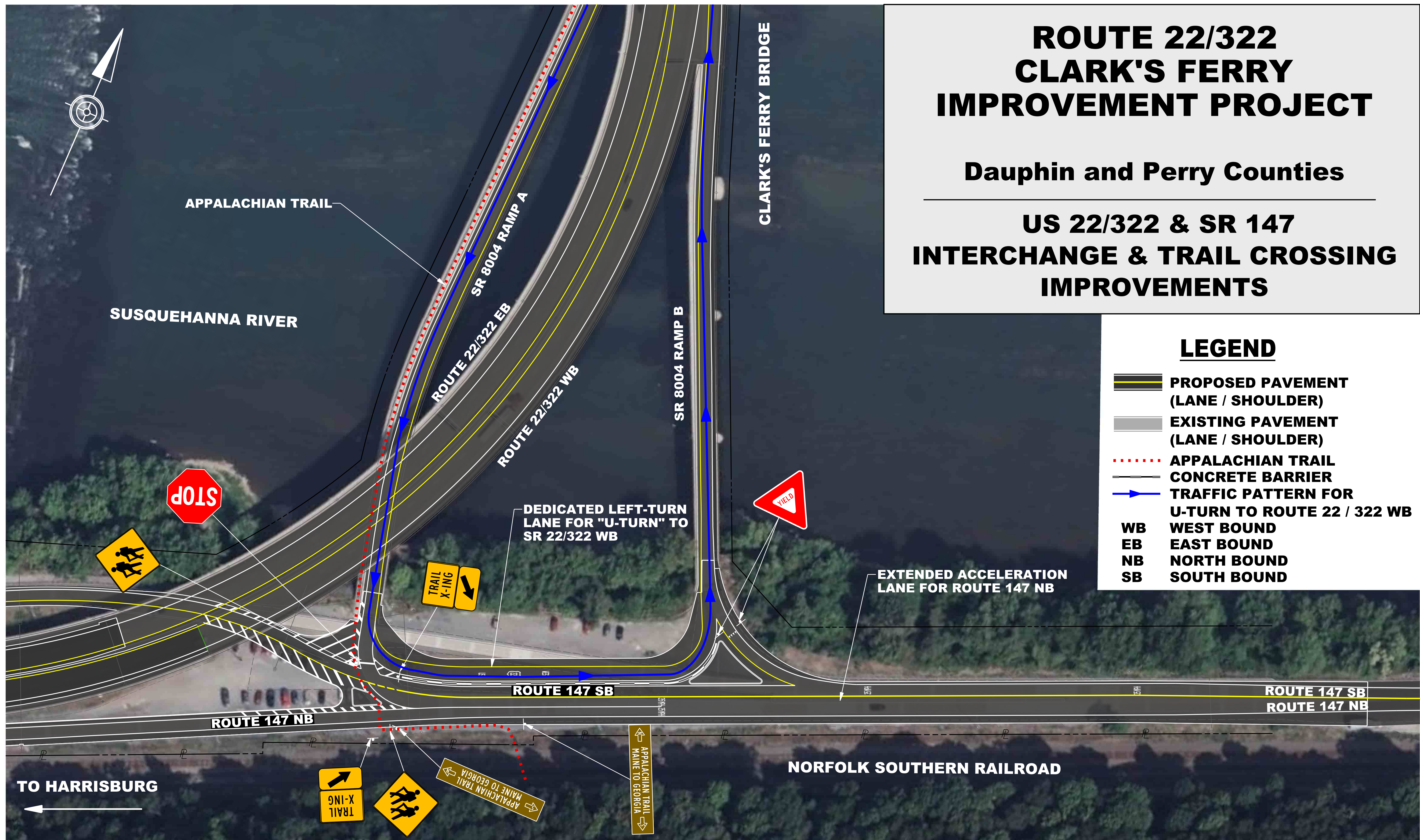

PLOT DRIVER: pcedat201.pdf_color-grayscale.pltcfgr
 PEN TABLE: ..\Print_Gr-optimizer-grayscale.tbl
 WORKSPACE: 028001-02.riverlandus

OPERATOR: bgrassley
 FILE PATH: F:\2016\0605\0218007-02\HWY-TR\CON\ISP\05\Pub\1c_Mee\ing-147\Interchange.dgn
 PLOT DATE: 7/17/2023 12:18:18 PM

