

ROUTE 22/322 CLARK'S FERRY IMPROVEMENT PROJECT

Dauphin and Perry Counties SR 0849 (NEWPORT ROAD) BRIDGE STRUCTURE PLAN

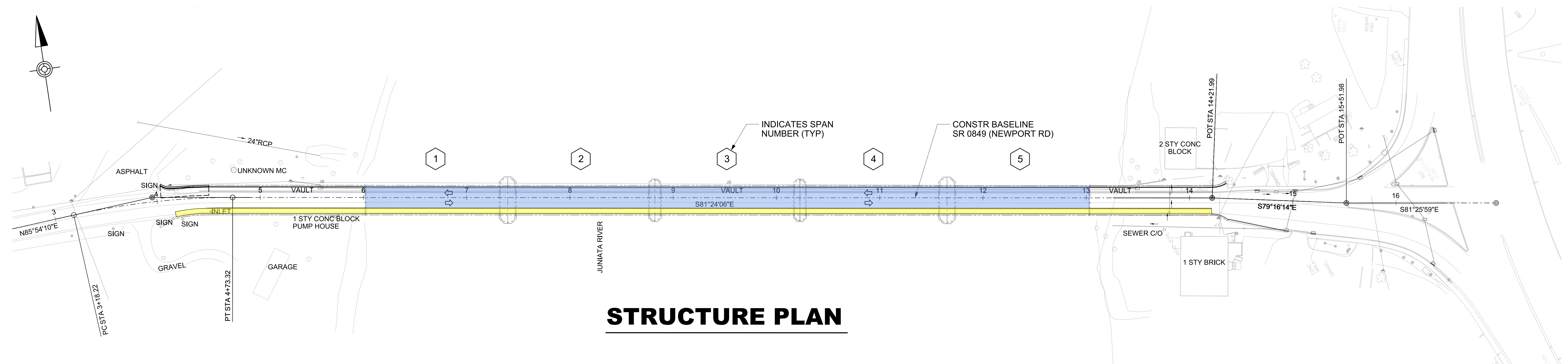

STRUCTURE PLAN

SCOPE OF WORK:

BRIDGE REPAIRS TO BE MADE UNDER DETOURED TRAFFIC (BOTH VEHICULAR AND PEDESTRIAN).

FOUNDATIONS (MAY BE PERFORMED UNDER AN EARLY CONTRACT)
 INSTALL TURBIDITY CURTAINS AT PIERS 3 AND 4 TO FACILITATE FOUNDATION REPAIRS.
 INSTALL GROUT BAGS FOR INSTALLATION OF GROUT UNDER FOUNDATIONS AND TO PROVIDE SCOUR PROTECTION.
 INSTALL GROUT UNDER FOUNDATIONS FOR PIERS 3 AND 4.

REINFORCED CONCRETE ARCH REPAIRS - UNDERSIDE
 PERFORM CONCRETE REPAIRS TO THE UNDERSIDE OF CONCRETE ARCHES.
 PERFORM MINOR CONCRETE CLEANING AND REFACING OF CONCRETE PIERS.
 PROVIDE APPLICATION OF SILANE SEALER TO ARCH UNDERSIDE AND THE PIERS.

LEGEND

- RELOCATED SIDEWALK
- ASPHALT PAVEMENT OVER BRIDGE

REINFORCED CONCRETE ARCH REPAIRS - TOPSIDE
 REMOVE EXISTING ROADWAY ASPHALT AND CONCRETE SLAB.
 REMOVE EXISTING SIDEWALK AND TRAFFIC RAILING.
 REMOVE EXISTING FILL.
 INSTALL WATERPROOFING SYSTEM.
 CONSTRUCT PAVEMENT SUBBASE.
 INSTALL PAVEMENT BASE DRAINS.
 CONSTRUCT ROADWAY PAVEMENT.
 CONSTRUCT NEW SIDEWALK ON THE DOWNSTREAM SIDE OF ROADWAY AND CONCRETE CURB ON THE UPSTREAM SIDE.
 REPAIR EXISTING CONCRETE PARAPETS - MATCH CONFIGURATION.
 CONSTRUCT NEW PARAPET AND MOMENT SLAB AT NEAR LEFT.

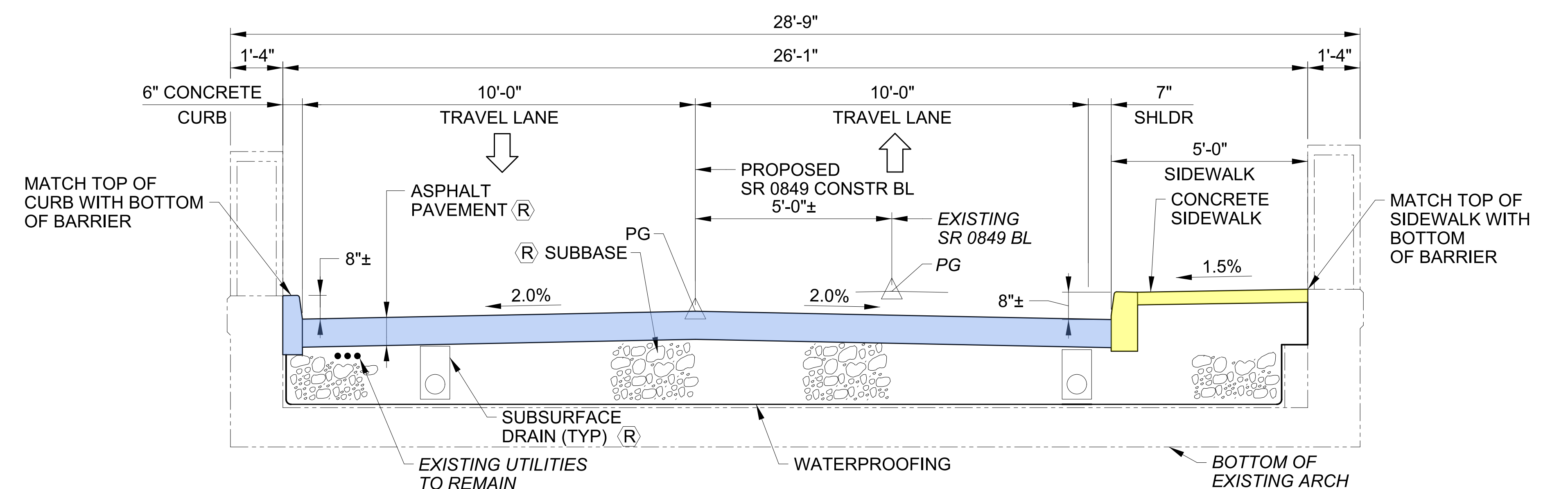

TYPICAL SECTION