

DISTRICT	COUNTY	ROUTE	SECTION	SHEET
8-0	YORK	3092	003	1 OF 1
JACKSON TOWNSHIP				
REV NO	REVISIONS	DATE	BY	APPD

HYDRAULIC DATA
BUNCH CREEK

DRAINAGE AREA = 0.83 SQ MI
DESIGN FREQUENCY = 10-YEAR

		EXISTING	PROPOSED
10-YEAR FLOOD	DISCHARGE	263 CFS	263 CFS
	WATER SURFACE	616.03	613.38
	VELOCITY	3.4 FPS	10.2 FPS
25-YEAR FLOOD	DISCHARGE	477 CFS	477 CFS
	WATER SURFACE	618.24	615.89
	VELOCITY	3.4 FPS	5.7 FPS
100-YEAR FLOOD	DISCHARGE	981 CFS	981 CFS
	WATER SURFACE	620.92	618.87
	VELOCITY	3.9 FPS	6.1 FPS

EXISTING STRUCTURE DATA

STA - 103+52.40
TYPE - CULVERT
SPAN - 11.83' (NORMAL)
SKEW - 44°00'00" +/-
MIN VERT CLR: 7'-7" (TO NORMAL POOL)

PROPOSED STRUCTURE DATA

STA - 103+52.40
TYPE - PRECAST BOX CULVERT
SPAN - 17.00' (CLEAR)
SKEW - 44°00'00" RT AHEAD
MIN VERT CLR: 7'-0" (TO NORMAL POOL)

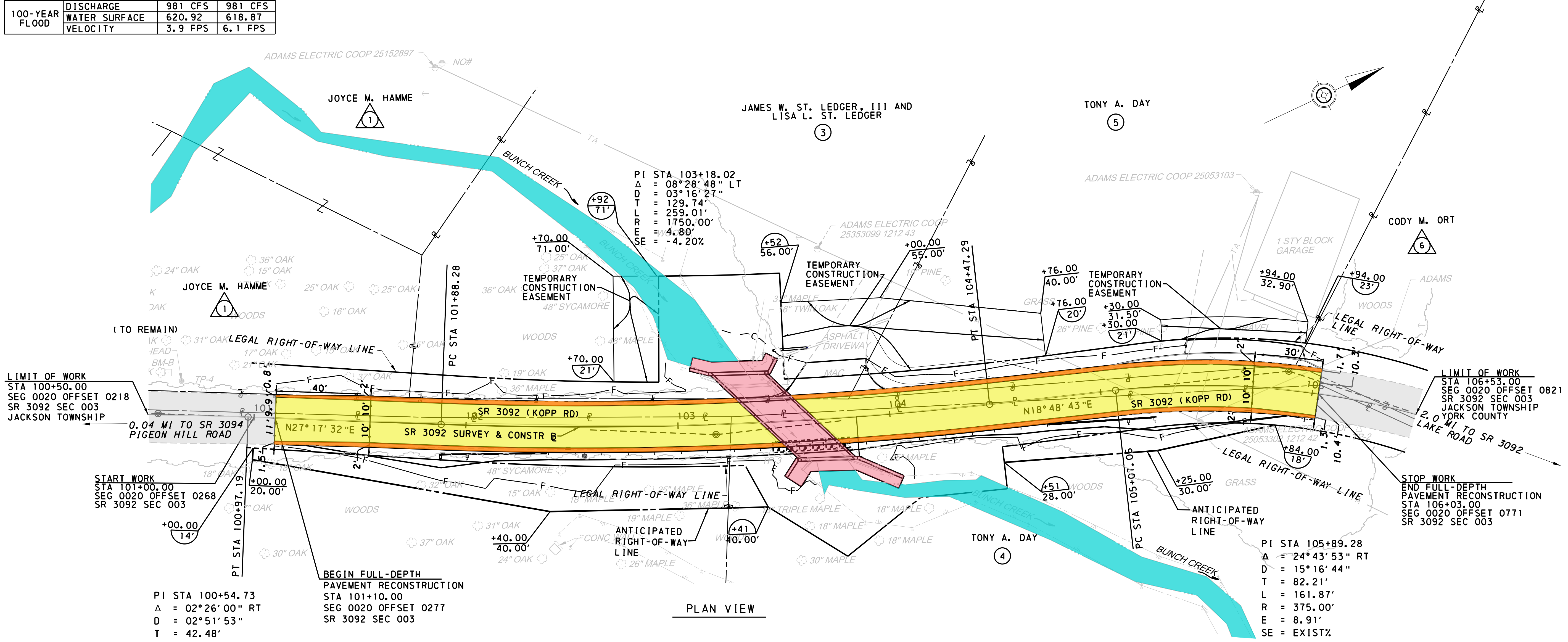

PLAN VIEW

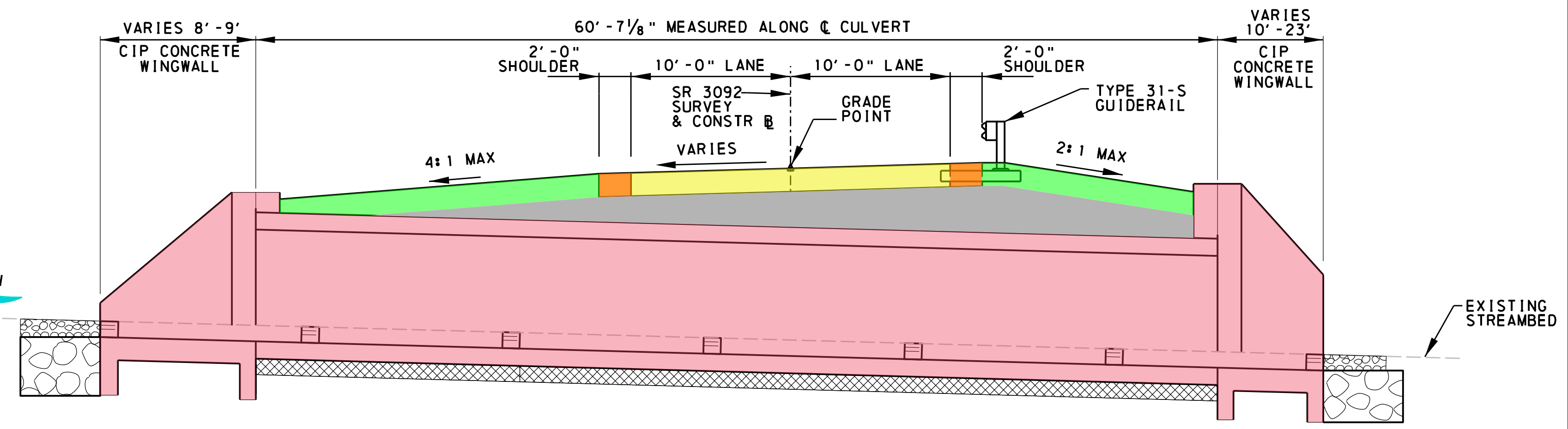

TYPICAL STRUCTURE SECTION
NOT TO SCALE

LEGEND

	PROPOSED ROADWAY
	PROPOSED SHOULDER
	PROPOSED STRUCTURE
	PROPOSED SEEDED AREA
	STREAM
	EXISTING ROADWAY



CONCEPTUAL STATE ROUTE 3092 (KOPP ROAD) CULVERT REPLACEMENT OVER BUNCH CREEK

OPERATOR: yvonne.firczak
 FILE NAME: pw://projectwise.volkert.com:volkert-us-pw/Documents/Projects/1200702 - York County Bridges (Southwest) - PennDOT/07 Design/DGN/Roadway/Plan_Sheet for Pl.dgn
 4-JUN-2026 15:39
 PLOTTED: