

USER: JH01123 PLOT: DRIVER+Penndot\_PDF\_Memo.plt.ctb PLOT DATE: 03-11-2025 3:46:23 PM  
PATH: g:\pwork\eng\veg\101\1479912\ FILE: SR 1042-CHURCH-GROUP-V\_GEN01.dgn  
MODEL: Default

GENERAL NOTES

THIS WORK CONSISTS OF THE MAINTENANCE OF TRAFFIC AND THE PROTECTION OF THE TRAVELING PUBLIC APPROACHING THE CONSTRUCTION AREA AND WITHIN THE LIMITS OF CONSTRUCTION.

FURNISH, ERECT, PLACE, AND MAINTAIN TRAFFIC CONTROL SIGNS AND DEVICES AND MAINTAIN TRAFFIC DURING HOURS OF CONSTRUCTION AND AT ALL OTHER TIMES IN ACCORDANCE WITH THE METHODS INDICATED ON THESE DRAWINGS AND IN THE MOST CURRENT EDITION OF:

- A. THE SPECIAL PROVISIONS OF THE CONTRACT;
- B. PA CODE, TITLE 67, CHAPTER 212, OFFICIAL TRAFFIC CONTROL DEVICES;
- C. PENNDOT PUBLICATION 35, APPROVED CONSTRUCTION MATERIALS (BULLETIN 15);
- D. PENNDOT PUBLICATION 408, SPECIFICATIONS;
- E. PENNDOT PUBLICATION 213, TEMPORARY TRAFFIC CONTROL GUIDELINES;
- F. PENNDOT PUBLICATION 236, HANDBOOK OF APPROVED SIGNS;
- G. PENNDOT PUBLICATION 111, TRAFFIC CONTROL STANDARDS, TC-8600 AND TC-8700 SERIES;
- H. MANUAL ON UNIFORM TRAFFIC CONTROL DEVICES (MUTCD), 2009 EDITION.
- I. PENNDOT PUBLICATION NO. 46, TRAFFIC ENGINEERING MANUAL.

IMMEDIATELY UPON COMPLETION OF WORK, REMOVE THE TRAFFIC CONTROL DEVICES. UNLESS OTHERWISE SPECIFIED IN THE SPECIAL PROVISIONS, THE DEVICES REMAIN THE CONTRACTOR'S PROPERTY.

THE DEPARTMENT REPRESENTATIVE WILL INSPECT ALL TRAFFIC CONTROL DEVICES PRIOR TO THE START OF WORK.

CONTRACTOR IS TO PROVIDE NOTIFICATION OF THE FOLLOWING TO THE DEPARTMENT REPRESENTATIVE:

- A. START OF PHYSICAL WORK: FOURTEEN (14) CALENDAR DAYS.
- B. WIDTH, HEIGHT, OR WEIGHT RESTRICTIONS TO ANY ROADWAY: TEN (10) WORKING DAYS (EXCLUDING STATE HOLIDAYS) NOTE: RESTRICTIONS ARE FROM THE PRE-CONSTRUCTION WIDTH, HEIGHT, OR WEIGHT RESTRICTIONS
- C. REMOVAL OF WIDTH, HEIGHT, OR WEIGHT RESTRICTIONS TO ANY ROADWAY: IMMEDIATELY UPON REMOVAL.
- D. START OF ANY OPERATION AFFECTING TRAFFIC (LANE CLOSURES, TOTAL CLOSURES, ETC.): FOURTEEN (14) CALENDAR DAYS WITH A CONFIRMATION IMMEDIATELY PRIOR TO COMMENCING THE OPERATION.

PROVIDE A TRAFFIC CONTROL SUPERVISOR WHO CAN BE REACHED TWENTY-FOUR (24) HOURS A DAY, SEVEN (7) DAYS A WEEK FOR THE DURATION OF THE PROJECT. ALL PROJECT PERSONNEL, INCLUDING THE DEPARTMENT REPRESENTATIVE, SHALL BE PROVIDED THE NECESSARY CONTACT INFORMATION OF THE TRAFFIC CONTROL SUPERVISOR.

THESE PLANS ARE NOT INTENDED TO RELIEVE THE CONTRACTOR OF THE RESPONSIBILITY FOR THE PROTECTION OF THE PUBLIC AND THE CONSTRUCTION PERSONNEL AS SPECIFIED IN SECTION 901.3 (d) OF PENNDOT PUBLICATION 408. THE STANDARDS PRESCRIBED ARE MINIMUM AND ADDITIONAL PROTECTION MAY BE NEEDED IF PROBLEMS ARE ENCOUNTERED DURING THE TERM OF THE CONTRACT. CONSTANTLY REVIEW THIS PLAN FOR ADEQUACY AND RECOMMEND CHANGES FOR DEPARTMENT APPROVAL WHEN INADEQUACIES ARE DISCOVERED.

REFER TO THE CONSTRUCTION REQUIREMENTS, CONSTRUCTION RESTRICTIONS, AND HOLIDAY RESTRICTIONS, WITHIN THE PROJECT CONTRACT, FOR ADDITIONAL INFORMATION PERTAINING TO THIS PROJECT.

THE POSTED SPEED LIMIT IS AS FOLLOWS:

CHURCH ROAD - SR 1042 - 40 MPH

ALL TRAFFIC CONTROL DEVICES MUST BE IN PLACE AND VISIBLE, TO THE SATISFACTION OF THE DEPARTMENT REPRESENTATIVE, PRIOR TO BEGINNING WORK EACH DAY, REPLACE ANY DAMAGED OR MISSING SIGNS, BARRICADES, LIGHTS, OR OTHER TRAFFIC CONTROL DEVICES IN ACCORDANCE WITH SECTION 901.3 (T).

MAINTAIN CONSTANT SURVEILLANCE OF THE TRAFFIC CONTROL OPERATION AND, TO THE SATISFACTION OF THE DEPARTMENT REPRESENTATIVE, REPLACE OR CORRECT ANY MISSING, DAMAGED, INEFFECTIVE OR MISALIGNED SIGNS, DEVICES, OR EQUIPMENT UNDER THE TERMS LISTED IN SECTION 901.3 (T).

CONTRACTOR SHALL COVER ALL OPEN TRENCHES WITH STEEL PLATES OR BACKFILL TO THE LEVEL OF THE SURROUNDING AREA AT THE END OF EACH WORK DAY. THIS WORK IS CONSIDERED INCIDENTAL TO ITEM NO. 0901-0005 (MAINTENANCE AND PROTECTION OF TRAFFIC DURING CONSTRUCTION).

PROVIDE DROP OFF PROTECTION IN ACCORDANCE WITH PENNDOT PUBLICATION 408, SECTION 901.3 (J) AND AS SHOWN ON THE DETAILS IN THIS PLAN.

USE TRUCK MOUNTED ATTENUATORS WHEN REQUIRED FOR SHORT-TERM TRAFFIC CONTROL. USE NCHRP 350 OR MASH 2016 TEST LEVEL 2 FOR ROADWAYS WITH POSTED SPEEDS LESS THAN 45 MPH AND TEST LEVEL 3 FOR ROADWAYS WITH POSTED SPEEDS GREATER THAN OR EQUAL TO 45 MPH.

PROVIDE ADEQUATE NUMBER OF TYPE III BARRICADES AT ROAD CLOSURE LOCATIONS TO COMPLETELY CLOSE THE ROAD.

KEEP DRIVEWAYS ACCESSIBLE AT ALL TIMES. LOCATE ALL SIGNS SO THAT SIGHT DISTANCE IS NOT OBSTRUCTED AT DRIVEWAYS AND SIDE STREETS.

PROVIDE INGRESS AND EGRESS ABILITIES TO ALL LOCAL ROADS AND DRIVEWAYS SITUATED ADJACENT TO CONSTRUCTION AREAS.

CONTRACTOR, 30 DAYS IN ADVANCE, IS TO DIRECTLY NOTIFY IN WRITING THE MUNICIPALITIES AFFECTED BY THE DETOUR ROUTE, AS WELL AS LOCAL RESIDENTS, SCHOOL DISTRICTS, POST OFFICE, LOCAL EMERGENCY OFFICIALS (STATE AND LOCAL POLICE, FIRE, AMBULANCE) OF WORK THAT IMPACTS THOSE ENTITIES. PROVIDE DOCUMENTATION OF NOTIFICATIONS TO THE DEPARTMENT REPRESENTATIVE.

THE PENNDOT DISTRICT 6 PRESS OFFICE REQUIRES FIVE DAYS' NOTICE FOR ANY LANE RESTRICTIONS AND TWO WEEKS' NOTICE FOR ANY FULL CLOSURES PLANNED ON STATE-OWNED HIGHWAYS. A ROAD RESTRICTION FORM TO NOTIFY THE PRESS OFFICE IS AVAILABLE AT WWW.BIT.LY/D6RRFORM OR ON THE DISTRICT 6 HOME PAGE. FOR QUESTIONS, OR TO PROVIDE ADDITIONAL INFORMATION, PLEASE EMAIL RA-PDD6PRESS@PA.GOV.

SUBMIT A COMPLETED M-937R FORM TO LIZABETH CACERES (lcaceres@pa.gov) AND COPY LINDA LANE (llindlan@pa.gov) IN THE DISTRICT HAULING PERMIT OFFICE, 610-205-6792 AND THE INSPECTOR-IN-CHARGE TEN (10) WORKING DAYS BEFORE PROHIBITING OVERSIZE/OVERWEIGHT VEHICLES FROM TRAVELING THROUGH RESTRICTED AREA.

NOTIFY THE DISTRICT 6-0 REGIONAL TRAFFIC MANAGEMENT CENTER (RTMC), 610-205-6500 FIFTEEN (15) MINUTES IN ADVANCE OF ANY PROPOSED LANE OR SHOULDER RESTRICTION, ROAD CLOSURE, OR ANY OPERATION IMPEDING THE FLOW OF TRAFFIC. NOTIFY THE RTMC WHEN THE ROAD IS RESTORED TO NORMAL OPERATION.

ALL WORKERS ARE TO FOLLOW THE REGULATIONS SET FORTH IN THE GENERAL NOTES SECTION A-7 WORKSITE PROCEDURE OF PUBLICATION 213 AND SECTION 6D.03 OF THE MANUAL ON UNIFORM TRAFFIC CONTROL DEVICES (MUTCD) REGARDING THE WORKER'S SAFETY APPAREL.

RECOMMENDED PENNDOT PUBLICATION 213 TRAFFIC CONTROL FIGURES FOR USE IN THIS PROJECT ARE INDICATED BELOW:

COUNTY	BMS NO.	ROUTE	CONDITION	SHORT-TERM *	LONG-TERM **
MONTGOMERY	46 1042 0060 0000	SR 1042	DETOUR	PATA 107	TCP, PATA 215

- \* WORK THAT OCCUPIES A LOCATION UP TO 24 HOURS.
- \*\* WORK THAT OCCUPIES A LOCATION MORE THAN 24 HOURS. TRAFFIC CONTROL PLAN (TCP) SHALL TAKE PRECEDENCE OVER PUBLICATION 213 PATA FIGURES.

OTHER THAN THE DETOURS PERMITTED IN THE CONTRACT TCP, NO WORK MAY BE DONE THAT WILL RESULT IN LANE CLOSURES OR IMPEDE THE FLOW OF TRAFFIC ON LEGAL HOLIDAYS AND MONDAY THROUGH FRIDAY, BETWEEN THE HOURS OF 6:00 AM TO 9:00 AM AND 3:00 PM TO 7:00 PM.

ALL FLAGGERS, AT A MINIMUM, SHALL HAVE TRAINING AS PER PUBLICATION 408/2020 SECTION 901.3 FLAGGER TRAINING AND MUST HAVE PROPER CREDENTIALS ON THEIR PERSON AT ALL TIMES WHILE ON SITE.

NO PERMANENT LANE CLOSURES, OTHER THAN THOSE DEPICTED ON THE PLAN, ARE PERMITTED FROM 6 A.M. TO 9 A.M., AND FROM 3 P.M. TO 7 P.M. DAILY MONDAY THROUGH FRIDAY, AND DURING ALL LEGAL HOLIDAYS.

REMOVE ANY CONFLICTING PAVEMENT MARKING (TEMPORARY AND EXISTING) IN A MANNER APPROVED BY THE DEPARTMENT REPRESENTATIVE AND REPLACE UPON COMPLETION OF THE PROJECT.

INSTALL AND UTILIZE ALL PROPOSED SIGNING AND PAVEMENT MARKINGS WHERE APPLICABLE.

THE REQUIREMENTS INDICATED ARE THE MINIMUM NECESSARY AND THE CONTRACTOR SHALL FURNISH, ERECT, AND MAINTAIN ADDITIONAL DEVICES AS DIRECTED BY THE DEPARTMENT REPRESENTATIVE.

COVER OR REMOVE FROM SIGHT ALL SIGNS NOT IN USE OR CONFLICTING TO THE OPERATION BEING PERFORMED AND AS SPECIFIED IN SECTION 901.3(d) OF PENNDOT PUBLICATION 408.

ALL SIGNS AND DEVICES ARE TO BE IN NEW CONDITION AND MAINTAINED AS SUCH.

ALL ADVANCE WARNING SIGNS AND CHANNELIZING DEVICES MAY BE ADJUSTED BACKWARD OR FORWARD DUE TO INTERSECTION STREETS, DRIVEWAYS, ETC AND/OR AS FIELD CONDITIONS DICTATE. ALL SIGNS MUST BE VISIBLE. TRIM TREES OR BRUSH AS NECESSARY.

ALL SIGN ASSEMBLIES GREATER THAN NINE (9) SQUARE FEET MUST BE MOUNTED ON TYPE III BARRICADES OR GROUND MOUNTED TYPE B POSTS. REFER TO TC-8717, NOTE 2.

POST 2 WEEKS IN ADVANCE OF ROAD CLOSURE "THIS BRIDGE TO BE CLOSED FOR CONSTRUCTION" SIGNS (W23-101) AS INDICATED ON DETOUR PLAN. REMOVE THESE SIGNS AT START OF ROAD CLOSURE WORK.

COORDINATE TRAFFIC CONTROL EFFORTS OF THIS PROJECT WITH THOSE OF ANY ADJACENT CONSTRUCTION PROJECTS. NO DETOUR MAY BE IMPLEMENTED PRIOR TO 9:00 AM ON THE DAY OF ROAD CLOSURE.

DISTRICT	COUNTY	ROUTE	SECTION	SHEET	
6-0	MONTGOMERY	1042	HBV	13 OF 31	
UPPER HANOVER TOWNSHIP					
REVISION NUMBER	REVISIONS			DATE	BY

INDEX

DESCRIPTION	SHEET
GENERAL NOTES	13
DETAILS	14
TRAFFIC CONTROL PLANS	16 - 18

TABULATION OF TRAFFIC CONTROL DEVICES

INCLUDED IN ITEM NO. 0901-0005 LUMP SUM (FOR INFORMATION ONLY)

STANDARD NUMBER	MESSAGE	SIZE	QUANTITY
			SR 1042
			40
M4-8A	END DETOUR	24"x18"	4
M4-9L	DETOUR (LEFT ARROW)	30"x24"	11
M4-9SL	DETOUR (LEFT ADVANCE ARROW)	30"x24"	8
M4-9R	DETOUR (RIGHT ARROW)	30"x24"	12
M4-9SR	DETOUR (RIGHT ADVANCE ARROW)	30"x24"	8
M4-9S	DETOUR (STRAIGHT)	30"x24"	44
M4-9-1-BL	DETOUR (BEAR LEFT)	30"x24"	1
M4-10L	DETOUR ARROW, LEFT	48"x18"	2
R11-2-1	BRIDGE CLOSED	48"x30"	4
R11-3B	BRIDGE OUT 1/2 MILE AHEAD LOCAL TRAFFIC ONLY	60"x30"	2
R11-3B	BRIDGE OUT 1 1/4 MILES AHEAD LOCAL TRAFFIC ONLY	60"x30"	2
R11-3B	BRIDGE OUT 1 1/2 MILES AHEAD LOCAL TRAFFIC ONLY	60"x30"	2
R11-3B	BRIDGE OUT 2 1/4 MILES AHEAD LOCAL TRAFFIC ONLY	60"x30"	2
W14-2	NO OUTLET	30"x30"	1
W20-2	DETOUR	36"x36"	18
W20-3	ROAD CLOSED	36"x36"	4
W30-1-1	500 FT	20"x6"	6
W30-1-2	1000 FT	20"x6"	7
W30-1-3	1500 FT	20"x6"	1
W30-1-6	AHEAD	20"x6"	8
SPECIAL-10	TRUCK	20"x6"	4
SPECIAL-01	CHURCH RD CLOSED BETWEEN STATE ST AND CAMELOT PARK FOLLOW DETOUR	60"x54"	3
SPECIAL-02	CHURCH RD CLOSED BETWEEN CAMELOT PARK AND STATE ST FOLLOW DETOUR	60"x54"	6
SPECIAL-03	CHURCH ROAD	30"x18"	88
SPECIAL-04	OPEN TO CAMELOT PARK	54"x30"	1
SPECIAL-05	TRUCK DETOUR LEFT ARROW	15"x30"	4
SPECIAL-06	CAR DETOUR RIGHT ARROW	15"x30"	4
SPECIAL-07	TRUCK	30"x15"	43
SPECIAL-08	CAR	30"x15"	7
SPECIAL-09	CHURCH RD CLOSED BETWEEN CAMELOT PARK AND STATE ST TRUCKS FOLLOW DETOUR	60"x54"	1
TYPE B LIGHTS			*
TYPE C LIGHTS			*
TYPE III BARRICADE			*

\* AS NEEDED

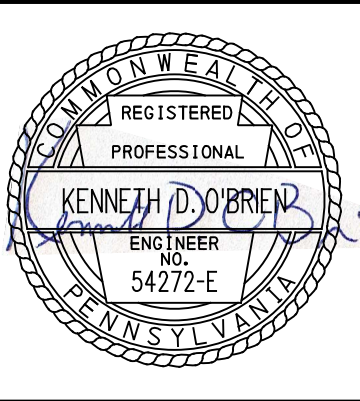



RECOMMENDED  
David L. Adams, P.E.  
ASSISTANT DISTRICT EXECUTIVE-OPERATIONS

20  
Digitally signed by David L. Adams, P.E.  
Date: 2025.03.12 15:43:42 -04'00'

TRAFFIC CONTROL PLAN



USER: CMCAHON PLOT: DRIVER+PANDOT-.PDF- Mono-plt.ctb PLOT DATE: 02-28-2025 3:54:00 PM  
PATH: c:\pwork\eng\res10\1479912\ FILE: SR 1042-CHURCH-GROUP-V-DET01.dgn  
MODEL: sign Detail.s

DISTRICT	COUNTY	ROUTE	SECTION	SHEET
6-0	MONTGOMERY	1042	HBV	14 OF 31
UPPER HANOVER TOWNSHIP				
REVISION NUMBER	REVISIONS		DATE	BY



W20-3  
36 "X36 "  
W30-1-1  
20 "X6 "



W20-3  
36 "X36 "  
W30-1-2  
20 "X6 "



W20-2  
36 "X36 "  
W30-1-1  
20 "X6 "

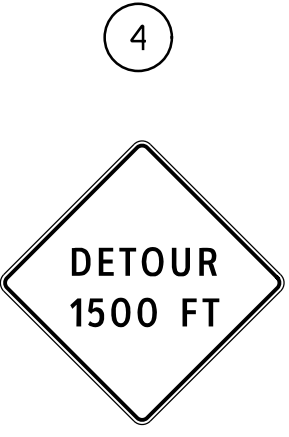

W20-2  
36 "X36 "  
W30-1-3  
20 "X6 "

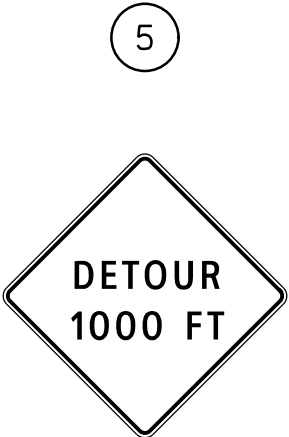

W20-2  
36 "X36 "  
W30-1-2  
20 "X6 "

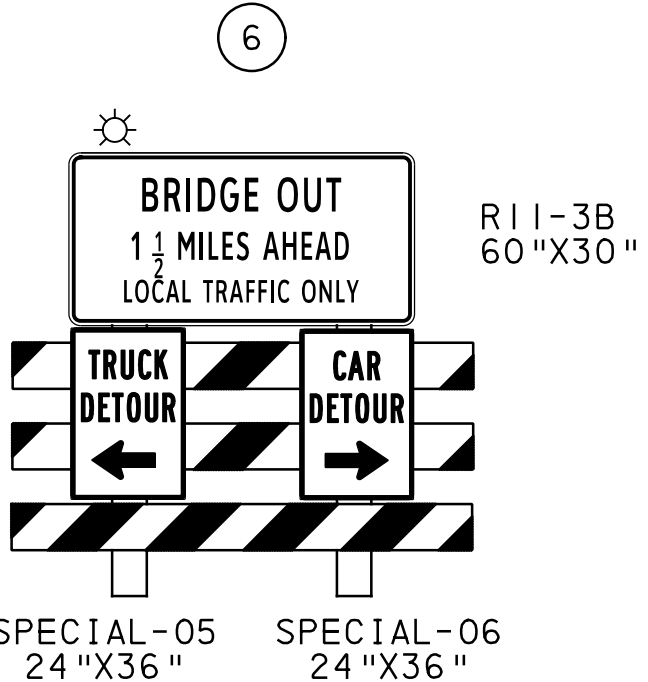

R11-3B  
60 "X30 "

SPECIAL-05  
24 "X36 "  
SPECIAL-06  
24 "X36 "



W20-2  
36 "X36 "  
W30-1-6  
20 "X6 "



SPECIAL-03  
30 "X18 "  
SPECIAL-07  
30 "X15 "  
M4-8A  
24 "X18 "

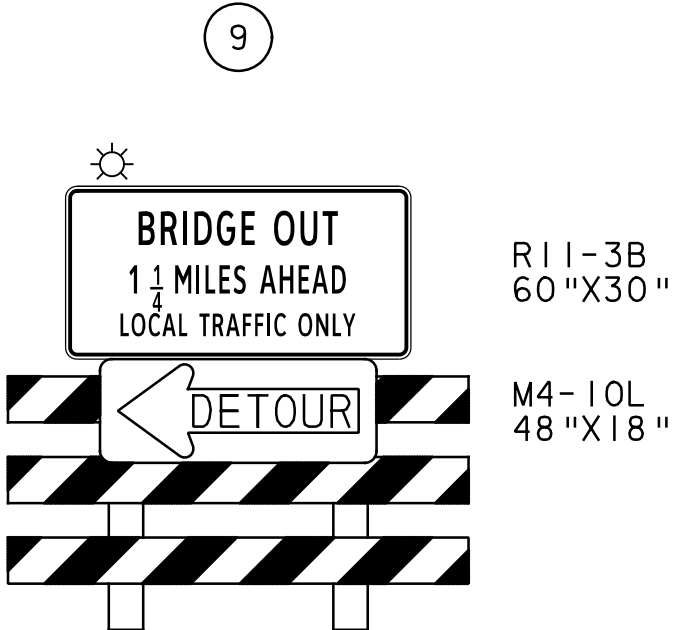

R11-3B  
60 "X30 "

M4-10L  
48 "X18 "



R11-3B  
60 "X30 "

W14-2  
30 "X30 "



R11-3B  
60 "X30 "

SPECIAL-04  
54 "X30 "

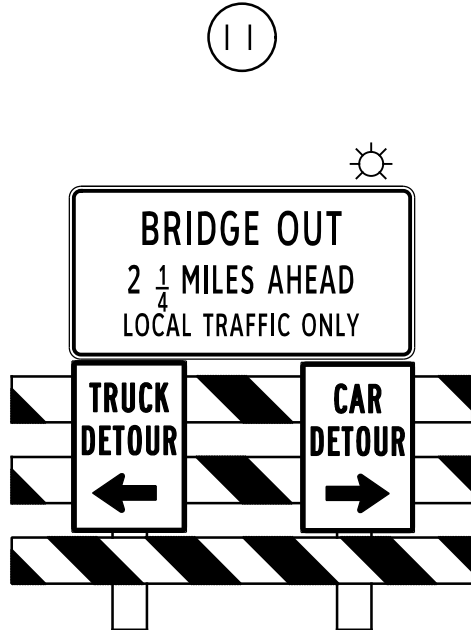

R11-3B  
60 "X30 "

SPECIAL-05  
24 "X36 "  
SPECIAL-06  
24 "X36 "



SPECIAL-03  
30 "X18 "  
M4-9-1-BL  
30 "X24 "



SPECIAL-01  
60 "X54 "



SPECIAL-02  
60 "X54 "

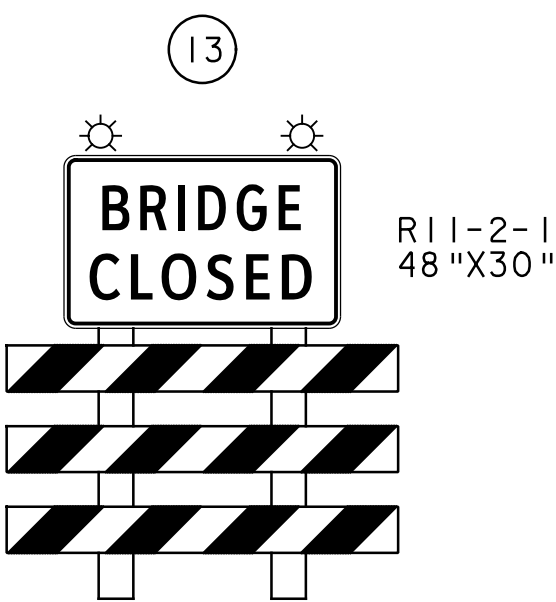

R11-2-1  
48 "X30 "



SPECIAL-03  
30 "X18 "  
M4-9SL  
30 "X24 "



SPECIAL-03  
30 "X18 "  
M4-9L  
30 "X24 "



SPECIAL-03  
30 "X18 "  
M4-9SR  
30 "X24 "



SPECIAL-03  
30 "X18 "  
M4-9R  
30 "X24 "



SPECIAL-03  
30 "X18 "  
M4-9S  
30 "X24 "



SPECIAL-03  
30 "X18 "  
M4-8A  
24 "X18 "



SPECIAL-03  
30 "X18 "  
SPECIAL-07  
30 "X15 "  
M4-9SL  
30 "X24 "

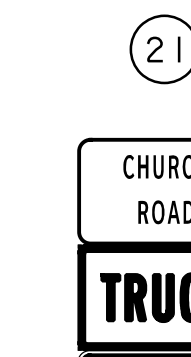

SPECIAL-03  
30 "X18 "  
SPECIAL-07  
30 "X15 "  
M4-9L  
30 "X24 "



SPECIAL-03  
30 "X18 "  
SPECIAL-07  
30 "X15 "  
M4-9SR  
30 "X24 "

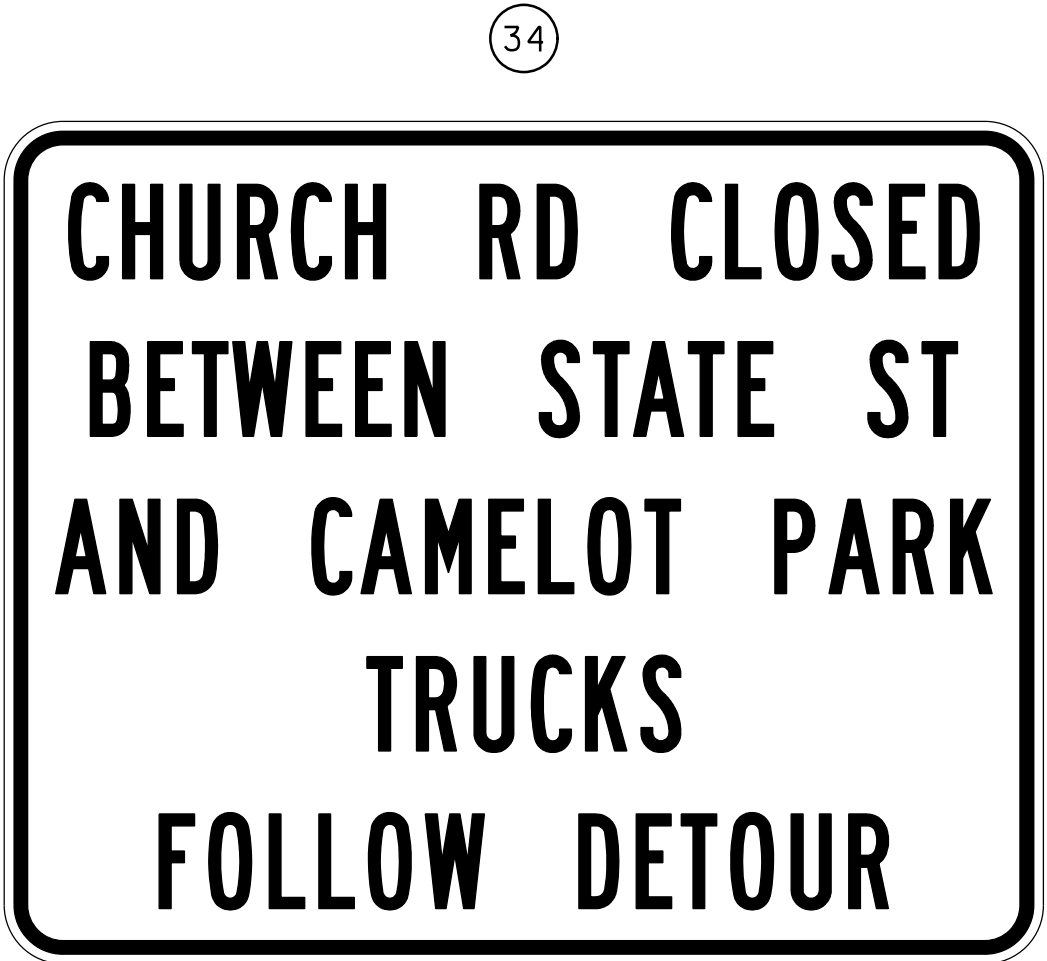

SPECIAL-09  
66 "X54 "



SPECIAL-03  
30 "X18 "  
SPECIAL-07  
30 "X15 "  
M4-9R  
30 "X24 "



SPECIAL-03  
30 "X18 "  
SPECIAL-07  
30 "X15 "  
M4-9S  
30 "X24 "



SPECIAL-10  
20 "X6 "  
W20-2  
36 "X36 "  
W30-1-1  
20 "X6 "

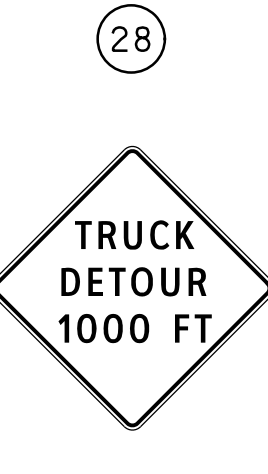

SPECIAL-10  
20 "X6 "  
W20-2  
36 "X36 "  
W30-1-2  
20 "X6 "

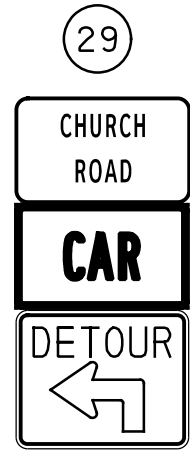

SPECIAL-03  
30 "X18 "  
SPECIAL-08  
30 "X15 "  
M4-9SL  
30 "X24 "



SPECIAL-03  
30 "X18 "  
SPECIAL-08  
30 "X15 "  
M4-9L  
30 "X24 "



SPECIAL-03  
30 "X18 "  
SPECIAL-08  
30 "X15 "  
M4-9SR  
30 "X24 "



SPECIAL-03  
30 "X18 "  
SPECIAL-08  
30 "X15 "  
M4-9R  
30 "X24 "



SPECIAL-03  
30 "X18 "  
SPECIAL-08  
30 "X15 "  
M4-8A  
24 "X18 "

DETOUR  
SR 1042 CHURCH ROAD  
46-1042-0060-0000  
MONTGOMERY COUNTY

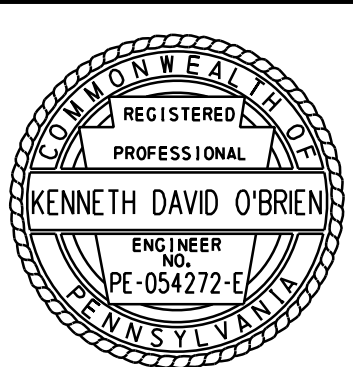

TRAFFIC CONTROL PLAN

NOTES:

1. COLORS FOR SIGN TYPES M, W, R,  
AND SPECIAL SHALL BE AS FOLLOWS:  
BACKGROUND: ORANGE (REFLECTORIZED)  
LEGEND AND BORDER: BLACK (NON-REFLECTORIZED)

USER: CMCAHON PLOT: DRIVER\_FemDOT\_PDF\_Memo.pltctfg PLOT DATE: 02-28-2025 3:54:01 PM  
PATH: c:\pwworking\cmaahon\plott\1479912\ MODEL: Sign\_Fab\_Details  
FILE: SR 1042-CHURCH-GROUP-V DETOIL.dgn

DISTRICT	COUNTY	ROUTE	SECTION	SHEET
6-0	MONTGOMERY	1042	HBV	15 OF 31
UPPER HANOVER TOWNSHIP				
REVISION NUMBER	REVISIONS	DATE	BY	

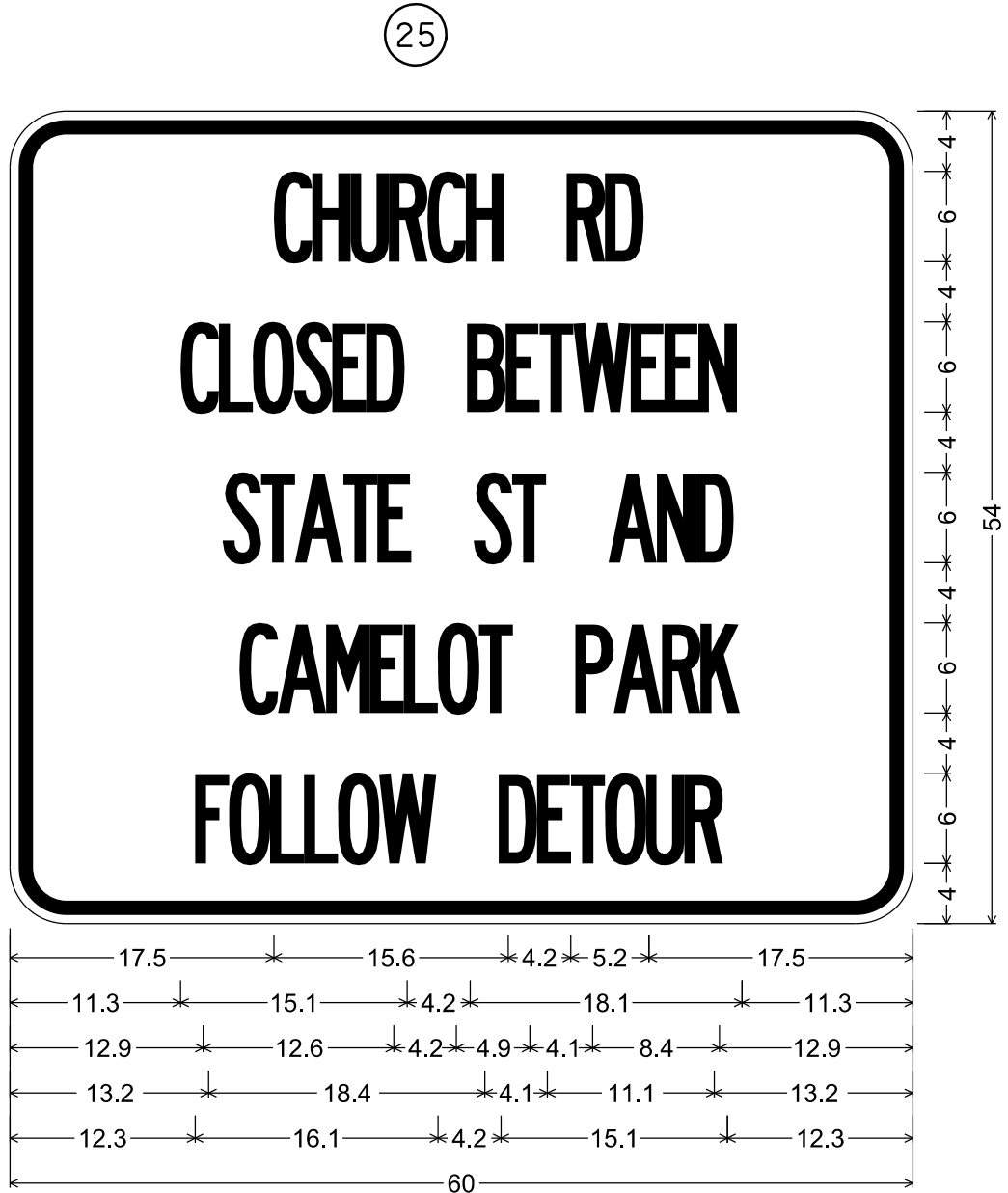

3.8" Radius, 0.9" Border, 0.6" Indent, Black on Orange;  
"CHURCH RD", Highway B 2K; "CLOSED BETWEEN", Highway B 2K;  
"STATE ST AND", Highway B 2K; "CAMELOT PARK", Highway B 2K;  
"FOLLOW DETOUR", Highway B 2K;

Table of widths and spaces

C	H	U	R	C	H	R	D							
17.5	2.6	0.0	2.7	-0.0	2.5	0.0	2.6	-0.0	2.6	4.2	2.6	-0.0	2.6	17.5
C	L	O	S	E	D									
11.3	2.6	0.0	2.3	-0.0	2.8	-0.0	2.5	0.0	2.3	0.0	2.6			
B	E	T	W	E	N									
4.2	2.6	-0.0	2.3	-0.0	2.2	0.0	3.8	0.0	2.3	0.0	2.3	-0.0	2.6	11.3
S	T	A	T	E	S	T								
19.1	2.6	0.0	2.3	0.0	3.2	0.0	2.3	0.0	2.3	4.2	2.6	-0.0	2.3	19.1
A	N	D												
4.1	3.3	0.0	2.6	-0.0	2.5	12.9								
C	A	M	E	L	O	T								
13.2	2.6	-0.0	3.3	0.0	3.0	-0.0	2.3	-0.0	2.2	0.0	2.8	-0.0	2.3	
P	A	R	K											
4.1	2.6	0.0	3.3	-0.0	2.6	0.0	2.7	13.2						
F	O	L	L	O	W									
12.3	2.3	-0.0	2.8	-0.0	2.2	-0.0	2.3	-0.0	2.7	0.0	3.8			
D	E	T	O	U	R									
4.2	2.6	0.0	2.3	-0.0	2.3	-0.0	2.7	0.0	2.6	-0.0	2.6	12.3		

SPECIAL-01  
60 "X54 "

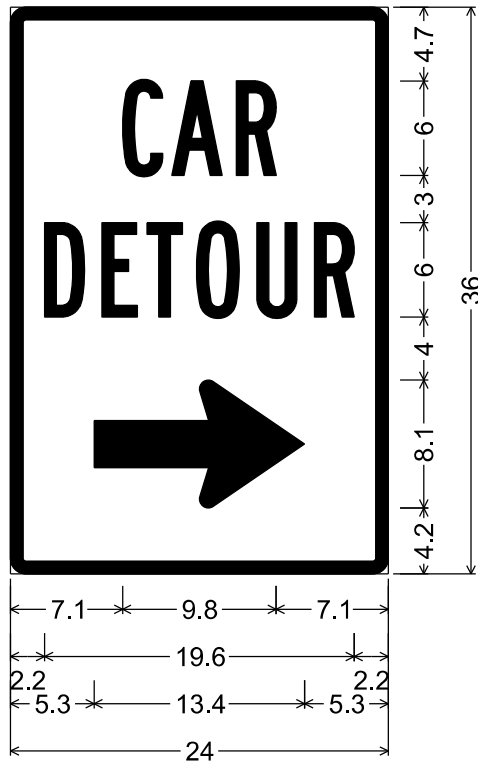

1.0" Radius, 0.8" Border, Black on Orange;  
"CAR", B; "DETOUR", B;  
Standard Arrow Custom 13.4" X 8.1" 0";  
Table of widths and spaces

C	A	R										
7.1	2.6	0.6	3.1	0.9	2.6	7.1						
D	E	T	O	U	R							
2.2	2.5	1.1	2.3	0.6	2.2	0.9	2.7	1.2	2.5	1.1	2.5	2.2
5.3	➡	13.4	5.3									

SPECIAL-06  
24 "X36 "

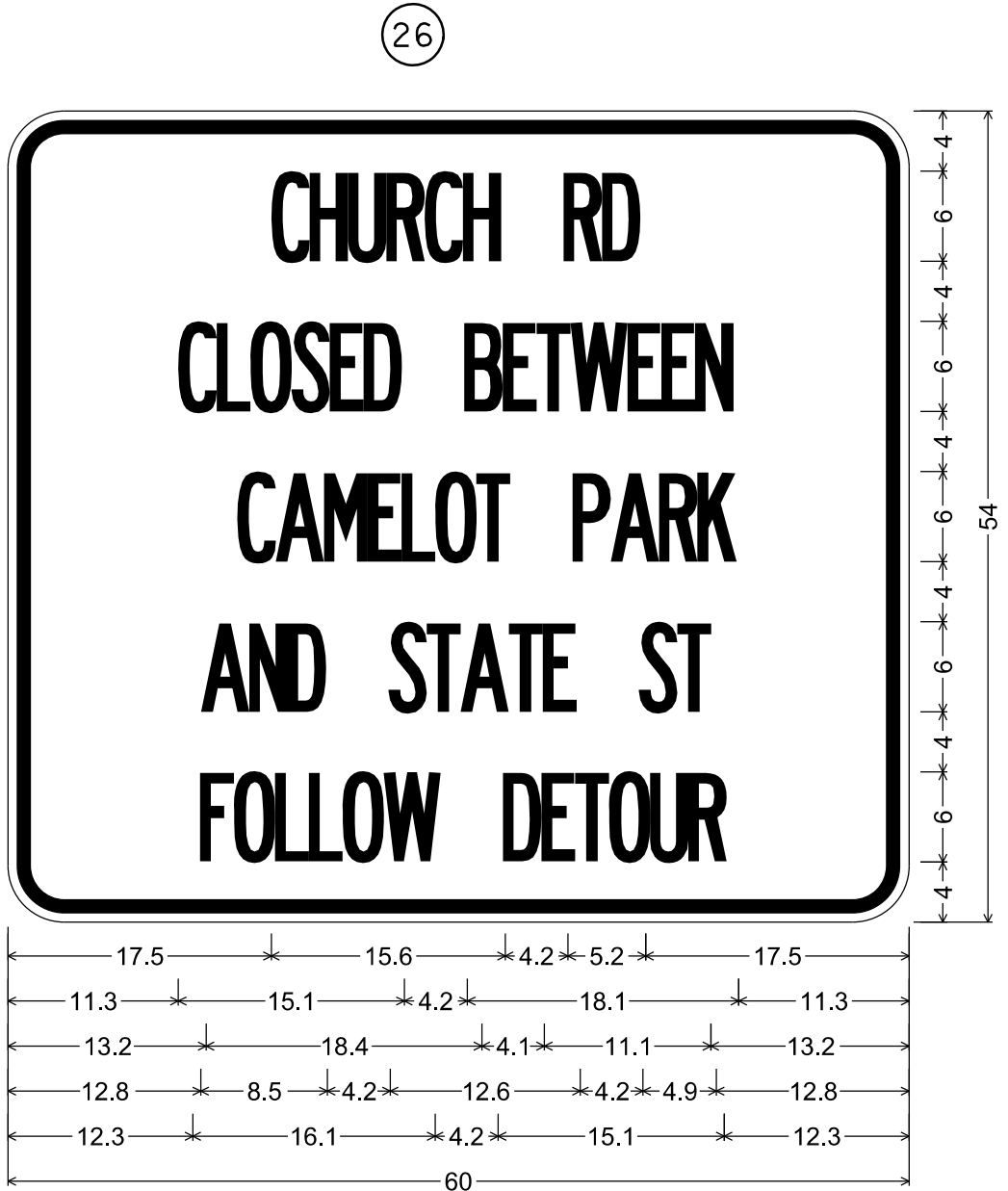

3.8" Radius, 0.9" Border, 0.6" Indent, Black on Orange;  
"CHURCH RD", Highway B 2K; "CLOSED BETWEEN", Highway B 2K;  
"CAMELOT PARK", Highway B 2K; "AND STATE ST", Highway B 2K;  
"FOLLOW DETOUR", Highway B 2K;

Table of widths and spaces

C	H	U	R	C	H	R	D							
17.5	2.6	0.0	2.7	-0.0	2.5	0.0	2.6	-0.0	2.6	4.2	2.6	-0.0	2.6	17.5
C	L	O	S	E	D									
11.3	2.6	0.0	2.3	-0.0	2.8	-0.0	2.5	0.0	2.3	0.0	2.6			
B	E	T	W	E	N									
4.2	2.6	-0.0	2.3	-0.0	2.2	0.0	3.8	0.0	2.3	0.0	2.3	-0.0	2.6	11.3
C	A	M	E	L	O	T								
13.2	2.6	-0.0	3.3	0.0	3.0	-0.0	2.3	-0.0	2.2	0.0	2.8	-0.0	2.3	
P	A	R	K											
4.1	2.6	0.0	3.3	-0.0	2.6	0.0	2.7	13.2						
A	N	D												
4.1	3.3	0.0	2.6	-0.0	2.5	12.9								
S	T	A	T	E	S	T								
19.1	2.6	0.0	2.3	0.0	3.2	0.0	2.3	0.0	2.3	4.2	2.6	-0.0	2.3	19.1
F	O	L	L	O	W									
12.3	2.3	-0.0	2.8	-0.0	2.2	-0.0	2.3	-0.0	2.7	0.0	3.8			
D	E	T	O	U	R									
4.2	2.6	0.0	2.3	-0.0	2.3	-0.0	2.7	0.0	2.6	-0.0	2.6	12.3		

SPECIAL-02  
60 "X54 "

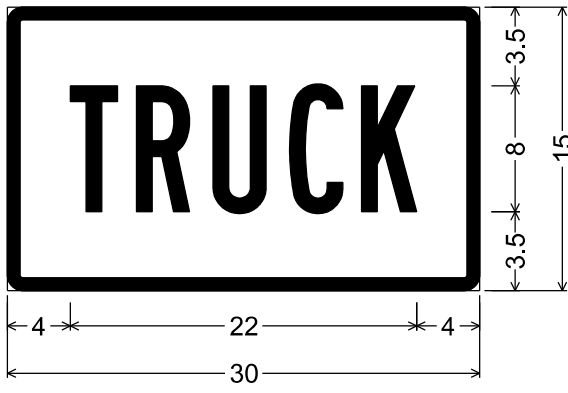

1.0" Radius, 0.8" Border, Black on Orange;  
"TRUCK", B;  
Table of widths and spaces

T	R	U	C	K						
4.0	3.0	1.2	3.4	1.5	3.3	1.5	3.4	1.2	3.5	4.0

SPECIAL-07  
30 "X15 "

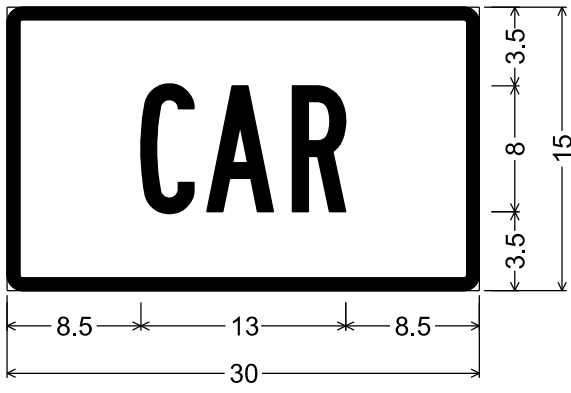

1.0" Radius, 0.8" Border, Black on Orange;  
"CAR", B;  
Table of widths and spaces

C	A	R				
8.5	3.4	0.8	4.2	1.2	3.4	8.5

SPECIAL-08  
30 "X15 "

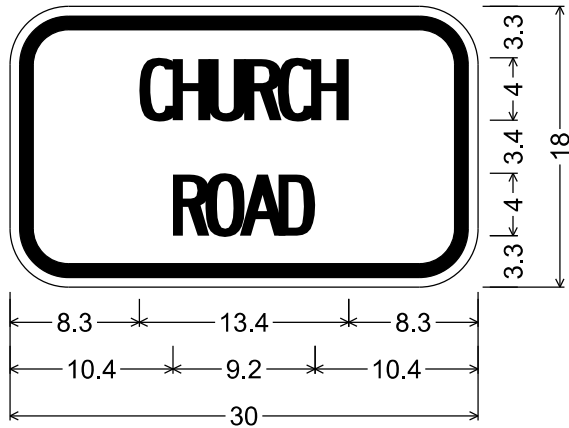

3.8" Radius, 0.9" Border, 0.6" Indent, Black on Orange;  
"CHURCH", B; "ROAD", B;  
Table of widths and spaces

C	H	U	R	C	H			
8.3	1.7	0.6	1.7	0.7	1.7	0.6	1.7	8.3
R	O	A	D					
10.4	1.7	0.6	1.8	0.6	2.2	0.6	1.7	10.4

SPECIAL-03  
30 "X18 "

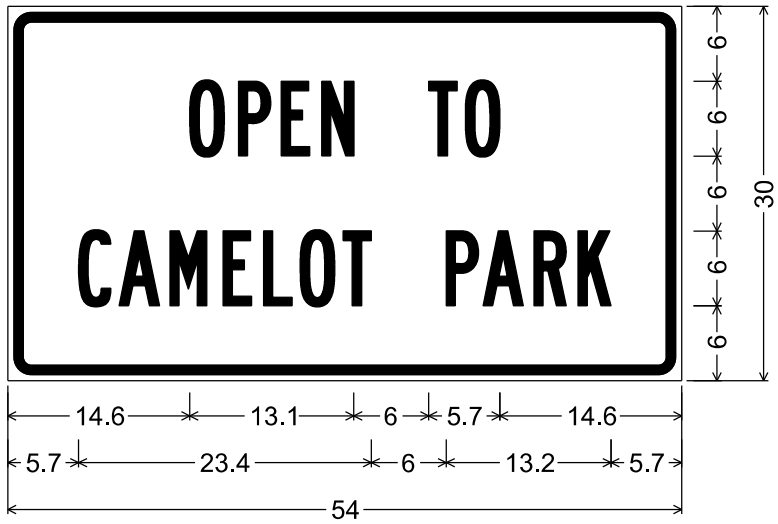

1.9" Radius, 0.8" Border, 0.5" Indent, Black on Orange;  
"OPEN TO", B 2K; "CAMELOT PARK", B 2K;

Table of widths and spaces

O	P	E	N	T	O								
14.6	2.7	1.2	2.6	0.8	2.3	0.9	2.6	6.0	2.3	0.7	2.7	14.6	
C	A	M	E	L	O								
5.7	2.5	0.7	3.2	0.9	2.9	1.3	2.3	1.0	2.3	0.6	2.8	0.6	2.3
P	A	R	K										
6.0	2.6	0.4	3.2	0.8	2.6	1.0	2.6	5.7					

SPECIAL-04  
54 "X30 "

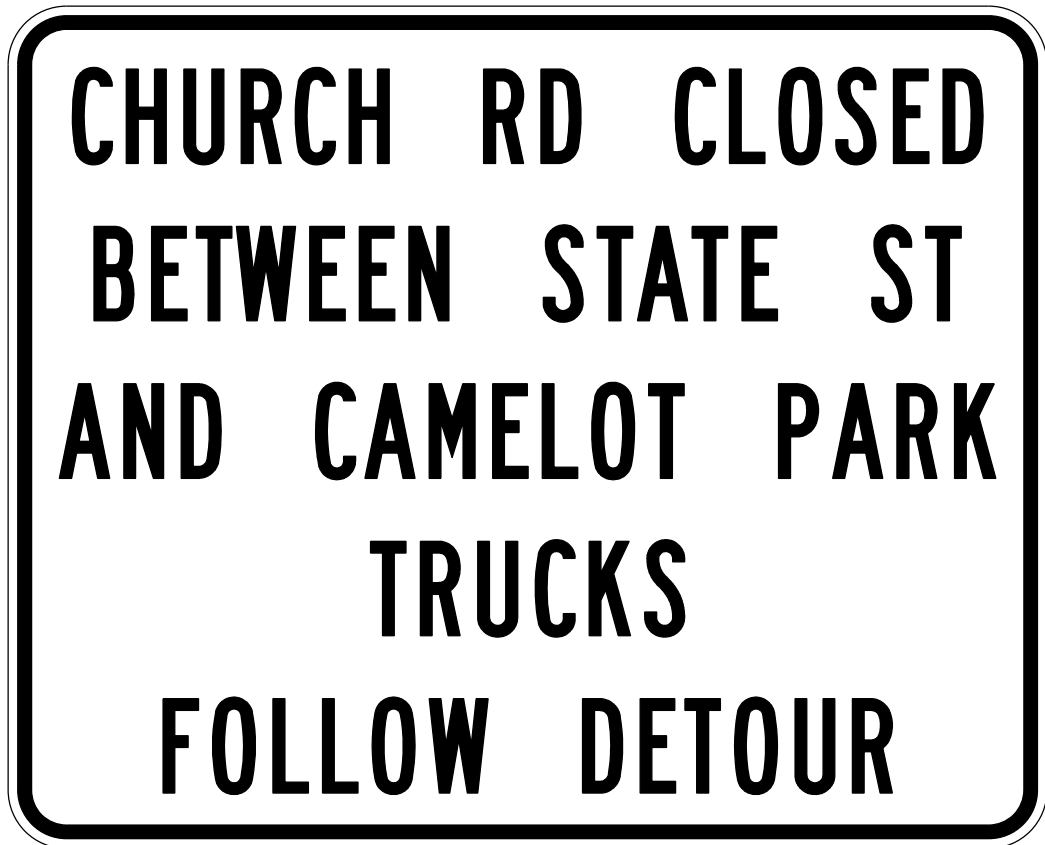

4.1	20.1	6	6.2	6	19.5	4.1
5.5	22.5	6	14.9	6	5.6	5.5
3.3	10.2	6	23.4	6	13.8	3.3
	23		20		23	
9.8	20.7	6	19.7		9.8	
66						

SPECIAL-09  
66 "X54 "

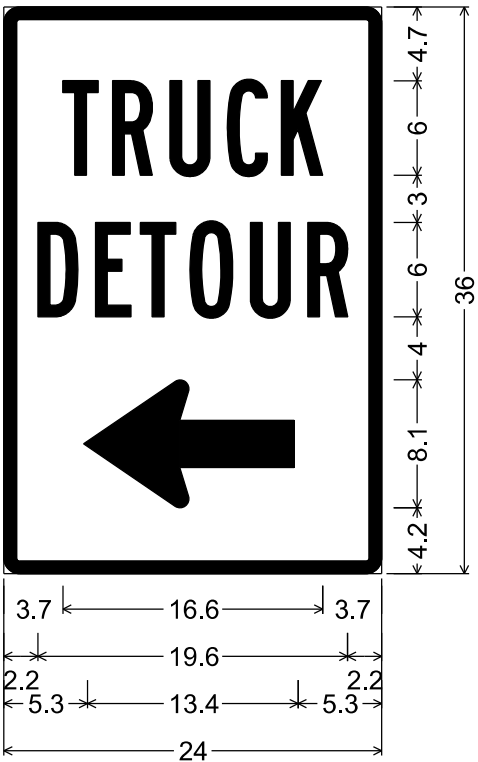

1.0" Radius, 0.8" Border, Black on Orange;  
"TRUCK", B;  
"DETOUR", B;  
Standard Arrow Custom 13.4" X 8.1" 0";  
Table of widths and spaces

T	R	U	C	K								
3.7	2.3	0.9	2.5	1.1	2.6	1.1	2.5	0.9	2.7	3.7		
D	E	T	O	U	R							
2.2	2.5	1.1	2.3	0.6	2.2	0.9	2.7	1.2	2.5	1.1	2.5	2.2
5.3	← 13.4	5.3										

SPECIAL-05  
24 "X36 "

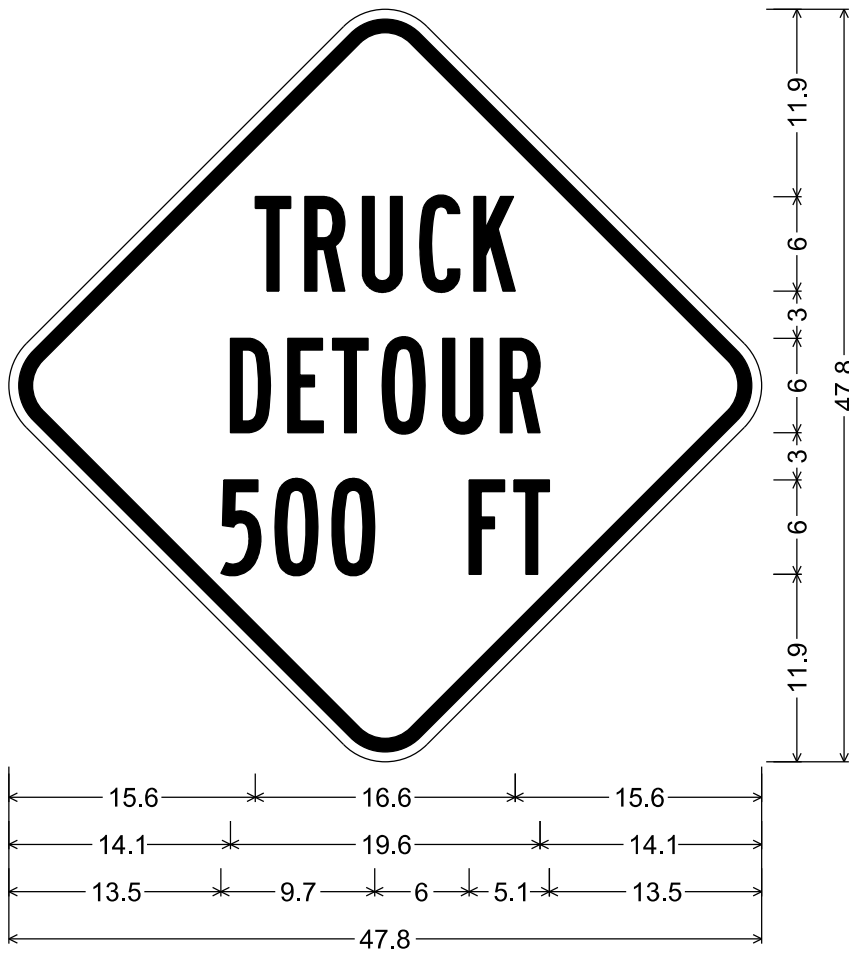

36.0" across sides 3.8" Radius, 0.9" Border, 0.6" Indent, Black on Orange;  
"TRUCK", B; "DETOUR", B; "500 FT", B;

Table of widths and spaces

15.6	T	2.3	0.9	R	2.5	1.1	U	2.6	1.1	C	2.5	0.9	K	2.7	15.6			
14.1	D	2.5	1.1	E	2.3	0.6	T	2.2	0.9	O	2.7	1.2	U	2.5	1.1	R	2.5	14.1
13.5	5	2.5	0.9	0	2.7	0.9	0	2.7	6.0	F	2.3	0.6	T	2.2	13.5			

SPECIAL-10  
36 "X36 "

DETOUR  
SR 1042 CHURCH ROAD  
46-1042-0060-0000  
MONTGOMERY COUNTY

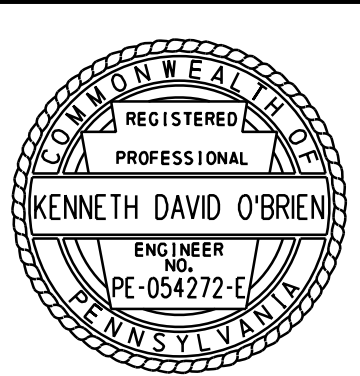

TRAFFIC CONTROL PLAN

USER: CMCMAHON PLOT: DRIVER: PennDOT - PDF - Mono - Plot - 111616g PLOT DATE: 03-03-2025 3:37:58 PM  
PATH: c:\pwork\eng\res\1042\1479912\ FILE: SR 1042-CHURCH-GROUP-V-PLAN-1-Car.dgn  
MODEL: TCP Sheet 1

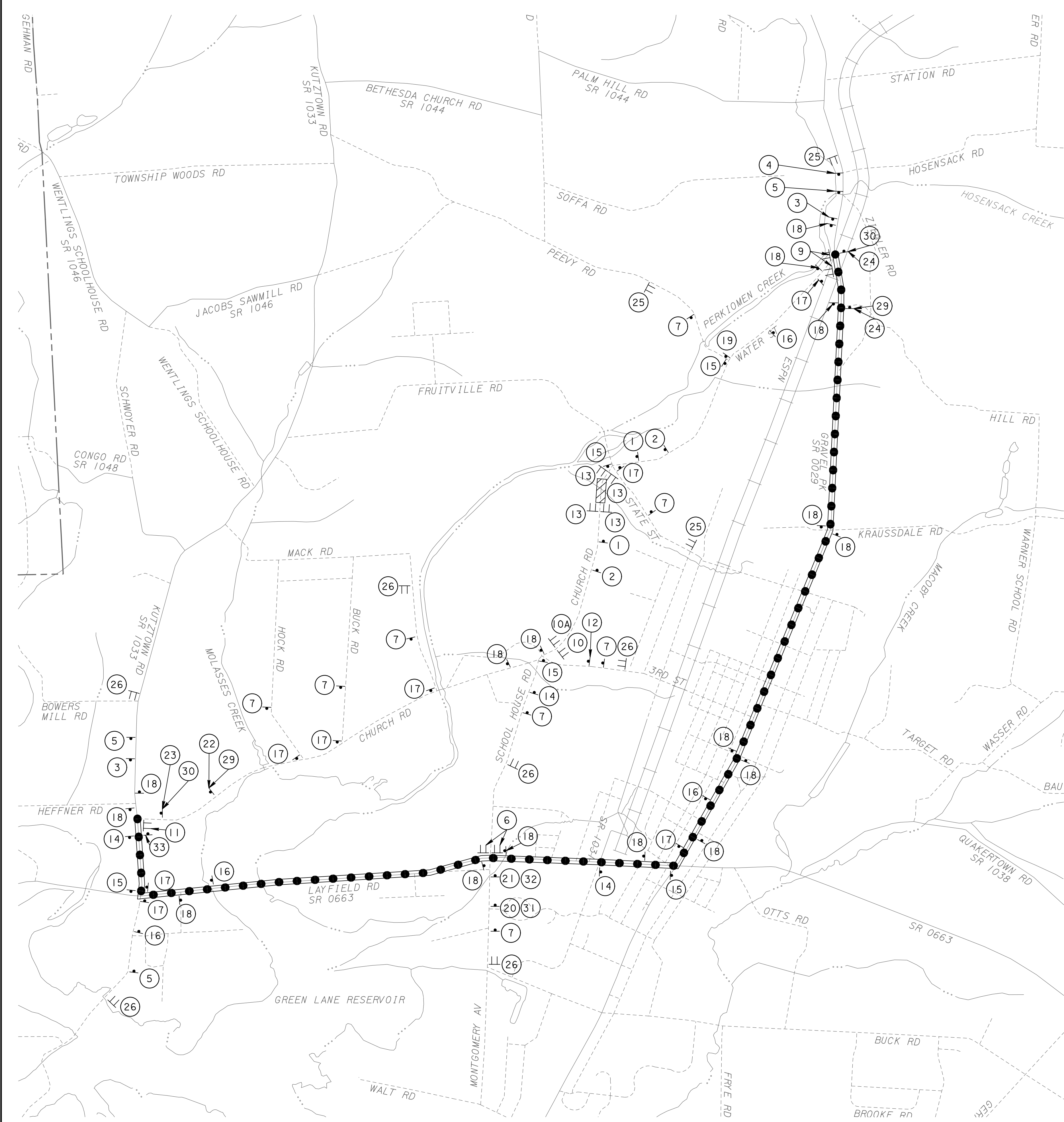

LENGTH OF DETOUR - 4.50 MILES



DISTRICT	COUNTY	ROUTE	SECTION	SHEET
6-0	MONTGOMERY	1042	HBV	16 OF 31
UPPER HANOVER TOWNSHIP				
REVISION NUMBER	REVISIONS		DATE	BY

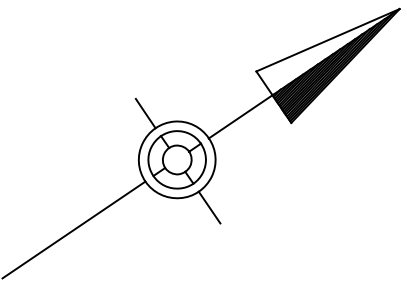

LEGEND

- DETOUR ROUTE
- STATE ROUTE
- LOCAL ROUTE
- MUNICIPAL BOUNDARY
- WATER/STREAM
- CLOSURE AREA
- SIGN
- TYPE III BARRICADE WITH SIGN

CAR DETOUR  
SR 1042 CHURCH ROAD  
46-1042-0060-0000  
MONTGOMERY COUNTY

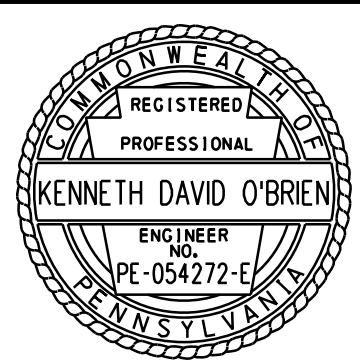

TRAFFIC CONTROL PLAN

USER: CMCMAHON PLOT: DRIVER: PENDING PDF: Memo.plt: fgs PLOT DATE: 03-03-2025 3:37:59 PM  
PATH: c:\pwork\eng\veg\101\1479912\ FILE: SR 1042-CHURCH-GROUP-V.plt: 101-1-Truck.dgn  
MODEL: TCP Sheet 1

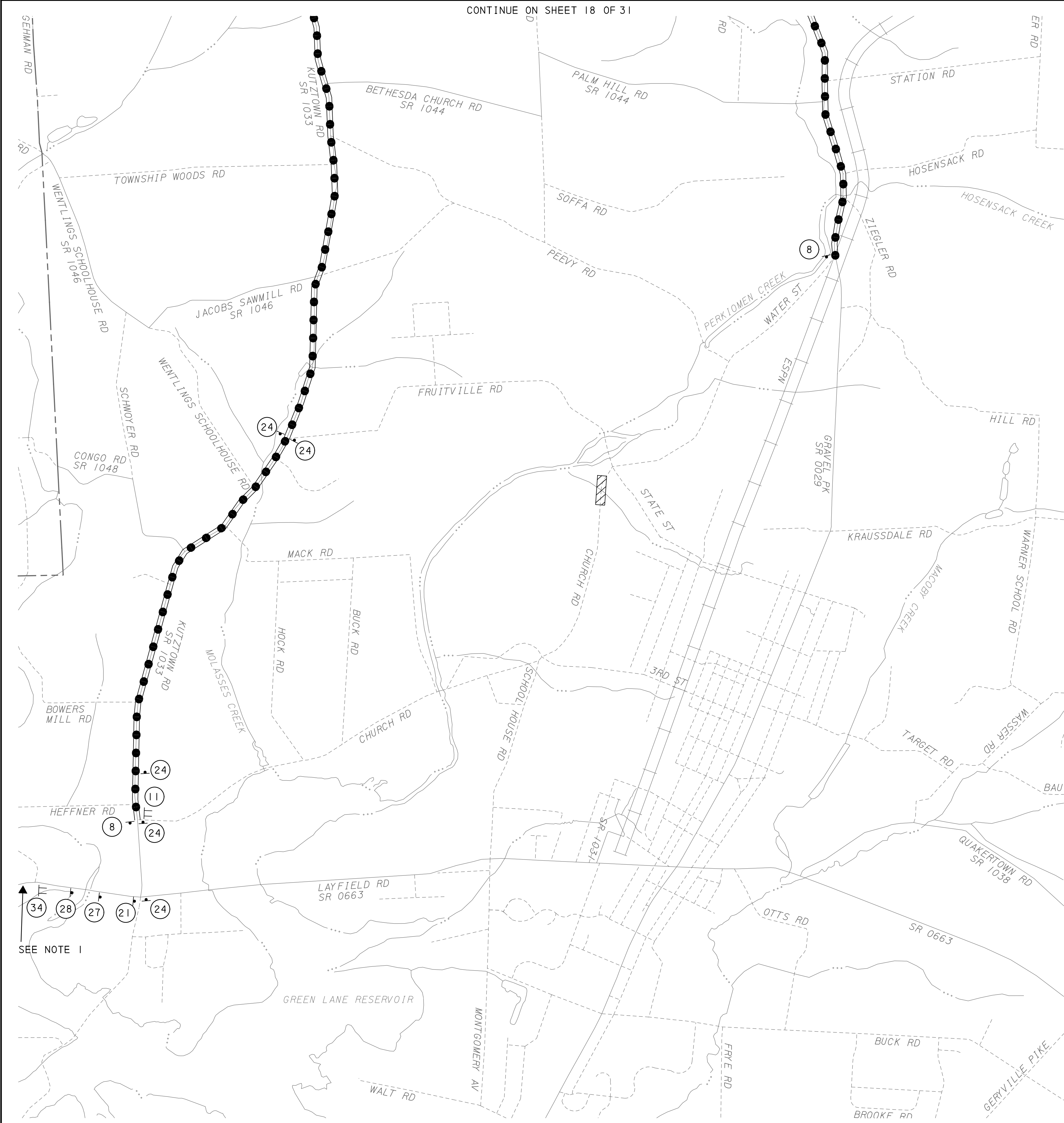

CONTINUE ON SHEET 18 OF 31

DISTRICT	COUNTY	ROUTE	SECTION	SHEET	
6-0	MONTGOMERY	1042	HBV	17 OF 31	
UPPER HANOVER TOWNSHIP					
REVISION NUMBER	REVISIONS			DATE	BY

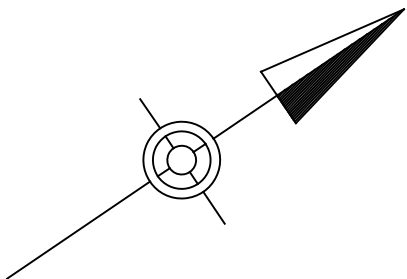

CHANGEABLE MESSAGE SIGN

SCHOOL  
HOUSE RD  
CLOSED

SUGGESTED  
MESSAGE 1

FOLLOW  
TRUCK  
DETOUR

SUGGESTED  
MESSAGE 2

EACH MESSAGE SHOULD BE DISPLAYED FOR 1.5 SECONDS

NOTES:

- 1.) PLACE PORTABLE CHANGEABLE MESSAGE SIGN AT LOCATION IN ADVANCE OF FIRST LEAD IN SIGN. FINAL LOCATION OF MESSAGE BOARD SHALL BE DETERMINED BY THE INSPECTOR IN CHARGE.

LEGEND

- DETOUR ROUTE
- STATE ROUTE
- LOCAL ROUTE
- MUNICIPAL BOUNDARY
- WATER/STREAM
- CLOSURE AREA
- SIGN
- TYPE III BARRICADE WITH SIGN

LENGTH OF DETOUR - 9.10 MILES

SCALE  
0 1000 2000 FEET

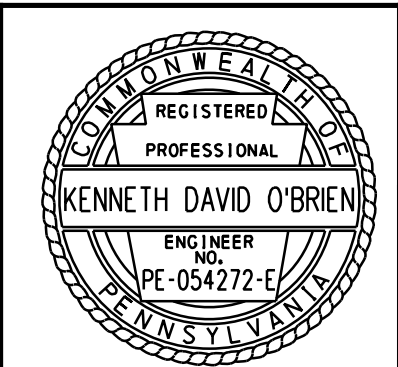

TRUCK DETOUR  
SR 1042 CHURCH ROAD  
46-1042-0060-0000  
MONTGOMERY COUNTY

TRAFFIC CONTROL PLAN

DES: EBN DWG: CTM CKD: JKW



USER: CMCAHON PLOT DRIVER: PenDOT\_PDF\_Memo.pltcfgr PLOT DATE: 03-03-2025 3:38:00 PM  
PATH: c:\pwork\eng\veg\101\1479912\ FILE: SR 1042-CHURCH-GROUP-V\_PLN01\_L\_Truck.dgn  
MODEL: TCP Sheet 2

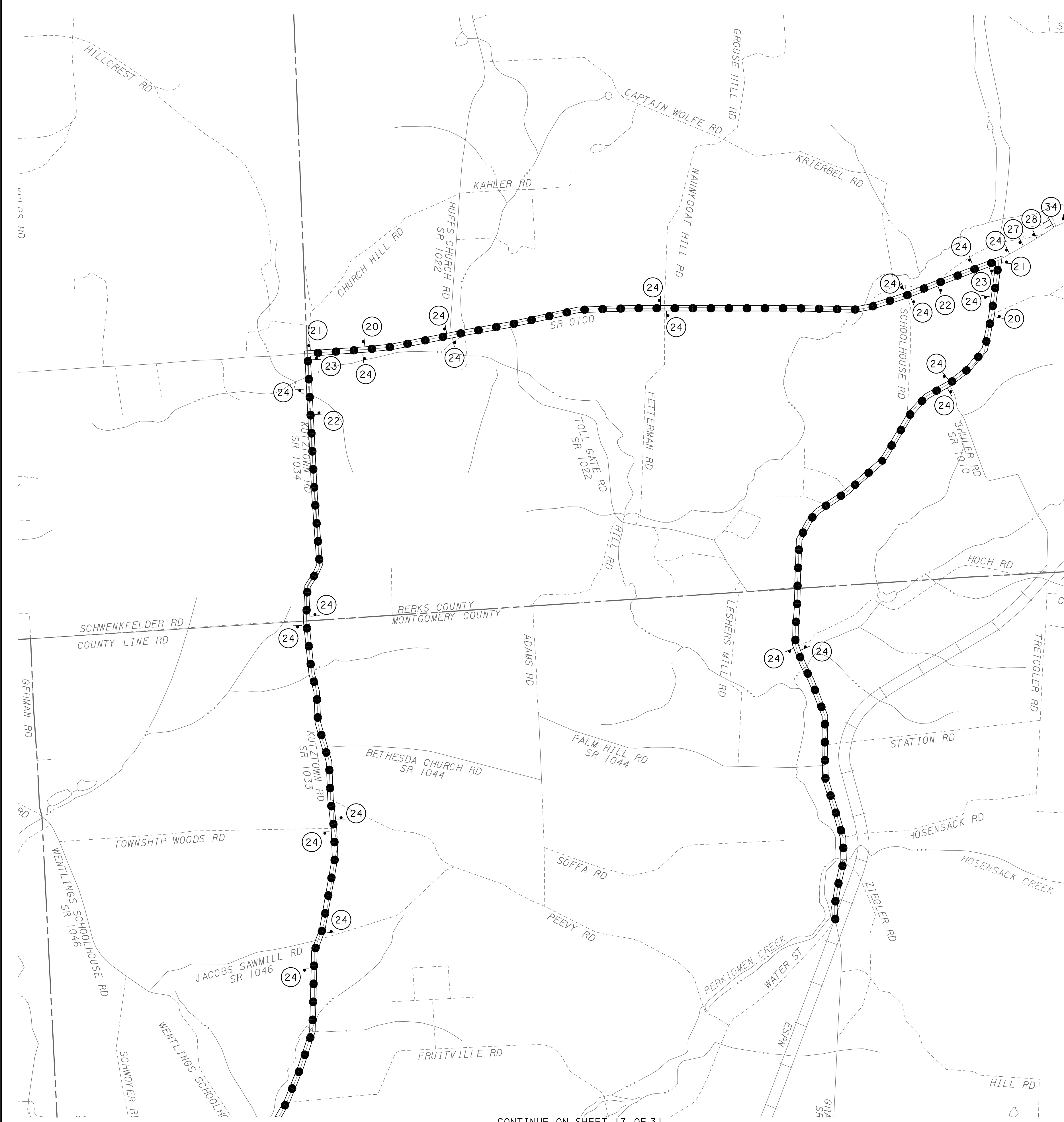

DISTRICT	COUNTY	ROUTE	SECTION	SHEET	
6-0	MONTGOMERY	1042	HBV	18 OF 31	
UPPER HANOVER TOWNSHIP					
REVISION NUMBER	REVISIONS			DATE	BY

SEE NOTE 1

CHANGEABLE MESSAGE SIGN

SCHOOL  
HOUSE RD  
CLOSED

SUGGESTED  
MESSAGE 1

FOLLOW  
TRUCK  
DETOUR

SUGGESTED  
MESSAGE 2

EACH MESSAGE SHOULD BE DISPLAYED FOR 1.5 SECONDS

- NOTES:
- 1.) PLACE PORTABLE CHANGEABLE MESSAGE SIGN AT LOCATION IN ADVANCE OF FIRST LEAD IN SIGN. FINAL LOCATION OF MESSAGE BOARD SHALL BE DETERMINED BY THE INSPECTOR IN CHARGE.

LEGEND

- DETOUR ROUTE
- STATE ROUTE
- LOCAL ROUTE
- MUNICIPAL BOUNDARY
- WATER/STREAM
- CLOSURE AREA
- SIGN
- TYPE III BARRICADE WITH SIGN

LENGTH OF DETOUR - 9.10 MILES

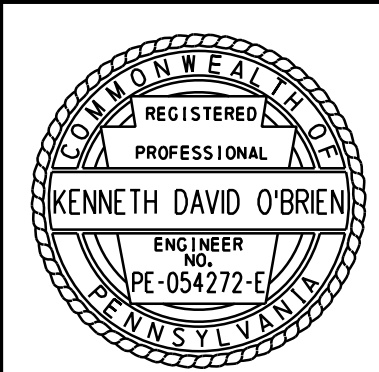

TRUCK DETOUR  
SR 1042 CHURCH ROAD  
46-1042-0060-0000  
MONTGOMERY COUNTY

TRAFFIC CONTROL PLAN