

PLOTTED: 18-JUL-2025 15:38

DISTRICT	COUNTY	ROUTE	SECTION	SHEET		
5-0	MONROE	2021	01B	3	OF 5	
SMITHFIELD TOWNSHIP						
REV NO	REVISIONS			DATE	BY	APPD

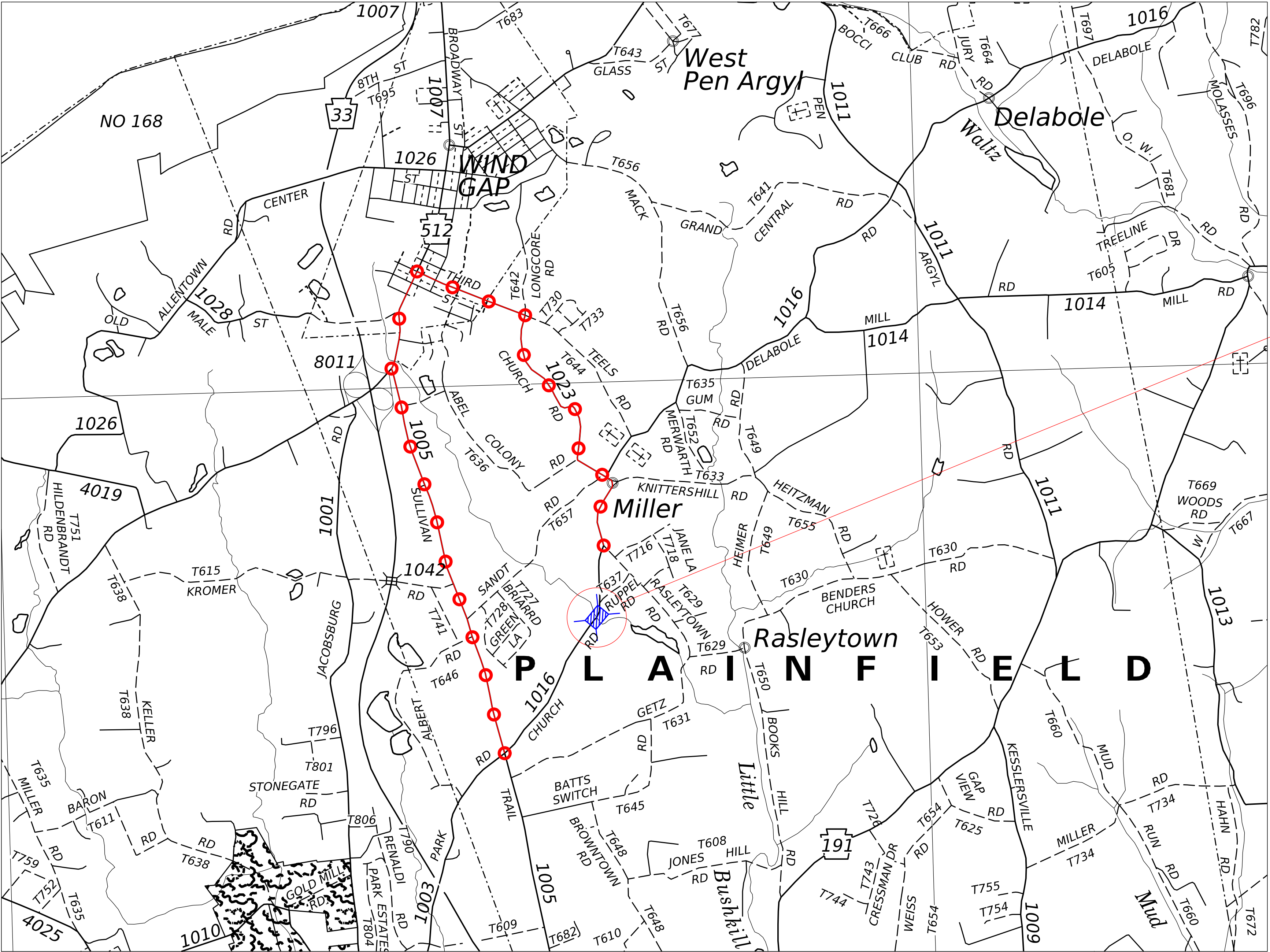

PROJECT LOCATION

LEGEND

- PROJECT WORK AREA
- TOWNSHIP ROAD
- STATE HIGHWAY
- MUNICIPAL / TOWNSHIP LINE
- DETOUR ROUTE
- TOWNSHIP ROUTE NO.
- STATE ROUTE NO.
- STATE MAINTAINED BRIDGE

Anticipated Detour Duration: 9 months

DETOUR LENGTH = 4.3 MILES

