

SR 1024-88H - INFORMATION & DISPLAY LAYOUT

Good evening.

The display boards are organized for viewing in a clockwise direction.

The board number is located in the top right corner of each display board.

Across from Board 10, there are tables and chairs for completing a comment form.

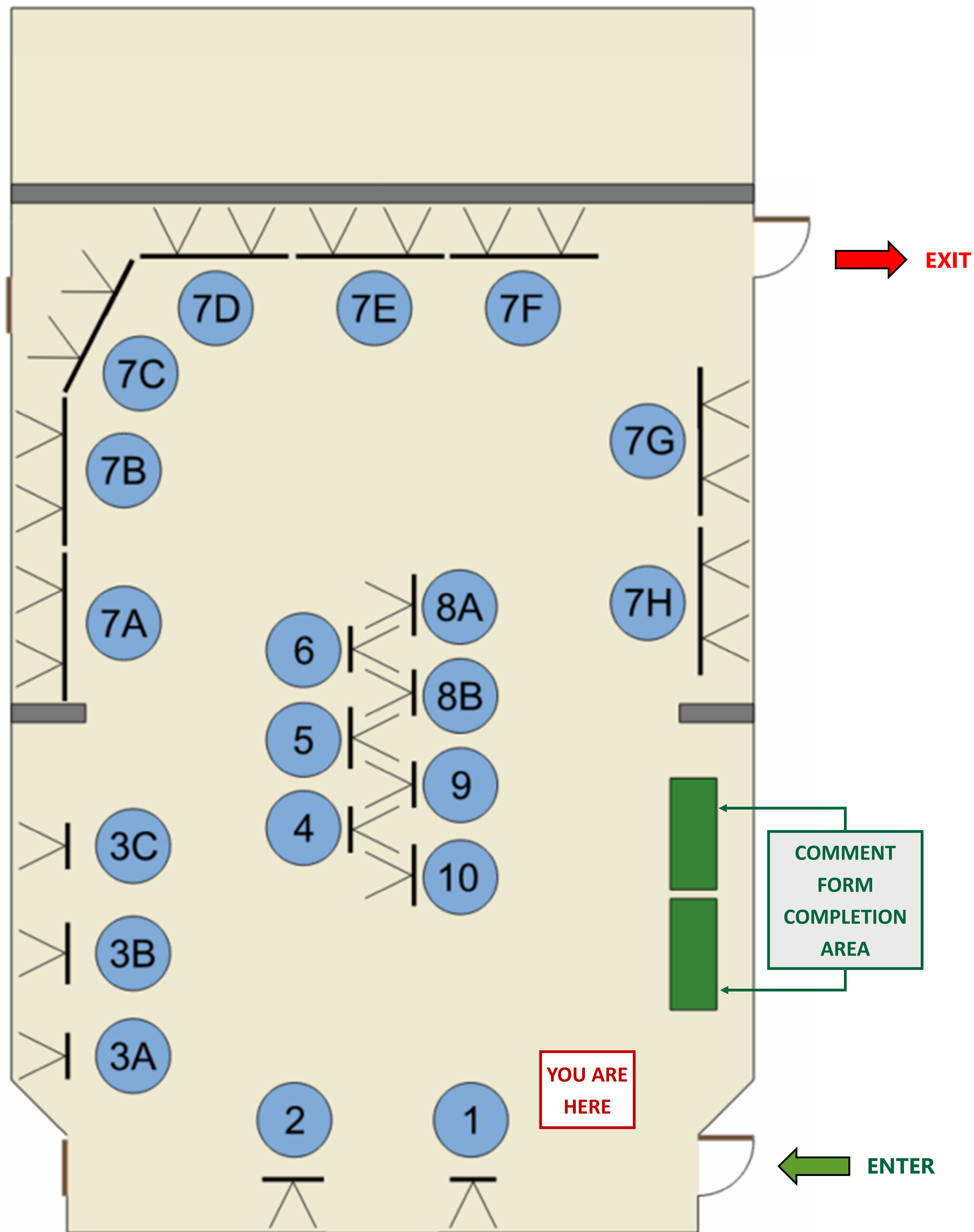

BOARD 1: INFORMATION & DISPLAY LAYOUT

- DISPLAY LAYOUT

BOARD 2: EXISTING CONDITIONS

- EXISTING ROADWAY CONCERNS & CRASHES
- EXISTING TYPICAL ROADWAY SECTION

BOARDS 3 A - C: TRAFFIC VOLUMES

- HISTORIC TRAFFIC VOLUME
- CURRENT TRAFFIC VOLUME
- ANTICIPATED FUTURE TRAFFIC

BOARD 4: PURPOSE & NEEDS

- PROJECT PURPOSE & NEEDS
- PROPOSED IMPROVEMENTS

BOARD 5: ENVIRONMENTAL FEATURES

- ENVIRONMENTAL FEATURES MAP

BOARD 6: PROPOSED ROADWAY DESIGN

- ROADWAY DESIGN

BOARDS 7 A – H: PROPOSED IMPROVEMENTS

- 7A: PA 147 TO LAHRS RD
- 7B: LAHRS RD TO STONE SCHOOL RD
- 7C: STONE SCHOOL RD TO EAST OF STRAWBRIDGE RD
- 7D: EAST OF STRAWBRIDGE RD TO EAST OF NEITZ RD
- 7E: EAST OF NEITZ RD TO ROUSH RD
- 7F: ROUSH RD TO BULK PLANT RD
- 7G: BULK PLANT RD TO EAST OF DORNISIFE RD
- 7H: EAST OF DORNISIFE RD TO US 11

BOARDS 8 A, B: TRAFFIC CONTROL

- PROPOSED STRATEGIES FOR MAINTAINING TRAFFIC DURING CONSTRUCTION

BOARD 9: RIGHT-OF-WAY ACQUISITION

- STEPS BEFORE RIGHT-OF-WAY ACQUISITION CAN BEGIN
- ANTICIPATED TIMEFRAME

BOARD 10: NEXT STEPS AND ANTICIPATED TIMELINE

- PROJECT SCHEDULE

