

VIRTUAL PUBLIC PLANS DISPLAY

SR 2008 (RED MILL ROAD) MCNEES BRIDGE REPLACEMENT OVER MILL RUN KITTINGING TOWNSHIP, ARMSTRONG COUNTY



PATRICK HOFFMAN, P.E. APRIL 2026

PENNDOT BY THE NUMBERS



*Total miles on all PA roadways



PROJECT PURPOSE

- The purpose of this presentation is to introduce the project to the public, gather feedback, and present the preliminary project design.
- The purpose of this project is to replace the existing poor condition structure that carries SR 2008 (Red Mill Road) over Mill Run in Kittanning Township, Armstrong County with a sustainable crossing.



PROJECT LOCATION

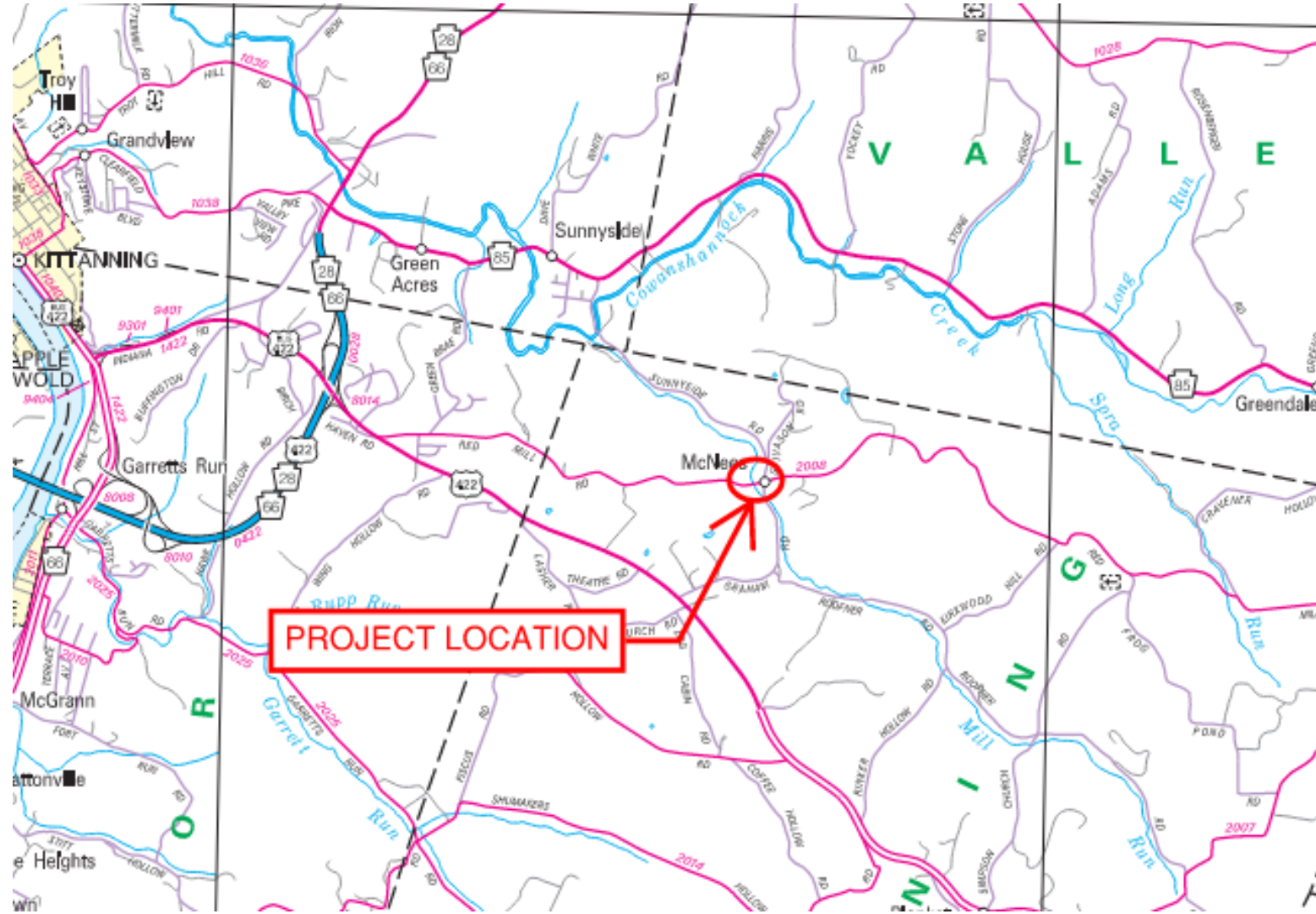

EXISTING STRUCTURE SUMMARY

- Overall condition of the existing structure carrying SR 2008 (Red Mill Road) over Mill Run is poor.
- Existing Structure – Single Span Concrete T-beams with Stone Masonry Abutments built in 1941.
- Total Length – 37 ft. (32 ft. clear span and 24 ft. curb-to-curb width).
- Average Daily Traffic (ADT) – 173 vehicles.
- Speed Limit – 40 mph.



PROJECT IMPROVEMENTS

- Proposed Structure – Single Span Prestressed Concrete Spread Box Beams with Integral Abutments.
- Replacement – Same location as existing.
- Total Length – 47 ft. (29 ft. clear span and 26 ft. curb-to-curb width).
- Road Reconstruction:
 - East approach approximately 145 ft.
 - West approach approximately 115 ft.
- Guide Rail Updates.
- Estimated Construction Cost - \$1,250,000.



PLAN VIEW

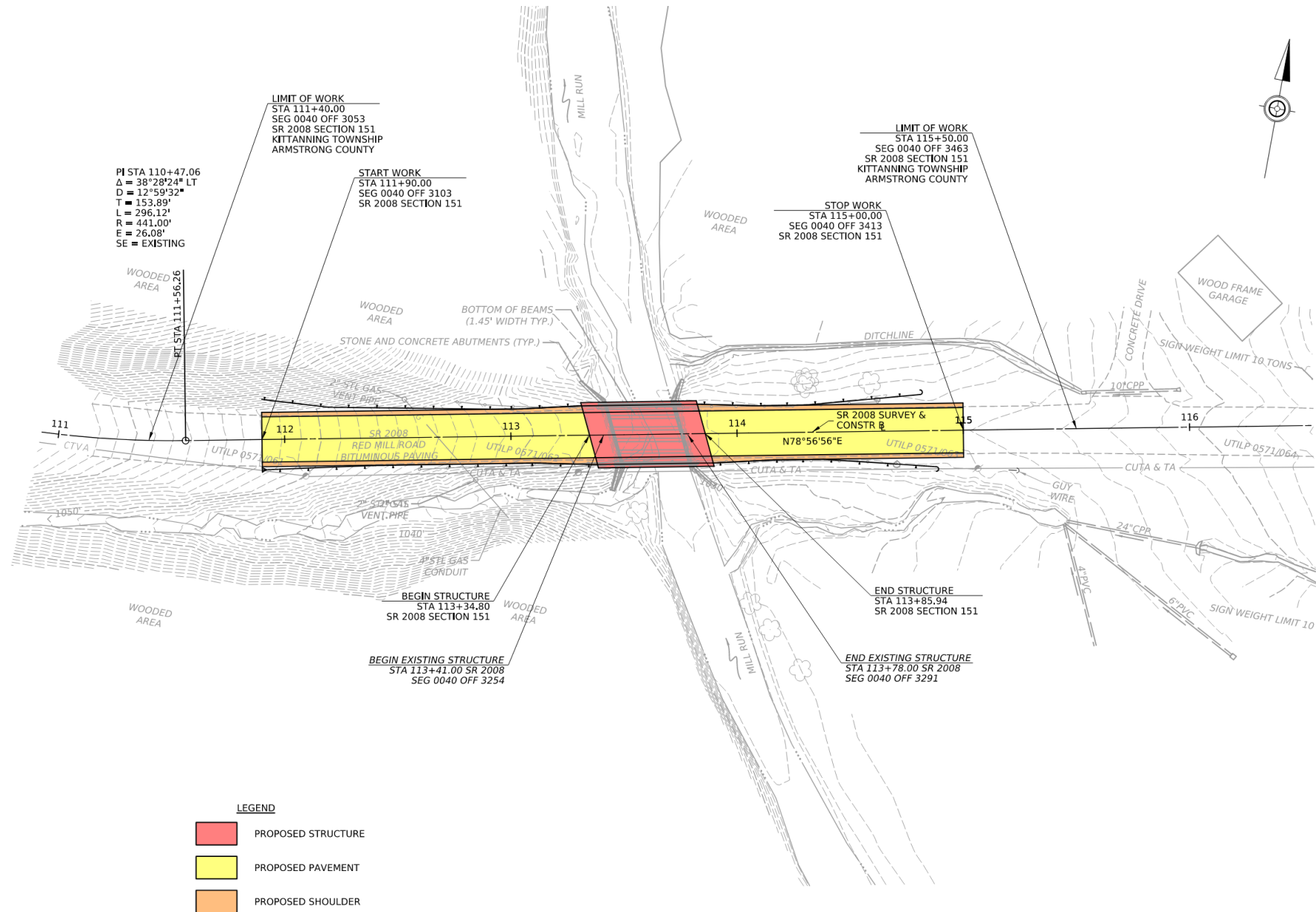

LEGEND

	PROPOSED STRUCTURE
	PROPOSED PAVEMENT
	PROPOSED SHOULDER



PROPOSED STRUCTURE

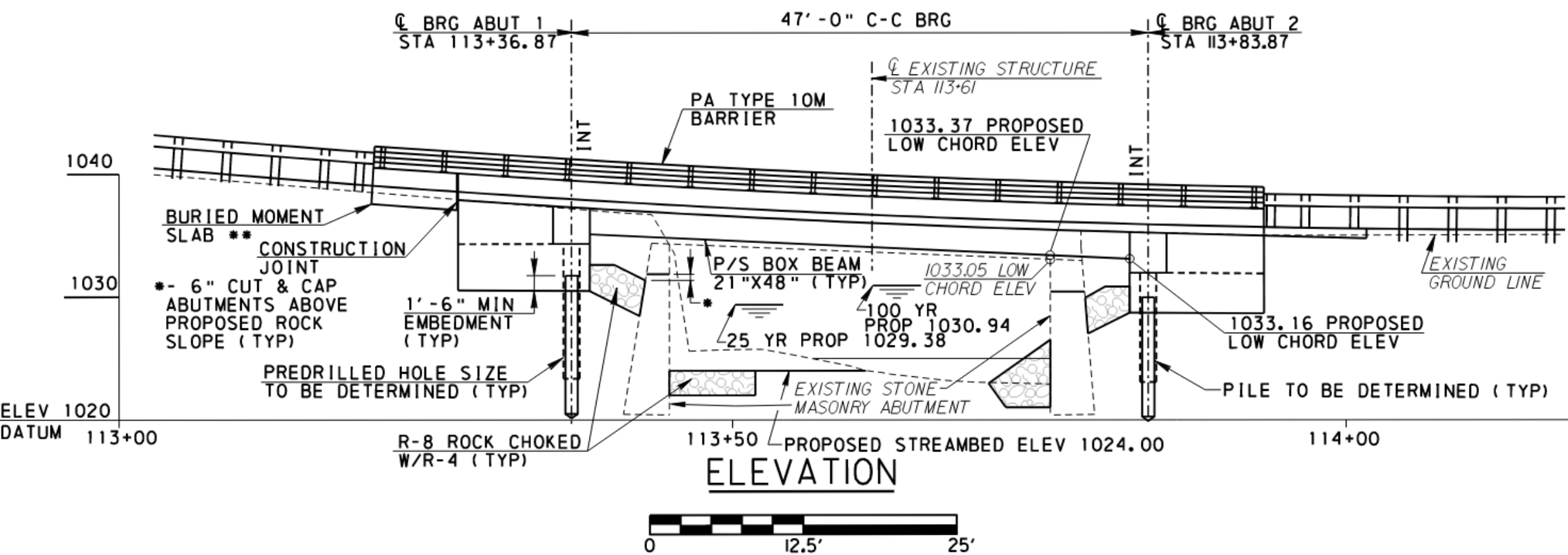

TYPICAL SECTION

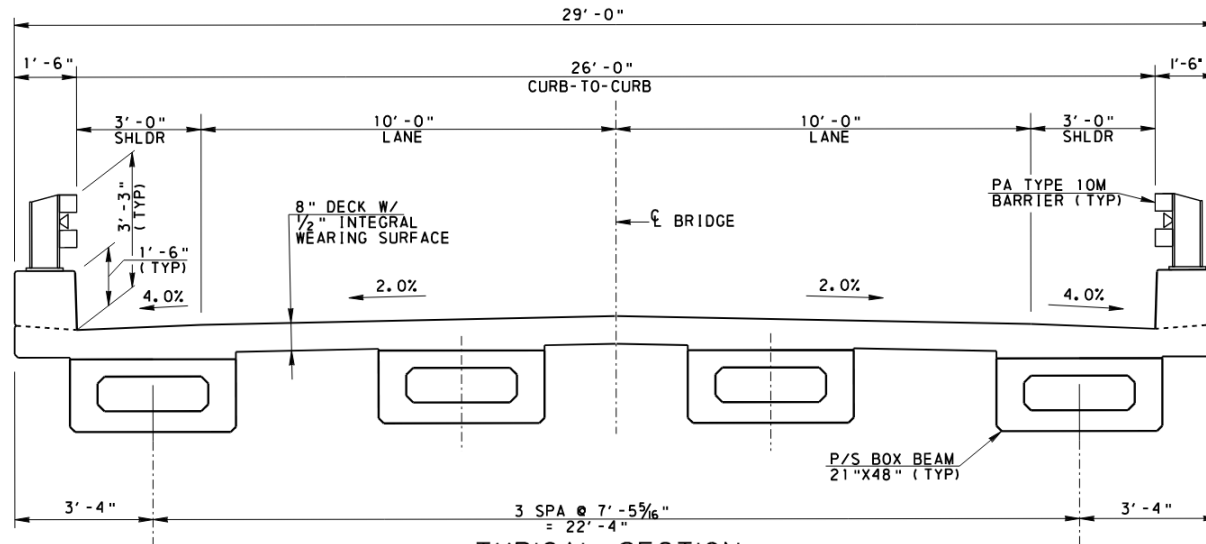

TYPICAL SECTION

0 6" 1' 2' 3' 4'

SCALE: 1/2" = 1'-0"

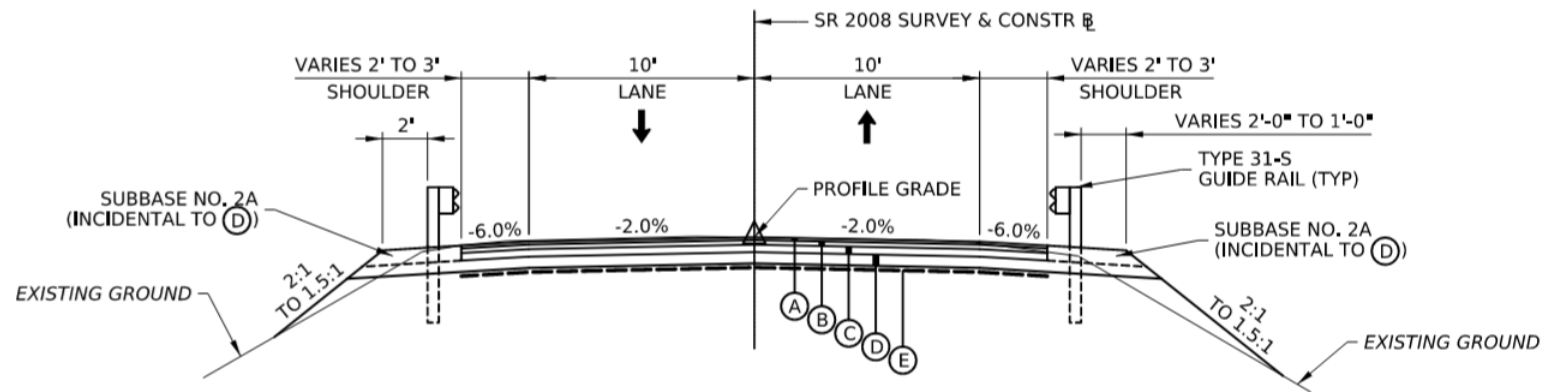

SR 2008 (RED MILL ROAD)
TYPICAL ROADWAY SECTION

NOT TO SCALE

STA 111+90.00 TO STA 113+34.80
STA 113+85.94 TO STA 115+00.00



TRAFFIC CONTROL - DETOUR

- Preferred method of traffic control – Detour.
- Detour Length – 17 miles (Approximately 26 minutes)
- Detour – SR 2008 (Red Mill Rd) to SR 422 (Benjamin Franklin Hwy) to SR 66/28 to SR 85 to SR 2005 (Margaret Rd) to SR 2008 (Red Mill Rd).
- Closure Length – Approximately 6 months.

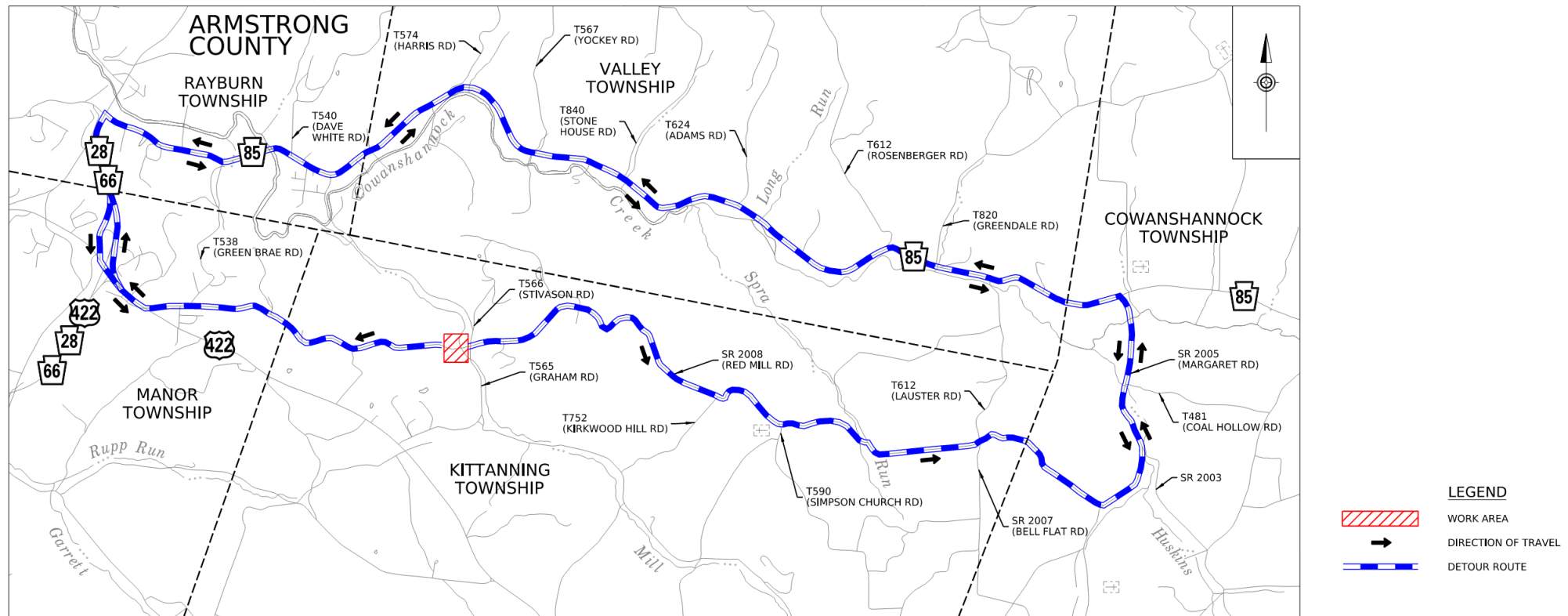

NOT TO SCALE



ANTICIPATED PROJECT SCHEDULE

- Complete Preliminary Engineering: Spring 2026
- Final Design: Fall 2027
- Let Date: Fall 2027
- Project Construction: April 2028 to October 2028



PROJECT SURVEY

Please complete the Project Survey

- The project survey can be found on the project website.
- Click the tile under resources labeled “Submit Comments” on the right-hand side of the screen.

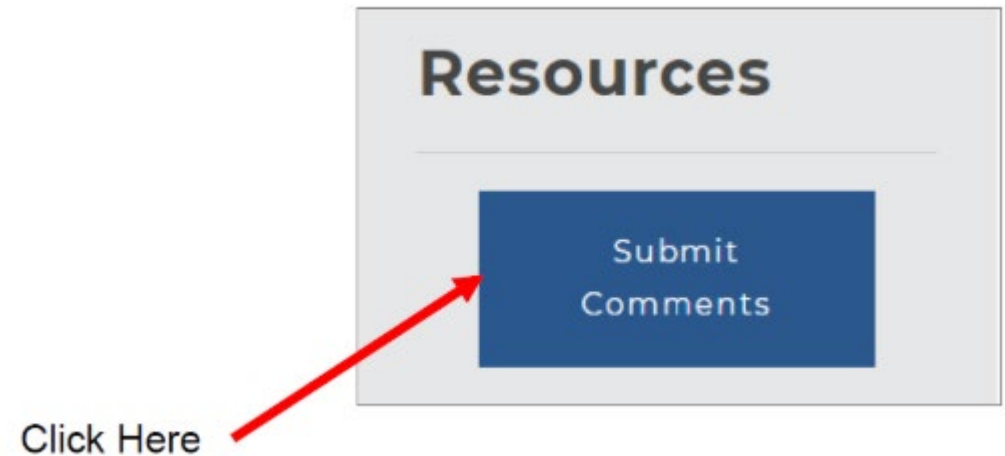

PROJECT CONTACT

Patrick J. Hoffman, P.E. – Assistant Bridge Engineer – Design

724-357-2964

PennDOT Engineering District 10-0

2550 Oakland Avenue

Indiana, PA 15701

patrihoffm@pa.gov



FOLLOW PENNDOT



www.pa.gov/penndot



www.pa.gov/dmv



PennsylvaniaDepartmentofTransportation



PennDOTNews



PennsylvaniaDOT



PennDOTSec



/company/PennDOT



PennDOTSec



PennsylvaniaDOT



Pennsylvania
Department of Transportation

THANK YOU!