

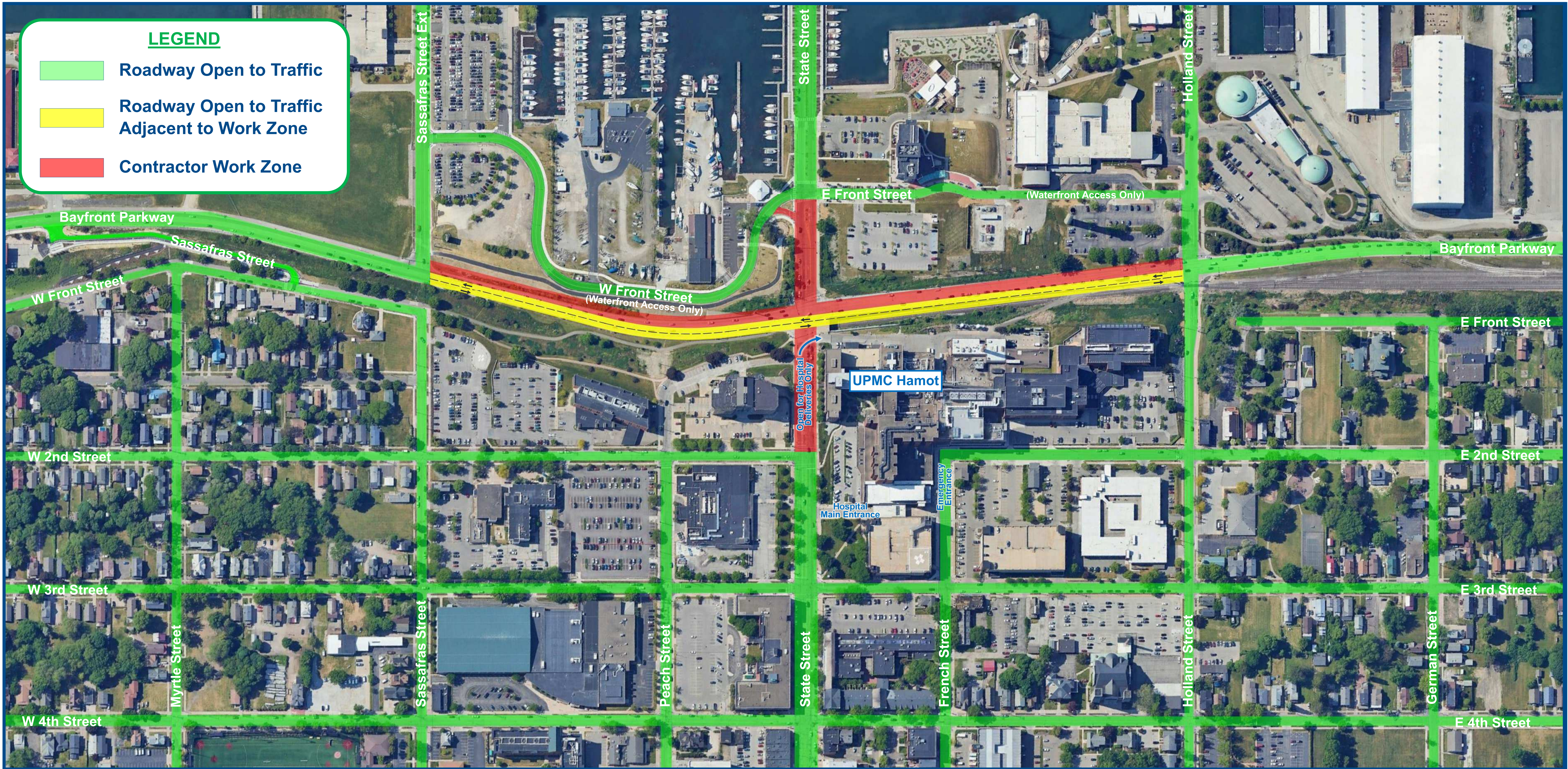

Original Construction Work Zone Limits

BAYFRONT PARKWAY
CENTRAL CORRIDOR IMPROVEMENTS

CITY OF ERIE, PA





Original State Street Construction Sequence

BAYFRONT PARKWAY
CENTRAL CORRIDOR IMPROVEMENTS

CITY OF ERIE, PA

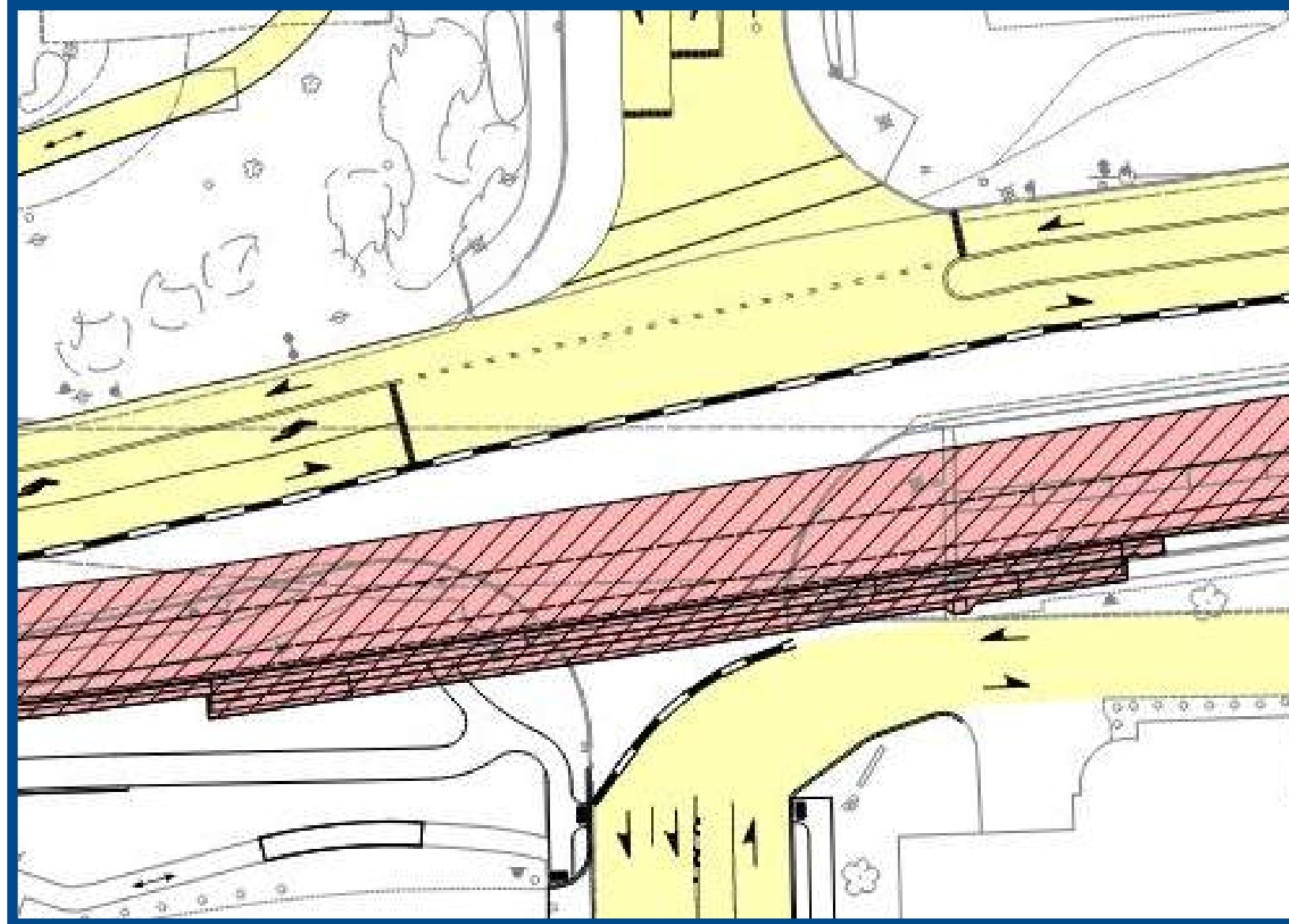

Stage 2

~6 Month Duration

Construct South Abutment
Bayfront @ State North Maintained
Pedestrians Detoured to Holland

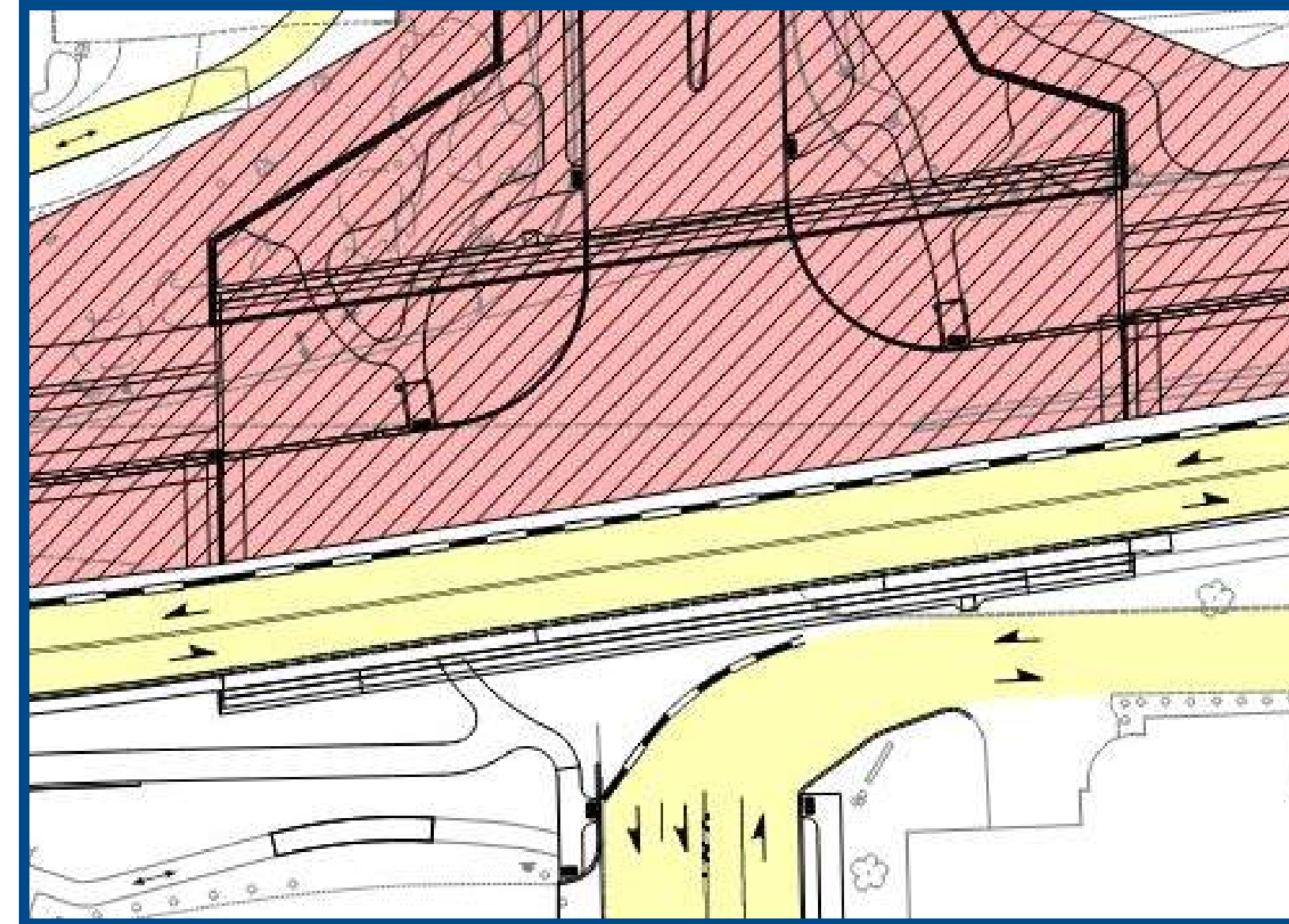

Stage 3

~12 Month Duration

Construct North Abutment
Construct State St Bridge Deck
Bayfront Pwky EB/WB Maintained
State St NB/SB Detoured
Pedestrians Detoured to Holland

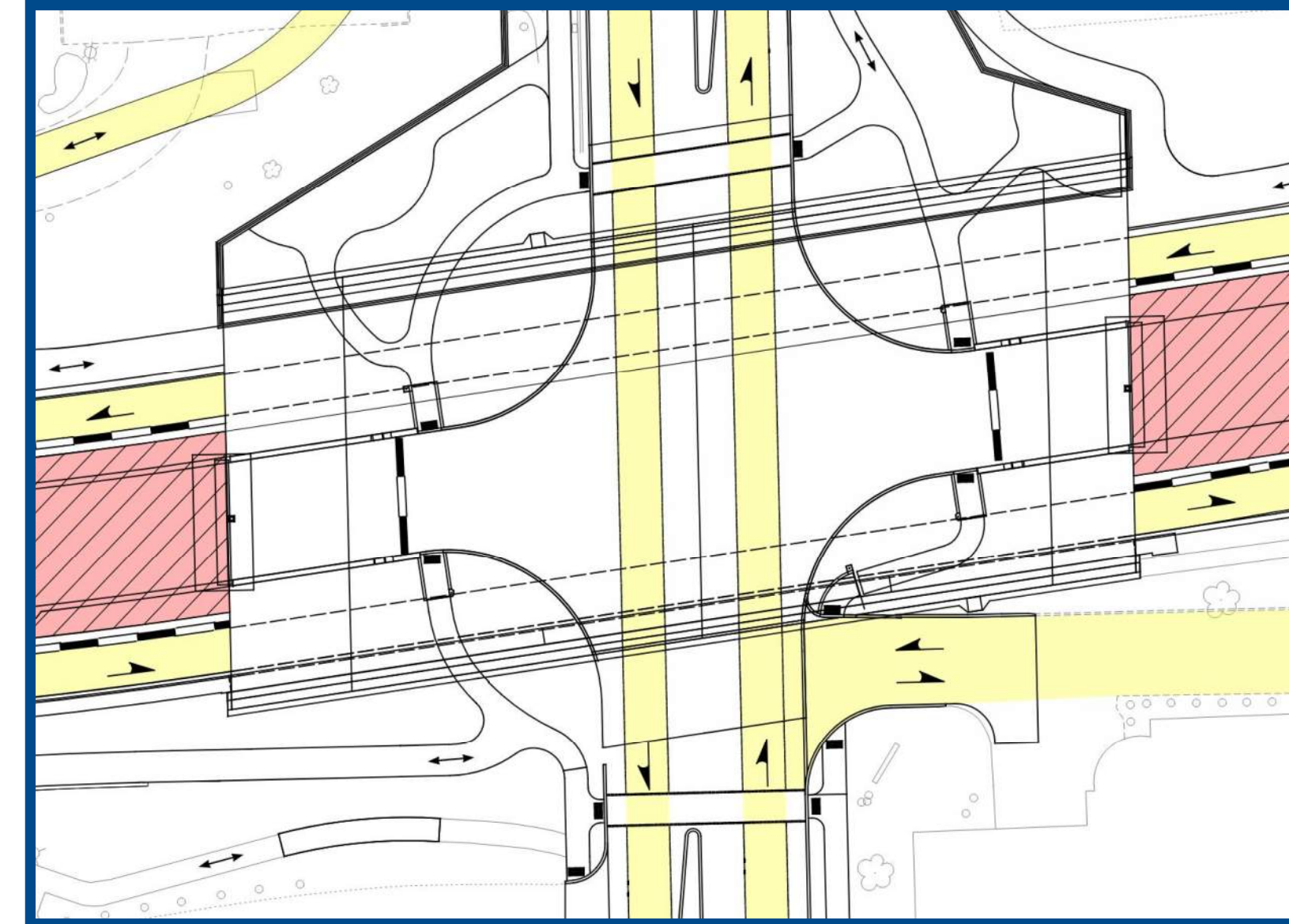

Stages 4-6

~13 Month Duration

Construct East & West Ramps
Bayfront Pwky EB/WB Maintained
State St NB/SB Maintained
Pedestrians NB / SB Maintained



Intersection Open to Traffic

Anticipated Fall 2028

Access Restored Between
Bayfront Parkway and State Street

KEY TAKEAWAYS

~31 Months until Full Vehicular Access
~18 Months until State Street NB/SB Restored
~18 Months of Pedestrian Detours

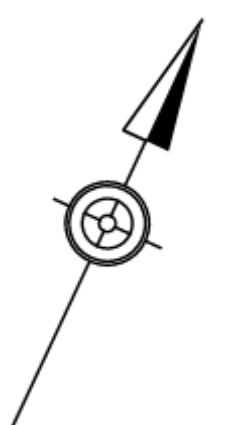



Proposed Construction Work Zone Limits

BAYFRONT PARKWAY
CENTRAL CORRIDOR IMPROVEMENTS

CITY OF ERIE, PA

LEGEND

-  Roadway Open to Traffic
-  Contractor Work Zone

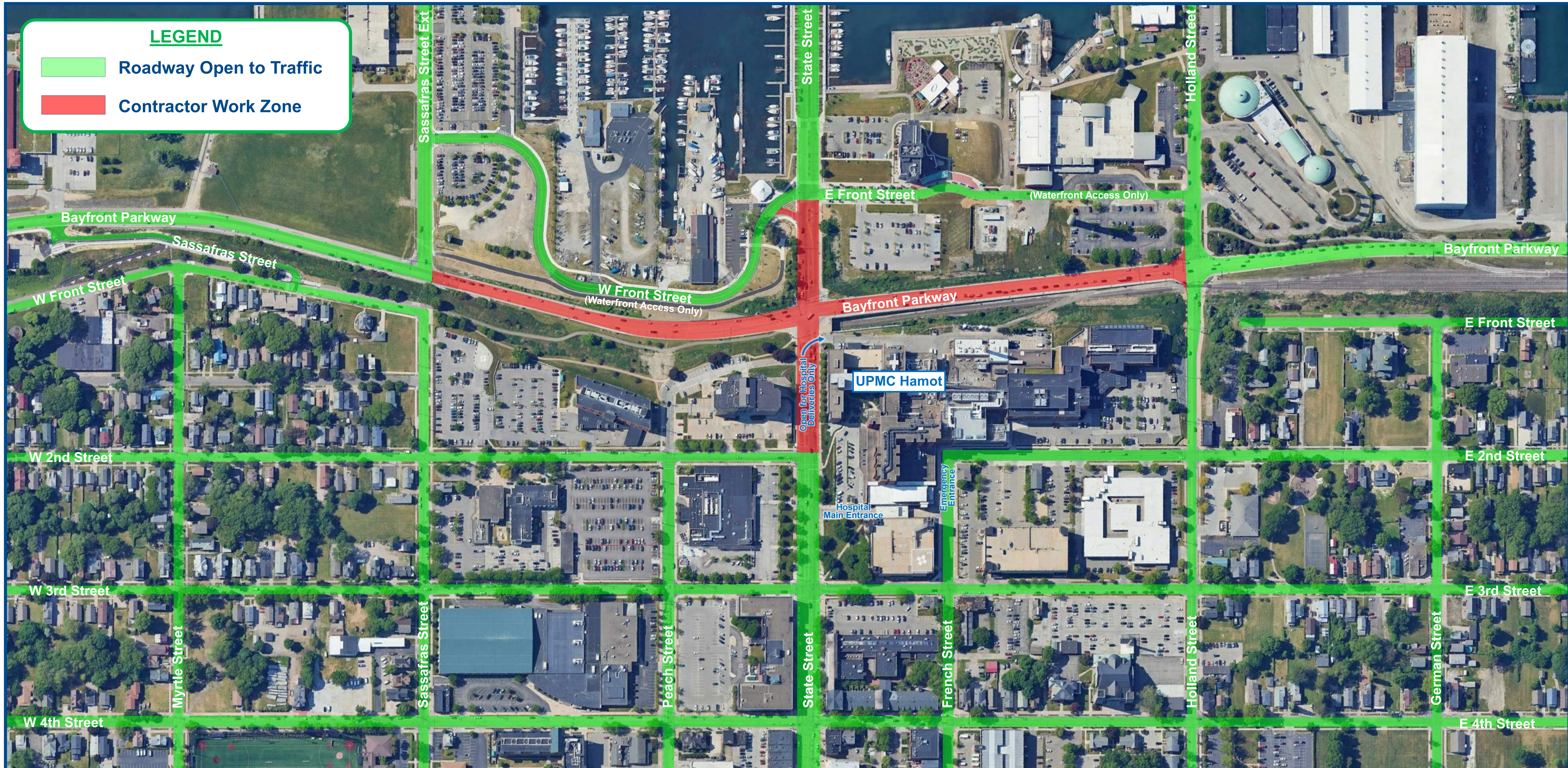

May 2025

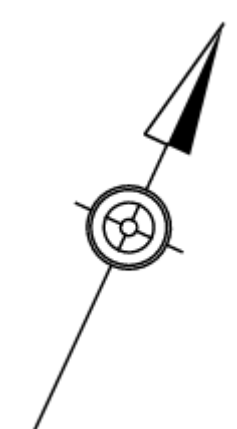

NOT TO
SCALE



Proposed State Street Construction Sequence

BAYFRONT PARKWAY
CENTRAL CORRIDOR IMPROVEMENTS

CITY OF ERIE, PA

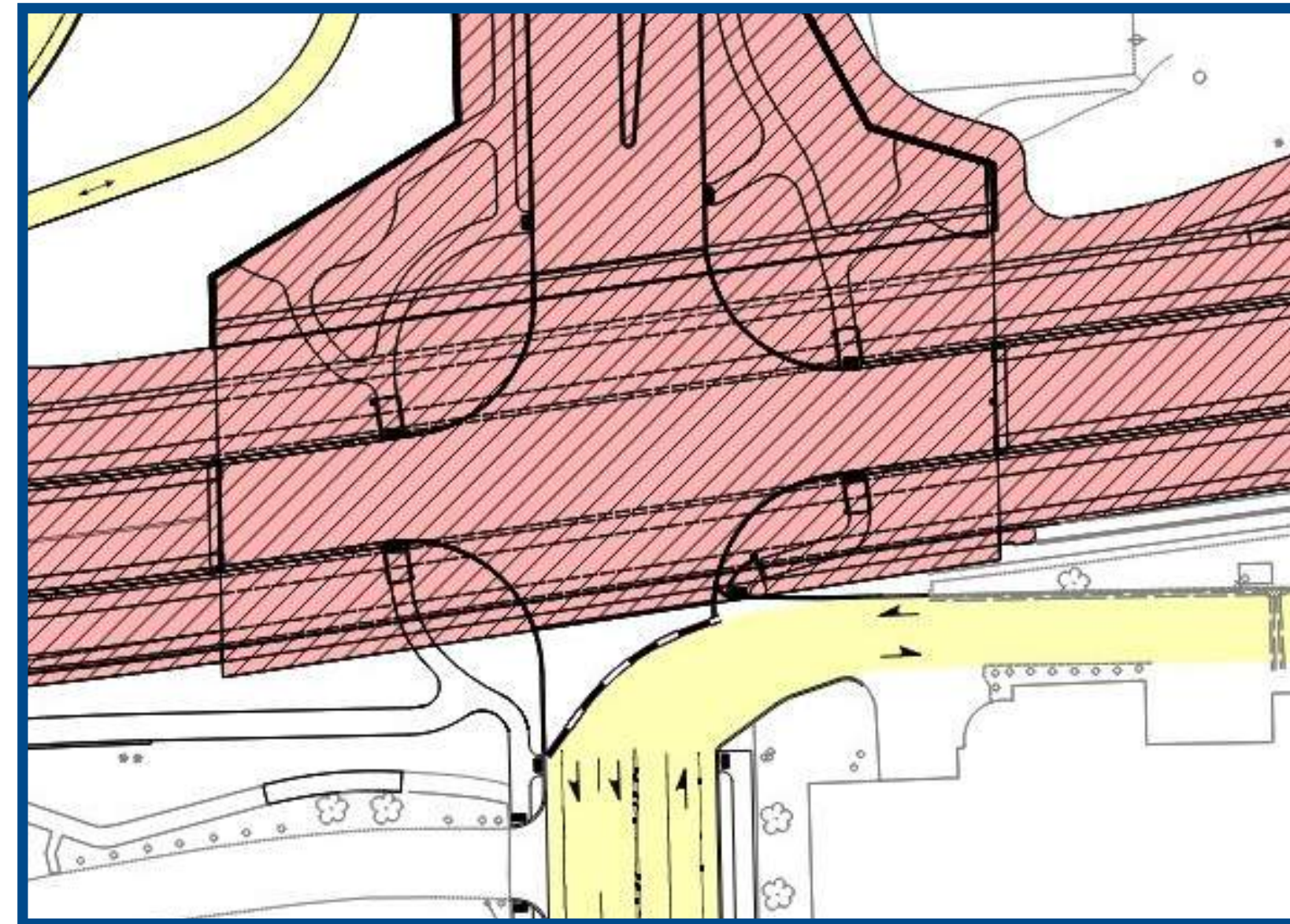

Stages 2-3

12 to 14 Month Duration

Construct State Street Bridge
Construct East & West Ramps
Bayfront EB & WB Detoured
State NB & SB Detoured
Pedestrians Detoured to Holland

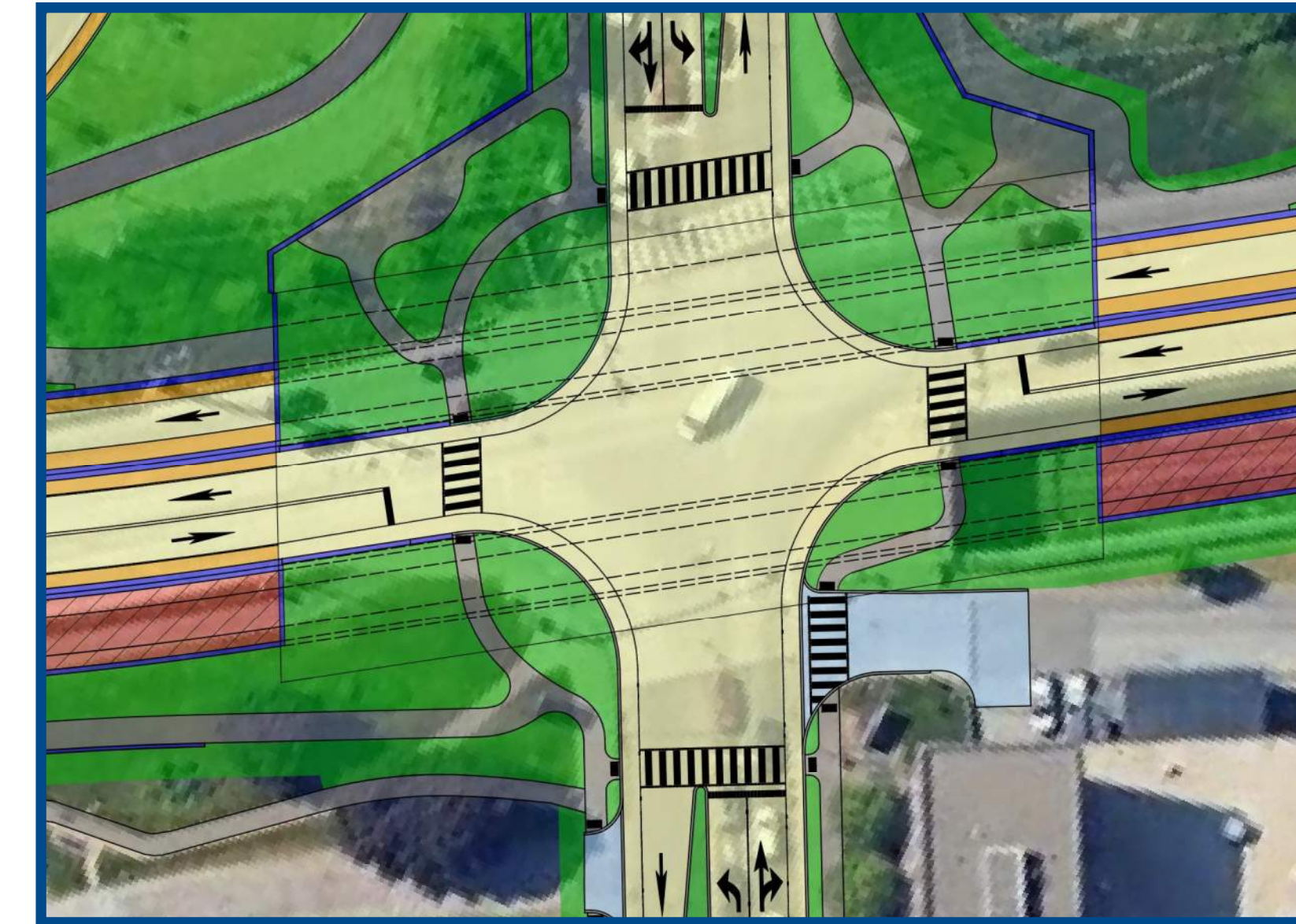

Intersection Open to Traffic

Anticipated Fall 2026

Access Restored Between
Bayfront Parkway and State Street

KEY TAKEAWAYS

12 to 14 Months until Full Vehicular Access (*reduced from ~31 months*)
12 to 14 Months of Pedestrian Detours (*reduced from ~18 months*)
Construction Savings Anticipated Relative to Original Sequence

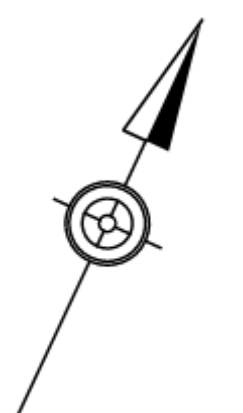



State Street Construction Sequence Comparison

BAYFRONT PARKWAY
CENTRAL CORRIDOR IMPROVEMENTS

CITY OF ERIE, PA

	Original Sequence	Proposed Sequence
Date Access Between Bayfront Parkway & State Street Restored	Fall 2028	Fall 2026
Duration Until Access Between Bayfront Parkway & State Street Restored	31 Months	12-14 Months
Duration of State Street Vehicular Detour	18 Months	12-14 Months
Duration of State Street Pedestrian Detour	18 Months	12-14 Months
Access Maintained to Waterfront and Downtown?	Yes	Yes
Detour Route Improvements	12th Street Corridor Traffic Signal Optimization (have ability to adjust signal timings as needed)	
Relative Construction Cost Savings	\$0	\$8 million less

Note: All information is approximate and subject to change based on field conditions encountered.



Bayfront Parkway Detour

BAYFRONT PARKWAY
CENTRAL CORRIDOR IMPROVEMENTS

CITY OF ERIE, PA

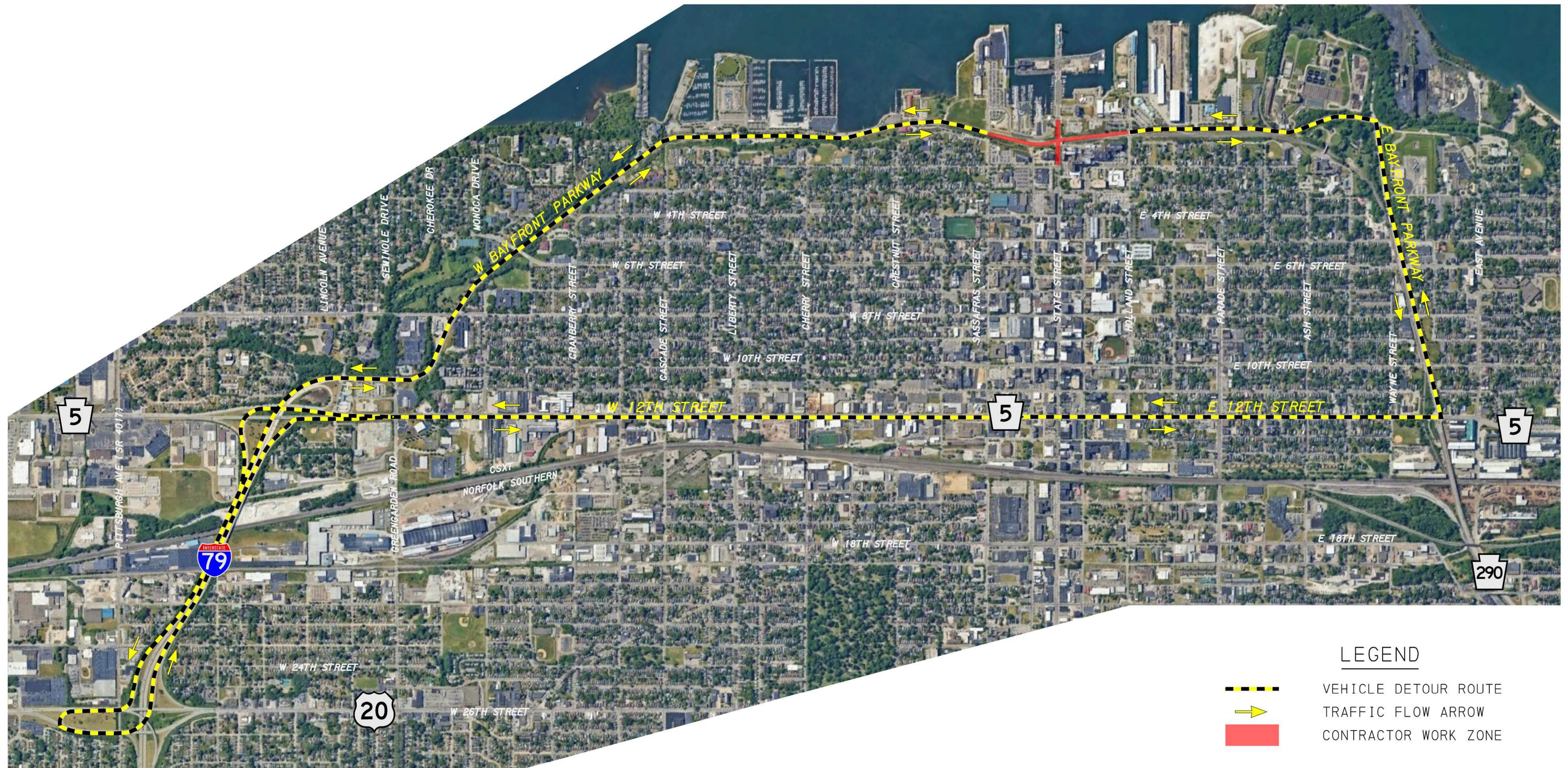



State Street Detour

BAYFRONT PARKWAY
CENTRAL CORRIDOR IMPROVEMENTS

CITY OF ERIE, PA

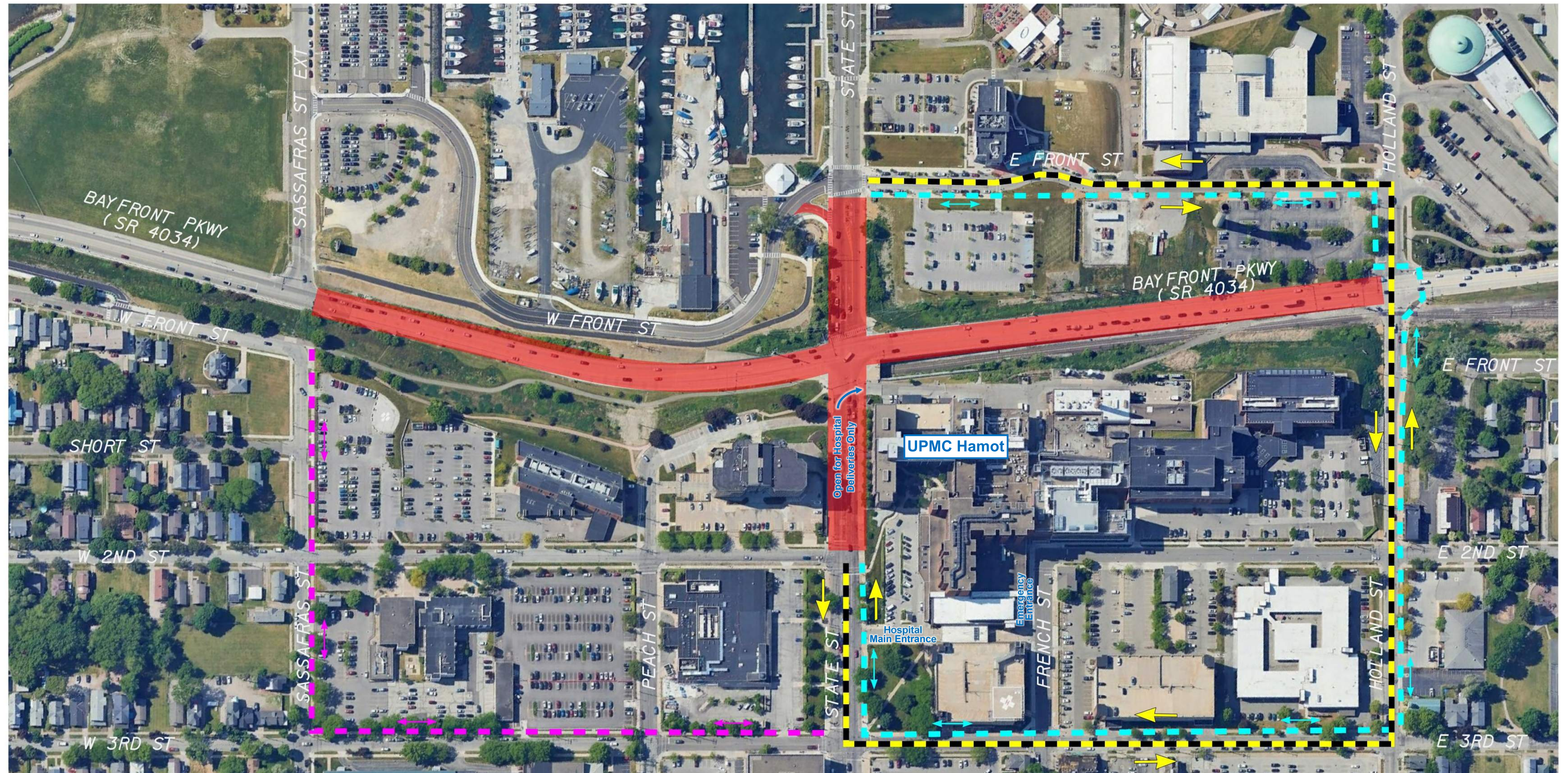

- | | | | |
|--|--------------------------------------|--|------------------------------|
| | STATE STREET VEHICLE DETOUR ROUTE | | PEDESTRIAN DETOUR FLOW ARROW |
| | STATE STREET PEDESTRIAN DETOUR ROUTE | | VEHICLE DETOUR FLOW ARROW |
| | BAYFRONT PROMENADE PEDESTRIAN DETOUR | | CONTRACTOR WORK ZONE |

May 2025



NOT TO SCALE



State Street & Bayfront Parkway Final Configuration

BAYFRONT PARKWAY
CENTRAL CORRIDOR IMPROVEMENTS

CITY OF ERIE, PA

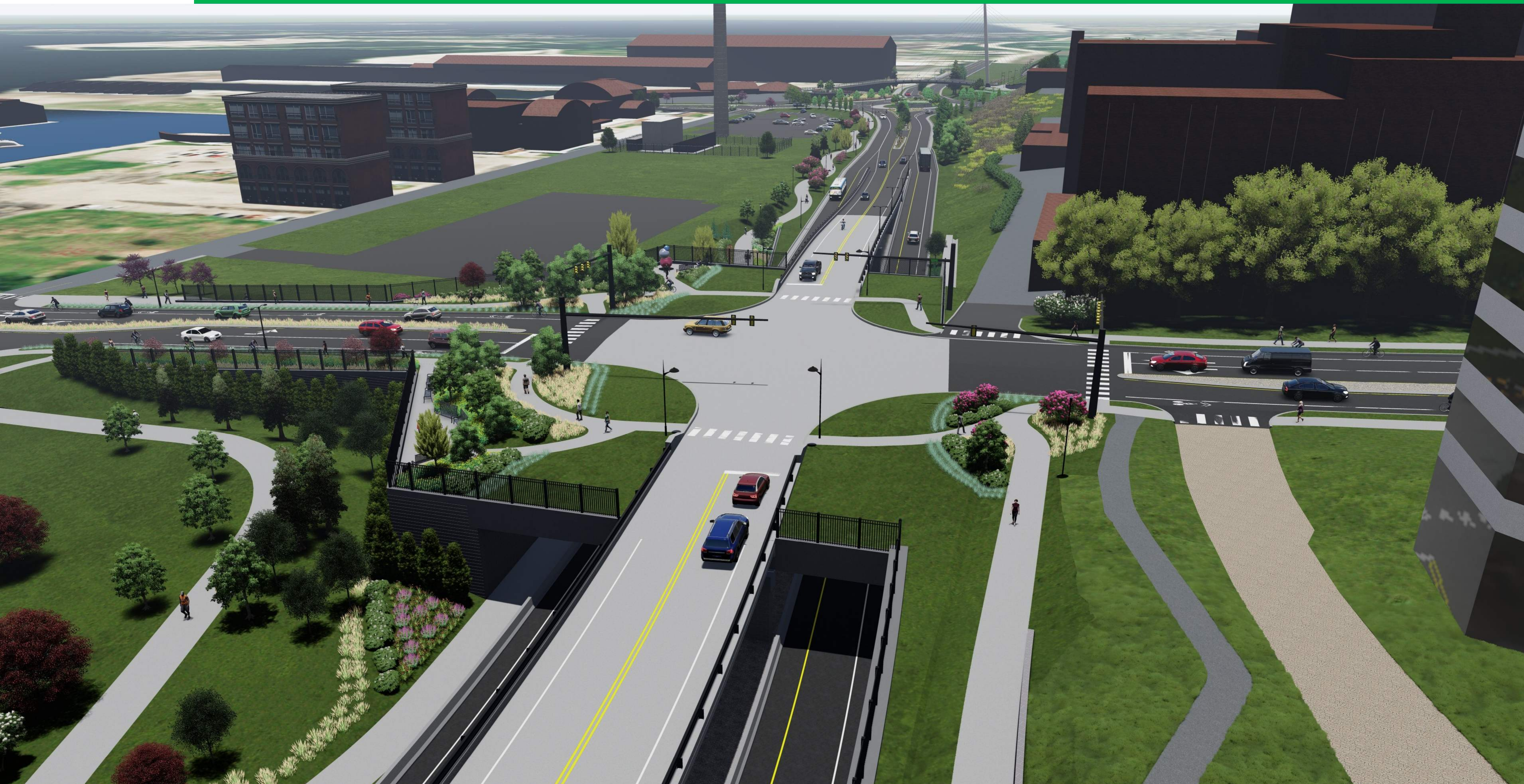

May 2025

Note: Looking East towards Holland Street