

# **PENNSYLVANIA FIRE SERVICE VOLUNTARY CERTIFICATION PROGRAM**



## **FIRE INSPECTOR CANDIDATE HANDBOOK**

OFFICE OF THE STATE FIRE COMMISSIONER  
PENNSYLVANIA STATE FIRE ACADEMY

Dear Certification Candidate,

Welcome to the Pennsylvania Fire Service Voluntary Certification Program. The purpose of this manual is to provide you with information to successfully participate in certification testing. This manual outlines the pre-requisites, testing and application process, and provides you with a study guide reference list. Tests are conducted under the sanction and approval of the Pennsylvania Office of the State Fire Commissioner with accreditation granted by the National Board on Fire Service Professional Qualifications (National Pro-Board) and the International Fire Service Accreditation Congress (IFSAC)

In accordance with *Act 61 of 1995, The State Fire Commissioner Act*, the Office of the State Fire Commissioner is the certifying agency within the Commonwealth of Pennsylvania, and the Pennsylvania State Fire Academy is the administering agency. Any United States Citizen eighteen (18) years of age or older who resides in Pennsylvania may apply for consideration as a test candidate.

**Effective March 1, 2026:**

- All certification candidates are required to maintain an active Acadis user portal account. (Acadis portal location = OSFC website/ Training and Certification Portal, or click here: [ENVISAGE Acadis®](#))
- All certification candidates are to be registered with the designated test site and rostered for the certification test.

Good luck and thank you for participating in the Pennsylvania Voluntary Fire Service Certification Program.

## Application Process

Obtain an application from either the Office of the State Fire Commissioner (OSFC) [website](#) or an approved test site. You must fill out the application in full and provide all required documentation. The completed application and accompanying documents are to be submitted to an approved test site or PA State Fire Academy (PSFA). Your application is then reviewed and either accepted or rejected based on compliance and deficiencies (i.e., lacks pre-requisites, no signatures, etc.).

The general test process is as follows:

1. A candidate must submit a complete application including all supporting documents;
2. After the application is approved, the candidate takes the written and subsequently the skills tests (NOTE: the skills test cannot be taken before the written test);
3. Upon successful completion of the written and skills tests and a review of the application for completeness by the test site and PSFA or Delegated Authority, the candidate can be certified for the level tested. If a candidate should not pass any part of the testing process, a retest can be administered and must be completed within one (1) year of the original test date.

## Application Pointers

1. Make sure the application is legible and complete. Applications **MUST** be typed.
2. Social Security Number: please provide the last four (4) digits.
3. Provide your complete name including suffix (Jr, Sr, III, etc.). **NO** nicknames please.
4. Make sure your mailing address includes street, apartment number, city, state, and zip.
5. Make sure all appropriate signatures are obtained and are signed in **all areas, either in Blue or Black ink, or via digital, electronic signatures (MUST be Adobe signature, NOT a Freeform signature)**.
  - a. *Chief Officers CANNOT sign for themselves in Section IV of the application;*
  - b. *Another Chief Officer MUST sign Section IV of the application.*
6. Legible copies of all prerequisites must be attached and signed were applicable. **NOTE: Copies must include front and back of the card(s) when applicable (i.e. CPR, medical card).**
7. Make sure your Prerequisite Verification Form (found in the back of the application) is appropriately marked off and signed in **BLUE** or **BLACK** ink or via digital, electronic signatures (**MUST be Adobe signature, NOT a Freeform signature**).

## Prerequisite: Hazardous Materials Training and/or Certification

Candidates **MUST** be trained or certified (as a minimum requirement) at the Hazardous Materials Awareness Level in accordance with NFPA 470 (2022 Ed) *Hazardous Materials/Weapons of Mass Destruction (WMD) Standard for Responders*

Attach a copy of one of the following recognized certificates (Jones & Bartlett or IFSTA curriculums).

- Hazardous Materials Awareness Level **OR** Annual Refresher Course
- Hazardous Materials Operations Level **OR** Annual Refresher Course
- Hazardous Materials Awareness or Operations Certification (IFSAC or ProBoard)

**NOTE:** The certificate (training, refresher training) **MUST** be current (i.e., within one (1) year of the fire inspector certification test date) and must meet the requirements of the current applicable NFPA standard. If fulfilling this prerequisite through certification, the certification date must be within one (1) year of the application.

### **Prerequisite: First Responder Inspector Certification**

Candidates MUST be trained or certified (as a minimum requirement) at the First Responder Inspector Level in accordance with NFPA 1030 (2024 Ed) *Standard for Professional Qualifications for Fire Prevention Program Positions*

Attach a copy of one of the following recognized certificates.

- First Responder Inspector Certification (IFSAC or ProBoard)
- Fire Inspector I Certification (IFSAC or ProBoard - NFPA 1030)

# Fire Inspector Certification Pathway

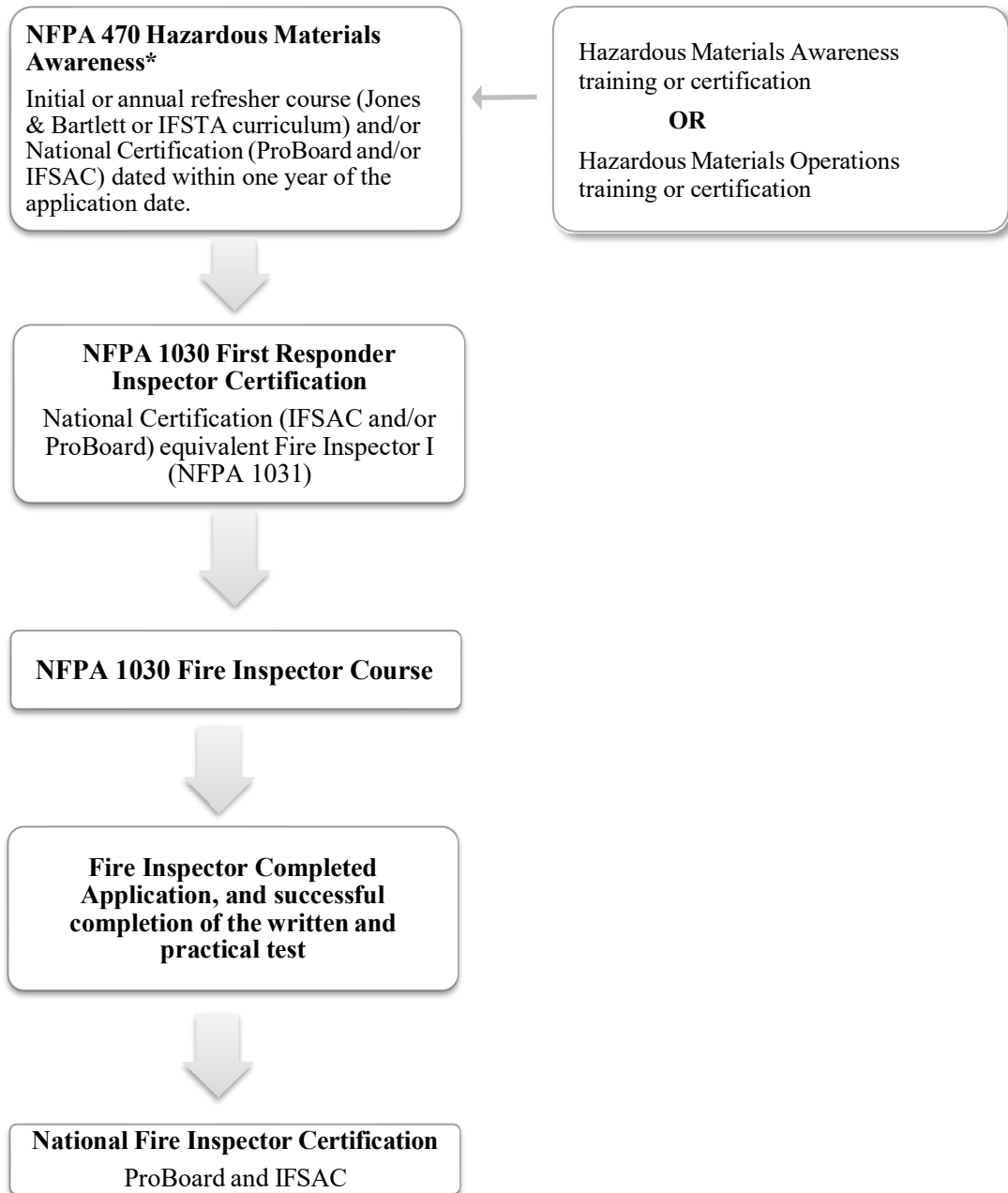

\* Please refer to the Fire Inspector application OR the previous section of this document titled “Prerequisites” for a complete listing of approved courses that will be accepted to fulfill the prerequisite(s).

## **Test Policy**

**Written Test:** The written test consists of one hundred (100) questions and is randomly generated. Candidates have a maximum of two (2) hour to complete the test. A passing score is seventy percent (70%).

**Skills Test:** Candidates must pass one hundred percent (100%) of the skill stations offered.

## **Re-test Policy**

**Written Test:** If you are unsuccessful, you have a total of two (2) retest attempts and have one (1) year to complete the retest. You will need to contact the fire academy or the test site where the test was originally taken to schedule a retest.

**Skills Test:** You must pass 100% of the skill stations offered.

- If you are unsuccessful on three (3) or less skill stations, you may retest the same day (only one retest per skill station);
- If you are unsuccessful on four (4) or more skill stations, you may NOT retest the same day. Skill retests must be scheduled for a later date and time.
- A total of eight (8) retest attempts are permitted and must be completed in one (1) year to successfully complete the testing process.

## **Appeals**

Within thirty (30) days of receipt of a failure notice, a candidate may request a review of his/her performance records by the State Fire Academy. Appeals must be in writing and in accordance with the policies and procedures of the Certification Program.

Send to: Pennsylvania State Fire Academy  
Attn: Certification Program Manager  
1150 Riverside Drive  
Lewistown, PA 17044

## **Test Results/Release of Results**

The Office of the State Fire Commissioner / PA State Fire Academy notifies candidates of test results in writing via US Postal Service mail. Only pass/fail grades are given.

In accordance with the Federal Education Records and Privacy Act (FERPA) of 1974, a standard (i.e., law) for the protection of individual education and test records was established; therefore, prior consent from a student / candidate / person must be made before any records or other personally identifiable information can be released to any other person / organization / third-party entity. In the event a third-party request for test result(s) of a candidate is made, a "Consent to Release Information" form will need to be completed and signed by the candidate to permit release of results to another person / organization / third-party entity.

## **Accommodations**

The Pennsylvania Fire Service Voluntary Certification Program offers reasonable accommodation for the written certification exams for individuals with documented disabilities. Only written requests for accommodation for certification examinations are reviewed, and each request is reviewed on a case-by-case basis. Requests must be submitted on the Accommodation Request form. The Pennsylvania Fire Service Voluntary Certification Program provides written notification of its decision to the candidate upon completion of its review and the review by legal counsel of the request for accommodation.

The “Accommodation Request” form is located on page 8 of this manual or is available from the Pennsylvania State Fire Academy and test site coordinators. Please contact the Certification Program Manager for further information. The candidate who is requesting accommodation must complete the request form at the time of application submission or as soon as the need for an accommodation is recognized. All requests must be made prior to the scheduled date of the examination. Any request for accommodation not submitted at least twenty (20) working days prior to the scheduled examination will result in a delay in the candidate’s date of examination.

Documentation of a specific disability which would impact a candidate’s performance on the written examination must be current (within five (5) years of the date of application). Such documentation should include a signed explanation on letterhead stationery from a professional who is familiar with the applicant’s disability or a copy of an Individual Education Plan (IEP) from an educational institution. See comment below.

The statement must confirm and describe the disability for which the accommodation is requested. The professional must have expertise in the specific disability for which the accommodation is being requested.



### **Recertification**

In the Commonwealth of Pennsylvania, certification is a voluntary process; currently there is no requirement for recertification. Issuance of a certificate indicates the candidate successfully passed the certification test. The certificate issued indicates the candidate is certified based on the edition and year of the standard under which the candidate certified. Furthermore, issuance of a certification certificate does not imply nor guarantee any indication of future performance because of the testing process.

### **Safety Policy**

A candidate should meet the requirements of NFPA 1582 *Standard on Medical Requirements for Firefighters and information for Fire Department Physicians* prior to participating in any physical test to ensure his/her ability to safely perform the required tasks.

For the safety and protection of all participants, all equipment, and Personal Protective Equipment (PPE) used in a test must meet the NFPA standard at the time of manufacturing. PPE will be inspected prior to use in a test.

The facial hair policy states candidates with facial hair which interferes with the operation or use of a Self-Contained Breathing Apparatus (SCBA) will not be permitted to participate in a test that requires use of a SCBA.

### **No show policy**

If a candidate is accepted for testing and fails to show up without an acceptable reason, the test site has the right to enforce their no-show policy that could include but is not limited to suspension from testing for an identified period of time and/or financial penalties.

## **Professional Testing Integrity and Dishonesty**

Dishonesty in the professional test environment includes but is not limited to cheating, plagiarizing, facilitating acts of testing dishonesty by others, having unauthorized possession of examinations, or submitting work of another person. Any instance(s) of testing dishonesty constitutes the need for disciplinary and/or legal actions. All certification candidates shall act with personal and professional integrity, respect the rights and property of others, and help maintain a professional environment in which all can be successful.

Test Site Coordinators, Assistant Coordinators, Test Proctors, Evaluators, and Instructors should take reasonable steps to anticipate and deter acts of dishonesty, reinforce integrity, and support appropriate behavior to protect the rights and trust of honest candidates. At the beginning of each test process, it is the responsibility of those to provide candidates with the “Testing Integrity and Dishonesty” policy and clarify questions that may arise.

### ***Falsification of Documents***

Any individual found to have forged, altered, or falsified documentation for the purpose of certification testing will be indefinitely suspended from participating in any certification exam within the Commonwealth of Pennsylvania. Further action may be taken in accordance with the Pennsylvania Crimes Code 18 Pa C.S. 4904, relating to unsworn falsifications.

### ***Cheating on Test***

All candidates are expected to work entirely on his/her own while taking any exam. Violations of test integrity consist of any attempt to receive assistance from written or printed aids unless provided by the test proctor for the purpose of a specific test, or any persons, papers, or electronic devices, or of any attempt to give assistance

### ***Document Integrity***

Certification candidates are expected to complete all work individually. For any material obtained from other sources such as plot plans, web maps, etc., a source reference must be given. All essay answers must be the candidate’s own work.

## **Study Reference List**

The following is a list of text that may be reference in preparation for testing.

1. National Fire Protection Association, NFPA 1030 (2024 Ed) Standard for Professional Qualifications for Fire Prevention Program Positions
2. IFSTA, Fire Inspection and Code Enforcement, 9<sup>th</sup> Edition, 1<sup>st</sup> Printing
3. Skill sheets can be found under [“Skills we’re looking for”](#)

**Additional Information:**

1. Applications shall be submitted to the test site by their established deadline or no later than 3 weeks prior to the test date.
2. Please contact the test site of your choice to receive information about fees for testing.
3. Photo ID is required at the time of the written and skills tests.
4. Bring all appropriate PPE and SCBA needed to complete all possible skill stations.
5. Dress appropriately; bring extra dry clothes.
6. Bring food and water or a similar beverage to stay hydrated.

Certification applications and skill sheets, in addition to the test schedule and test site contact information, can be found at [Firefighter Certifications | Commonwealth of Pennsylvania](#). A page will open with information about the certification program and process. Scroll through the page to find the links for certification applications, skill sheets, test schedule, and test site contact information.

If you have additional questions or concerns about the test process, please contact the test site coordinator at the site in which you applied to be tested at or the PA State Fire Academy Certification Program Staff.

# Firefighter Code of Ethics

**I understand that I have the responsibility to conduct myself in a manner that reflects proper ethical behavior and integrity. In so doing, I will help foster a continuing positive public perception of the fire service. Therefore, I pledge the following...**

- Always conduct myself, on and off duty, in a manner that reflects positively on myself, my department, and the fire service in general.
- Accept responsibility for my actions and for the consequences of my actions.
- Support the concept of fairness and the value of diverse thoughts and opinions.
- Avoid situations that would adversely affect the credibility or public perception of the fire service profession.
- Be truthful and honest at all times and report instances of cheating or other dishonest acts that compromise the integrity of the fire service.
- Conduct my personal affairs in a manner that does not improperly influence the performance of my duties or bring discredit to my organization.
- Be respectful and conscious of each member's safety and welfare.
- Recognize that I serve in a position of public trust that requires stewardship in the honest and efficient use of publicly owned resources, including uniforms, facilities, vehicle, and equipment and that these are protected from misuse and theft.
- Exercise professionalism, competence, respect, and loyalty in the performance of my duties and use information, confidential or otherwise, gained by virtue of my position, only to benefit those I am entrusted to serve.
- Avoid financial investments, outside employment, outside business interests or activities that conflict with or are enhanced by my official position or have the potential to create the perception of impropriety.
- Never propose or accept personal rewards, special privileges, benefits, advancement, honors or gifts that may create a conflict of interest, or the appearance thereof.
- Never engage in activities involving alcohol or other substance use or abuse that can impair my mental state or the performance of my duties and compromise safety.
- Never discriminate on the basis of race, religion, color, creed, age, marital status, national origin, ancestry, gender, sexual preference, medical condition or handicap.
- Never harass, intimidate, or threaten fellow members of the service or the public and stop or report the actions of other firefighters who engage in such behaviors.
- Responsibly use social networking, electronic communications, or other media technology opportunities in a manner that does not discredit, dishonor, or embarrass my organization, the fire service and the public. I also understand that failure to resolve or report inappropriate use of this media equates to condoning this behavior.

**Developed by the National Society of Executive Fire Officers**

## **STATION A**

### **Field Inspection 1**

As a Fire Inspector candidate, you will identify commercial facility that has the following characteristics:

- Multiple means of egress
- Single occupancy

Contact the facility ownership and obtain permission to conduct a fire inspection of the facility. Once you have permission to conduct the inspection, conduct your fire inspection, including fire suppression systems and fire alarm systems present. Document your findings in a written inspection report with appropriate supporting data and notice of violation. As part of your inspection determine/verify the following:

- Building occupancy
- Building construction type
- Building area
- Building height
- Number of stories above grade
- Allowable building area
- Allowable building height
- Allowable number of stories above grade
- All egress elements and their adequacy

Complete your field inspection and communicate the results of your inspection in writing in accordance with the policies and procedures of the jurisdiction.

**STATION B**  
**Permit Application**

As the fire inspector for Anytown Borough, Pennsylvania the following permit application was submitted to you with no attachments, process and review the following permit application in accordance with the policies and procedures of the jurisdiction and communicate your findings to the permit applicant.

All of the documents filed for the job are included:

Building Permit No:  
 Zoning Permit No:  
 Water Permit:  
 Sewer Permit:

## APPLICATION FOR ZONING AND BUILDING PERMIT

ADDRESS:

<b>LOCATION OF PROPOSED WORK OR IMPROVEMENT</b>	
Municipality: <u>Anytown Borough</u>	Tax Parcel No: <u>36-012-,123-,0000-</u>
Street Address: <u>3643 Hamilton Avenue</u>	
Rural Directions: _____	

<b>TYPE AND COST OF WORK OR IMPROVEMENT</b>		
<b>Type of Property:</b> <input checked="" type="checkbox"/> Commercial <input type="checkbox"/> Residential <input type="checkbox"/> Current Rental <input type="checkbox"/> Proposed Rental	<b>Type of Improvement:</b> <input type="checkbox"/> New building <input type="checkbox"/> Addition <input checked="" type="checkbox"/> Alteration <input type="checkbox"/> Repair, replacement <input type="checkbox"/> Demolition <input type="checkbox"/> Electrical ONLY <input type="checkbox"/> Sprinkler System ONLY	<b>Building Information:</b> <b>Dimensions:</b> Height (feet): <u>30</u> No of Stories: <u>2</u> Total Square footage: <u>24,000</u>  <b>Type of sewage disposal:</b> <input checked="" type="checkbox"/> Public or private company <input type="checkbox"/> Private (on lot septic tank, etc.)  <b>Type of water supply:</b> <input checked="" type="checkbox"/> Public or private company <input type="checkbox"/> Private (well, cistern)
<b>Declared cost</b> \$ <u>124,000</u>		

**Describe proposed work:**  
Change the use of the building from an office building to a charter school and install a new automatic sprinkler system

Role:	Name	Address	Phone No	Email
<i>Owner</i>	ABC School	123 Elementary Lane	(717)555-1212	<a href="mailto:abc@gmail.com">abc@gmail.com</a>
		Anytown, PA 99999		
<i>Tenant</i>	Same as above			
<i>Contractor</i>	Great Stuff	6970 E. Crazy Ave.	(215)666-1734	<a href="mailto:GSC@gmail.com">GSC@gmail.com</a>
	Contractors	Next Town Over, PA 99998		
<i>Design Professional</i>	Gary Smith, RA	5643 First Ave.	(215)777-1515	<a href="mailto:GSArch@gmail.com">GSArch@gmail.com</a>
		Town After That, PA 99997		

**AFFIDAVIT**

I hereby certify that I am the owner in fee or the authorized agent of the owner in fee of the property upon which the work authorized by the permit sought will be performed. All work will be performed in accordance with all applicable laws of the Commonwealth of Pennsylvania and this jurisdiction.

Signature of applicant	Address 5643 First Ave., Town After That, PA 99997	Application Date May 15, 2024
Print Name Gary Smith, R.A.	Email/Phone <a href="mailto:GSArch@gmail.com">GSArch@gmail.com</a> /(215)777-1515	Role Architect



Site Plan - Required for zoning application. Applicant must fill in dimensions and indicate North.

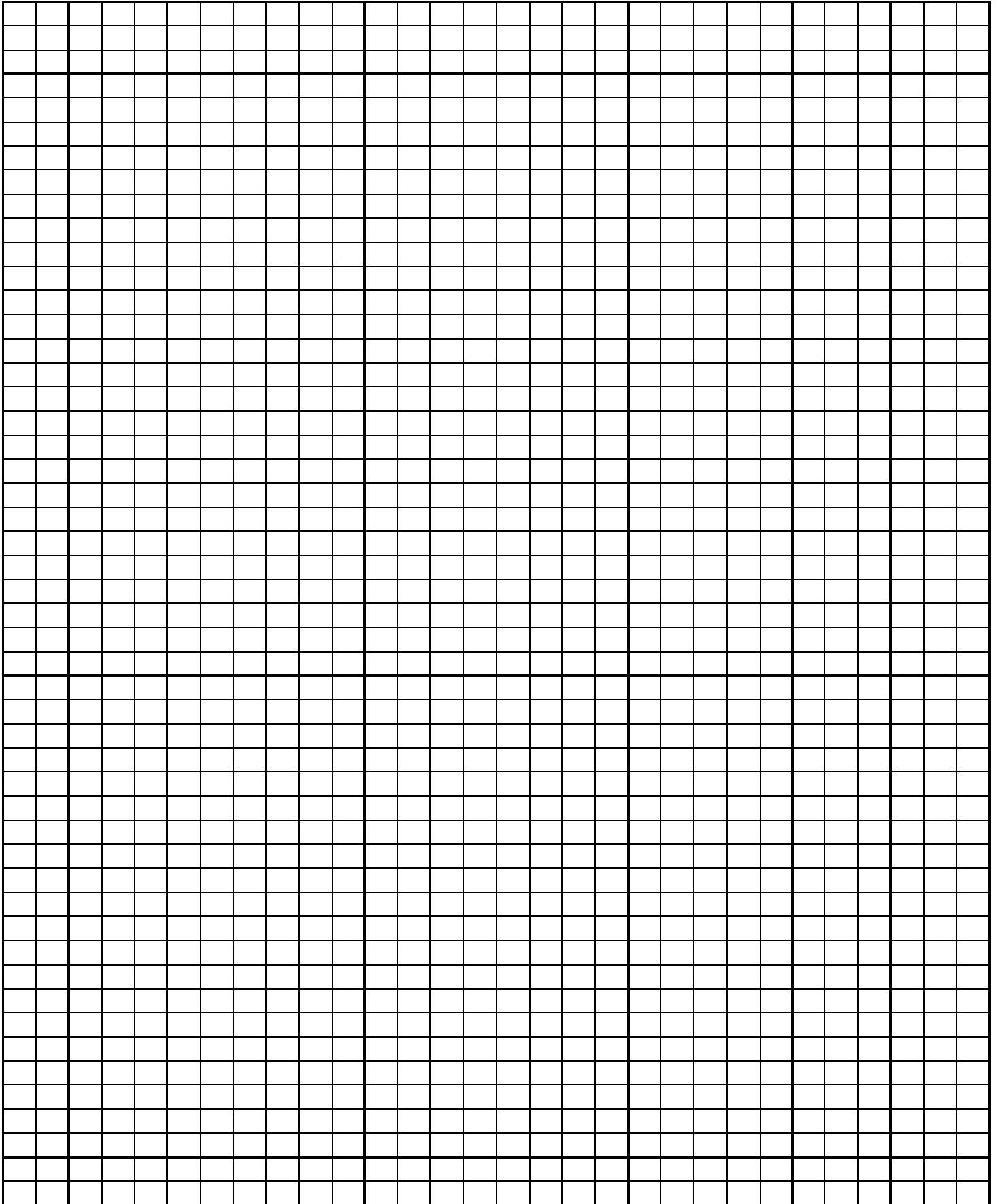

**ZONING PLANS EXAMINER NOTES**

Zone: \_\_\_\_\_

Lot Square Footage: \_\_\_\_\_

Percent Coverage: \_\_\_\_\_

Off-street parking spaces

Enclosed: \_\_\_\_\_

Outdoors: \_\_\_\_\_

Set Backs	North "//	Required	Provided
Front			
Right Side			
Left Side			
Rear			

Notes:

\_\_\_\_\_

\_\_\_\_\_

\_\_\_\_\_

Approved: \_\_\_\_\_ Date approved: \_\_\_\_\_ Permit No.: \_\_\_\_\_

**CODES PLANS EXAMINER NOTES**

OCCUPANCY INFORMATION

Type of Construction: \_\_\_\_\_ Use Group: \_\_\_\_\_

FLOOR	# OF UNITS	MAX OCC LOADS	MAX LIVE LOAD (lbs per sq.ft.)	FLOOR	# OF UNITS	MAX OCC LOAD	MAX LIVE LOADS (lbs per sq.ft.)
BASEMENT				SEVENTH FLOOR			
FIRST FLOOR				EIGHTH FLOOR			
SECOND FLOOR				NINTH FLOOR			
THIRD FLOOR				TENTH FLOOR			
FOURTH FLOOR				ELEVENTH FLOOR			
FIFTH FLOOR				ROOF			
SIXTH FLOOR				OTHER			

Plan Approved: \_\_\_\_\_ Date Approved: \_\_\_\_\_

Building Permit No: \_\_\_\_\_ Date Permit Issued: \_\_\_\_\_

Permit fee \$ \_\_\_\_\_ Deposit Paid \$ \_\_\_\_\_ Balance Due \$ \_\_\_\_\_

Deposit Date \_\_\_\_\_ Check/Cash \_\_\_\_\_ By \_\_\_\_\_

## **STATION C**

### **Plan Review Application**

As the fire inspector for Anytown Borough, Pennsylvania, you have received a plan review application from Buck Stars, the local coffee shop owner. As an attempt to increase his business he would like to host morning karaoke at his coffee shop, located at 15 Caffeinated Way. As part of the karaoke experience, he would like to remove the six (6) four-top tables in the middle of the shop, allowing for people to better mingle.

From the current department file, the following information is provided: Occupancy: (B)

Business  
Construction Type: III B No  
Sprinkler  
No Alarm  
Maximum Occupancy: 46

Current seating plan provided (following)

Process and review the following plan review application in accordance with the policies and procedures of the jurisdiction and communicate your findings to the permit applicant.

All of the documents filed for the job are included:

Building Permit No:  
 Zoning Permit No:  
 Water Permit:  
 Sewer Permit:

## APPLICATION FOR PLAN REVIEW

ADDRESS:

<b>LOCATION OF PROPOSED WORK OR IMPROVEMENT</b>	
Municipality: <u>Anytown Borough</u>	Tax Parcel No: <u>73-001-,123-,0000-</u>
Street Address: <u>15 Caffeinated Way</u>	
Rural Directions: _____	

<b>TYPE AND COST OF WORK OR IMPROVEMENT</b>		
<b>Type of Property:</b> <input checked="" type="checkbox"/> Commercial <input type="checkbox"/> Residential <input type="checkbox"/> Current Rental <input type="checkbox"/> Proposed Rental	<b>Type of Improvement:</b> <input type="checkbox"/> New building <input type="checkbox"/> Addition <input checked="" type="checkbox"/> Alteration <input type="checkbox"/> Repair, replacement <input type="checkbox"/> Demolition <input type="checkbox"/> Electrical ONLY <input type="checkbox"/> Sprinkler System ONLY	<b>Building Information:</b> <b>Dimensions:</b> Height (feet): <u>15</u> No of Stories: <u>1</u> Total Square footage: <u>1637</u>  <b>Type of sewage disposal:</b> <input checked="" type="checkbox"/> Public or private company <input type="checkbox"/> Private (on lot septic tank, etc.)  <b>Type of water supply:</b> <input checked="" type="checkbox"/> Public or private company <input type="checkbox"/> Private (well, cistern)
<b>Declared cost</b> \$ <u>0.00</u>		

**Describe proposed work:**  
 Remove movable seating (tables and chairs) for karaoke at my coffee shop to increase business. After the event I will put the tables and chairs back where they were.

Role:	Name	Address	Phone No	Email
<i>Owner</i>	Buck Stars	123 Creamer Street	(777) 123-5555	coffee-is-great@gmail.com
		Anytown, PA 18000		
<i>Tenant</i>				
<i>Contractor</i>				
<i>Design Professional</i>				

**AFFIDAVIT**

I hereby certify that I am the owner in fee or the authorized agent of the owner in fee of the property upon which the work authorized by the permit sought will be performed. All work will be performed in accordance with all applicable laws of the Commonwealth of Pennsylvania and this jurisdiction.

Signature of applicant <i>Buck Stars</i>	Address 123 Creamer Street, Anytown, PA 18000	Application Date May 15, 2024
Print Name Buck Stars	Email/Phone coffee-is-great@gmail.com (777) 123-5555	Role Owner



Site Plan - Required for zoning application. Applicant must fill in dimensions and indicate North.

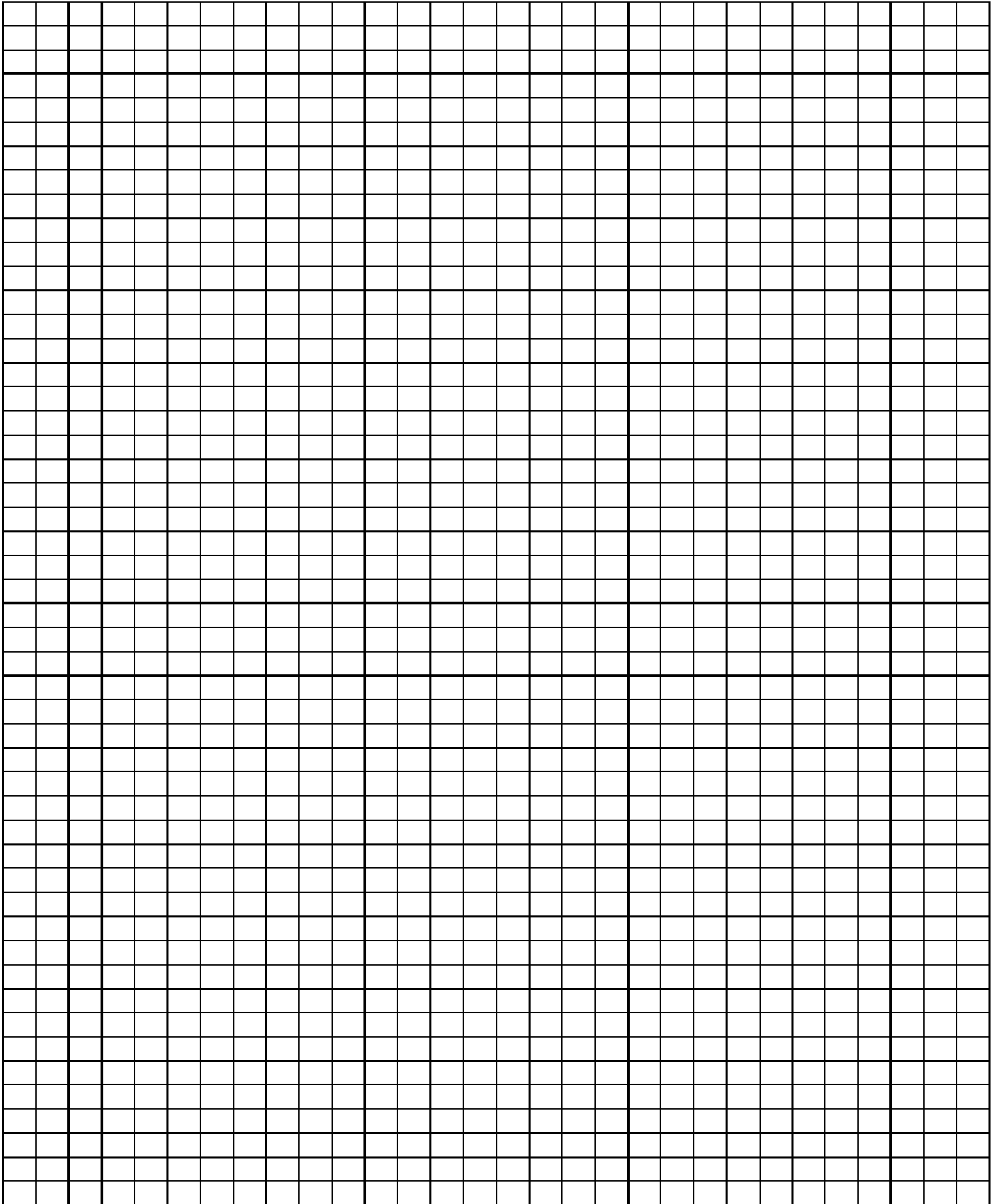

**ZONING PLANS EXAMINER NOTES**

Zone: \_\_\_\_\_

Lot Square Footage: \_\_\_\_\_

Percent Coverage: \_\_\_\_\_

Off-street parking spaces

Enclosed: \_\_\_\_\_

Outdoors: \_\_\_\_\_

Set Backs	North "//	Required	Provided
Front			
Right Side			
Left Side			
Rear			

Notes:

\_\_\_\_\_

\_\_\_\_\_

\_\_\_\_\_

Approved: \_\_\_\_\_ Date approved: \_\_\_\_\_ Permit No.: \_\_\_\_\_

**CODES PLANS EXAMINER NOTES**

OCCUPANCY INFORMATION

Type of Construction: \_\_\_\_\_ Use Group: \_\_\_\_\_

FLOOR	# OF UNITS	MAX OCC LOADS	MAX LIVE LOAD (lbs per sq.ft.)	FLOOR	# OF UNITS	MAX OCC LOAD	MAX LIVE LOADS (lbs per sq.ft.)
BASEMENT				SEVENTH FLOOR			
FIRST FLOOR				EIGHTH FLOOR			
SECOND FLOOR				NINTH FLOOR			
THIRD FLOOR				TENTH FLOOR			
FOURTH FLOOR				ELEVENTH FLOOR			
FIFTH FLOOR				ROOF			
SIXTH FLOOR				OTHER			

Plan Approved: \_\_\_\_\_ Date Approved: \_\_\_\_\_

Building Permit No: \_\_\_\_\_ Date Permit Issued: \_\_\_\_\_

Permit fee \$ \_\_\_\_\_ Deposit Paid \$ \_\_\_\_\_ Balance Due \$ \_\_\_\_\_

Deposit Date \_\_\_\_\_ Check/Cash \_\_\_\_\_ By \_\_\_\_\_



## **STATION D**

### **Field Inspection 2**

As a Fire Inspector candidate, you will identify commercial restaurant facility. Contact the facility ownership and obtain permission to conduct a fire inspection of the facility. Once you have permission to conduct the inspection, conduct your fire inspection, including fire suppression systems and fire alarm systems if present. Document your findings in a written inspection report with appropriate supporting data and notice of violation.

The inspection was the result of an anonymous verbal complaint received by your office regarding blocked egress at the facility. Complete a full inspection and report your findings to your supervisor.

Complete your field inspection and communicate the results of your inspection and resolve the complaint in writing in accordance with the policies and procedures of the jurisdiction.

## **STATION E Code Adoption**

As the fire inspector for Anytown Borough, Pennsylvania you have been contacted by the Always Ready Volunteer Fire Department (the local volunteer fire department) requesting assistance with an on-going problem. Chief Susan Smith, CFO tells you that there have been a few larger buildings built and there is not adequate water to conduct firefighting activities. The local land development ordinance is silent on water supply for firefighting. She has requested that you investigate the problem and make a recommendation on how to resolve it.

Anytown Borough, Pennsylvania has adopted the International Fire Code (IFC), 2018 edition with ordinance number 1-22-2020, and it was effective March 1, 2020

The contact information for Chief Smith is:

Susan E. Smith, CFO Chief  
of Department  
Always Ready Volunteer Fire Department 1028  
Fire House Road  
Anytown, PA 99999

Communicate with Chief Smith in writing so that she is comfortable that you understand the problem, the recommended fire code modification solution, and outline the procedure that will need to be followed to adopt/modify the locally adopted code to address the issue.

## STATION F Legal Proceedings

You as the fire inspector for Anytown Borough, Pennsylvania responded to an anonymous complaint at ABC Tavern on January 27, 2024 for blocked egress. During your inspection you found that the rear exit was blocked as shown in the following picture:



As a result of your inspection you determined that the following violations of the 2018 International Fire Code as adopted by local ordinance were present. The adoptive ordinance is Anytown Borough Ordinance 1-24-2020 and was effective on March 1, 2020:

***304.1 Waste accumulation prohibited.*** Combustible waste material creating a fire hazard shall not be allowed to accumulate in buildings or structures or upon premises.

**[BE] 1003.6 Means of egress continuity.** *The path of egress travel along a means of egress shall not be interrupted by a building element other than a means of egress component as specified in this chapter. Obstructions shall not be placed in the minimum width or required capacity of a means of egress component except projections permitted by this chapter. The minimum width or required capacity of a means of egress system shall not be diminished along the path of egress travel.*

**1031.2 Reliability.** *Required exit accesses, exits and exit discharges shall be continuously maintained free from obstructions or impediments to full instant use in the case of fire or other emergency where the building area served by the means of egress is occupied. An exit or exit passageway shall not be used for any purpose that interferes with a means of egress.*

**1031.3 Obstructions.** *A means of egress shall be free from obstructions that would prevent its use, including the accumulation of snow and ice.*

With this being the third time in the past year that you have found this violation that the ABC Tavern, the municipal solicitor is getting involved. The solicitor has requested that you outline the case for them in writing so that they can prepare for a meeting with you.

Some key facts of the case are:

ABC Tavern  
1730 Laubach Avenue  
Suite 4  
Anytown, PA 99999

Manager on duty: Michael Warner

You presented your credentials and were granted access to the facility to conduct an inspection Date:

January 27, 2024  
Time: 22:10 hours (10:10 pm)

A-2 Occupancy  
Maximum permitted occupancy – 650 Observed  
occupancy - 625  
Total number of exits in the building - 3

Prepare the correspondence to the solicitor so that the facts of the case are information is presented in a factual and straightforward manner. In addition draft the Notice of Violation in accordance with the policies and procedures of the jurisdiction for the solicitor's review.

The municipal solicitor is:

Michelle M. Cook, Esq.  
126 Beaver Street  
Anytown, PA 99999

## **STATION G**

### **Field Inspection 3**

As a Fire Inspector candidate, you will identify commercial facility that has the following characteristics:

- Has a wet or dry automatic fire sprinkler system
- Has a monitored fire alarm system
- Has at least one portable fire extinguisher present
- Is connected to a public water supply with water flow test data available

Contact the facility ownership and obtain permission to conduct a fire inspection of the facility. Once you have permission to conduct the inspection, conduct your fire inspection, including fire suppression systems and fire alarm systems present. Document your findings in a written inspection report with appropriate supporting data and notice of violation. As part of your inspection verify and document the available fire flow.

Complete your field inspection and communicate the results of your inspection in writing in accordance with the policies and procedures of the jurisdiction.

## **STATION H**

### **Fixed Fire Protection Acceptance**

You are the Fire Inspector for the Borough of Springtown. Steve Martin a local building owner and businessman has made application to replace the commercial hood in his existing café. The complete permit application has been provided with supporting documentation. The existing café is a Business “B” occupancy with a maximum occupancy of 40 persons in a single-story Type III-A building.

1. As the fire inspector for the Borough of Springtown, Pennsylvania process and review the following permit application in accordance with the policies and procedures of the jurisdiction and communicate your findings to the permit applicant.
2. Assume that the attached drawings were the approved permit drawings. The hood system was installed and you were called for a final inspection of the system. You made field notes on a copy of the system drawing that are attached as “field notes.” You were not called for any testing that that was completed on the system, but the contractor stated that all required testing was completed and “passed with flying colors.” Using your “field notes”, Complete your field inspection and communicate the results of your inspection in writing in accordance with the policies and procedures of the jurisdiction.

Building Permit No:

Zoning Permit No:

Water Permit:

Sewer Permit:

## APPLICATION FOR ZONING AND BUILDING PERMIT

### LOCATION OF PROPOSED WORK OR IMPROVEMENT

Municipality: Springtown Borough Tax Parcel No: 99-255-,123-,0000-  
 Street Address: 999 Bogart Avenue  
 Rural Directions: \_\_\_\_\_

### TYPE AND COST OF WORK OR IMPROVEMENT

<b>Type of Property:</b> <input checked="" type="checkbox"/> Commercial <input type="checkbox"/> Residential <input type="checkbox"/> Current Rental <input type="checkbox"/> Proposed Rental	<b>Type of Improvement:</b> <input type="checkbox"/> New building <input type="checkbox"/> Addition <input type="checkbox"/> Alteration <input checked="" type="checkbox"/> Repair, replacement <input type="checkbox"/> Demolition <input type="checkbox"/> Electrical ONLY <input type="checkbox"/> Sprinkler System ONLY	<b>Building Information:</b> <b>Dimensions:</b> Height (feet): _____ No of Stories: _____ Total Square footage: _____  <b>Type of sewage disposal:</b> <input checked="" type="checkbox"/> Public or private company <input type="checkbox"/> Private (on lot septic tank, etc.)  <b>Type of water supply:</b> <input checked="" type="checkbox"/> Public or private company <input type="checkbox"/> Private (well, cistern)
<b>Declared cost</b> \$ <u>\$25,000</u>		

**Describe proposed work:**  
Replace existing commercial hood system with a new hood system

Role:	Name	Address	Phone No	Email
Owner	Steve Martin	999 Bogart Ave	(999)828-1234	Marins@gmail.com
		Springtown, PA, 19981		
Tenant				
Contractor	Hoods-R-Us	456 1 <sup>st</sup> Avenue, Peru, PA, 19991	(999)800-1212	HoodsRUs@gmail.com
Design Professional	Frank Oz, P.E.	319 3 <sup>rd</sup> Avenue, Peru, PA, 19991	(999)800-1665	Ozman@gmail.com

### AFFIDAVIT

I hereby certify that I am the owner in fee or the authorized agent of the owner in fee of the property upon which the work authorized by the permit sought will be performed. All work will be performed in accordance with all applicable laws of the Commonwealth of Pennsylvania and this jurisdiction.

Signature of applicant <i>Steve Martin</i>	Address 999 Bogart Ave, Springtown, PA 19981	Application Date April 1, 2024
Print Name Steve Martin	Email/Phone <a href="mailto:Marins@gmail.com">Marins@gmail.com</a> /(999)828-1234	Role Owner

ADDRESS:



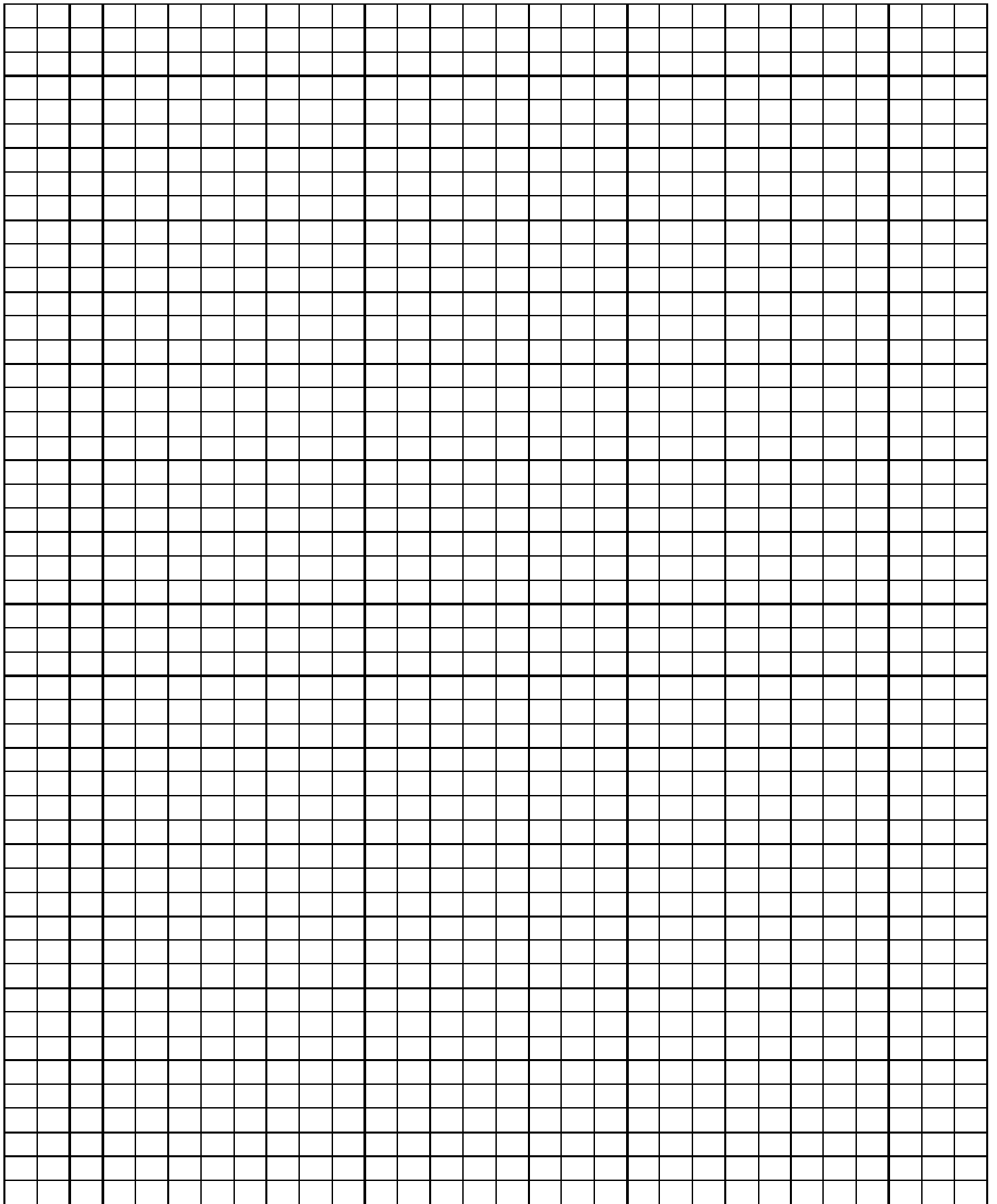

**ZONING PLANS EXAMINER NOTES**

Zone: _____ Lot Square Footage: _____ Percent Coverage: _____	Off-street parking spaces Enclosed: _____ Outdoors: _____		North "//		Required	Provided
		Set Backs				
		Front				
		Right Side				
		Left Side				
		Rear				

Notes: \_\_\_\_\_  
 \_\_\_\_\_  
 \_\_\_\_\_

Approved: \_\_\_\_\_ Date approved: \_\_\_\_\_ Permit No.: \_\_\_\_\_

**CODES PLANS EXAMINER NOTES**

OCCUPANCY INFORMATION

Type of Construction: \_\_\_\_\_ Use Group: \_\_\_\_\_

FLOOR	# OF UNITS	MAX OCC LOADS	MAX LIVE LOAD (lbs per sq.ft.)	FLOOR	#OF UNITS	MAX OCC LOAD	MAX LIVE LOADS (lbs per sq.ft.)
BASEMENT				SEVENTH FLOOR			
FIRST FLOOR				EIGHTH FLOOR			
SECOND FLOOR				NINTH FLOOR			
THIRD FLOOR				TENTH FLOOR			
FOURTH FLOOR				ELEVENTH FLOOR			
FIFTH FLOOR				ROOF			
SIXTH FLOOR				OTHER			

Plan Approved: \_\_\_\_\_ Date Approved: \_\_\_\_\_

Building Permit No: \_\_\_\_\_ Date Permit Issued: \_\_\_\_\_

Permit fee **S** \_\_\_\_\_ Deposit Paid **S** \_\_\_\_\_ Balance Due **S** \_\_\_\_\_

Deposit Date \_\_\_\_\_ Check/Cash \_\_\_\_\_ By \_\_\_\_\_

Ansul Pre-Engineered Fire Suppression System

Installation Location:

Wet Chemical - Kitchen System



# Ansul Pre-Engineered Fire Suppression System

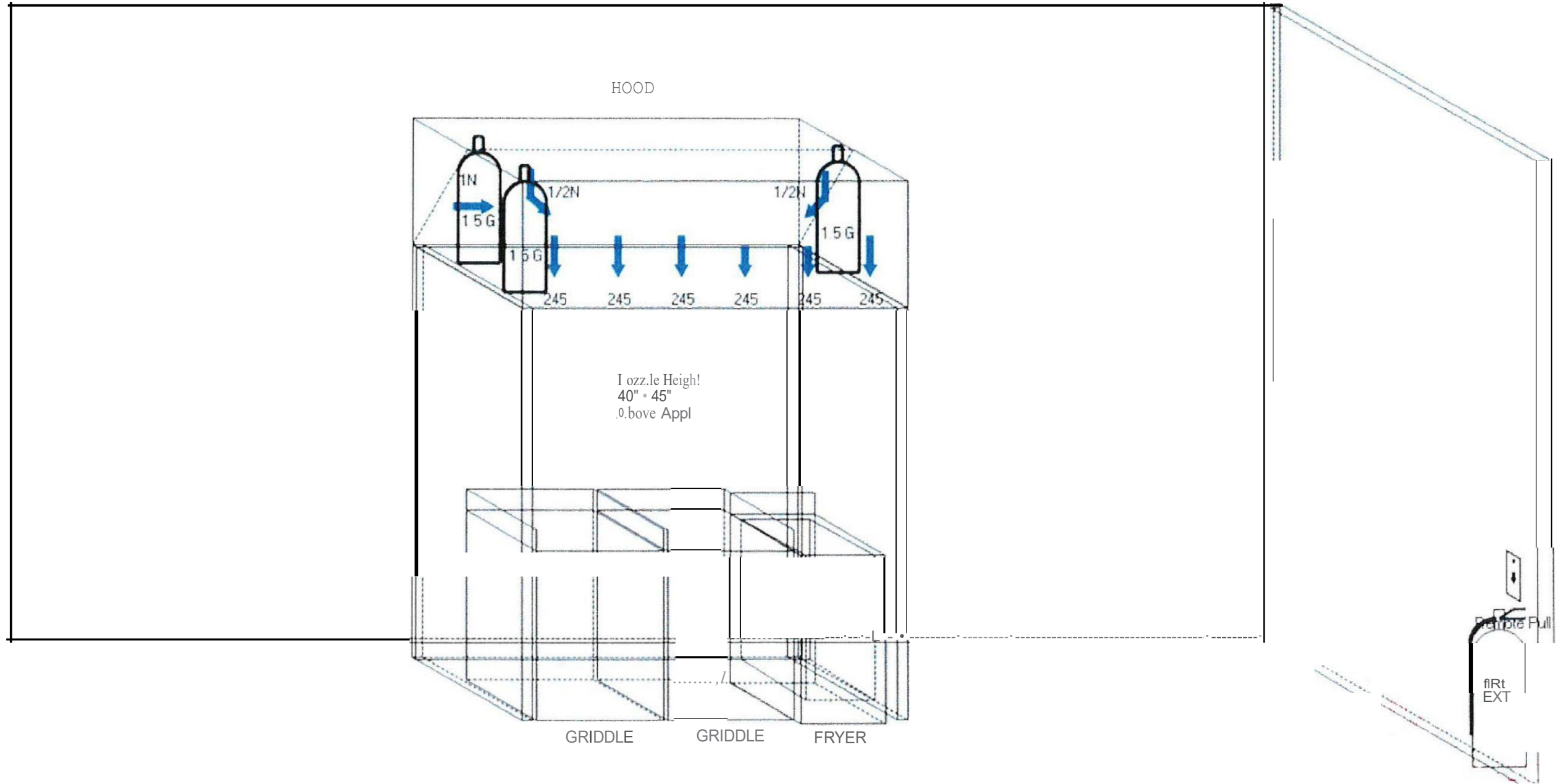

SCALE  
1 foot

Total System Flow Points= 15: Flow Points Used= 14

Designed & Installed by:

For:

**FIRE & SAFETY INC.**

Joo: Wells Duct-Less Hood

Designer: DL

Permit#: CB-16542

Date: 10/11/2024

7J  
7J  
0  
U  
f71  
110  
1'0  
S:  
1'7  
Z  
U  
0  
Z  
7J  
A  
Z

B  
Z  
O  
R  
D  
I  
Z  
I  
G

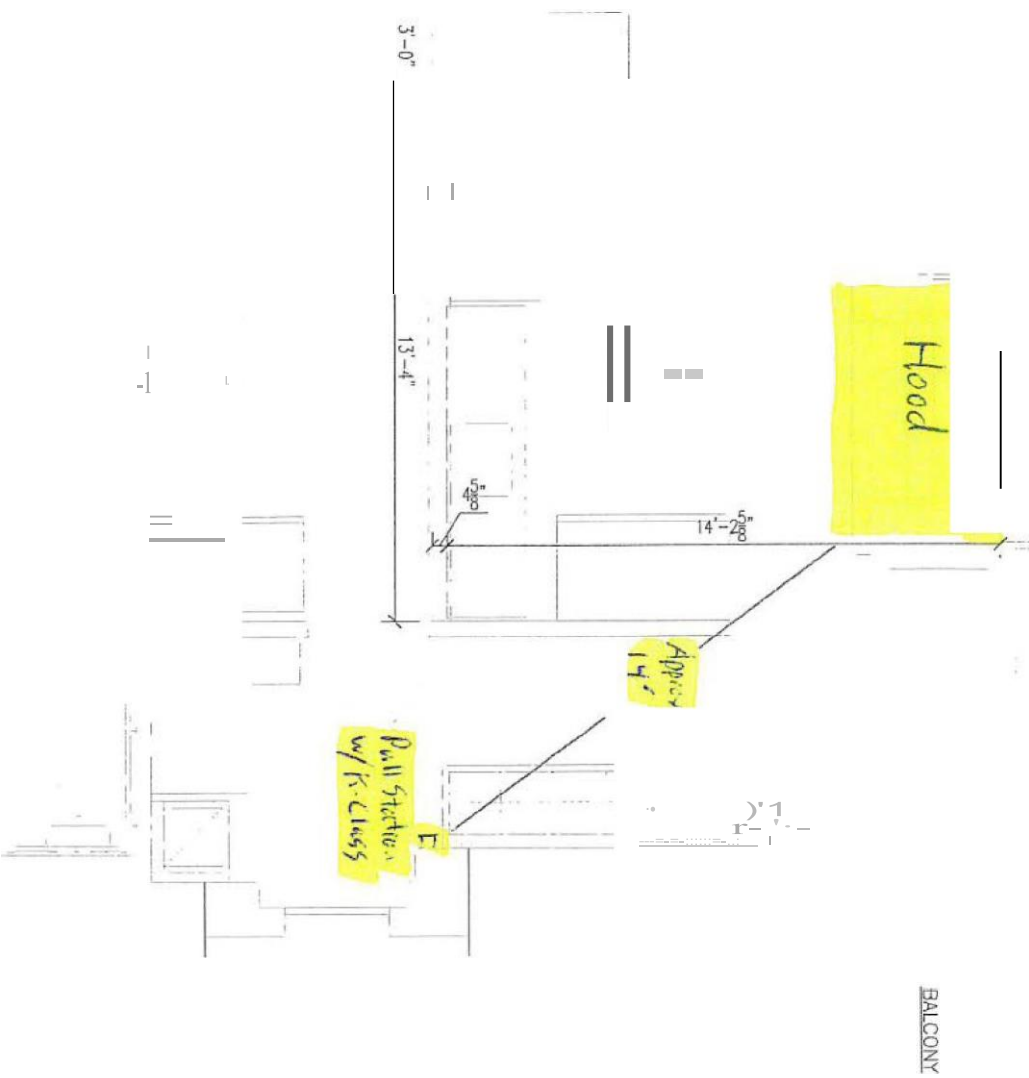
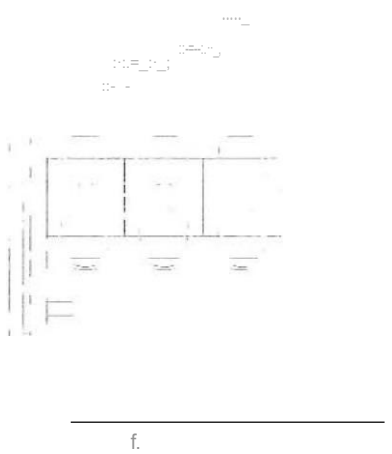
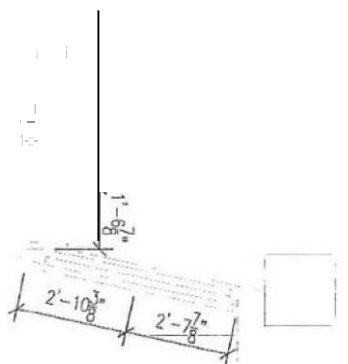

# Ansul Pre-Engineered Fire Suppression System

## Notes

- Upon activation an audible or visual indicator shall be provided.
- All Electric work to be performed by the customer's Licensed Electrician.
- Exhaust shall remain on during system discharge.
- A Class K fire extinguisher shall be located within 30' of the cooking area
- Remote pull station shall be no higher than 48" above finished floor and in the path of egress.

## System Materials

Item Number	Description	Flow	Qty
429864	1. 5 Gallon (UL/ULC) SS. Tank Assembly		3
439837	Nozzle, 1/2N	1.0	2
439838	Nozzle, 1N	1.0	1
439843	Nozzle, 245	12.0	6
434618	Remote Pull Station, Red (without wire rope)		

Total Flow Points: 14.0



FIRE & SAFETY INC.

For: \_\_\_\_\_



# Ansul Pre-Engineered Fire Suppression System

R-102net-rwtsnl ira Supp,ossKjn Manual

SECTION 3 - SYSTEM COMPONENTS  
UL EX3470 ULC EX3470  
2011-SEP-01 REV 11 PAGE Jn

### ALARM INITIATING SWITCH

The Alarm Initiating Switch Kit (Part No. J2BJ11) consists of one 111 detector(s) according to the temperature condition circuit below:



FIGURE 3-31

### REGULATOR TEST KIT

The Regulator Test Kit (Part No. 56072) is required to test the regulator assembly. It includes a 12-year minimum life span. This kit is used to test the regulator assembly.

FIGURE I-32

### VENT PLUG ASSEMBLY

The Vent Plug Assembly (Part No. 7427) is installed on the agent tank adaptor to prevent pressure buildup in the tank.

### CARTRIDGE RECEIVER GASKET

The Cartridge Receiver Gasket (Part No. 101) is installed in the release and outlet of the cartridge receiver to create a seal.

### FUSIBLE LINK

Select correct UL Listed Link (5) for installation 111 detector(s) according to the temperature condition circuit below:

SL STYLE	Temporatura	To Be Used Where Temperature Does Not Exceed	Color of Link
439085 (25)	165 °F	100 °F (74 °C)	Black (38 °C)
439000 (25)	212 °F	150 °F (100 °C)	White (65 °C)
439007 (25)	200 °F	225 °F (107 °C)	Blue (143 °C)
439080125	360 °F	290 °F (143 °C)	Red (143 °C)
4300B9 (25)	450 °F	360 °F (232 °C)	Green (143 °C)

### APC STYLE

Par No	Temporatura	To Be Used Where Temperature Does Not Exceed
430,27 (10)	165 °F (74 °C)	100 °F (38 °C)
439228 (10)	212 °F (100 °C)	150 °F (65 °C)
439229 (10)	200 °F (136 °C)	225 °F (107 °C)
439230 (10)	360 °F (182 °C)	290 °F (143 °C)
439231 (10)	450 °F (232 °C)	360 °F (192 °C)
419232 (25)	500 °F (260 °C)	400 °F (204 °C)

### MAXIMUM REGISTERING THERMOMETER

The Maximum Registering Thermometer (Part No. 15240) may be used to determine the maximum temperature of the fire. Once this is established, the correct rated fusible link can be chosen. Other methods for determining maximum temperatures may be used.

### HOSE/GROMMET PACKAGE

The Hose/Grommet Package (Part No. 418511) consists of a 24 in. rubber hose and two grommets. This package is required when the expellant gas hose is routed outside the AUTOMAN Regulated Release. Regulated Actuator, remote tank enclosure (if applicable).

SECTION 3- SYSTEM COMPONENTS  
UL EX3470 ULC 00470  
PAGE 3-6 REV. 11 2014-SEP-01

R-102 Re5/Buranl Fin: Supp1155(011 Mt11U81

### SWIVEL ADAPTOR

The Swivel Adaptor Assembly consists of a swivel ball, swivel body and swivel ball. All are chrome-plated. The swivel adaptor allows Einy Aozzle to be rotated approximately 30° in all directions. Swivel Adaptor, 10, 15, 20, 25, 30, 35, 40, 45, 50, 55, 60, 65, 70, 75, 80, 85, 90, 95, 100, 105, 110, 115, 120, 125, 130, 135, 140, 145, 150, 155, 160, 165, 170, 175, 180, 185, 190, 195, 200, 205, 210, 215, 220, 225, 230, 235, 240, 245, 250, 255, 260, 265, 270, 275, 280, 285, 290, 295, 300, 305, 310, 315, 320, 325, 330, 335, 340, 345, 350, 355, 360, 365, 370, 375, 380, 385, 390, 395, 400, 405, 410, 415, 420, 425, 430, 435, 440, 445, 450, 455, 460, 465, 470, 475, 480, 485, 490, 495, 500, 505, 510, 515, 520, 525, 530, 535, 540, 545, 550, 555, 560, 565, 570, 575, 580, 585, 590, 595, 600, 605, 610, 615, 620, 625, 630, 635, 640, 645, 650, 655, 660, 665, 670, 675, 680, 685, 690, 695, 700, 705, 710, 715, 720, 725, 730, 735, 740, 745, 750, 755, 760, 765, 770, 775, 780, 785, 790, 795, 800, 805, 810, 815, 820, 825, 830, 835, 840, 845, 850, 855, 860, 865, 870, 875, 880, 885, 890, 895, 900, 905, 910, 915, 920, 925, 930, 935, 940, 945, 950, 955, 960, 965, 970, 975, 980, 985, 990, 995, 1000.

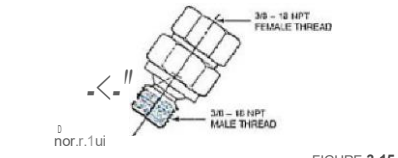

FIGURE 3-15

### METAL BLOW-OFF CAP

The Metal Blow-Off Cap helps keep the orifice of the nozzle free of grease or other substances that could interfere with agent distribution.

The Metal Blow-Off Cap (Part No. 439861) contains 10 blow-off caps. Also available is a 10 p81d; or Stainless Steel EUOW Off Clips (Part No. 439866).

### REDUCING COUPLING

The Reducing Coupling (Part No. 4J6i20) is made of stainless steel material with 3/16 in. x 1/2 in. NPT inlet threads. If necessary, the reducing coupling can be utilized with the Agonist Distributor Hose Line Kit (Part No. 435982). Two couplings may be required per Agonist Distributor Hose.



FIGURE 3-17

### CONDUIT OFFSET ASSEMBLY

The Conduit Offset Assembly (Part No. 435961) is used to change the direction of the wire rope on detection, mechanical gas valve, and remote pull station lines. The conduit offset assembly can only be used in the area where the conduit attaches to the regulated release assembly. When using the conduit offset assembly, the maximum number of pulleys allowed is 16. The Conduit Offset Assembly (Part No. 436063) consists of 6 conduit offsets.

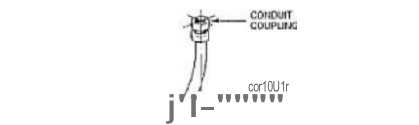

FIGURE J-18

### "OUK-SEAL" ADAPTOR

The "Ouk-Seal" adaptor is a listed mechanical bulkhead fitting that produces a liquid-tight seal around both distributor piping and detection conduit which runs through restaurant hoods and ducts. The Ouk-Seal Adaptor accepts the EMT pipe or conduit. The adaptor is available for 1 1/4 in. (PM No. 78100), 3/8 in. (Part No. 772a5), 1/2 in. (Part No. 772b7), or 1/4 in. (Part No. 77209) pipe or conduit sizes. When using with EMT conduit, a conduit connector must be installed in each end of the adaptor. The Ouk-Seal Adaptor Shipping Assembly must be ordered as listed below.

Size	Shipping Assembly Part No.	Qty	Maximum Length
1/4 in.	7B196	24	3/4 in.
1/2 in.	772b5	24	1118 in.
1/2 in.	772b7	24	1118 in.
3/4 in.	772b9	24	1 JIB in.

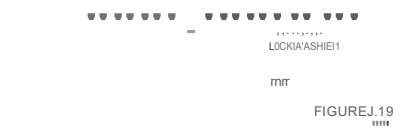

FIGURE J-19

R-102 Resu1ura11i Filis Slppres5(111Mtrual

SECTION 3 - SYSTEM COMPONENTS  
UL EX:1470 ULC D:3470  
2014-SEP-01 REV. 11 PAGE 3-7

### "COMPRESSION-SEAL" ADAPTOR

This adaptor is a mechanical bulkhead fitting that produces a liquid-tight seal around 1 1/2 in. EMT conduit when installed in detection line through restaurant hoods and ducts. The Compression-Seal Adaptor is a single through fitting requiring no nutting or threading of conduit or pipe. The adaptor is available for pipe sizes of 1 1/4 in. (Part No. 79149), 3/8 in. (Part No. 79151), 1/2 in. (Part No. 79147), and EMT conduit size of 1 1/2 in. (Part No. 79153). Each Compression-Seal Adaptor Shipping Assembly must be ordered as stated below.

Size	Shipping Assembly Part No.	Qty	Maximum Length
1 1/2 in. Pipe / 1 1/2 in. tube	79153	0	314 in.
1/2 in. Pipe / 1/2 in. tube	79147	24	1110m.
1 1/2 in. Pipe / 1 1/2 in. tube	79153	24	1110m.

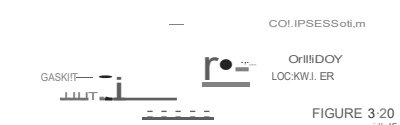

FIGURE 3-20

### "HOOD SEAL" ADAPTOR ASSEMBLY

This adaptor is a mechanical bulkhead fitting that produces a liquid-tight seal around 1 1/2 in. EMT conduit when installed in detection line through restaurant hoods and ducts. The adaptor accepts a 1 1/2 in. temperature pulley or EMT Orf, when used, correctly closes the hood or conduit in 1 1/2 in. with the hood or hole in the detector bracket. The Hood Seal eliminates the need for multiple fittings when penetrating the hood or a hood when installed in the hood or duct line. Hood Seal Adaptors are available in quantities of 24 as Shipping Assembly Part No. 423253.

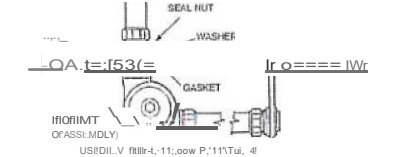
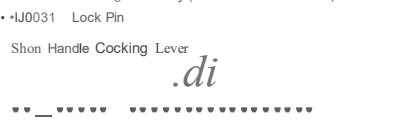

FIGURE J-21

### COCKING LEVER/LOCK PIN

The cocking lever is a component required to cock (arm) both the 1 1/2 in. mechanical gas valve and the AUTOMAN remote mechanical gas valve. The cocking lever is cocked (armed), the lock pin must be inserted to eliminate the accidental firing of the remote mechanical gas valve. These components are available as either an individual shipping assembly or shipping assembly containing both. Listed below are the various shipping assemblies part numbers.

Part No.	Description
441042	Short Handle Cocking Lever with 1 1/2 in. Lock Pin (Mechanical Gas Valve)
4110111	Lock Pin (Mechanical Gas Valve)
25310	Cocking Lever Only (AUTOMAN 1 1/2 in.)
41G0m	Cocking Lever Only (Mechanical Gas Valve)
4J0031	Lock Pin



### Long Handle Cocking Lever

The Long Handle Cocking Lever (Part No. 4110111) is used to cock the 1 1/2 in. mechanical gas valve. The long handle cocking lever is cocked (armed), the lock pin must be inserted to eliminate the accidental firing of the remote mechanical gas valve. These components are available as either an individual shipping assembly or shipping assembly containing both. Listed below are the various shipping assemblies part numbers.



FIGURE 3-22

## EXPLODED VIEW & PARTS LIST

### Universal Hood Suppression System

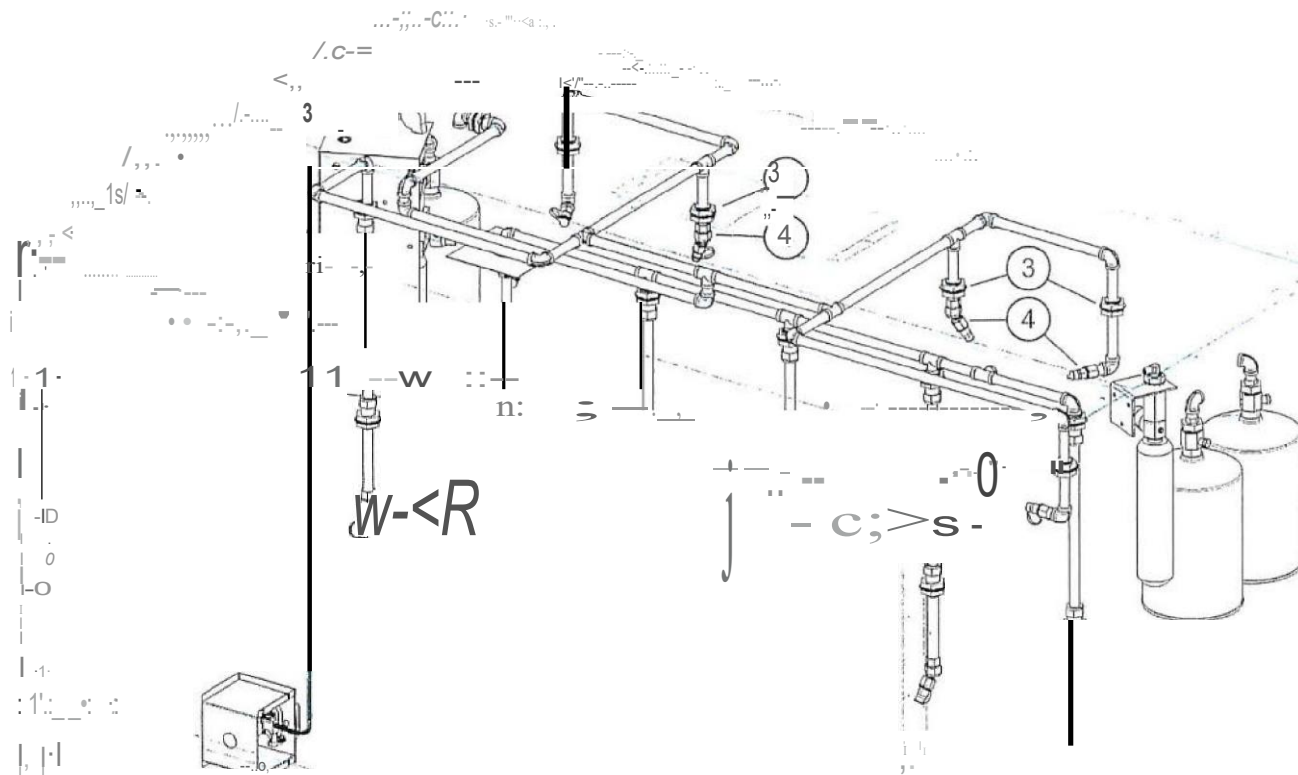

#### Model WVU-72: Suppression System

Fig No.	Part Number	Quantity	Description
1	2K-301245	12	COMPRESSIONSEAL 1/2 EMT
2	20-217942	6	SUPPRESSION NOZZLE230
3	2K-47269	19	ADAPTER3/BINQUICKCON A
4	20-220376	4	NOZZLE,# 1/2 N
5	20-47267	1	NOZZLE ANSUL 1N
6	2K-Z15635	2	ELBOW.MALE7/16-20x1/4NPT
7	20-307966	1	ANSULREG. ACTUATORASSY
8	20-Z14918	1	ANSUL CARTRIDGELT-30-R
9	N1-Z15435	1	ELEC. AUTOMANBKT. MODIFY
10	20-47099	1	ANSUL CARTRIDGELT-20-R
12	20-304433	3	TANK SS ANSULEX 1.5GALLO

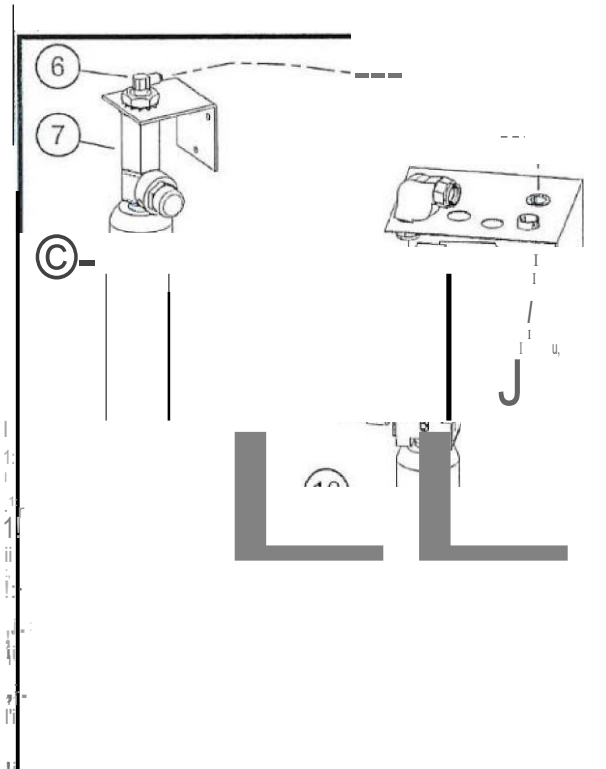

14	20-308131	1	REMOTE PULL STATION RED
----	-----------	---	-------------------------

WVU72: Suppression System



SK2941 Rev. - 12128/2015

## EXPLODED VIEW & PARTS LIST

Universal Hood Base A

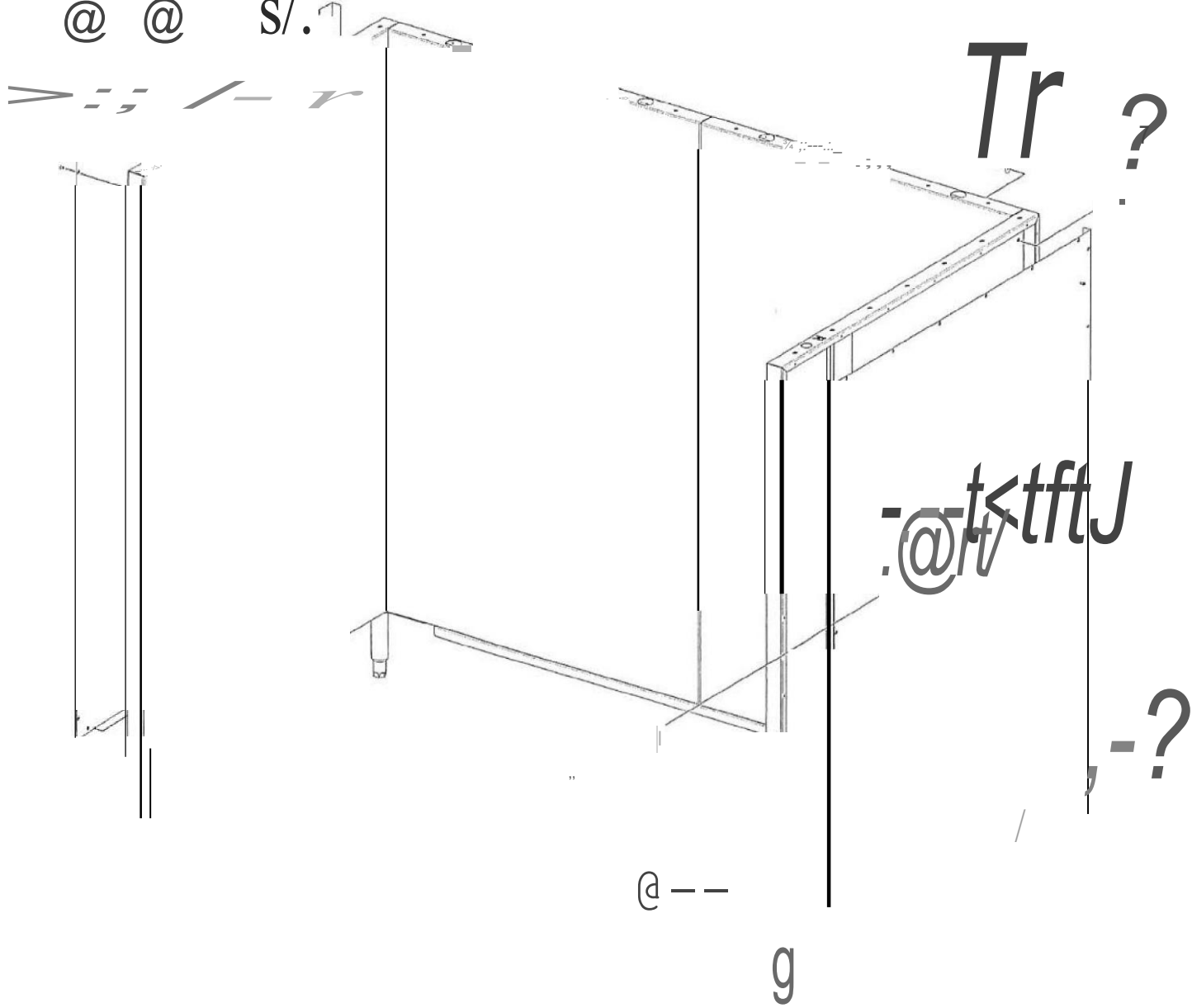

### Model WVU-72: Universal Hood Base Assembly

Fig No.	Part Number	Quantity	Description
1	2C-31715	50	SCREW 8-32X5/16 PH RD HD
2	N1-Z14152	1	COVER, BASE SIDE LEFT
3	N1-WL0661	1	BASE, SUPPORT ASSY, LEFT
4	N1-Z19037	2	PANEL, REAR BASE SUPPORT
5	2C-Z5555	70	BOLT 1/4-20 X .75 HEX SS
6	2C-A27469	70	WASHERJLAT 1/4IN 7/8OD 1
7	2C-6517	70	NUT 1/4-20HEX STL NP
9	2P-70903-05	1	PLG BTN PLTD MTL 7/8
10	N1-WL0126	1	BOX, MANUAL PULL ASSEMBLY
11	N1-WL0180	1	COVER,BASE SIDE RT ASSY
12	2A-307628	4	LEG 6ADJ 1/2-13 SS
13	N1-WL0662	1	BASE, SUPPORT ASSY RIGHT
15	2C-31730	2	SCREW 8-32X1/2 PH TR HO M

WVU72: Base Assembly

S1<2945 Rev. - 12/29/2015

a  
C  
Cii  
(2  
C  
S  
8-  
o  
N  
cu  
Q  
N  
1.0



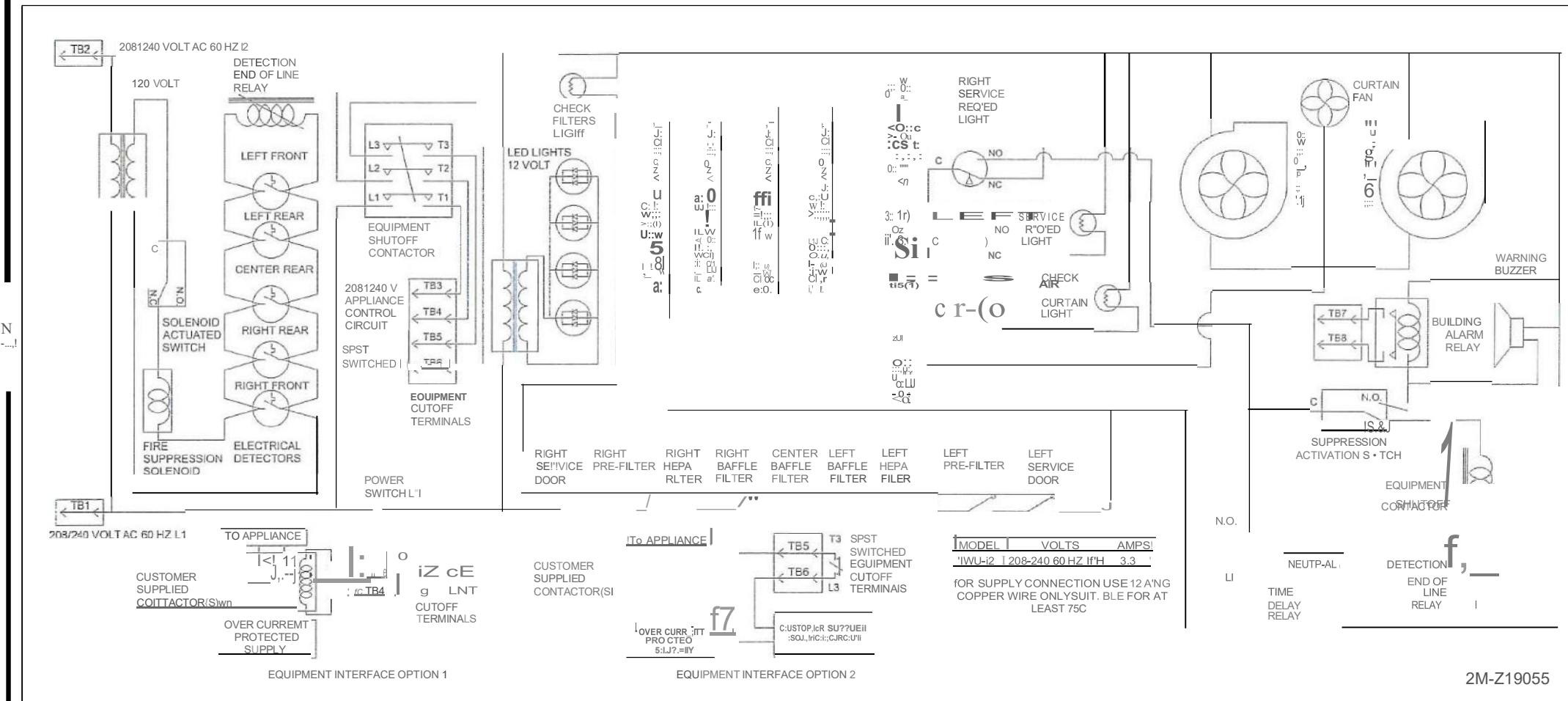

**FRONT SECTION**

**SHEET 2 OF 3**

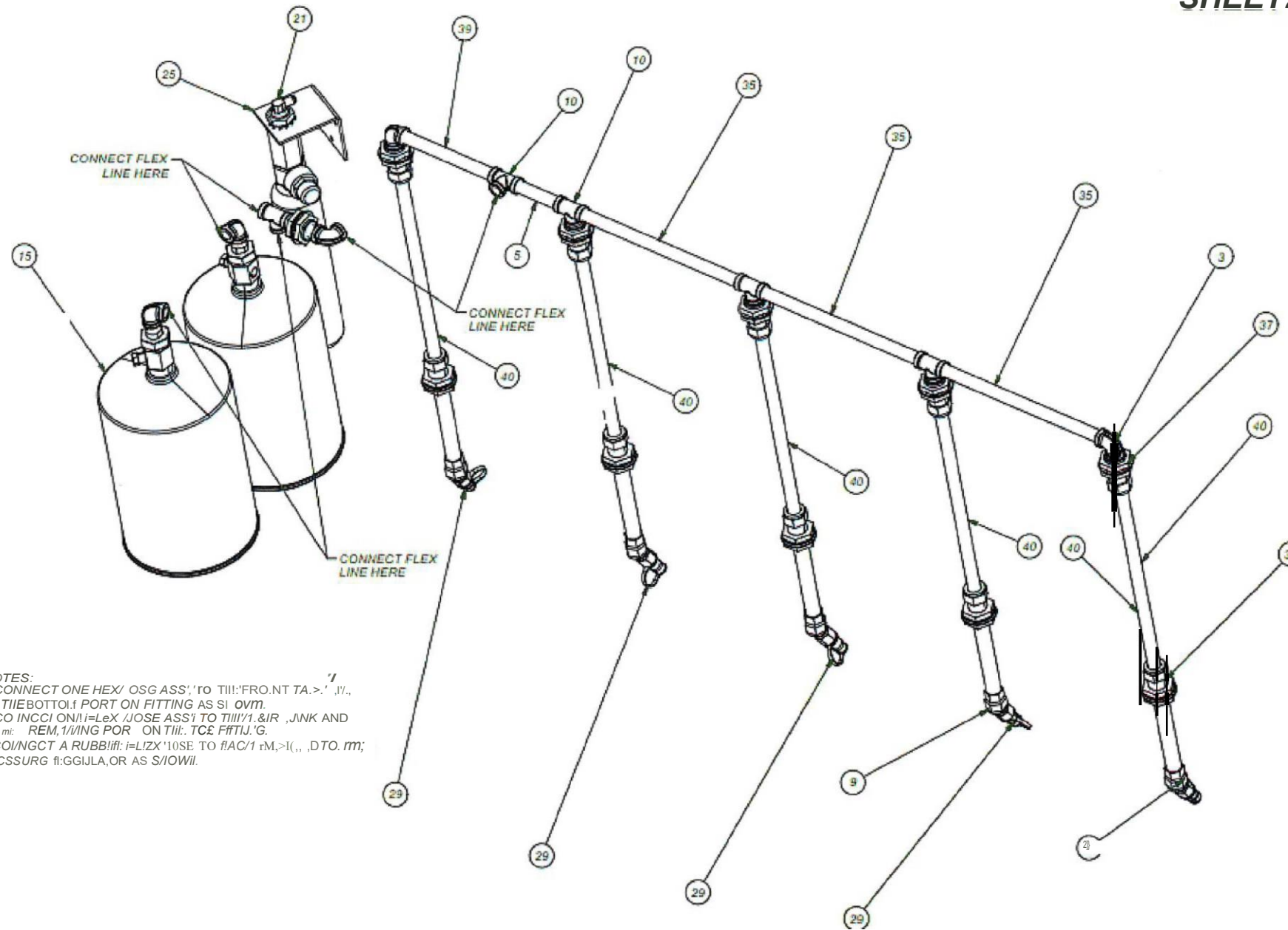

NOTES:  
 1. CONNECT ONE HEX/ OSG ASSY TO THE FRONT TANK AS SHOWN TO THE BOTTOM PORT ON FITTING AS SHOWN.  
 2. CONNECT ONE HEX/ JOSE ASSY TO THE 1/2" AIR JUNK AND TO THE REMAINING PORT ON THE TCE FITTING.  
 3. CONNECT A RUBBER HOSE TO EACH TANK AS SHOWN TO THE SURGE FILLER, OR AS SHOWN.

<p><b>BLOOMFIELD</b>                  STAR MANUFACTURING                  #10 SUNNEN DRIVE                  ST. LOUIS, MO. 63143, USA</p>	DATE: 01/15/01 AS SHOWN
	PART NO: M1-W1-0667

Paris List			
ITEM	PIN	TITLE	QTY
1	2K-47269	ADAPTER 3/8" QUICK CONNECT	7
2	2K-301312	NIPPLE, 3/8"NPT x 3"LG, SS	5
3	2K-Z15523	ELBOW 3/8 NPT X 90 DEG SS	23
4	2K-Z14561-8	PIPE, 3/8"NPT x 22.25"LG, SS	
5	2K-Z14561-5	PIPE, 3/8"NPT x 3.25"LG, SS	2
6	20-47267	NOZZLE, #1N	
7	2K-300435	NIPPLE CLOSE 3/8 NPT BI N	14
8	2K-Z19044-4	PIPE, 3/8"NPT x 4" LG, SS.	2
9	20-307481	ADAPTER, SWIVELANSUL	8
10	2K-Z15522	TEE - 3/8 x 3/8 x 3/8 NPT SS	10
11	2K-Z14561-2	PIPE, 3/8"NPT x 10.75"LG, SS	
12	2K-Z17787-2	PIPE, 3/8"NPT x 7.125" LG, SS.	2
13	2K-Z14561-10	PIPE, 3/8"NPT x 24.65"LG, SS	
14	20-47272	PULLEY ELBOW	1
15	20-304433	TANK SS ANSULEX 1.5 GAL	3
16	N1-Z15435	ELEC, AUTOMAN	1
17	20-47099	ANSUL CARTRIDGE LT-20-R (COMPRESSED NITROGEN)	1
18	2K-8043	BUSHING HEYCO SB-875-10	2
19	2K-Z20052	PIPE, 1/4 NPT X 2.5 "LG SS	1
20	2K-Z15631	ELBOW, 1/4 NPT 90 DEG SS	1
21	2K-Z15635	ELBOW, MALE 7116-20 X 1/4" NPT	2
22	2K-Z14561-1	PIPE, 3/8"NPT x 6.00" LG, SS	2
23	2K-Z17787-1	PIPE, 3/8"NPTx 9.5" LG. SS.	2
24	20-Z14918	ANSUL CARTRIDGE LT-30-R (COMPRESSED NITROGEN)	1
25	20-307966	ANSUL REG. ACTUATOR ASSY	1
26	2K-Z19044-3	PIPE, 3/8"NPT X 18.5" LG, SS.	1
27	2K-Z14561-9	PIPE, 3/8"NPT x 5.75"LG, SS	1
28	20-Z20376	NOZZLE, # 1/2 N	4
29	20-Z17942	NOZZLE, 230	6
30	2J-Z15547	STAINLESS ACTUATOR HOSE (NOT SHOWN)	2
31	2K-70303-03	PIPE COUPLING 1/4 NPT (NOT SHOWN)	1
32	2J-Z15444	HOSE, ACTUATOR (NOT SHOWN)	3
33	2J-Z15426	HOSE, ASSY, FLEX SS, 20"LG (NOT SHOWN)	4
34	2K-Z14561-12	PIPE, 3/8"NPT x 2.75"LG, SS	2
35	2K-Z14561-3	PIPE, 3/8"NPTx 11"LG, SS	3
36	2K-Z19044-2	PIPE, 3/8"NPT x 12.0" LG.	2
37	2K-301245	COMPRESS/ON SEAL 1/2 EMT	12
38	2V-Z20377	CHROME TUBE	6
39	2K-Z19044-1	PIPE, 3/8" NPT X 6.5" LG,	1
40	2K-Z20971-1	PIPE, 3/8"NPT X 21.5"LG, SS.	5
41	2K-Z20971-2	PIPE, 3/8"NPT X 25.0"LG, SS.	1

NOTES:  
 1) APPLY TEFLON TAPE TO ALL JOINTS.  
 (TWO TURNS I NOT ON THE FIRST TWO THREADS)  
 2) NOTE NOZZLE LOCATION AND POSITION.  
 3) INSTALL FRONT SECTION FIRST.

# SHEET 1 OF 3

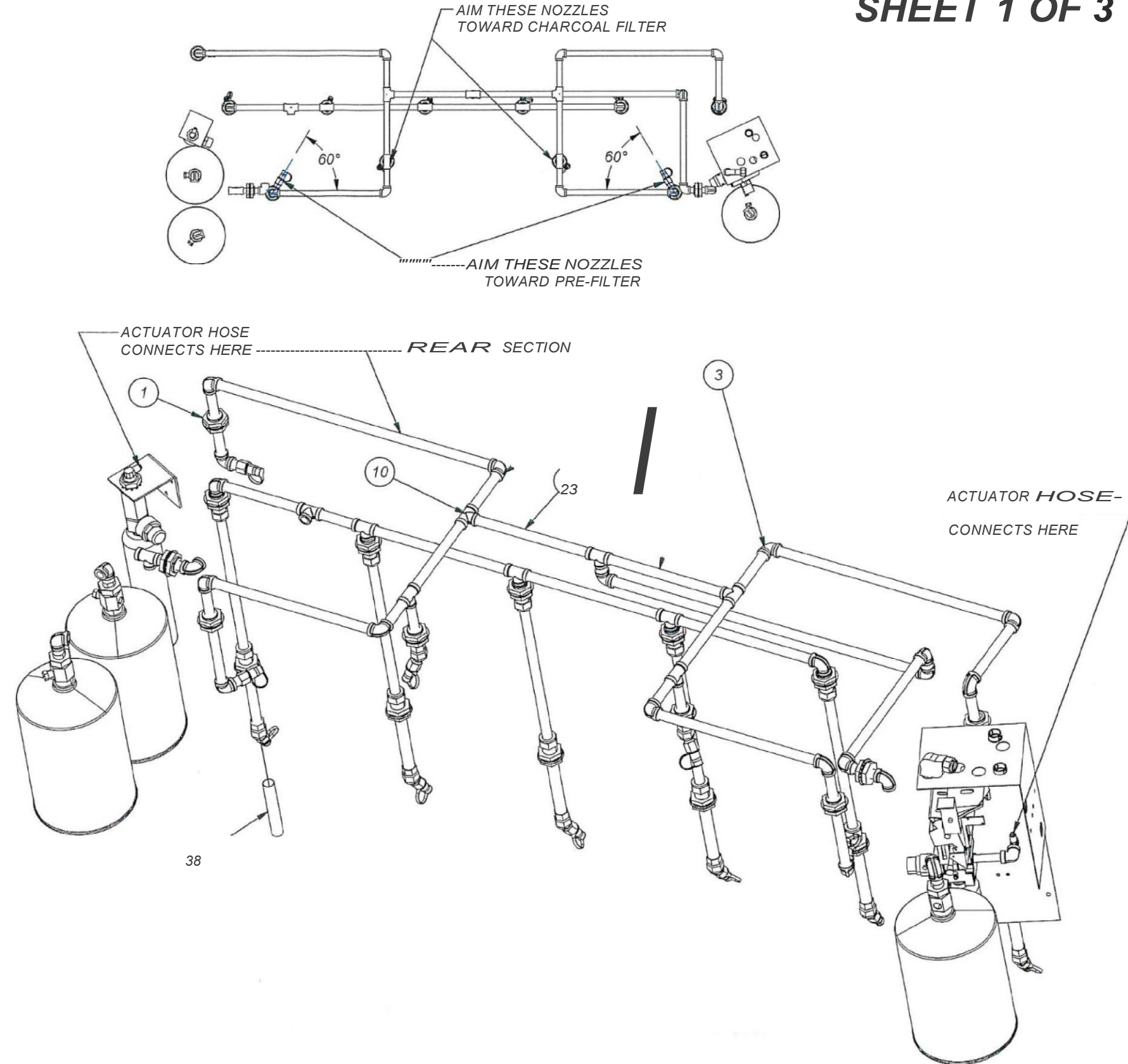

THIS DRAWING CONTAINS INFORMATION CONFIDENTIAL TO THE MIDDLEBY CO. NO REPRODUCTION OR DISCLOSURE OF ITS CONTENTS IS PERMITTED.

**WELLS**  
**BLOOMFIELD**  
 STAR MANUFACTURING  
 #10 SUNNEN DRIVE  
 ST. LOUIS, MO. 63143, USA

MATERIAL: AS SHOWN  
 FINISH: AS SHOWN  
 DR. WJK CK. DATE: 2/18/2015 TOLERANCE UNLESS NOTED: ±.015 ANGLES

MODEL NO. MWU-72  
 TITLE: 10438  
 PART NO. N1-ML0667

# FRONT SECTION

SHEET 2 OF 3

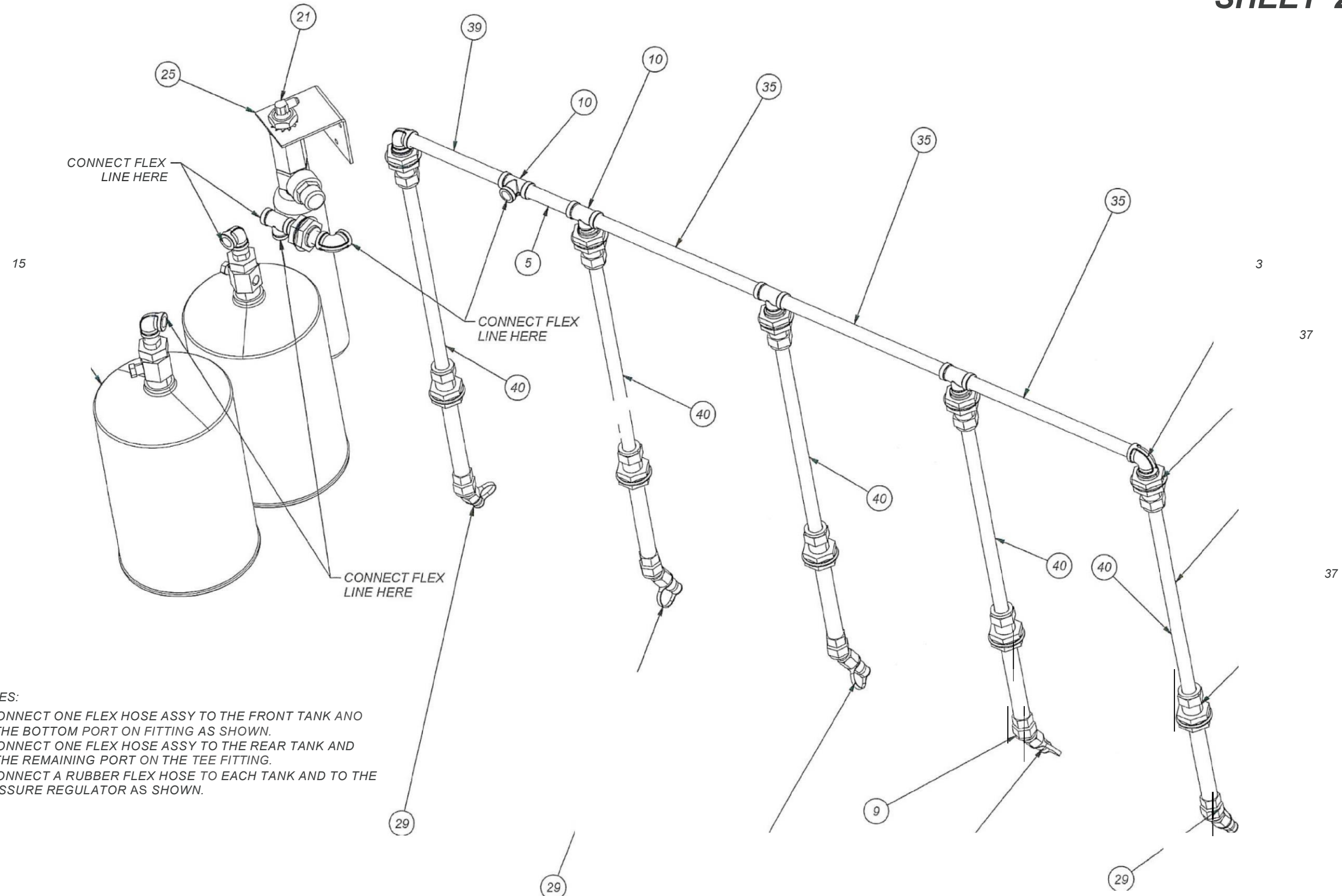

**NOTES:**

1. CONNECT ONE FLEX HOSE ASSY TO THE FRONT TANK AND TO THE BOTTOM PORT ON FITTING AS SHOWN.
2. CONNECT ONE FLEX HOSE ASSY TO THE REAR TANK AND TO THE REMAINING PORT ON THE TEE FITTING.
3. CONNECT A RUBBER FLEX HOSE TO EACH TANK AND TO THE PRESSURE REGULATOR AS SHOWN.

		<b>BLOOMFIELD</b> STAR MANUFACTURING #10 SUNNEN DRIVE ST. LOUIS, MO. 63143, USA	
MATERIAL	AS SHOWN	FINISH	
DR. M/JK	CK.	DATE:	2/18/2015
		TOLERANCE UNLESS NOTED:	±.015 ANGLES
REV	DATE	BY	APP
1	05/22		
2			
3			
4			
5			
6			
7			
8			
9			
10			
11			
12			
13			
14			
15			
16			
17			
18			
19			
20			
21			
22			
23			
24			
25			
26			
27			
28			
29			
30			
31			
32			
33			
34			
35			
36			
37			
38			
39			
40			
41			
42			
43			
44			
45			
46			
47			
48			
49			
50			



# Field Inspection Notes

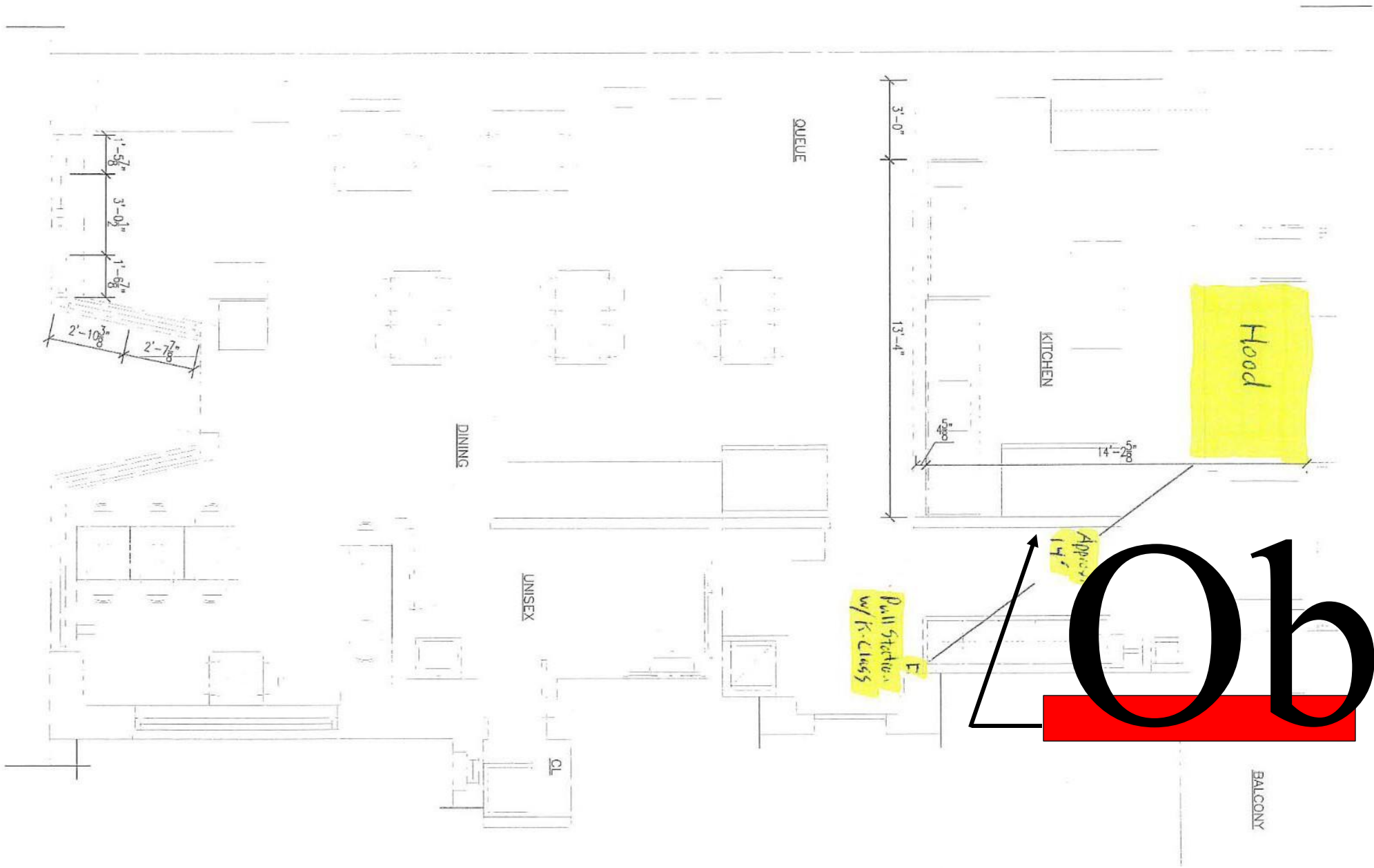

**Obs**

PROPOSED DIMENSION PLAN  
SCALE: 1/4" = 1'-0"



**EXPLODED VIEW & PARTS LIST**

Universal Hood Suppression System

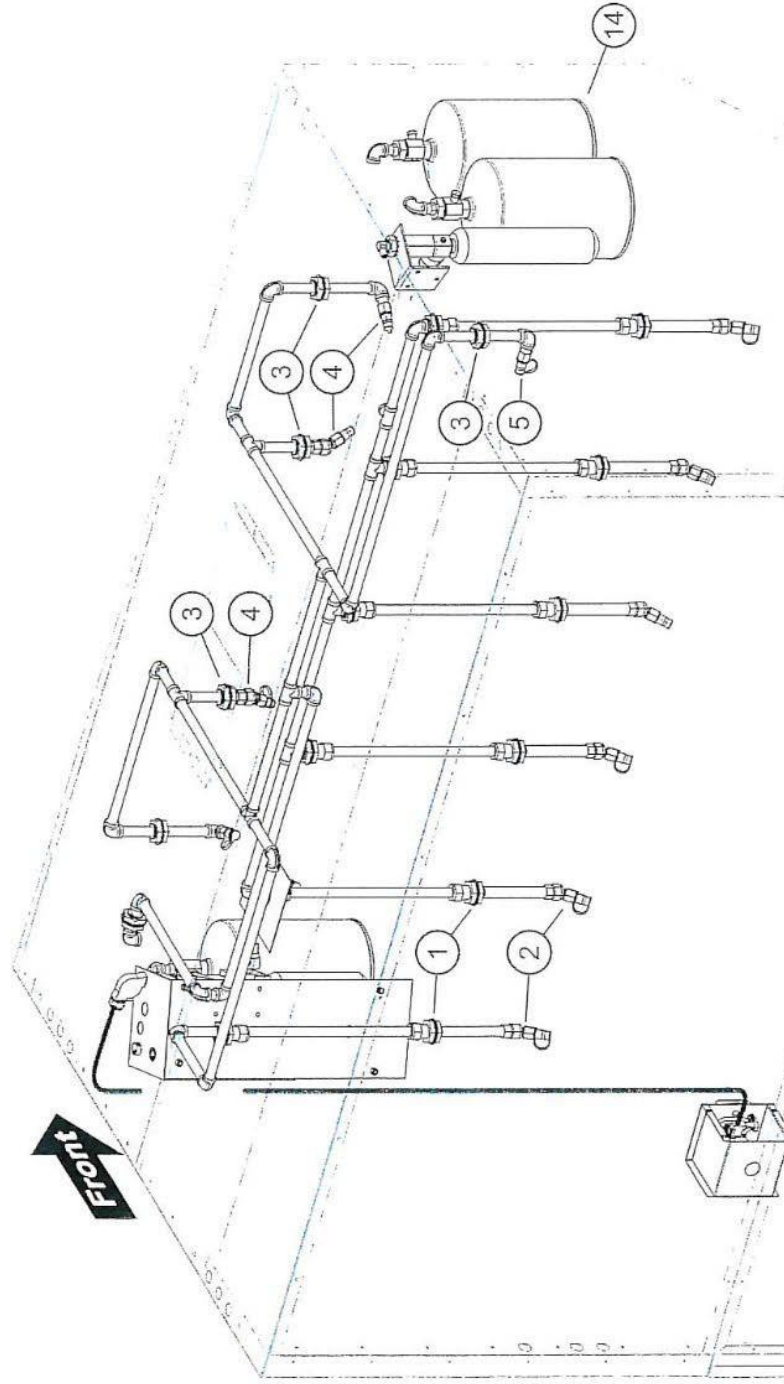

**Model WVU-72: Suppression System**

Fig No.	Part Number	Quantity	Description
1	2K-301245	12	COMPRESSION SEAL 1/2 EMT
2	20-Z17942	6	SUPPRESSION NOZZLE 230
3	2K-47269	19	ADAPTER 3/8IN QUICK CON A
4	20-Z20376	4	NOZZLE, # 1/2 N
5	20-47267	1	NOZZLE ANSUL 1N
6	2K-Z15635	2	ELBOW, MALE 7/16-20x1/4NPT
7	20-307966	1	ANSUL REG. ACTUATOR ASSY
8	20-Z14918	1	ANSUL CARTRIDGE LT-30-R
9	N1-Z15435	1	ELEC. AUTOMAN BKT. MODIFY
10	20-47099	1	ANSUL CARTRIDGE LT-20-R
12	20-304433	3	TANK SS ANSULEX 1.5 GALLO
14	20-308131	1	REMOTE PULL STATION RED

WVU72: Suppression System

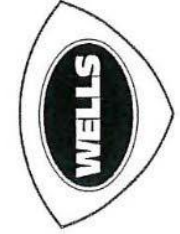

SK2941 Rev. - 12/28/2015

**Final**

## **STATION I**

### **Emergency Planning**

As the fire inspector for the Borough of Anytown, Pennsylvania, your department director asks you to review the existing emergency plan for the municipal building including emergency vehicle access (attached) making recommendations for changes and updates. The Borough is currently out of space and is looking at doing a building lot consolidation and building a second facility on the neighboring lot. The new building would be a two-story Type VB building equipped throughout with an automatic sprinkler system similar to the existing building.

Communicate your recommendations to your supervisor Ms. Mortia Adams, FM in writing in accordance with the policies and procedures of the jurisdiction.

**Borough of Anytown Pennsylvania**  
**Municipal Building**  
**Fire and Evacuation Plan**  
**November 5, 2007**  
**(revised October 3, 2013)**

I. Purpose

The purpose of this plan is to provide all employees and visitors to the Anytown Municipal building the knowledge necessary to escape the building in the event of an emergency.

II. Applicability

This plan shall apply to all employees of Anytown Borough based at the Municipal building located at 5600 Mockingbird Lane, Anytown, PA.

III. Policy

- A. The Borough of Anytown shall provide the fire and evacuation plan to each employee based at the Municipal office building.
- B. In the event of an emergency, Borough of Anytown employees shall follow the fire and evacuation plan.
- C. Unless specified in the plan, the designated meeting place for all building evacuations will be the sidewalk next to the Municipal building sign.
- D. Failure to follow the fire and evacuation plan may result in disciplinary action.

IV. Responsibility

- A. The Municipal Manager is responsible for the development, update and distribution of the fire and evacuation plan.
- B. The Department Directors are responsible for providing fire and evacuation plan training to agency employees.
- C. The Department Directors are responsible for posting the building evacuation plan at the exit of each suite.
- D. The Department Directors are responsible for review of the Run; Hide; Fight video with each employee. The video is available online at <http://www.youtube.com/watch?v=5VcSwejU2D0>.
- E. The employee is responsible for following the plan and assisting visitors during times of emergency.
- F. All employees are responsible for a calm response to the emergency. Do not panic!

## V. Procedure

### A. Fire

1. Upon discovery of a fire, the employee shall make verbal notification to all others in the immediate area of the fire.
2. Small fire (i.e. trash can) trained employee shall attempt to extinguish the fire while building is being evacuated.
3. Large fire- immediately evacuate the building.
  - a. Upon notification of a fire by audible fire alarm, employees shall evacuate the building. Employees shall evacuate without regard for personal belongings or Municipal property. Failure to evacuate immediately may cause injury or death. If the primary exit is blocked by smoke or fire, employees shall use a secondary exit.
  - b. Upon exiting the building, the employee should report to the designated meeting place (sidewalk next to the COG sign).
  - c. The first person with a cellular phone to the meeting place shall report the fire to 911.
  - d. The first department director to the meeting place shall confirm the call to 911 and act as the representative to the fire department.
  - e. Each department director or his/her designee shall account for all employees from the agency.
  - f. In the event of a missing employee, the department director shall notify 911 and the first arriving fire department representative.
  - g. All employees shall remain at the meeting place until released by their department director or his/her designee.

### B. Bomb Threat

1. In the event that an agency receives a bomb threat by telephone, the person receiving the threat shall attempt to complete the Bomb Threat Information Worksheet.
2. The department receiving the bomb threat shall make phone notification to all COG agencies by using the intercom system. Dial 6 and 1 on the phone system and advise all staff and visitors to evacuate the building and report to the designated meeting place (sidewalk next to the Municipal sign).
3. Upon completing the notifications, the agency shall notify 911. (when using building phone, first dial 9 for outside line)
4. Upon exiting the building, the employee should report to the designated meeting place.
5. The first department director to the meeting place shall confirm the call to 911 and act as the representative to the Borough of Anytown Police Department.
6. Each department director or his/her designee shall account for all employees from the agency.
7. All employees shall remain at the meeting place until released by their department director or his/her designee.

### C. Tornado

1. In the event that a department receives a tornado warning or spots a tornado, that agency shall make verbal notification to each of the COG building agencies. Dial 6 and 1 on the phone system and advise all staff and visitors to report to the basement. Each department has been issued a key to the stairwell door.
2. All employees shall report to the basement.
3. Each department director or designee shall account for all employees from the respective department.
4. All employees shall remain in the basement until released by your department director or his/her designee.

### D. Intruder

1. In the event of an intruder, employees will deploy the principle of Run; Hide; Fight. For the purpose of this plan, an intruder is anyone that disrupts the normal business of the COG. An intruder may be a visitor or could be a present or past employee.
2. Any employee who perceives an immediate threat of bodily harm (a violent act has not yet occurred) should disengage the intruder and leave the area; when in doubt contact 911; make a reasonable effort to notify other employees of the threat and notify a supervisor.
3. Any employee who encounters a hostile intruder which could cause death or serious injury should run from the building announcing the threat while evacuating to a safe place. When safely away from the building (do not go to fire meeting place) contact 911. Do not return to the building until contacted by a supervisor or advised by 911.
4. Any employee who encounters a hostile intruder situation and is not able to run should hide or fight as determined by the situation presented to the employee. Every hostile intruder situation will be different, and each employee should be prepared to hide and/or fight as needed.
5. When confronted by law enforcement during a hostile intruder situation, the employee should obey all verbal commands.
6. The employee should understand that law enforcement officers are required to engage the threat prior to treating or removing the injured.
7. Any employee with knowledge of a less immediate threat shall report the threat to a supervisor. Action for a less immediate threat will be determined by the Department Director after consult with the Executive Director.

### E. Other

1. In the event of any other type of emergency, a department director shall notify employees of the appropriate action.
2. In the event an employee needs assistance, the phone system can be used to alert others in the building. See below:

All phones in Municipal building: dial 61

### Attachments

Building Evacuation Plan

Bomb Threat Information Worksheet

Building Emergency Contact List

**Borough of Anytown  
BOMB THREAT INFORMATION WORKSHEET**

- 1) Exact time of call -----AM / PM  
 2) Exact words of caller .....
- \_\_\_\_\_
- \_\_\_\_\_
- \_\_\_\_\_

Questions to ask caller:

- a) When is the bomb going to explode? \_\_\_\_\_  
 b) Where is the bomb? .....
- c) What does it look like? \_\_\_\_\_  
 d) What kind of bomb is it? \_\_\_\_\_  
 e) What will cause it to explode? \_\_\_\_\_  
 f) Did you place the bomb? \_\_\_\_\_  
 Why? \_\_\_\_\_
- g) Where are you calling from? \_\_\_\_\_  
 h) What is your address? \_\_\_\_\_  
 i) What is your name? \_\_\_\_\_

Callers Voice: (circle)      Male      Female

Calm	Disguise	Nasal	Angry	Broke
Stutter	d Slow	Sincer	Lisp	n
Gigglin	Deep	e	Squeak	Rapid
g	Accent	Crying	y	Excite
Stresse		Loud	Slurred	d
d				Norma
				l

Is the voice familiar to you?      Yes /No  
 If yes, who does it sound like? \_\_\_\_\_

Were there any background noises?    Yes/ No  
 If yes, describe the noise: \_\_\_\_\_

Person receiving the call: \_\_\_\_\_      Date: \_\_\_\_\_

Telephone number call received at: \_\_\_\_\_  
 Call was transferred from: .....

**REPORT CALLS IMMEDIATELY TO 911**

# Borough of Anytown Municipal Building

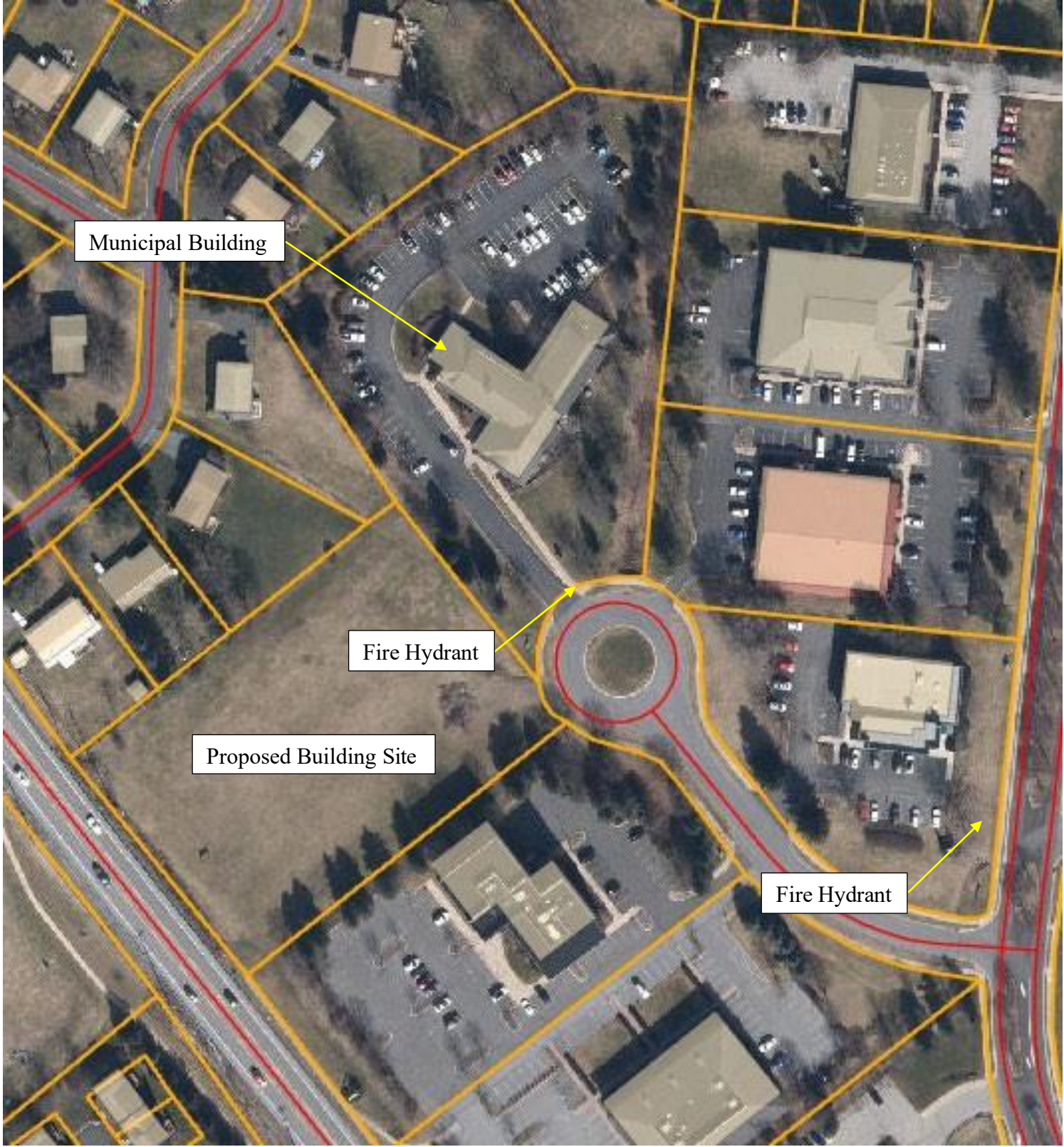

Municipal Building

Fire Hydrant

Proposed Building Site

Fire Hydrant

## **STATION J**

### **Policy Development**

You as one of the fire inspectors for Anytown, Pennsylvania have observed that the re-inspections for violations are not always being conducted, or conducted in a timely fashion based on the amount of time that was provided for corrective action. This is occurring both for the fire inspectors and the first responder inspectors in the jurisdiction.

Develop a draft policy to address the issue and correspondence to your supervisor introducing the issue and proposed solution.

Your supervisor is:

Thomas H. Jones, FM Supervisor  
for Inspections Anytown Borough  
324 Municipal Lane  
Anytown, PA 99999

## **STATION K**

### **Building Mechanical Equipment**

As the fire inspector for Anytown Borough, Pennsylvania you received a complaint from the Assistant Manager of Up All Night Coffee House, located at 123 Bogart Avenue, Anytown, Pennsylvania. The complaint stated that the store owner, Frank Scott, had been doing work to fix the water heater and things did not look “quite right.” You conducted a fire inspection of Up All Night Coffee House at 3 pm on May 15, 2024. Prior to conducting the inspection, you obtained verbal consent from the manager Barry Bostwick. During your inspection you took the following photograph of the mechanical room. Prior to this inspection, all of the previous inspections were completed with no violations, and there is no record of any permits being issued for work at the property since the initial building permit that was completed, and a certificate of occupancy issued on November 1, 2010.

Complete your field inspection and communicate the results of your inspection and resolve the complaint in writing in accordance with the policies and procedures of the jurisdiction.

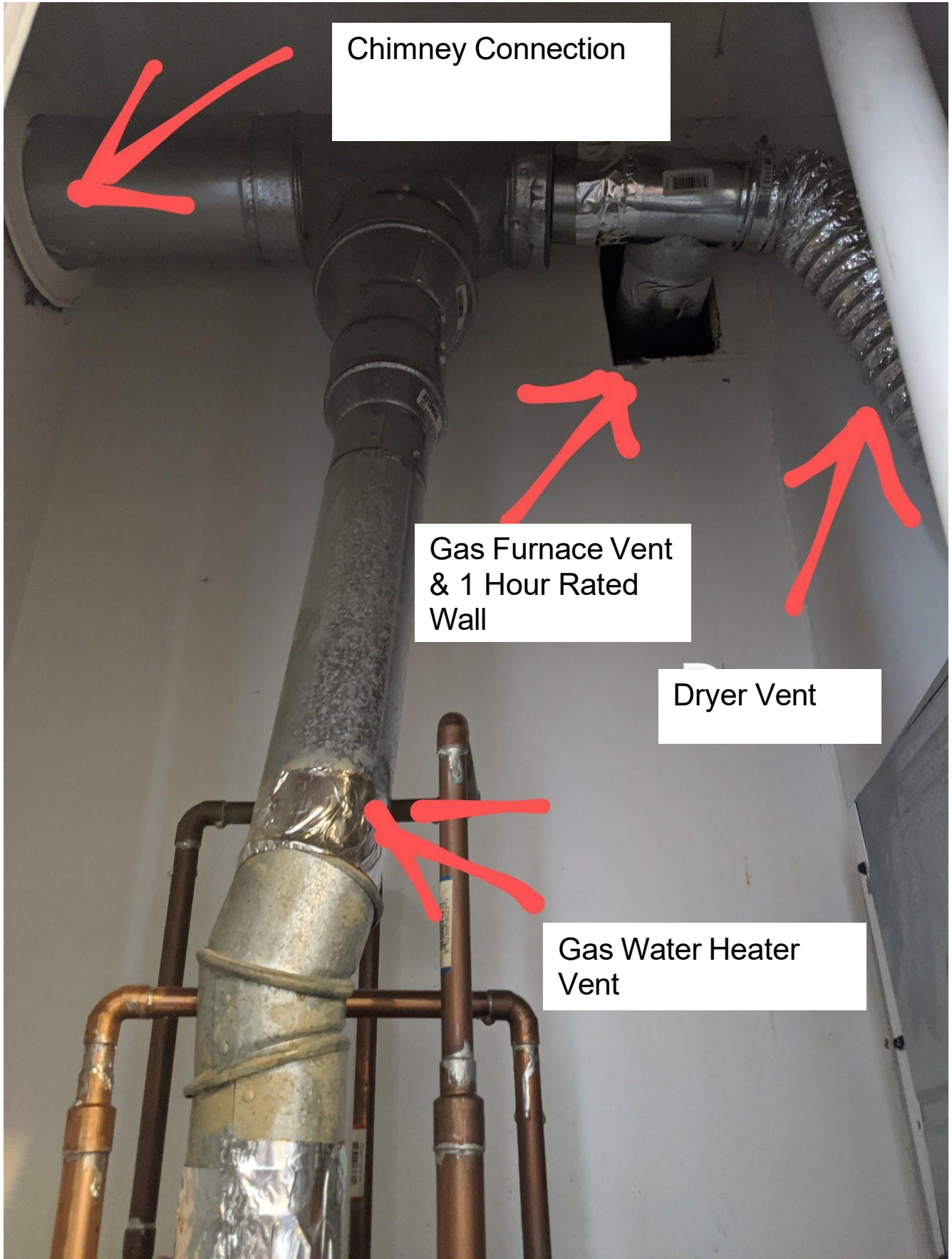

Chimney Connection

Gas Furnace Vent  
& 1 Hour Rated  
Wall

Dryer Vent

Gas Water Heater  
Vent

## **STATION L**

### **Performance Design Evaluation**

As the fire inspector for Anytown Borough, Pennsylvania the following performance based designed hood suppression system as-built shop drawings were submitted as part of a building permit submission. Process and review the following as-built shop drawing submittal in accordance with the policies and procedures of the jurisdiction and communicate your findings to the permit applicant. Your field inspection found that the installation was identical to the as-built shop drawings.

All of the documents filed for the job are included:

# Fire Suppression System

Wet Chemical - Kitchen System

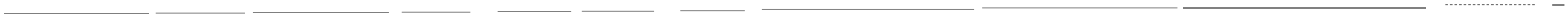

# Pre-Engineered Fire Suppression System

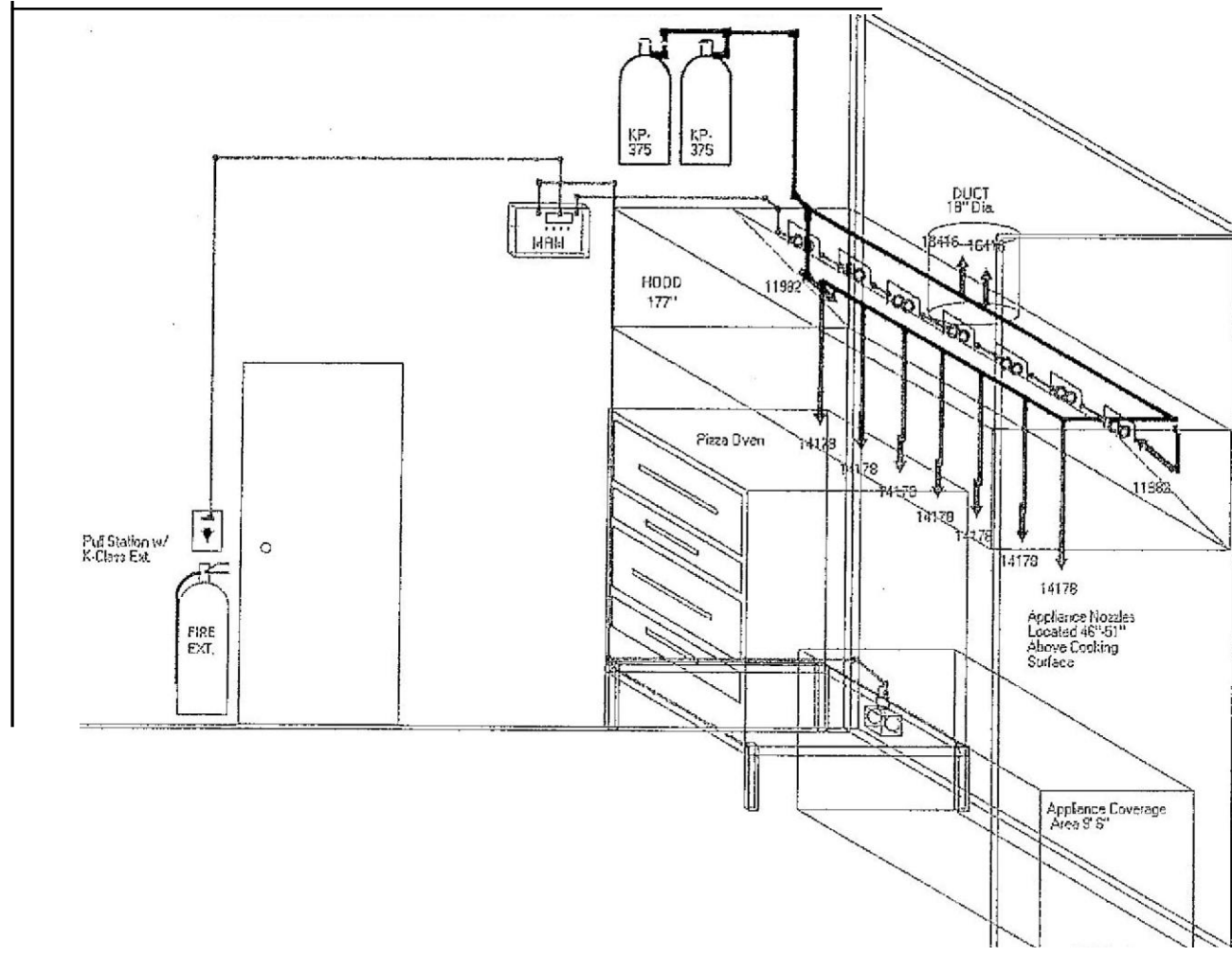

SCALE

1/2 inch = 1 foot

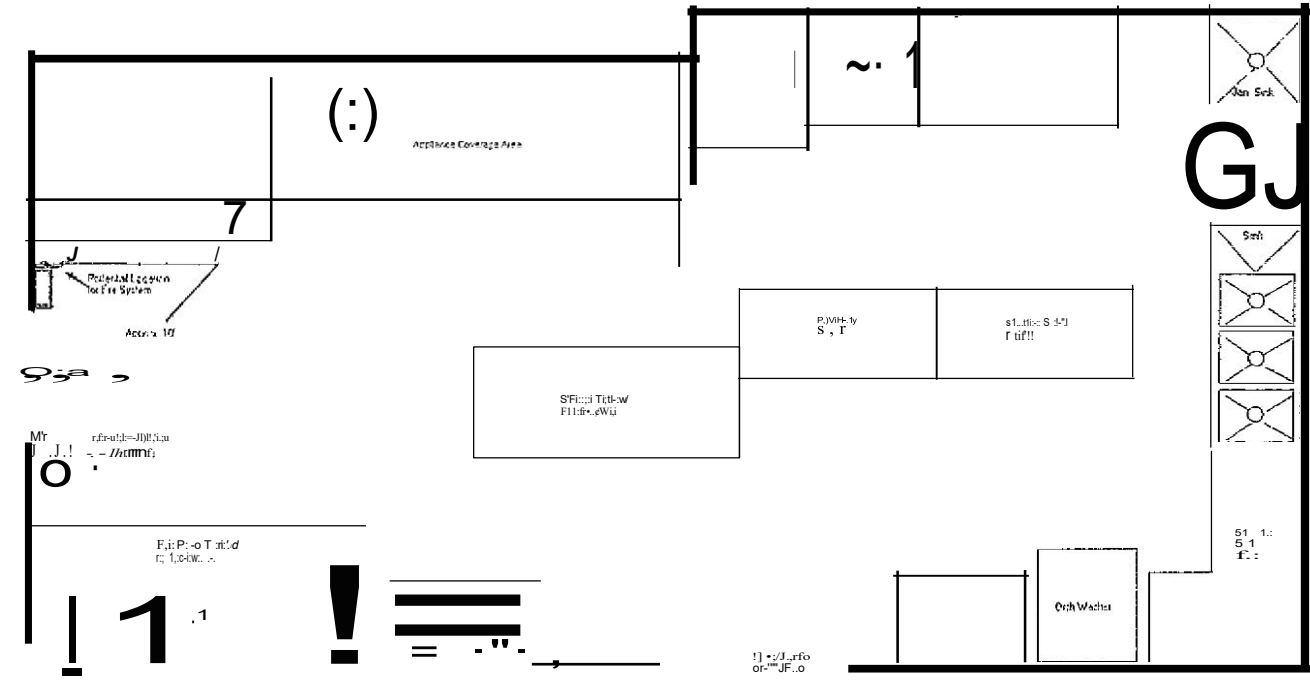

SCALE

1/2 inch = 1 foot

Total System Flow Points 22 : Flow Points Used 15

Date: 3/27/2024

# Pre-Engineered Fire Suppression System

## LIQUID AGENT RECHARGES



P/N 16924 - CHS47

2.75 Gal. Pall - 30 lbs. (13.6 kg)

P/N 12866 - CHS44

3.75 Gal. Pall -42½ lbs., (19.277 kg)

P/N 17450 - CH6S6

4.80 Gal. Pall -51.24 lbs. (23.24 kg)

P/N 15416 - CH664

6.14 Gal. Pall - 67 lbs. (29.71 kg)

Tile operating temperature of the Liquid Agent is 32°F to 120°F (0°C to 49°C).

AMEREX KP Wet Chemical Agent is specially formulated potassium acetate based solution designed for use on cooking grease and cooking oil fires. AMEREX Wet Chemical Recharge is shipped in plastic pails with each pail marked with a date and batch code.

WHENEVER HANDLING THE AGENT, GLOVES SHOULD BE WORN. AVOID CONTACT WITH SKIN. IN CASE OF DISCHARGE, THE SOLUTION SHOULD BE CLEANED UP PROMPTLY TO AVOID DAMAGE TO APPLIANCES, FOOD, AND DUCTS. AVOID CONTACT WITH THE AGENT. MUST BE DISCARDED. REFER TO THE MATERIAL SAFETY DATA SHEET.

AMEREX SDS: <https://www.amerex-fire.com/resources/sds/>

## KP 275/375/475 CYLINDER BRACKET

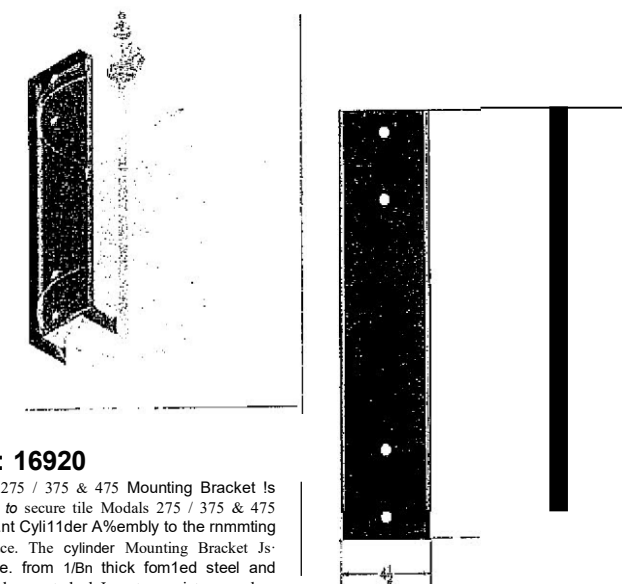

P/N: 16920

The 275 / 375 & 475 Mounting Bracket is used to secure the Models 275 / 375 & 475 Agent Cylinder Assembly to the mounting surface. The cylinder Mounting Bracket is made from 1/8" thick formed steel and powder coated silver to resist corrosion. The assembly comes with a stainless steel belly strap and a Swivel Adapter (16901) for connection to the cylinder valve outlet.

## MECHANICAL RELEASE MODULE

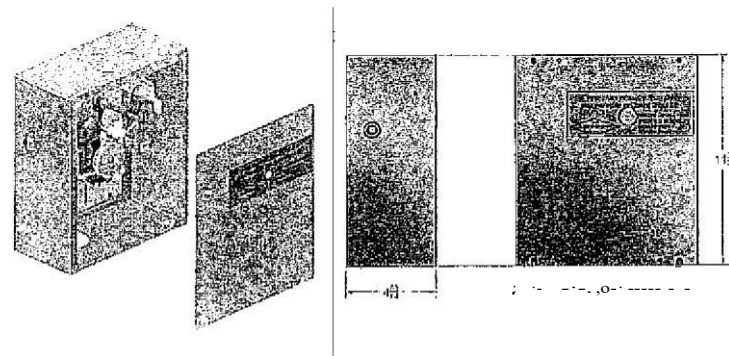

P/N: 18001

The new MRM combines the same features and function as the original MRM along with increased detection capabilities and a simple method of setting the detection cable tension. The slide plate and collapsible column are now Teflon coated. The MRM is available in the above configuration or now preinstalled in its own enclosure.

Setting the detection cable tension does not require the use of any tools. The cable is locked down into the large, knurled ratchet wheel. A large lever to the right of the ratchet wheel is used to increase the cable tension. Alignment of the bottom edge of the lever with markings on a label indicates when the proper tension has been achieved. Lowering cable tension to allow detection links is not possible.

There is also a MRM available without the enclosure, P/N 11977. This has the same purpose and functionality as the MRM (P/N 18001). It is often used in conjunction with the Single

## GAS TRIP ASSEMBLY

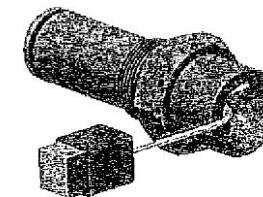
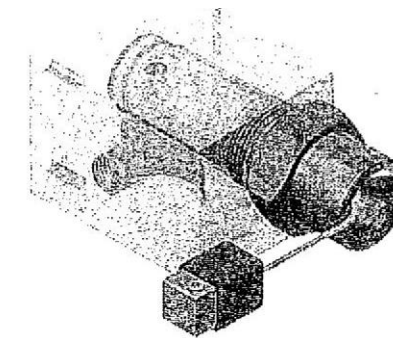

P/N: 12740

Operation of the mechanical gas valve may be accomplished with the Gas Trip Assembly (P/N 12740) which is included in the AMEREX Mechanical Gas Valve.

The cable for the gas valves, manual pull stations and detector network may be attached to the MRM from either the top or bottom.

